

1:8 SCALE CATALOG

- ◆ These products are no longer available.
- ◆ Information provided for reference only.

1:8 GAS KITS

2002	RC300-BD RACING KIT with Ball Differential THIS KIT IS NOT AVAILABLE Associated's flat pan technology is incorporated in the design of this car, including the very rugged #2850 ball differential. The adjustable differential adapts the car easily to any kind of surface condition, making this the easiest-to-drive flat pan car on any track. Less engine, radio and body.	\$159.00
5002	RC500 4WD RACING CAR KIT THIS KIT IS NOT AVAILABLE The RC500 4WD car won the 1987 IFMAR WORLD CHAMPIONSHIPS, the 1987, 1988, 1989 & 1990 NATIONALS and the 1987, 1988 & 1989 WINTERNATIONALS and the 1987, 1988, 1989, 1990 McCOY races. Kit is complete, including flywheel and motor mounts. Does not include motor, radio, or body. Side exhaust engines will not fit.	\$625.00
5001	RC500 2WD SUSPENSION RACING CAR KIT THIS KIT IS NOT AVAILABLE Top Qualifier at the 1983/84 WORLD CHAMPIONSHIPS. 1983, 1984, 1985, 1987 ROAR NATIONAL CAN AM CHAMPION. Winner of the 1985 McCOY race. Kit is complete, including flywheel and motor mounts. Does not include motor, radio, or body. Side exhaust engines will not fit.	\$475.00
5515	RC500 4WD CONVERSION KIT THIS KIT IS NOT AVAILABLE All the parts necessary to change your RC500 2WD car into an RC500 4WD car.	\$250.00

BODY ACCESSORIES

115	WING THINGS, secures wing to wing wire	pr	2.50 NOW 1.25
116	CAN AM WING KIT, ideal for racing. Contains plastic wing, wire, wing things and instructions	1	3.50 NOW 1.75

118	CAN AM WING, plastic only	1	2.00 NOW 1.00
118F	FORMULA 1 WING, plastic only	1	2.00 NOW 1.00
711	REEDY CAR WASH. Great for cleaning gas and electric cars and bodies. Lexan safe and biodegradable. Not for electrical components. 4 oz. bottles sold in cases of 12 only. Price reflects \$6.00 per bottle. (Purchase individual bottles at your hobby shop or race track.)	1 case	72.00
2204	LIGHTWEIGHT RACING DRIVER	1	1.00 NOW .50
2207	BODY MOUNT HOOD PINS, small	6	.75
2208	BODY MOUNT HOOD PINS, large	6	.75
SP-20*	ASSOCIATED DECAL SHEET, MYLAR Peel & stick decals, over 50 emblems to help make your car look like the real thing.	1	4.00
2812	Large "TEAM ASSOCIATED" decal, black	5	2.50
2813	Large "TEAM ASSOCIATED" decal, white	5	2.50

RC500 FRONT END

5100	FRONT BULKHEAD (2WD)	1	6.50 NOW 3.25
5101L	LEFT HAND LOWER 'A' ARM	1	2.50
5101L SP	LEFT HAND LOWER 'A' ARM, BLACK	1	7.50 NOW 3.75
5101R SP	RIGHT HAND LOWER 'A' ARM, black	1	7.50 NOW 3.75
5102L	LH UPPER 'A' ARM	1	2.00 NOW 1.00
5102L SP	LH UPPER 'A' ARM, BLACK	1	6.00 NOW 3.00
5102R	RH UPPER 'A' ARM	1	2.00 NOW 1.00
5102R SP	RH UPPER 'A' ARM, BLACK	1	6.00 NOW 3.00
5103L	LH STEERING BLOCK ARM	1	.50 NOW .25
5103R	RH STEERING BLOCK ARM	1	.50 NOW .25
5104	STEERING BALL CUP	4pr	3.50 NOW 1.75
5106	WASHER, LOCKING	4	.80 NOW .40
5107	HORSESHOE WASHER	4	.50 NOW .25
5108L	LH STEERING BLOCK WITH AXLE	1	9.00 NOW 4.50
5108R	RH STEERING BLOCK WITH AXLE	1	9.00 NOW 4.50
5109	AXLE WASHER, inner	2	.30 NOW .15
5111	AXLE WASHER, outer	2	.30 NOW .15
5112	LOCK NUT	2	.55 NOW .30
5114	CAMBER SPACER	2	.50 NOW .25
5115	UPPER 'A' ARM PINS	2	.50 NOW .25
5116	LOWER 'A' ARM PINS	2	.50 NOW .25
5117	'A' ARM PIN LOCK WASHERS	24	1.50 NOW .75
5118	'A' ARM PIN SNAP RINGS	30	3.50 NOW 1.75
5119	FRONT ANTI-ROLL BAR KIT WITH BALL ENDS, complete	1	7.50 NOW 3.75
5120	FRONT ANTI-ROLL BAR MOUNT	2	1.00 NOW .50
5122	MOLDED FRONT BUMPER, for cold weather	1	5.00 NOW 2.50
5123	MOLDED FRONT BUMPER, for hot weather	1	5.00 NOW 2.50

5129	TITANIUM ROD, 1/8" Dia x 3', saves 3oz	1	15.00 NOW 7.50
------	--	---	----------------

RC500 FRONT WHEELS & TIRES

5150	FRONT WHEELS	pr	6.00
2222	BALL BEARINGS for front wheels, 2 per wheel req'd. 1/4 x 5/8	pr	12.50 NOW 6.25
5151	FRONT WHEELS & TIRES (kit foam compound)	pr	12.00 NOW 6.00
2634	FRONT FOAM TIRES only (kit compound)	pr	4.00

RC500 REAR WHEELS & TIRES

5300	REAR WHEEL ONLY	2	6.00 NOW 3.00
5304	REAR WHEEL & TIRE, firm; green, (kit compound) use on high traction tracks	2	18.00
5312	YELLOW COMPOUND FOAM RUBBER, tires only, untrued, for average tracks NOT AVAILABLE	2	10.00
5313	GREEN KIT COMPOUND FOAM RUBBER, tires only, untrued, high traction tracks	2	10.00
SP-192*	REAR RACING FOAM RUBBER, #70 compound, better traction and wear	pr	16.95

RC500 CHASSIS & RADIO TRAY

5173	SCREW SET, for chassis and power pod	12	3.50 NOW 1.75
5516	CHASSIS PLATE for 2 or 4 wheel drive, fiberglass	1	14.00 NOW 7.00
5517	RADIO TRAY, for 2 or 4 wheel drive, fiberglass	1	12.00 NOW 6.00
5518	GRAPHITE CHASSIS, precut	1	70.00 NOW 35.00
5176	SERVO SAVER SPACER AND BODY MOUNT SPACER	3	.75 NOW .40
5177	REAR RADIO TRAY MOUNT	2	1.50 NOW .75
5178	RECEIVER AND BATTERY MOUNT	2	1.50 NOW .75
5179	STEERING SERVO SPACER	2	1.00 NOW .50
5180	LINKAGE MOUNTS	2	1.00 NOW .50
5195	PLASTIC FUEL TANK	1	18.00 NOW 9.00
5196	"O" RING FOR #5195 FUEL TANK CAP	2	1.00 NOW .50
5197	MOUSE TRAP SPRING KIT, for external tank spring	1	3.00 NOW 1.50

RC500 CLUTCH

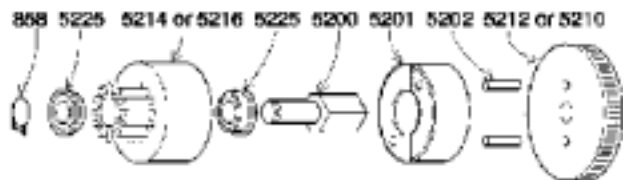

858	CLUTCH NUT CLIPS	6	.75 NOW .40
5200	CLUTCH NUT, 1/4-28 threads	1	2.50 NOW 1.25
5201	CLUTCH SHOES	pr	7.00 NOW 3.50

5202	CLUTCH DOWEL PINS	4	1.00 NOW .50
5203	CLUTCH SHOES FOR 3-PIECE CLUTCH	set	7.50 NOW 3.75
5221	14T RACING CLUTCH BELL	1	9.00 NOW 4.50
5220	16 TOOTH VENTILATED CLUTCH BELL	1	6.00 NOW 3.00
5225	CLUTCH PRECISION BALL BEARINGS, 1/4 x 3/8	pr	28.00 NOW 14.00

RC500 GEAR & BRAKES

2610	DISC BRAKE ROTOR, steel, for all 1:8 kits. Replaces #2617 fiber rotor for RC250 & 300BD	1	2.50 NOW 1.25
5233	SPROCKET IDLER SHAFT	1	5.00 NOW 2.50
5234	IDLER SHAFT BALL BEARINGS, 1/4 x 1/2	pr	12.00 NOW 6.00
5237	BRAKE ARM	1	.25 NOW .12
5239	BRAKE ROTOR, fiberglass	2	3.00 NOW 1.50
5240	BRAKE CAM	1	3.50 NOW 1.75
5242	SPUR GEAR 42T	1	3.00 NOW 1.50
5243	SPUR GEAR 43T	1	3.00 NOW 1.50
5244	SPUR GEAR 44T	1	3.00 NOW 1.50
5246	GEAR SPACER	1	.75 NOW .40
5247	GEAR HUB	1	2.50 NOW 1.25
5248	STEEL DUAL DISK BRAKE KIT	1	10.00 NOW 5.00
5249	STEEL DUAL DISK BRAKE KIT LINING, for #5248; also replaces #5238 fiberglass brake shoes	3pc	5.00 NOW 2.50

RC500 REAR END

5250	REAR POD PLATE	1	22.50 NOW 11.25
5251LS	LEFT HAND REAR BULKHEAD, uses #5375 bearings	1	6.50 NOW 3.25
5251RS	RIGHT HAND REAR BULKHEAD, uses #5375 bearings	1	6.50 NOW 3.25
5255	REAR BODY MOUNT	2	1.50 NOW .75
5257	REAR END BRACE WITH SCREWS	1	2.50 NOW 1.25
5260	REAR UPPER 'A' ARM, fits both left hand and right hand sides	1	2.50 NOW 1.25
5262	REAR LOWER 'A' ARM, fits both left hand and right hand sides	1	2.50 NOW 1.25
5263	REAR 'A' ARM PINS	8	1.50 NOW .75
5264R	RIGHT HUB CARRIER	1	2.50 NOW 1.25
5264L	LEFT HUB CARRIER	1	2.50 NOW 1.25
5266	REAR STUB AXLE BALL BEARING, 7/16 x 11/16	2	20.00 NOW 10.00
5267	REAR STUB AXLE BEARING SPACER	2	1.50 NOW .75
5268	REAR STUB AXLE WASHER	2	.60 NOW .35
5269	REAR STUB AXLE LOCKNUT	2	1.00 NOW .50
5270	DRIVESHAFT, hex drive	1	12.00 NOW 6.00
5271	RUBBER BELLOWS, small	2	4.00 NOW 2.00
5273	DRIVESHAFT SPACER	2	1.50 NOW .75
5274	DRIVESHAFT SPRING	2	1.00 NOW .50
5280	REAR ANTI-ROLL BAR MOUNT	2	1.00 NOW .50
5281	REAR ANTI-ROLL BAR WIRE, specify 1/8" or 3/32"	3	1.50 NOW .75
5282	ALUMINUM REAR	4	2.00 NOW 1.00

	BULKHEAD SCREWS		
5289	REAR FIBERGLASS SHOCKMOUNT	1	12.50 NOW 6.25
5290	REAR SHOCK MOUNT KIT	1	18.00 NOW 9.00
5291	FIBERGLASS BRAKE CAM MOUNT	1	4.00 NOW 2.00
5292	REAR QUICKCHANGE WHEEL HUB KIT	1	22.50 NOW 11.50
5294	STUB AXLE FOR #5292	1	7.00 NOW 3.50
5295	PLASTIC INSERT WITH SPRING AND PIN for #5292	1	2.50 NOW 1.25

RC500 BELT DRIVE

5350	BELT DRIVE KIT, contains belt, front sprocket, differential drive sprocket and differential balls	1	24.00
5351	BELT for #5350	1	7.50 NOW 3.75
5352	FRONT 26 Tooth SPROCKET for #5350	1	7.00 NOW 3.50
5353	REAR 56 TOOTH DIFFERENTIAL SPROCKET for #5350	1	10.00 NOW 5.00

ENGINE MOUNTS AND FLYWHEELS for RC500, RC300BD, RC250

For OS MAX EXR21, use #5207 motor mounts and use #5212 flywheel with #5227 collet.

2509	4-40 x 1/2" SOCKET HEAD Cap Screw (for mounting engine to engine mounts)	4	.75
5205	ENGINE MOUNTS for K&B 3.5 & PICCO (old style)	set	7.00 NOW 3.50
5206	ENGINE MOUNTS for OPS & ROSSI	set	7.00 NOW 3.50

5207	ENGINE MOUNTS for OS MAX (SE, RF, VF & EX series), Royal, and Magnum (standard kit)	set	7.00 NOW 3.50
5208	ENGINE MOUNTS for REX, NOVA ROSSI OS MAX RX series, PICCO (new black case engine).	set	7.00 NOW 3.50
5210	FLYWHEEL for OS MAX, Royal, Magnum, Leo & most prop spacer style crankshafts, standard kit. (see drawings following)	1	10.00 NOW 5.00
5212	FLYWHEEL for PICCO, OPS, REX, NOVAROSI, OS MAX (EX & RX series), and other 7MM or .275" straight shaft motors. Requires #5227 collet. (see drawings following)	1	8.00 NOW 4.00
5227	FLYWHEEL COLLET for #5212 & 5213 flywheel and 7MM or .275" shaft motors	1	2.00 NOW 1.00

RC500 BALL DIFFERENTIAL

2863	DIF BALL THRUST WASHER (dif ball rings)	pr	3.00
5360LW	DIF LEFT AXLE DRIVER, lightweight, use with #5375 bearings	1	13.25 NOW 6.75
5361	DIF OUTER HUB	1	5.75 NOW 3.00
5362LW	DIF RIGHT AXLE DRIVER, lightweight, use with #5375 bearings	1	8.25 NOW 4.25
5363	DIF BEARING ADAPTOR	1	1.60 NOW .80
5364	DIF BRAKE HUB	1	14.00 NOW 7.00
5365	DIF INNER HUB	1	3.50 NOW 1.75
2864	5/32" DIF BALL	12	1.50 NOW .75
6636	ASSOCIATED SILICONE DIF LUBE	1	2.50
5369	DIF BELLEVILLE WASHERS	3	1.50 NOW .75
5370	DIF 10/32 ADJUSTMENT SCREW	1	.65 NOW .35
5371	DIF THRUST WASHER	1	.75 NOW .40
5372	DIF OUTER HUB BUSHING	1	.50 NOW .25

RC500 FRONT SHOCKS

5138	SHOCK KIT, with springs and oil	pr	30.00
5400	SHOCK BODY	1	3.00 NOW 1.50
5401	SHOCK BODY CAP	1	2.50 NOW 1.25
5402	SHOCK SHAFT	1	2.50 NOW 1.25
5403	SHOCK SHAFT CAP	1	2.25 NOW 1.25
5404	FRONT SHOCK ADJUSTING COLLAR, nylon	1	1.00 NOW .50
5405	SHOCK MAINTENANCE KIT, parts to rebuild one shock	set	2.00 NOW 1.00
5406	SHOCK DUST COVERS WITH TIES	4	1.00
5441	RC500 FRONT SPRINGS, 3/4" X .059	pr	1.25 NOW .65
5442	RC500 FRONT SPRINGS, 3/4" X .055	pr	1.25 NOW .65
5443	RC500 FRONT SPRINGS, 3/4" X .051	pr	1.25 NOW .65

IF YOU HAVE:



USE:
#5212 flywheel and #5227 flywheel collet.

MODIFICATIONS:
None.

IF YOU HAVE:



USE:
#5212 flywheel and #5227 flywheel collet.

MODIFICATIONS:
Remove portion of shaft (in gear above) to install in Associated gear cars.

IF YOU HAVE:



USE:
#5210 flywheel with set screw.

MODIFICATIONS:
Remove silver-colored prop spacer to see flat spot on crankshaft.

RC500 REAR SHOCKS

5407	RED SILICONE "O" RINGS, makes shocks smoother	8	2.00
6455	BODY, 0.4 bore x 0.56 stroke	1	5.50 NOW 2.75
6411	SHOCK SHAFT, CHROMED	ea	5.00 NOW 2.50
6461	SHAFT, 0.56 stroke	1	3.00
6464	PISTONS, all 0.4 bore shocks	4	3.00
6467	REBUILD KIT, for #5460 Shocks	1	4.00
6471	ROD ENDS for two shocks, .230 ball	2	3.00
6473	SHOCK BUSHINGS	4	1.00
5465	SILVER SPRINGS, .040, soft for #5460	pr	1.25 NOW .65
5466	BLACK SPRINGS, .042, med for #5460	pr	1.25 NOW .65
5467	GOLD SPRINGS, .046, firm for #5460	pr	1.25 NOW .65
5468	RC500 REAR SPRINGS, 1" X .045, medium for #5460	pr	1.25 NOW .65
5469	RC500 REAR SPRINGS, 1" x .049, firm for #5460	pr	1.25 NOW .65

SHOCK OIL

5412	SHOCK OIL, 50 wt, 1 oz bottle	1	1.25
5413	SHOCK OIL, 40 wt, 1 oz bottle	1	1.25
5414	SHOCK OIL, 30 wt, 1 oz bottle	1	1.25
5415	SHOCK OIL, 20 wt, 1 oz bottle	1	1.25
5416	SHOCK OIL, 10 wt, 1 oz bottle	1	1.25
5420	SILICONE SHOCK OIL, 10 wt, 2 oz bottle	1	3.50
5427	SILICONE SHOCK OIL, 15 wt, 2 oz bottle	1	3.50
5421	SILICONE SHOCK OIL, 20 wt, 2 oz bottle	1	3.50
5428	SILICONE SHOCK OIL, 25 wt, 2 oz bottle	1	3.50
5422	SILICONE SHOCK OIL, 30 wt, 2 oz bottle	1	3.50
5429	SILICONE SHOCK OIL, 35 wt, 2 oz bottle	1	3.50
5423	SILICONE SHOCK OIL, 40 wt, 2 oz bottle	1	3.50
5435	SILICONE SHOCK OIL, 50 wt, 2 oz bottle	1	3.50
5436	SILICONE SHOCK OIL, 60 wt, 2 oz bottle	1	3.50
5437	SILICONE SHOCK OIL, 70 wt, 2 oz bottle	1	3.50
5425	SILICONE SHOCK OIL, 80 wt, 2 oz bottle	1	3.50

RC500 2-SPEED TRANSMISSION

5490	45 TOOTH 2 SPEED GEAR, use with #5499	1	4.50 NOW 2.25
5491	2 SPEED CLUTCH SPRINGS	pr	2.00 NOW 1.00
5492	2 SPEED SMALL	6	2.00 NOW 1.00

	SCREWS		
5498	BALL BEARINGS FOR #5499	pr	20.00 NOW 10.00
5499	14/18 CLUTCH BELL, uses 1 5225 and 1 5234 bearing	1	25.00 NOW 12.50
5501	ONE WAY ROLLER BEARING ONLY, FC8 size	1	9.50 NOW 4.75
5502	ONE WAY ROLLER BEARING in Hub	1	15.50 NOW 7.75
5503	2 SPEED LARGE CLUTCH BELL	1	10.00 NOW 5.00
897	BALL BEARINGS FOR #5503, 1/4 x 3/8	pr	13.00
5506	2 SPEED LARGE CLUTCH SHOES with springs and screws	pr	15.50 NOW 7.75
5508	LONG CLUTCH NUT	1	4.00 NOW 2.00
5510	LARGE CLUTCH SHOE DUST COVER	1	4.50 NOW 2.25
5511	2 SPEED IDLER SHAFT	1	25.00 NOW 12.50
5513	LARGE CLUTCH SHOE HUB	1	4.50 NOW 2.25
6591	TRANNY SILICONE DIF LUBE (for use on one way bearings)	1	2.50

RC500 4WD

5516	FIBERGLASS CHASSIS, precut	1	14.00
5517	FIBERGLASS RADIO TRAY, precut	1	12.00 NOW 7.00
5518	GRAPHITE CHASSIS, precut	1	70.00 NOW 35.00
5520	ENGINE POD	1	25.00 NOW 12.50
5524	14T IDLER SPROCKET	1	2.00 NOW 1.00
5525	SMOOTH IDLER SPROCKET	1	1.00 NOW .50
5526	IDLER SPROCKET BULKHEAD & screws	1	8.00 NOW 4.00
6227	SHAFTS for #5526	pr	2.50
6299	SHAFT CLIPS	pkg	1.00
5530	REAR ALUMINUM IDLER BLOCK	1	3.00 NOW 1.50
5531	FRONT BULKHEAD	1	9.00 NOW 4.50
5532	BULKHEAD BRACE with spacers	1	3.00 NOW 1.50
5533	REAR BRACKET	1	3.50 NOW 1.75
5535	LH OUTER WHEEL HUB with One Way	1	8.50 NOW 4.25
5536	RH OUTER WHEEL HUB with One Way	1	8.50 NOW 4.25
5537	INNER WHEEL HUB	1	1.50 NOW .75
5538	FRONT AXLE with button	1	7.50 NOW 3.75
858	AXLE CLIPS	6	.75 NOW .40
5539	INNER DRIVE SHAFT	1	7.50 NOW 3.75
5540	FRONT DOGBONE	1	7.00 NOW 3.00
5541	FRONT DOGBONE SPRINGS	pr	.50 NOW .25
5542	ALUMINUM BLOCKS FOR INNER DRIVE SHAFTS	pr	7.50 NOW 3.75
3655	IDLER SHAFT BALL BEARINGS, 1/8 x 5/16	pr	12.00
5545	LH & RH STEERING ARMS with screws	set	2.00 NOW 1.00
2533	TIE ROD STEEL BALL JOINTS used on #5545	pr	1.40 NOW .70
5546	RH STEERING BLOCK	1	9.00 NOW 4.50
5547	LH STEERING BLOCK	1	9.00 NOW 4.00
5548	LARGE STEERING	pr	14.00 NOW 7.00

	BLOCK BEARINGS, 1/4 x 1/2		
5549	FRONT AXLE WASHERS	10	1.50 NOW .75
5550	LH & RH TIE RODS	set	4.00 NOW 2.00
5551	KIMBROUGH SERVO SAVER	1	5.00
5552	TIE ROD STEEL BALL JOINTS used on #5551	pr	2.00 NOW 1.00
2532	TIE ROD PLASTIC END ONLY	pr	1.50 NOW .75
5555	18T DRIVE SPROCKET, use with #5556 and #5557	1	4.00 NOW 2.00
5556	32T FRONT SPROCKET, use with #5555 and #5557	1	8.00 NOW 4.00
5557	LONG BELT, use with #5555 and #5556	1	10.00
5560	SOLID REAR AXLE for RC500	1	45.00

RC300BD & RC250 CLUB RACER II

DISC BRAKE PARTS

Fiber rotor brake has been replaced by single steel rotor. Uses #2712 brake linings.

2610	DISC BRAKE ROTOR, steel, for all 1:8 kits. Replaces #2617 fiber rotor for RC250 & 300BD	1	2.50 NOW 1.25
2611	DISC BRAKE SHOE, steel. For #2617 fiber rotor only NOT AVAILABLE	pr	1.50
2612	DISC BRAKE CAM	1	2.00 NOW 1.00
2613	DISC BRAKE ARM	1	.75 NOW .40
2614	DISC BRAKE BRACKET	1	1.50 NOW .75
2616	DISC BRAKE SHOE PINS	6	1.00 NOW .50
2511	DISC BRAKE SPRING	1	.50 NOW .25
2712	BRAKE LINING KIT, for single or dual disc brakes (1 thick, 2 thin, 1 steel). For RC250 & 300BD. Replaces #2611 when using #2610 steel rotor	1	5.00 NOW 2.50

GEARS

2618	GEAR HUB PINS	pr	1.00 NOW .50
2869	58 TOOTH SPUR GEAR, fits RC250 & RC300BD	1	3.50
2870	61 TOOTH SPUR GEAR, fits RC250 & RC300BD	1	3.50
2871	63 TOOTH SPUR GEAR, fits RC250 & RC300BD	1	3.50
2622	GEAR HUB, with pins and set screw	1	3.00 NOW 1.50

REAR END PARTS

2201	STEEL WING TUBES	pr	2.50 NOW 1.25
2624	WHEEL HUB AND SET SCREW	1	2.50 NOW 1.25
2625	WHEEL HUB SET SCREWS, 1/4-20 threads	6	1.50 NOW .75
2626	REAR POD PLATE	1	9.50 NOW 4.75
2627	RH AXLE BEARING BLOCK	1	6.00
2628	LH AXLE BEARING BLOCK	1	4.00
2629	8mm TOOL STEEL	1	12.00

	REAR AXLE NOT AVAILABLE		
2517	BALL BEARINGS for rear axle #2629, 8mm x 16mm	1	12.50 NOW 6.25
2680	REAR WIRE BUMPER	1	4.00 NOW 2.00

WHEELS/TIRES & ACCESSORIES

2630	FRONT WHEELS ONLY, 2"	pr	5.00 NOW 2.50
1217	FRONT WHEEL BUSHINGS, 1/4 x 3/8 x 3/8	pr	1.50 NOW .75
2631	FRONT WHEELS AND TIRES, medium traction sponge	pr	11.00
2634	FRONT TIRES ONLY, med traction sponge	pr	4.00 NOW 2.00
2640	REAR WHEELS ONLY, 2". Fit RC250 or left wheel on RC300BD	pr	5.00 NOW 2.50
2641	REAR WHEELS MOUNTING SCREWS	8	2.00 NOW 1.00
2642	REAR WHEELS AND TIRES, now with green racing rubber for RC250 or left wheel on RC300BD	pr	18.00 NOW 9.00
5313	GREEN KIT COMPOUND FOAM RUBBER, tires only, untrued, high traction tracks NOT AVAILABLE	2	10.00

LINKAGE & CHASSIS

2525	SERVO SAVER COMPLETE	1	5.00 NOW 2.50
1203	SERVO SAVER JOURNALS for #2525	pr	2.50 NOW 1.25
2508	LINKAGE KIT, all necessary linkages, bellcrank, grommets, bolts, washers, nuts, carb springs, clips, rubber bands and instructions used to mount the #2512 radio mounting tray.	1	5.50 NOW 2.75
2510	THROTTLE RETURN SPRING	1	.50 NOW .25
2526	SERVO SAVER SPRINGS ONLY	1	.75 NOW .40
2527	SERVO SAVER PLASTIC ARMS	2	3.50 NOW 1.75
2530	TIE ROD ASSEMBLY COMPLETE	pr	6.00 NOW 3.00
2531	TIE ROD END COMPLETE, one only, plastic end, ball joint, bolt and locknut	set	1.50 NOW .75
2532	TIE ROD PLASTIC END ONLY	pr	1.50 NOW .75
2533	TIE ROD STEEL BALL JOINT ONLY	pr	1.40 NOW .70
2534	THREADED TIE ROD ONLY	pr	.50 NOW .25
2535	4-40 TIE ROD BOLTS AND NUTS	4	.70 NOW .35
2647	COMPLETE SET OF RC300 CHASSIS SCREWS	11	2.00 NOW 1.00
2649	FRONT CHASSIS PLATE	1	12.00

FRONT END PARTS

2650	SUSPENSION ARMS	pr	6.00 NOW 3.00
2651	KINGPIN	2	3.00 NOW 1.50
2652	STEERING BLOCK	2	7.50 NOW 3.57
2653	STEERING BLOCK ARM with screws	pr	2.00 NOW 1.00
858	KINGPIN CLIPS	6	.75 NOW .40
2654	STEERING BLOCK ARM SCREWS	4	.75 NOW .40
2656	15° FRONT SUSPENSION ARMS, for med. to hi traction tracks, includes shim	pr	8.00 NOW 4.00
2657	FRONT BODY MOUNT SUPPORT	1	.75 NOW .40
2658	FRONT BODY MOUNTS	set	1.00 NOW .50
2659	FRONT BUMPER	1	3.50 NOW 1.75

RC250 & RC300BD

CLUTCH

5201	CLUTCH SHOES	pr	7.00
5203	3-PIECE CLUTCH SHOES	set	7.50 NOW 3.75
2660	CLUTCH NUT, 3/16-28 threads	1	2.00
2661	CLUTCH NUT CLIPS	6	.75
2662	CLUTCH BALL BEARING SET, 3/16 x 5/16	3	20.00
6863	CLUTCH BUSHINGS FOR RC250, 3/16 x 5/16	4	1.50
2663	11 TOOTH CLUTCH BELL	1	4.00 NOW 2.00
2664	12 TOOTH CLUTCH BELL	1	4.00 NOW 2.00
2666	11 TOOTH VENTILATED CLUTCH BELL	1	5.00 NOW 2.50
2668	11 TOOTH RACING CLUTCH BELL	1	9.00 NOW 4.50
2669	12 TOOTH RACING CLUTCH BELL	1	9.00 NOW 4.50

RADIO TRAYS

2512	PLASTIC RADIO TRAY	1	5.50 NOW 2.75
2670	FRONT RADIO TRAY MOUNT	1	.75 NOW .40
2671	REAR RADIO TRAY MOUNT	2	1.25 NOW .65
2674	FIBERGLASS RADIO TRAY, latest configuration for racing	1	8.50

DUAL DISK BRAKE

2710	RC300 DUAL DISC BRAKE KIT, the ultimate in braking power! Kit contains two steel rotors, three pieces disc brake lining, pressure plate, cam, bracket, gear hub with pins & alignment plate. For solid axle and ball differential	1	22.50 NOW 11.25
2712	BRAKE LINING KIT, for	1	5.00 NOW 2.50

	single or dual disc brakes (1 thick, 2 thin, 1 steel)		
2713	DUAL DISC BRAKE CAM	1	3.50 NOW 1.75
2714	DUAL DISC GEAR HUB for #2710	1	4.50 NOW 2.25
2716	DUAL DISC ALIGNMENT PLATE	1	3.50 NOW 1.75
2717	SPRING SET	pr	2.00 NOW 1.00

RC300 BALL DIFF REPLACEMENT PARTS

2850	ASSOCIATED BALL DIF for RC300 & CLUB RACER II. Fully adjustable in seconds for any track condition. Ideal for all-out racing. Incl. #2852 LH & RH rear wheels with tires	1	70.00
2851	ASSOCIATED BALL DIFFERENTIAL complete, except DOES NOT INCLUDE REAR WHEELS AND TIRES	1	56.00
2852	LH & RH REAR WHEELS AND TIRES for #2850 RC300BD	pr	15.00 NOW 7.50
2853	LH & RH REAR WHEELS only, RC300BD	pr	6.00 NOW 3.00
2854	RH REAR WHEEL for #2850, ONE ONLY, RC300BD	1	3.50 NOW 1.75
2855	RH WHEEL SCREWS AND LOCKWASHERS	4	1.25 NOW .65
2856	TWO RH WHEELS AND TIRES for Ball Differential/RC300BD	pr	16.00 NOW 8.00
2860	AXLE WITH WASHER HUB INSTALLED	1	18.00 NOW 9.00
2861	RH DIF WHEEL HUB WITH ROLLER BEARING & SCREW	1	11.00 NOW 5.50
2862	DIF GEAR AND BRAKE HUB COMPLETE	1	14.00 NOW 7.00
2863	DIF BALL THRUST WASHER (dif ball ring)	pr	3.00 NOW 1.50
2864	5/32" DIF BALL	12	1.50 NOW .75
6636	ASSOCIATED SILICONE DIF LUBE	1oz	2.50
2865	SMALL WASHERS for roller thrust bearing	pr	1.50 NOW .75
2866	ROLLER THRUST BEARING, 5mm x 12mm	1	2.00 NOW 1.00
2867	BELLEVILLE CONE THRUST WASHER	3	.50 NOW .25
2868	AXLE LOCK NUT, aluminum	1	.95 NOW .60
2869	DIF GEAR, 58 TOOTH	1	3.50
2870	DIF GEAR, 61 TOOTH	1	3.50
2871	DIF GEAR, 63 TOOTH	1	3.50

	from O.S. Max.)		
SP-213*	PARIS SHOCK COLLARS NOT AVAILABLE	pr	7.00
SP-215*	PARIS WING PIVOTS NOT AVAILABLE	pr	7.00

MISCELLANEOUS PRODUCTS

SP-26*	RUBBER DONUT FOR ELECTRIC STARTERS, Perfect size to reach the flywheel. Made from hard rubber for long life NOT AVAILABLE	1	2.50
809	FUEL PROOF RUBBER BANDS, for shock mounting battery pack and receiver NOT AVAILABLE	pkg	.49
869	10-32 BOLTS, 1/2" LONG	10	.95 NOW .50
870	10-32 LOCK NUT & 1/2" LONG BOLT SET	set	.95 NOW .50
871	4-40 LOCK NUT AND BOLT SET for engine mounts	set	.69 NOW .35
1204	TWO 10-32 SET SCREWS AND WRENCH	3pc	.75 NOW .40
3719	NYLON WIRE TIES, 6" heavy duty	12	2.00
3720	NYLON WIRE TIES, 8" heavy duty	12	2.00
7709	NYLON WIRE TIES, 4" light duty	12	1.25
2509	4-40 x 1/2" SOCKET HEAD Cap Screw (for mounting engine to engine mounts)	4	.75
7710	FOAM FILTER TREATMENT	1	2.50
7725	FUEL TUBING, 3'	1	4.00

MC COY PRODUCTS

MC-59*	McCOY GLOW PLUG	1	3.95
--------	-----------------	---	------

CUSTOM RC500 PARTS

SP-186*	TITANIUM BRAKE ROTOR for #SP-188	ea	6.95 NOW 3.50
SP-187*	THIN BRAKE LINING for #SP-188	4	6.00 NOW 3.00
SP-188*	3 ROTOR BRAKE KIT, with 3 titanium rotors and 4 thin pads NOT AVAILABLE	1	26.85
SP-205*	REX MANIFOLD for RC500 (check your exhaust port against the drawing below to see if you also need to order part no. OSMG2570 from O.S. Max.)	1	29.95 NOW 15.00
SP-206*	PARIS MANIFOLD for RC250 & RC300BD (check your exhaust port against the drawing below to see if you also need to order part no. OSMG2570	1	26.95 NOW 13.50