

:: Bag 4 - Step 2

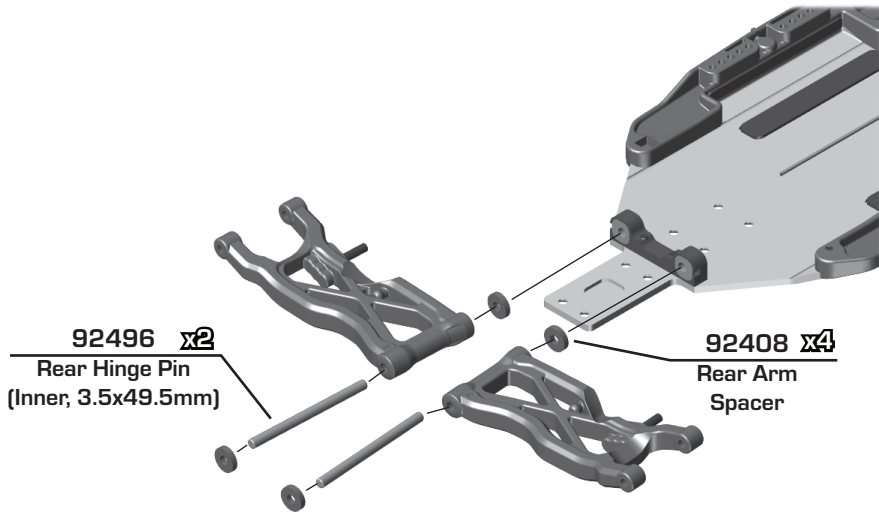

The (#92432) C and (#92433) D aluminum arm mounts allow for a large amount of setup combinations when using the (#92014) 0.5° and 1° arm mount inserts.

For a complete list of pill setup combinations, please visit our website by using the link below.
<http://bit.ly/B6PillChart>

| Arm Mount C: | Toe-In | Anti-Squat |
|--------------|--------------|--------------|
| 1° In | 3° Kit Setup | 2° Kit Setup |
| Arm Mount D: | | |
| 1° In | | |

:: Bag 4 - Step 3

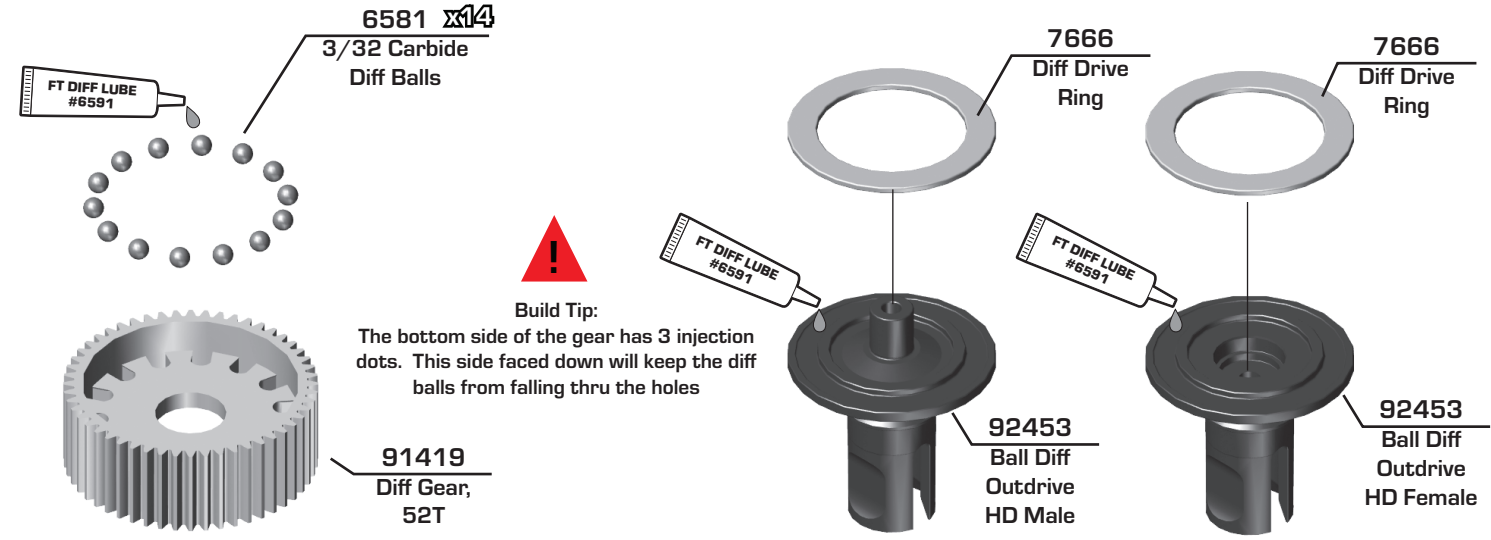

Build Tip:
 The bottom side of the gear has 3 injection dots. This side faced down will keep the diff balls from falling thru the holes



Build Tip:
 Do this entire step with the diff screw on the end of your wrench for better control.

:: Bag 4 - Step 4

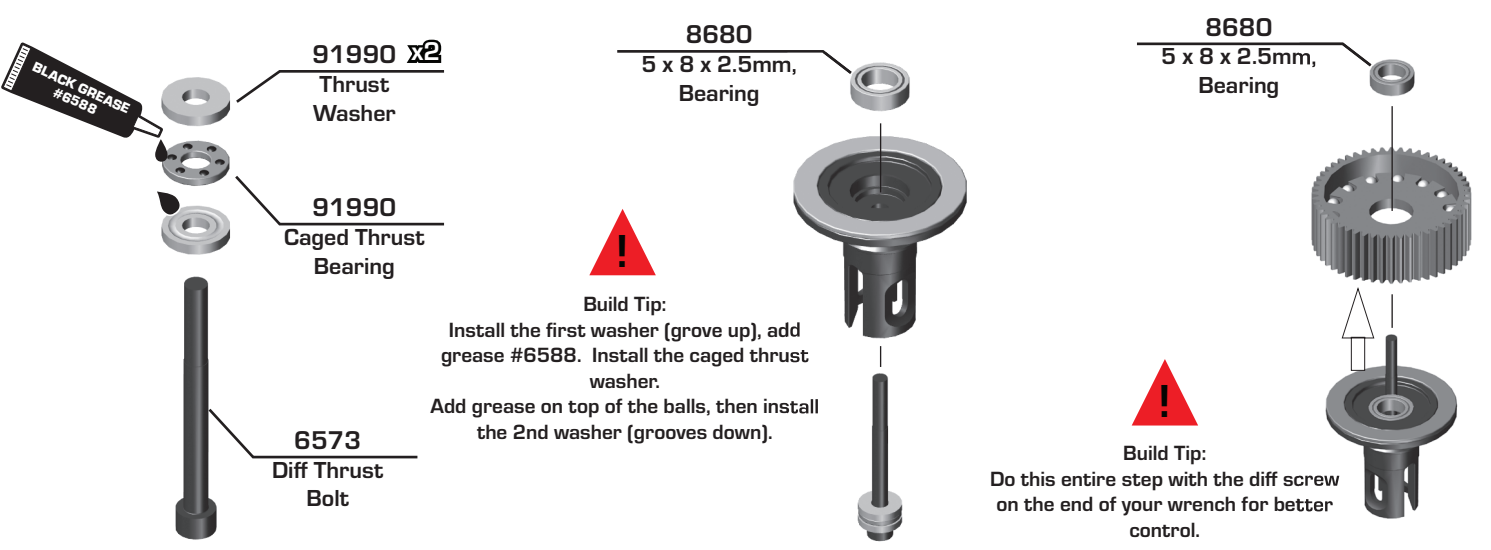

Build Tip:
 Install the first washer (grove up), add grease #6588. Install the caged thrust washer. Add grease on top of the balls, then install the 2nd washer (grooves down).



Build Tip:
 Do this entire step with the diff screw on the end of your wrench for better control.

Bag 4 - Step 5

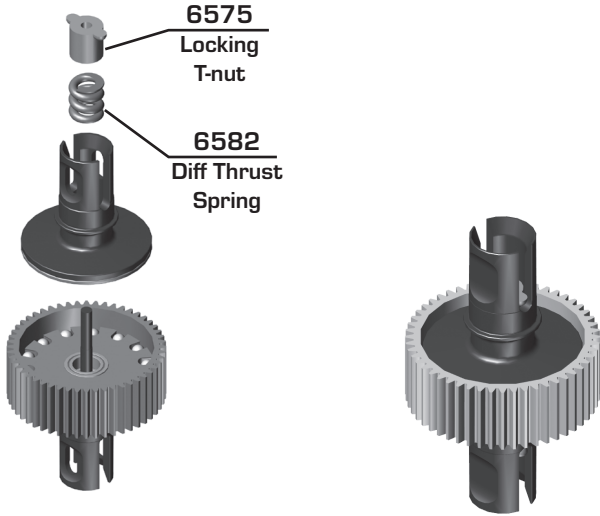

As you tighten the diff bolt, you will notice the T-nut ears moving closer to the bottom of the outdrive slot. This compresses the spring behind the T-nut. The spring should be completely

compressed at the time the T-nut reaches the end of the slot. Caution! Pay close attention to the feeling when the spring is completely compressed. Do not overtighten the bolt. When you feel the spring completely compressed, loosen the diff bolt 1/8 of a turn. Your diff should now operate smoothly but with resistance as the outdrives move in opposite directions. After you have driven the car once, re-check the diff setting.

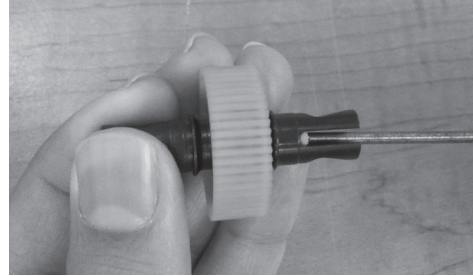

Bag 6 - Step 1



92406
Carbon
B7 Gearbox

92405
B7 Gearbox
(right)

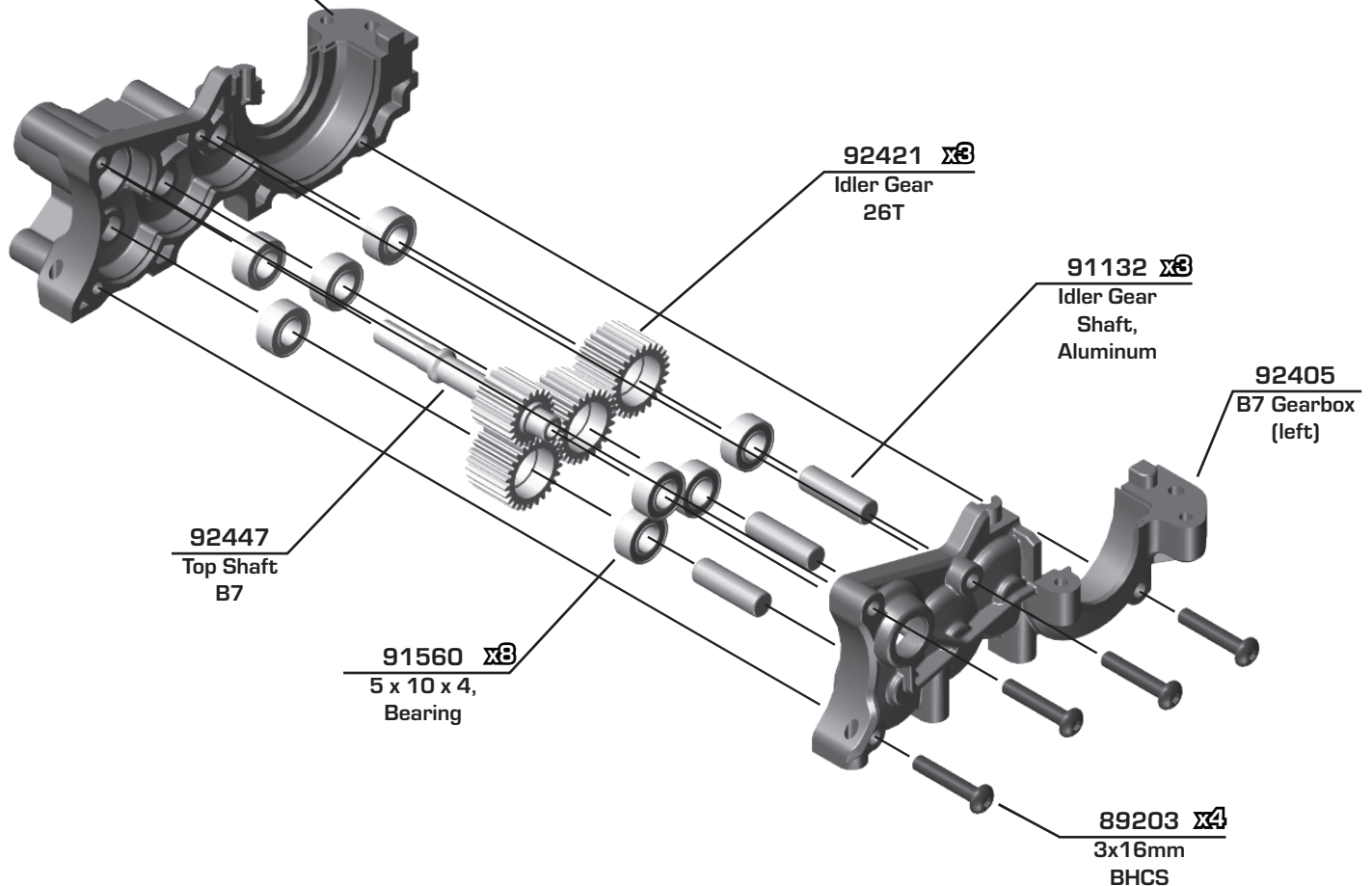

92421 x3
Idler Gear
26T

91132 x3
Idler Gear
Shaft,
Aluminum

92405
B7 Gearbox
(left)

92447
Top Shaft
B7

91560 x8
5 x 10 x 4,
Bearing

89203 x4
3x16mm
BHCS

Bag 6 - Step 3

| Diff Height | |
|-------------|-------------|
| | 3 |
| | 2 |
| | 1 Kit Setup |
| | 0 |



Add a drop of Diff Lube (#6591 - not included) to the teeth of the diff gear, idler gear, and top shaft.



91563 x2
10x15x4
Bearing



! Diff Height Inserts: The number on top is the setting. Stock diff height is 1.



92505
Carbon
B7 Gearbox

92504
B7 Gearbox
Top

Arm Mount D:
1° In



31532
M3 x 8mm
BHCS

89203 x4
M3 x 16mm
BHCS

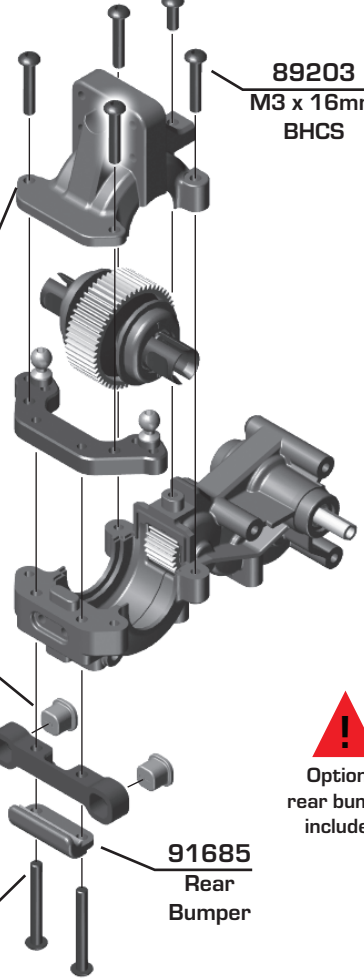

! Optional rear bumper included!

91685
Rear
Bumper

92014 x2
Arm Mount
Inserts (1°)

92433
Aluminum
Arm Mount, D

89204 x2
M3 x 24mm
BHCS

91048 x2
Heavy-duty
Ballstud, 8mm

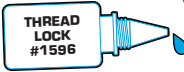

31383 x2
Ballstud
Washers,
5.5x2.0mm,
Blue Aluminum

92440
B7 Rear
Ballstud Mount,
Aluminum

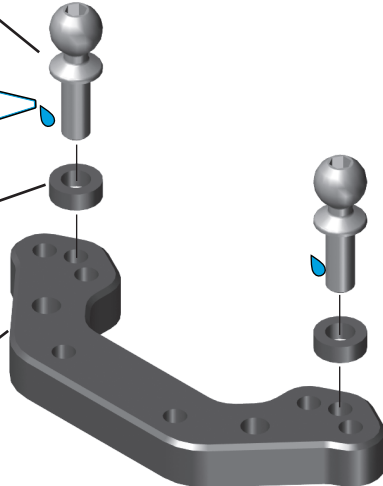

Bag 6 - Step 4

92427
B7 Spur
Gear Guard

91803
B6.1 Slipper
Hub, Inner

92295
Octalock Spur
Gear, 78T
48P



There's also a 72T, 48P spur gear (#92293) included for stock motor use!



92288 x2
Octalock
Slipper Pad,
19mm

92286
FT Octalock
LCF
Slipper Pad,
19mm

! #92295 spur gear walls should point away from gear box.

92439
B7
Motor Mount

25203 x3
M3 x 12mm
FHCS

92451
B7 Slipper Hub,
Outer

92448
B7 Top
Shaft Screw



FIND IT ON ASSOCIATEDELECTRICS.COM

CARS & TRUCKS

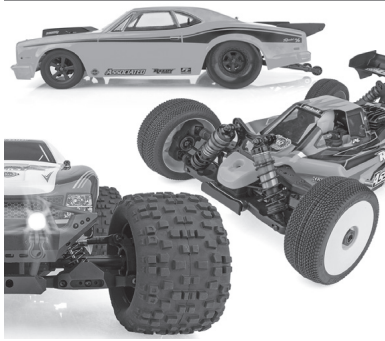

Vehicle Spare Parts

GO TO:

[AssociatedElectrics.com](#) →
[Team Associated tab](#) →
[Cars & Trucks](#) →
[Scroll to your vehicle](#) →
[Parts & Accessories link](#)

SETUP SHEETS & MANUALS



Setups and Manuals

GO TO:

[AssociatedElectrics.com](#) →
[Team Associated tab](#) →
[Manuals & Setups](#) →
[Scroll to your vehicle](#)

A-TEAM APPS



Tuning Guides & Tips

GO TO:

[AssociatedElectrics.com](#) →
[Support](#) →
[A-Team Apps](#)



Associated Electrics, Inc.

21062 Bake Parkway Lake Forest, CA 92630 USA

call: (949) 544-7500 - fax: (949) 544-7501

**Check out the following web sites for all of our kits, current products,
new releases, setup help, tips, and racing info!**

www.AssociatedElectrics.com

FOLLOW US ON SOCIAL MEDIA



TeamAssociated
ReedyPower
ElementRC
Factory Team

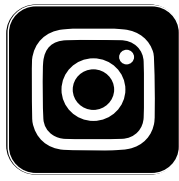

@TeamAssociatedRC
@ReedyPower
@Element_RC
@FactoryTeam_RC

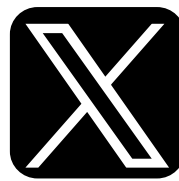

@Team_Associated
@ReedyPower



@Associated_Electrics