

### :: Bag 3 - Step 1

Build x2 (1 front, 1 rear)

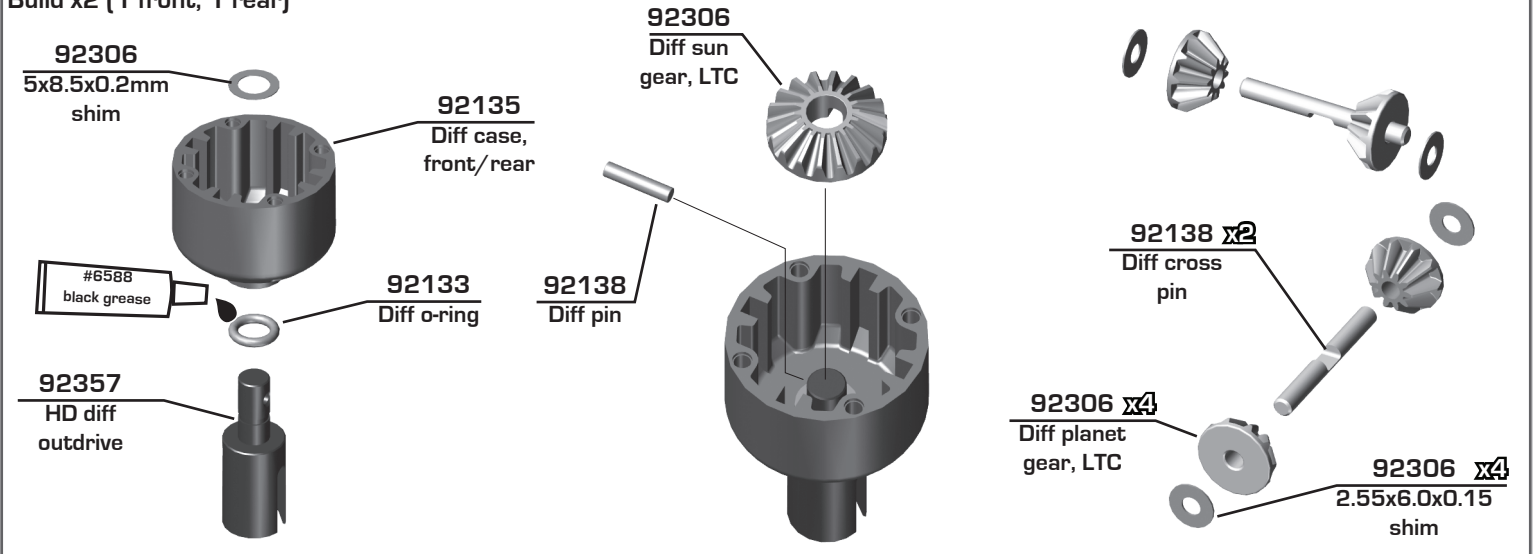

### :: Bag 3 - Step 2

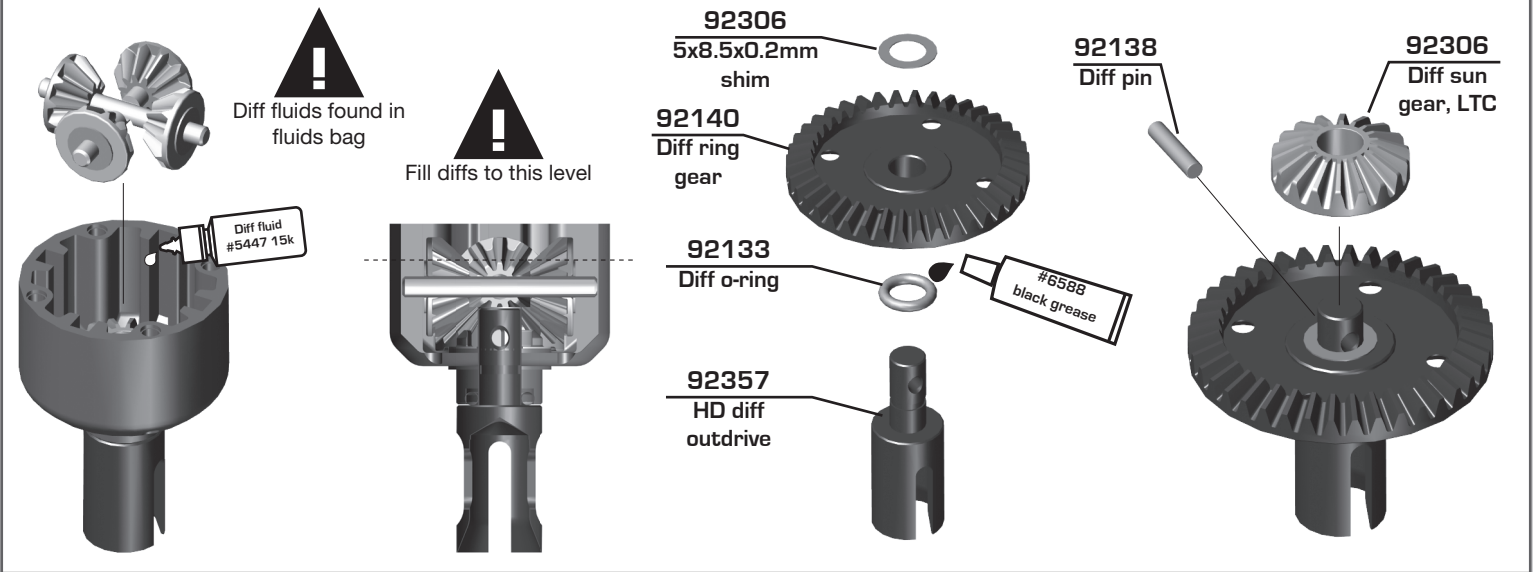

### :: Bag 3 - Step 3



It is important that the correct amount of fluid is added to the diff. Too much fluid may cause the diff to fail. Fill diffs to the reference line shown above. A more accurate method is to use a digital scale (AE#1522) to make sure the correct amount of fluid is added on the first build, and subsequent rebuilds. The entire diff assembly should weigh **45.25g** when built. Start by placing the ring gear assembly, screws, and cup assembly (without fluid) onto the scale.

Then slowly add fluid to the cup assembly until the overall mass is **45.25g**.

B74 Diff Weights (minus bearings)	Weight (grams)	
	Metal	Plastic
F/R Differential	45.25	36
Center Differential	43.75	34.5

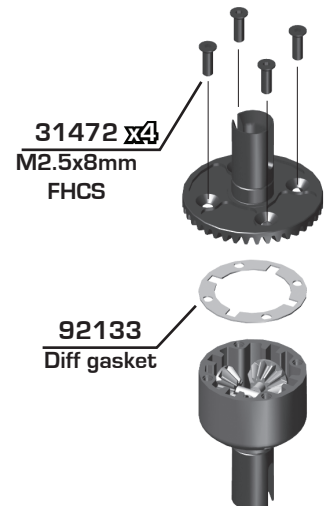
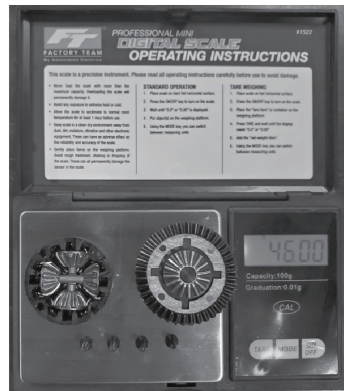

Build x2 (1 front, 1 rear)

**:: Bag 4 - Step 1**

**Build front gearbox**

**92324 x2**  
M5x10x4  
flanged bearing

**92319**  
Diff pinion  
gear shim,  
M5x6.5x1mm

**92142**  
Diff pinion  
gear

**92309**  
B74.2 front  
gearbox,  
inboard,  
#2

**91563 x2**  
M10x15x4  
bearing

**92139 x2**  
Diff shim

0 & 2 are included in kit.  
"2" gearbox for front,  
"0" height is optional.

Start by shimming the diff with one shim on either side of the diff. If the diff is tight when inserted into the gearbox, remove one shim from the ring gear side and add it to the diff case side.

**:: Bag 4 - Step 2**

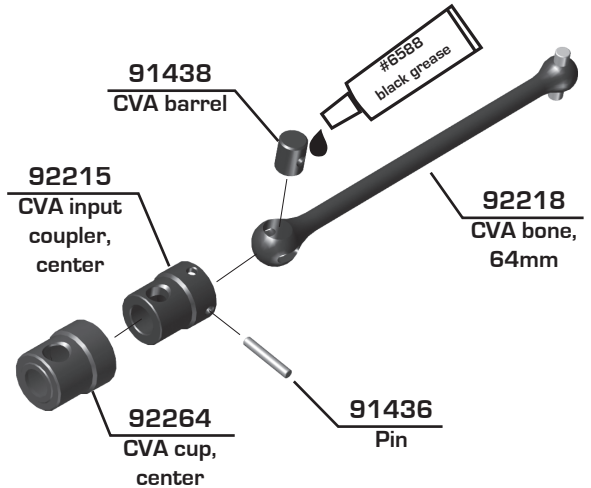
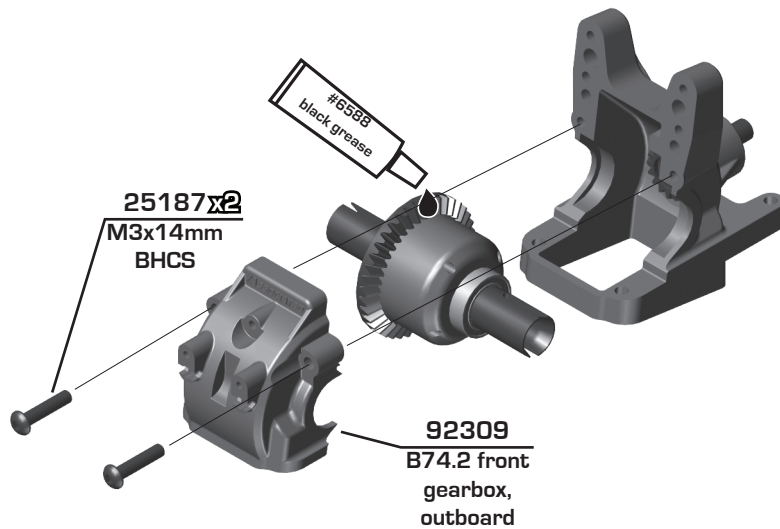

**:: Bag 4 - Step 3**

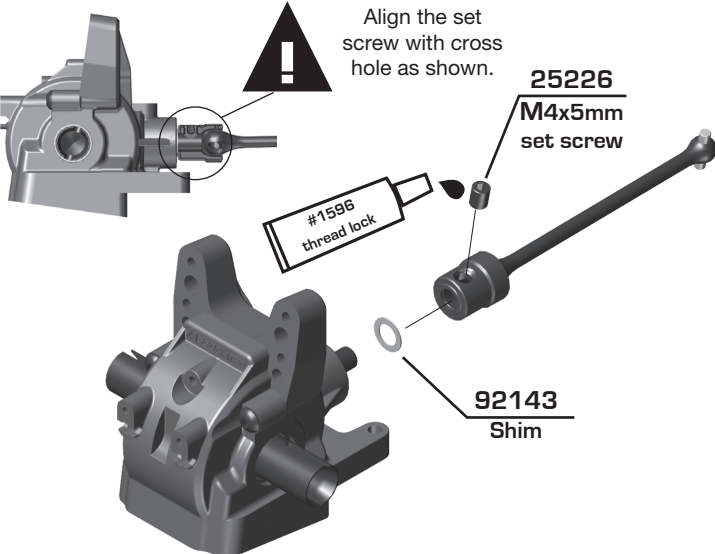

**Build rear gearbox**

**92324 x2**  
M5x10x4  
flanged bearing

**92311 x2**  
B74.2 rear  
gearbox pinion  
height insert,  
1 and 2

**92310**  
B74.2 rear  
gearbox,  
bottom

**92142**  
Diff pinion  
gear

**92319**  
Diff pinion  
gear shim,  
M5x6.5x1mm

Number shown on top of the insert after insertion should match the diff height desired. Kit setup: "2"

**:: Bag 4 - Step 4**

Start by shimming the diff with one shim on either side of the diff. If the diff is tight when inserted into the gearbox, remove one shim from the ring gear side and add it to the diff case side.

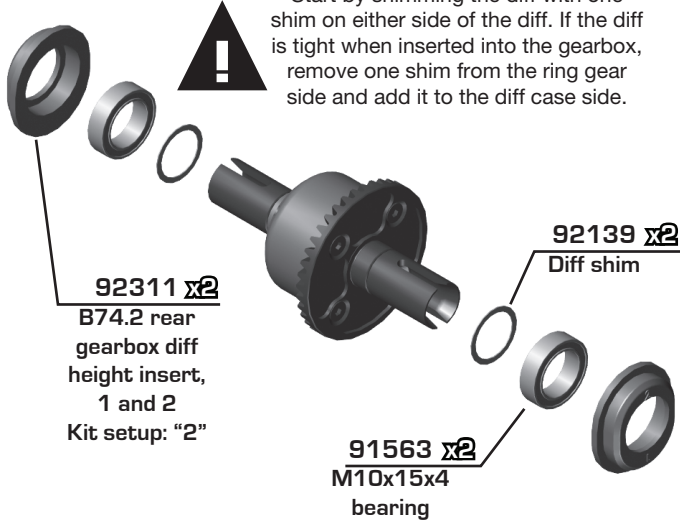

**92310**  
B74.2 rear gearbox, top

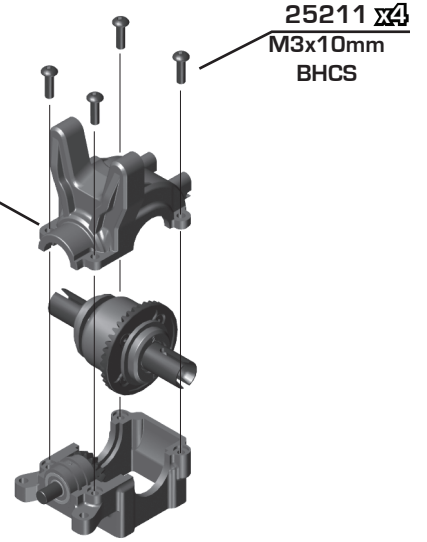

**!**  
Take extra care not to strip these screw holes out. Stripping the plastic will result in premature failure.

**:: Bag 4 - Step 5**

**!** Align the set screw with cross hole as shown.

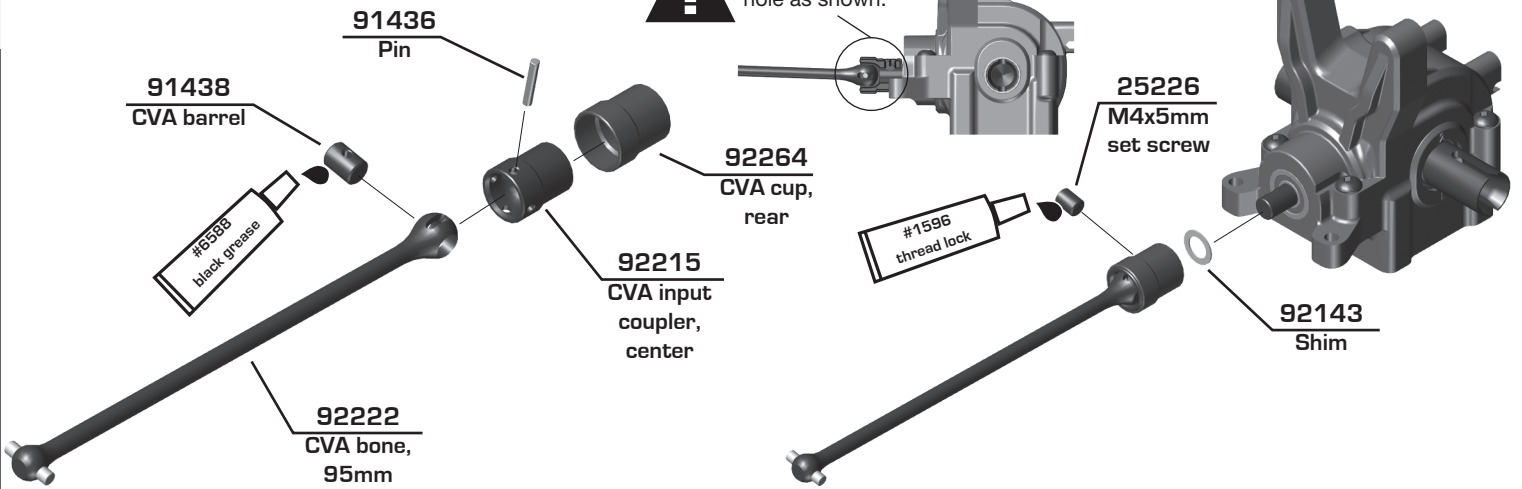

**:: Bag 4 - Step 6**

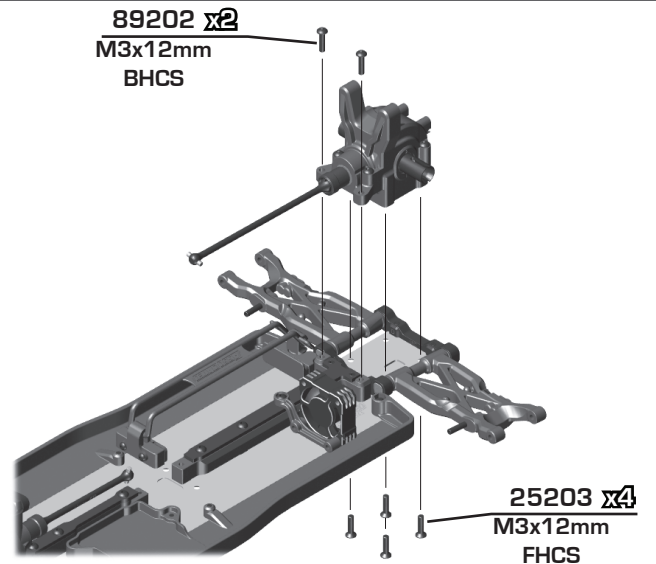
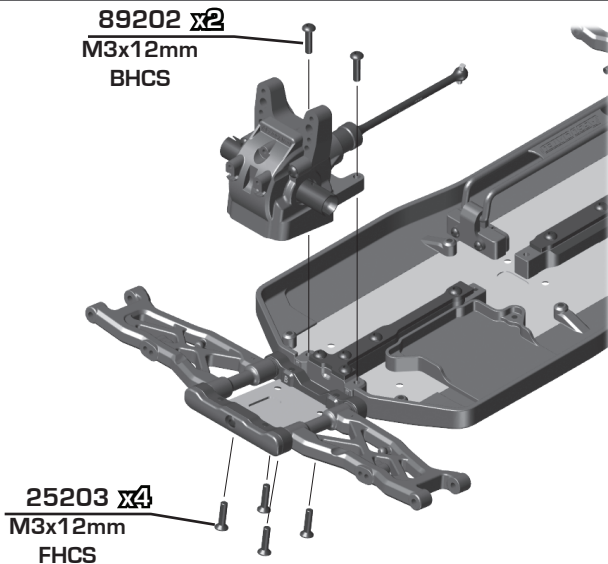

# FIND IT ON ASSOCIATEDELECTRICS.COM

## CARS & TRUCKS

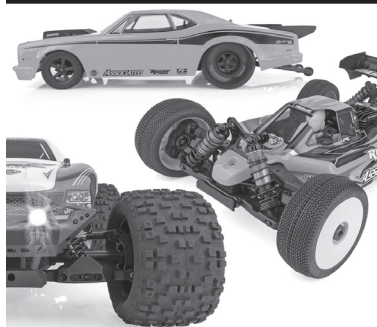

### Vehicle Spare Parts

GO TO:

**AssociatedElectrics.com** →  
**Team Associated tab** →  
**Cars & Trucks** →  
**Scroll to your vehicle** →  
**Parts & Accessories link**

## SETUP SHEETS & MANUALS



### Setups and Manuals

GO TO:

**AssociatedElectrics.com** →  
**Team Associated tab** →  
**Manuals & Setups** →  
**Scroll to your vehicle**

## A-TEAM APPS



### Tuning Guides & Tips

GO TO:

**AssociatedElectrics.com** →  
**Support** →  
**A-Team Apps**



**Associated Electrics, Inc.**

**21062 Bake Parkway Lake Forest, CA 92630 USA**

**call: (949) 544-7500 - fax: (949) 544-7501**

**Check out the following web sites for all of our kits, current products,  
new releases, setup help, tips, and racing info!**

**[www.AssociatedElectrics.com](http://www.AssociatedElectrics.com)**

## FOLLOW US ON SOCIAL MEDIA



**TeamAssociated**  
**ReedyPower**  
**ElementRC**



**@TeamAssociatedRC**  
**@ReedyPower**  
**@Element\_RC**



**@Team\_Associated**  
**@ReedyPower**