

#89565, 89566, 89567 Vertical Caster Blocks/Spindles Supplement

:: Vertical Spindle

!
*Racer Tip:
If the large bearing fit is too tight, grind the CVA cross pin in order to prevent a bearing bind.

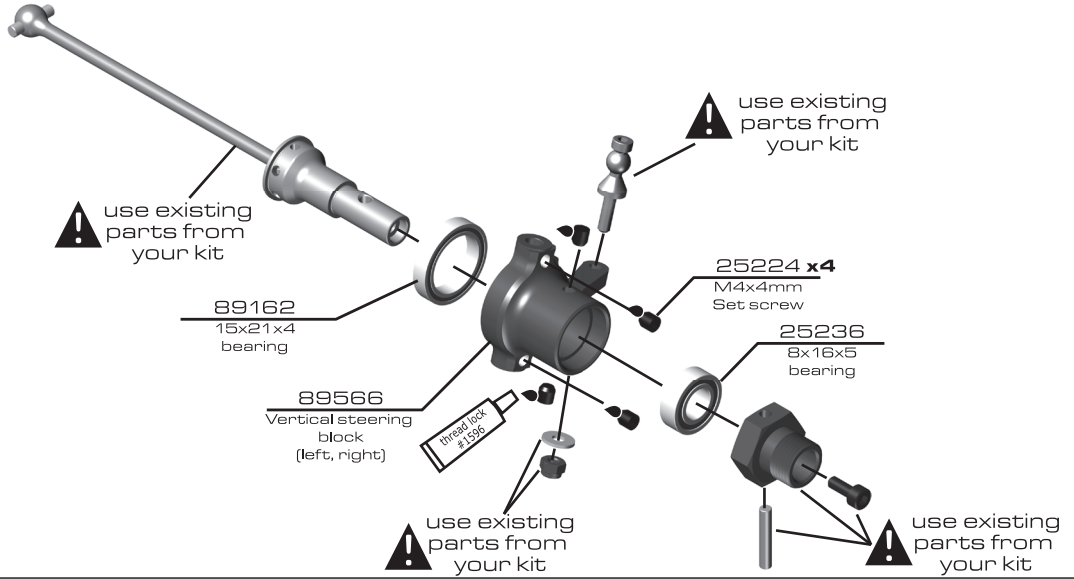

:: Vertical Caster Block and Spindle

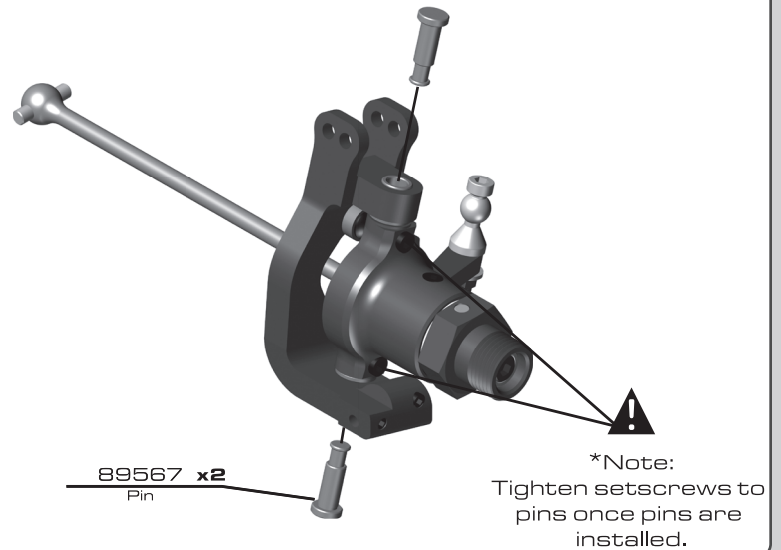
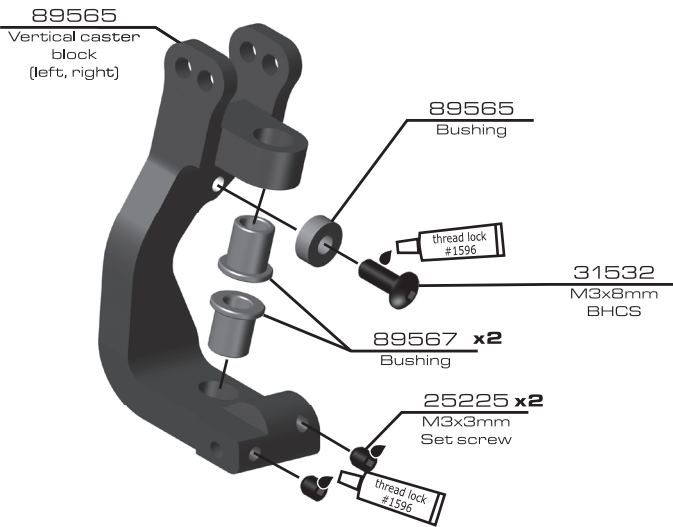

:: Vertical Caster Block and Spindle (cont.)

