

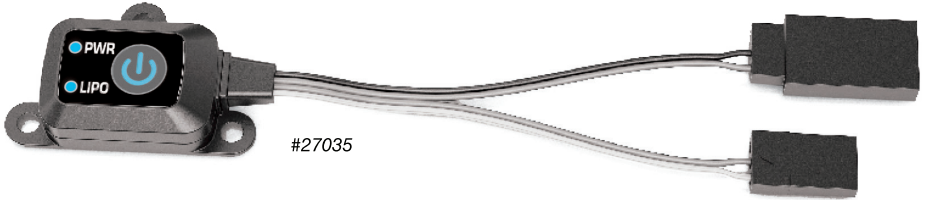

# ELECTRONIC POWER SWITCH

## OWNER'S MANUAL



Reedy's Electronic power switch is a reliable and versatile alternative for 1/8 racers fed up with failure-prone mechanical switches. Selecting LiPo mode activates the built-in low voltage protection to prevent over-discharge of your battery while a convenient battery capacity indicator displays real-time state of charge.

**Please read the following instructions before using your Electronic Power Switch.**

### FEATURES

- Compact design
- Reliable operation
- LiPo mode
- Capacity meter
- Dual mounting options

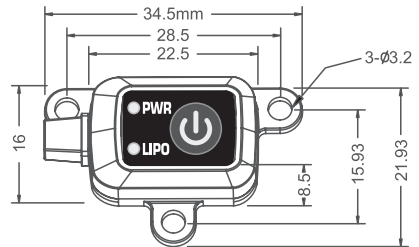

Dimensions with included Transponder Mount

### SPECIFICATIONS

Input Voltage	4-12V
Max. Current	10A
Battery Mode	NiMH, LiPo
Low Voltage Protection	6.2V (LiPo)
Operating Temperature	0-50°C
Weight	<7g

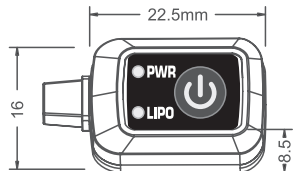

Dimensions without Transponder Mount

### WARRANTY

Your Reedy Electronic Power Switch is warranted to the original purchaser for 90 days from the date of purchase, verified by the sales receipt, against defects in material and workmanship. Product that has been mishandled, abused, used incorrectly, used for an application other than intended, or damaged by the user are not covered under warranty. Associated Electrics Inc. is not liable for any loss or damage, whether direct or indirect, incidental or consequential, or from any special situation, arising from the use, misuse, or abuse of this product.

## INSTALLATION

The switch can be installed in one of two ways. Option 1 is to use the included transponder mount which enables the switch to be mounted to the dedicated transponder mounting points found in many vehicles. Option 2 is to mount the switch in a convenient location using high-quality double-sided tape. Once mounted, plug the RX battery into the male switch plug and plug the female switch plug into your receiver's battery port.

### NIMH OPERATION:

To power ON in NiMH mode, press and hold the power button for one second. The PWR LED will turn on. To power OFF, press and hold the power button until all LEDs turn off. When powered ON, the PWR LED's color will indicate the remaining battery capacity.

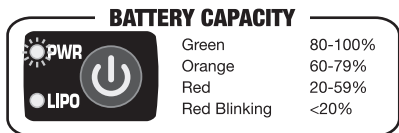
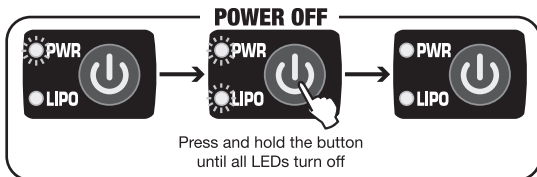
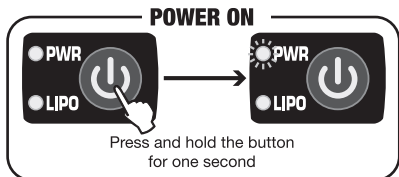

### LiPo OPERATION:

To power ON in LiPo mode, press and hold the power button for more than 3 seconds. Both the PWR and LIPO LEDs will turn on. To power OFF, press and hold the power button until all LEDs turn off. When powered ON, the PWR LED's color will indicate the remaining battery capacity.

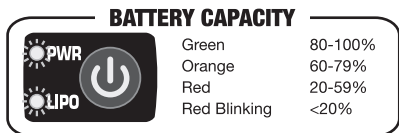
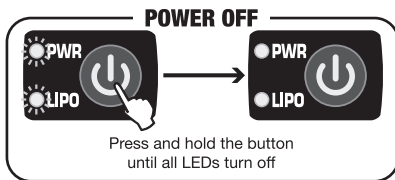
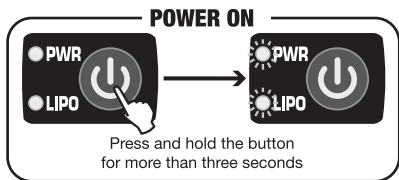

Associated Electrics, Inc. declares that this product complies with the essential requirements and other relevant provisions of the European directive 2014/30/EU.



The crossed-out wheeled bin means that within the European Union, this product must be taken to a separate waste collection facility at the product's end of life. Do not dispose of this product as unsorted municipal waste.