

# SR7

1:27 Scale Ready-To-Run  
2WD Electric On Road Car

SCALE 1:27 VEHICLE  
READY TO RUN  
2 WHEEL DRIVE  
ELEC. POWERED  
ON ROAD  
2.4GHZ  
PRE-PAINTED



1:27 Scale Ready-To-Run 2WD Electric On Road Car Manual



CHAMPIONS *by* DESIGN

[AssociatedElectrics.com](http://AssociatedElectrics.com)

TEAM ASSOCIATED

## :: Introduction

Thank you for purchasing this Team Associated product. This assembly manual contains instructions and tips for building and maintaining your new vehicle. Please take a moment to read through the manual and familiarize yourself with the steps. We are continually changing and improving our designs; therefore, actual parts may appear slightly different than the illustrations. New parts will be noted on supplementary sheets located in the appropriate parts bags. Check each bag for these sheets before you start to build.

## :: SR27 RTR Features

- Set-up for balanced handling performance out of the box
- Accepts rechargeable AAA size batteries
- Adjustable front and rear body mounts when removed allows for hard body mounting
- High-detail wheels with specific offsets for a balance of looks and performance
- Integrated electronic speed control and receiver with gyro
- Adjustable track width: Wide and Narrow front-end pieces included
- Adjustable wheelbase: Mid- and Rear-Motor pieces included
- Adjustable gear ratio options included
- Gear differential included
- Stand-alone servo with servo saver
- Metric hardware used throughout
- Tools included in box (1.3mm and 1.5mm L-wrenches, 4.0mm/5.5mm nut driver)
- Designed to accept many aftermarket parts for this category
- Metal ball bearings included
- Licensed highly detailed polycarbonate bodies

## :: Additional

Combo Items and features:

#27204 Reedy 114SN NiMH AA/AAA Charger

Features:

- Suitable for AA/AAA NiMH/NiCd rechargeable batteries
- Charges 1-4 batteries simultaneously
- LED charge status indicators
- Alkaline battery detection
- Compact size

Specifications:

Input: DC 5V, 2A

Output: DC 1.2V 1000mA +/- 15%

Battery Type: 1.2V AA-AAA NiMH/NiCd Rechargeable

Charge Rate: 1.0A x4

Dimensions (mm): 94 x 63 x 34

Weight (g): 65

Usage environment: 0-35°C, humidity ≤95%

Storage environment: 0-60°C, humidity ≤85%

#27398 Reedy AAA 800mAh 1.2V NiMH Rechargeable Batteries (x4)

Long Lasting – High Power Reedy's AAA Rechargeable NiMH batteries feature high capacity and power output for your favorite RC model. They also offer excellent performance in digital cameras, portable electronics, or any device that uses AAA batteries and can benefit from extended battery life and/or maximum power output.



Associated Electrics, Inc.  
21062 Bake Parkway.  
Lake Forest, CA 92630





Customer Service  
Tel: 949.544.7500  
Fax: 949.544.7501

**:: Hardware - 1:1 Scale View**

**Button Head (bhcs)**

	1.5x4mm (21824)
	2x5mm (21824)
	2x10mm (21807)
	2x12mm (21824)



**Shims and Washers**

	3.1x5x0.2mm (21808)
	2x6x2.5mm (21808)

**Nuts (lock/plain)**

	Wheel Nut (21809)
---	-------------------

**Ball Bearings**

	2x6x2.5mm (21808)
	3x6x2.5mm (21825)

**Notes:**

## :: Table of Contents

1.....	Cover	10.....	Body Mounts Install
2.....	Introduction	10.....	Wheel and Tire Install
3.....	1:1 Hardware "Fold Out"	11.....	Batteries Install
4.....	Table of Contents	11.....	SR27 Side View
5.....	Electronics Install	12.....	240z Body Install
6.....	Steering Install	13.....	400z Body Install
7.....	Rear End Install	14.....	Tuning Tips
9.....	Shock Install		

## :: Notes



This symbol indicates a special note or instruction in the manual.

X2

This symbol indicates the number of the same part that is required.



This symbol indicates the order within a step to assemble parts.



This symbol indicates there are optional FT parts available



This symbol indicates a Racers Tip.



This symbol indicates where Thread Lock Adhesive should be applied. \*not included



This symbol indicates where Diff Fluid should be applied.



This symbol indicates where Shock Fluid should be applied.



This symbol indicates where FT Silicone Grease should be applied. \*not included



This symbol indicates where FT Diff Lube should be applied. \*not included



This symbol indicates where Black Grease should be applied.



This symbol indicates where Green Slime can be applied. \*not included



There is a 1:1 hardware foldout page in the front of the manual. To check the size of a part, line up your hardware with the correct drawing until you find the exact size. Each part in the foldout has a number assigned to it for ordering replacement parts.

Associated Electrics, Inc.  
21062 Bake Parkway.  
Lake Forest, CA 92630



Customer Service  
Tel: 949.544.7500  
Fax: 949.544.7501

:: Electronics Install - Step 1

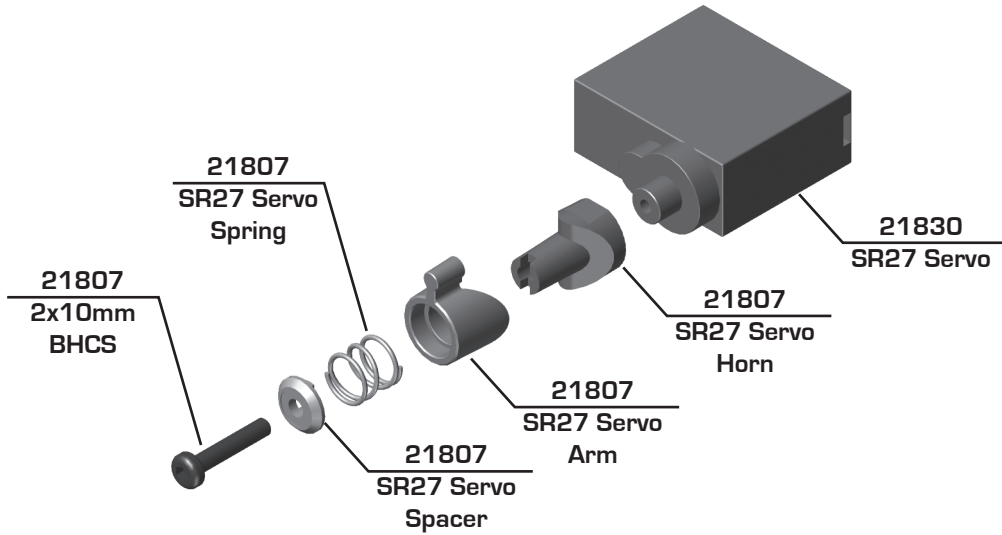

:: Electronics Install - Step 2

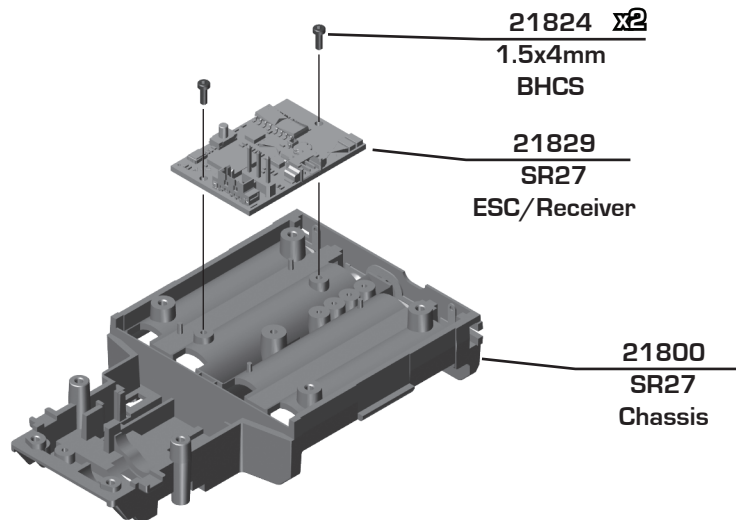

:: Electronics Install - Step 3

NARROW VERSION

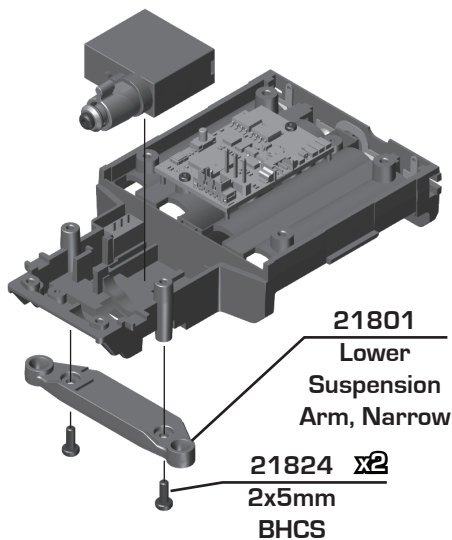

WIDE VERSION

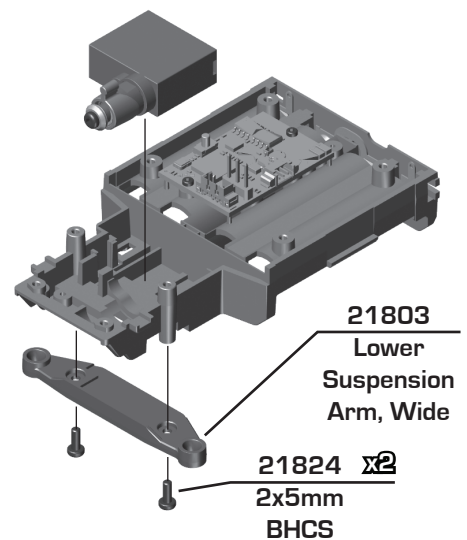

**:: Steering Install - Step 1**

NARROW VERSION

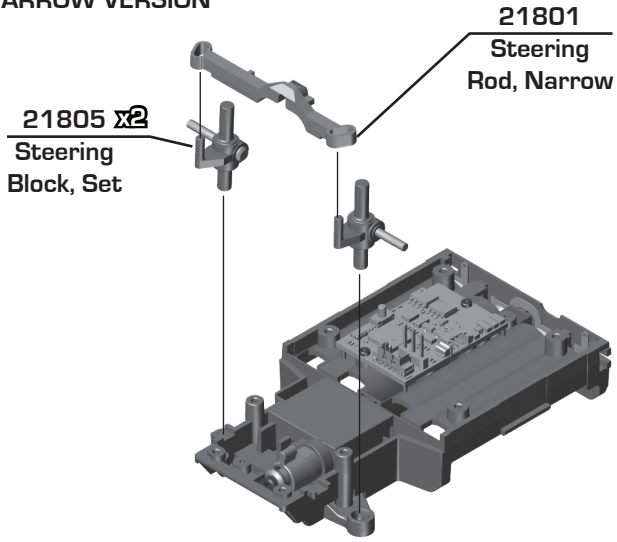

WIDE VERSION

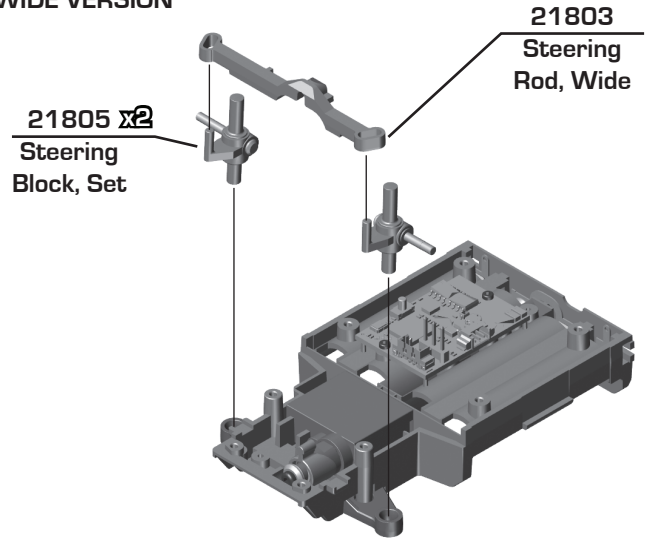

**:: Steering Install - Step 2**

NARROW VERSION

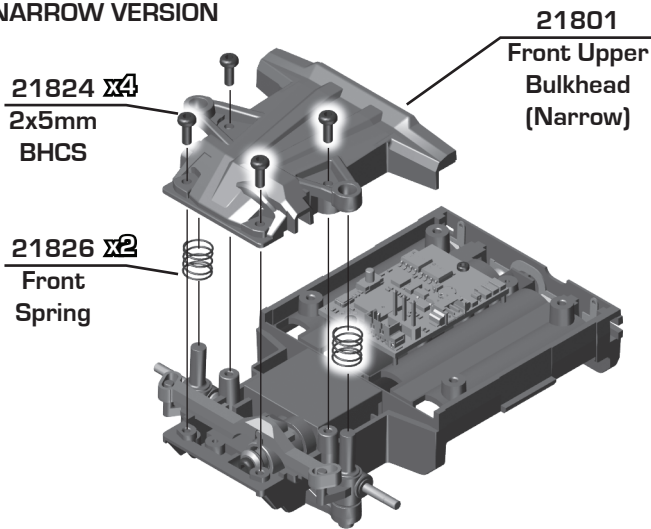

WIDE VERSION

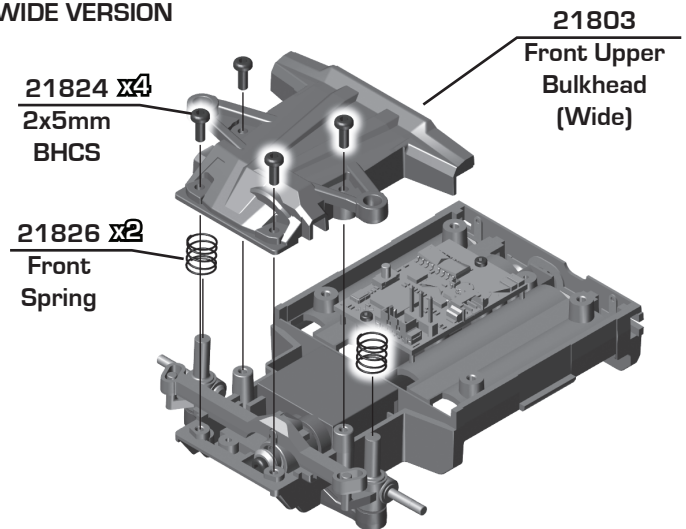

**:: Steering Install - Step 3**

NARROW VERSION

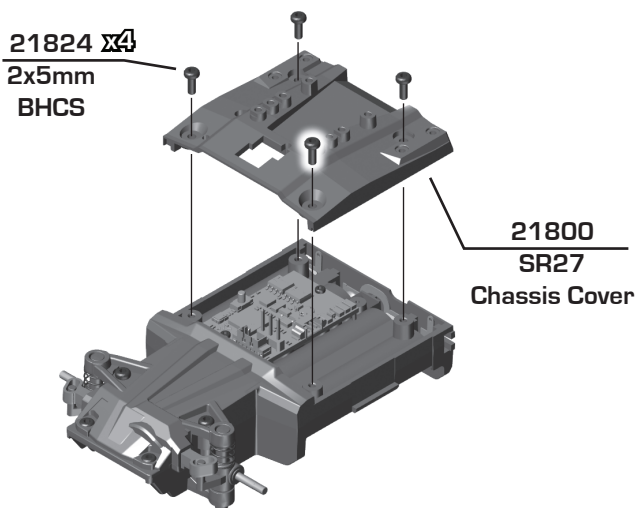

WIDE VERSION

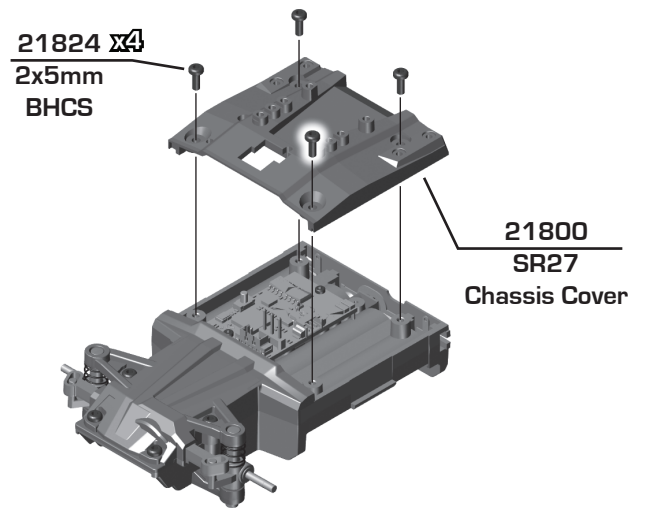



⚡ Rear End - Step 1

REAR MOTOR

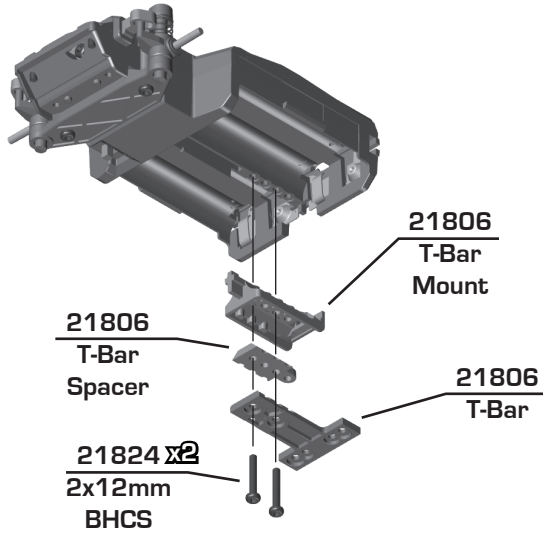

MID MOTOR

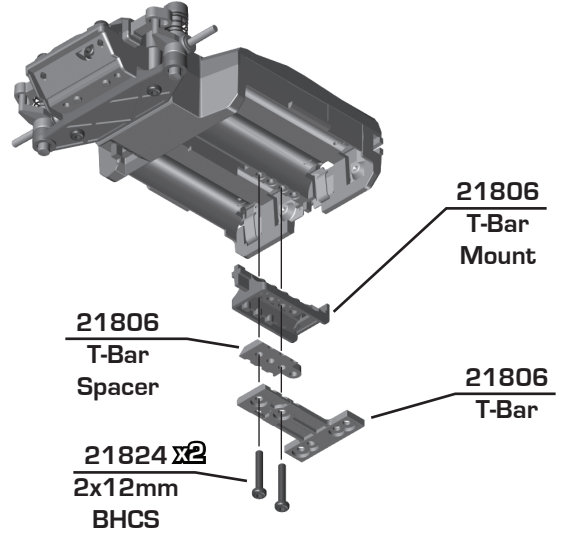

⚡ Rear End - Step 2

REAR MOTOR



Note: Motor plates are marked on the sides with their corresponding pinion size.

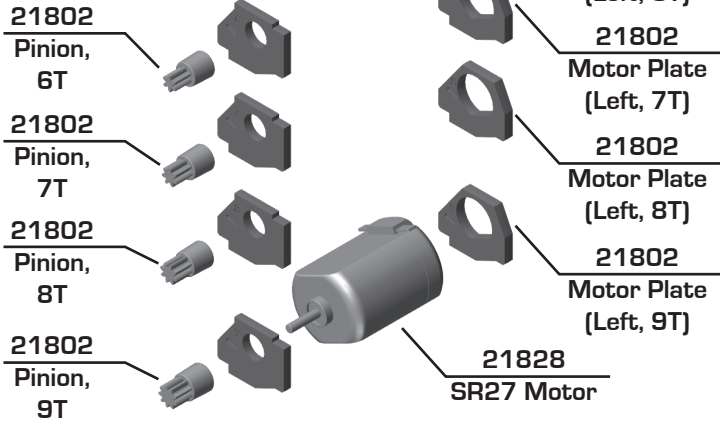

MID MOTOR



Note: Motor plates are marked on the sides with their corresponding pinion size.

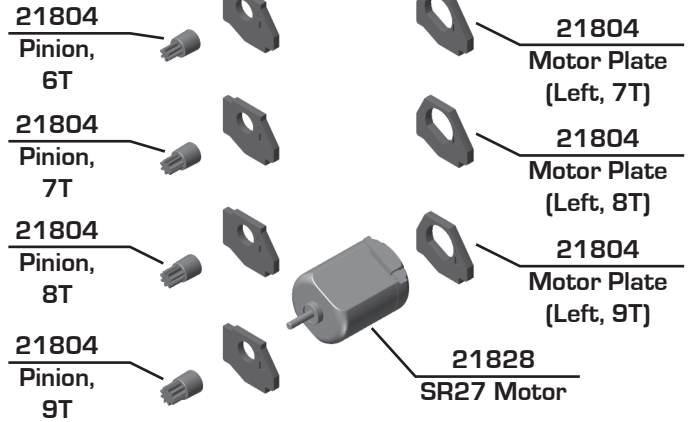

⚡ Rear End - Step 3

REAR MOTOR

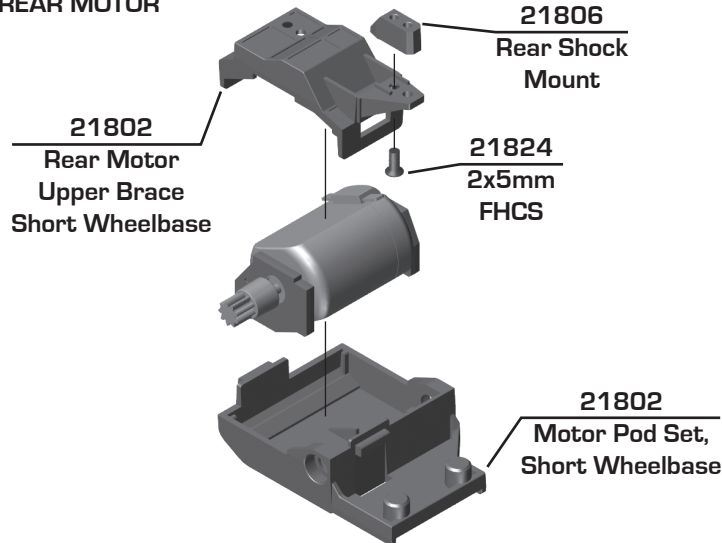

MID MOTOR

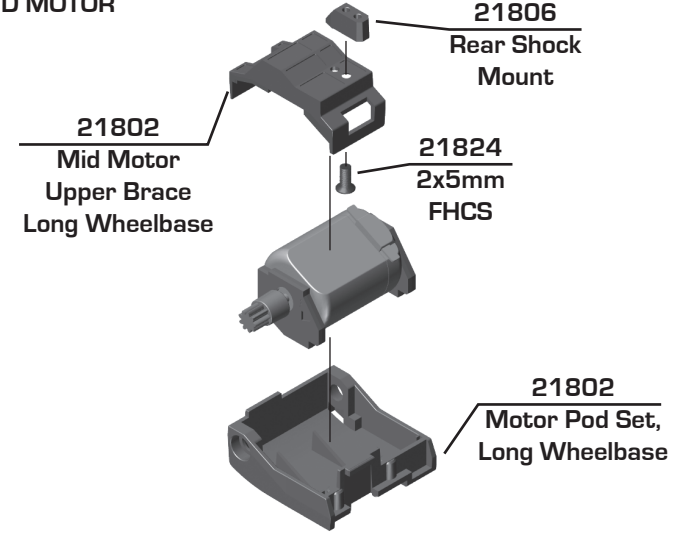

⚡ Rear End - Step 4

REAR MOTOR

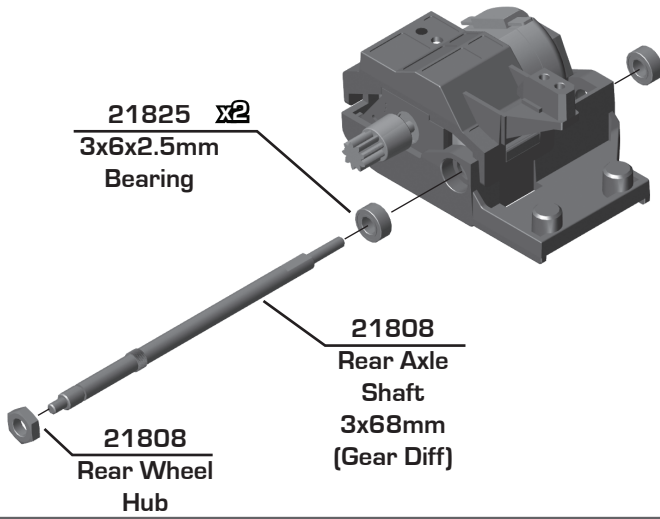

MID MOTOR

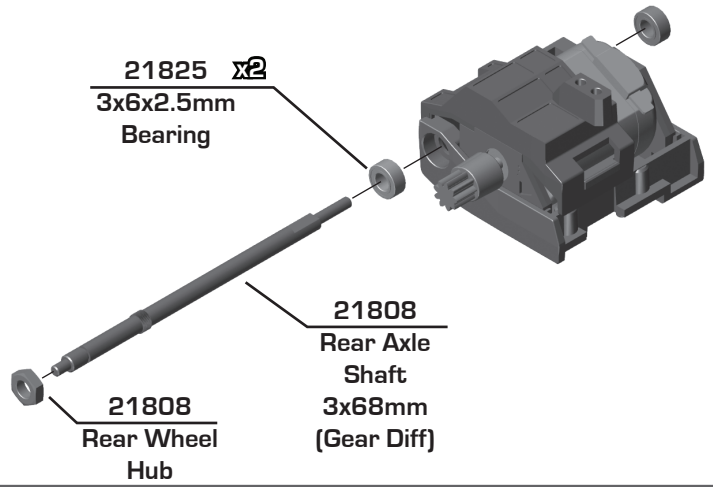

⚡ Rear End - Step 5

REAR MOTOR

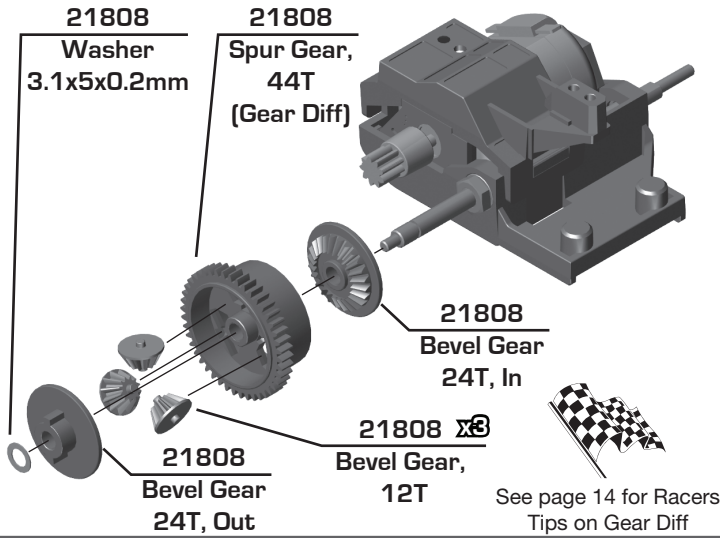

MID MOTOR

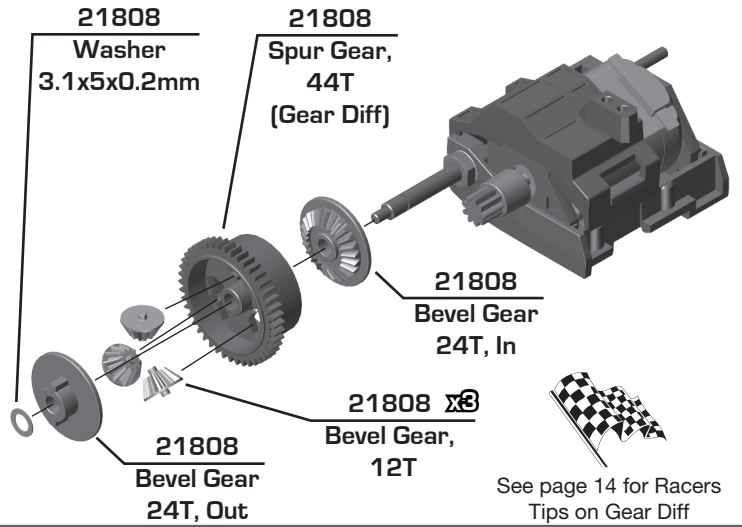

⚡ Rear End - Step 6

REAR MOTOR

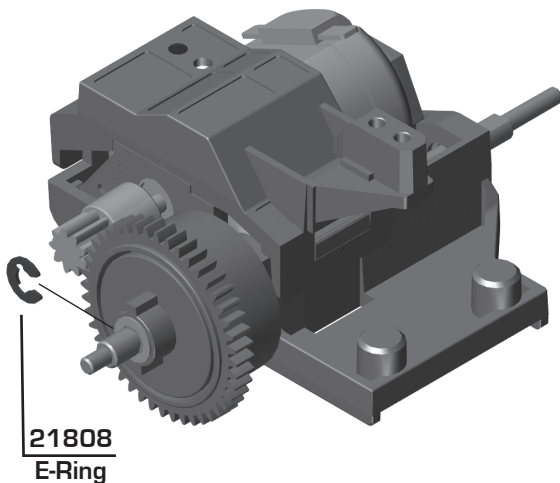

MID MOTOR

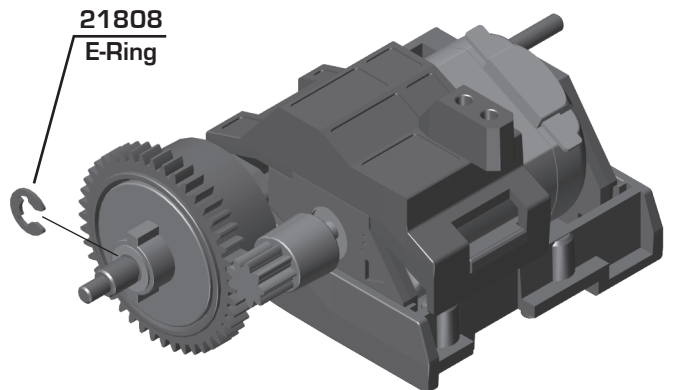



∴ Rear End - Step 7

REAR MOTOR

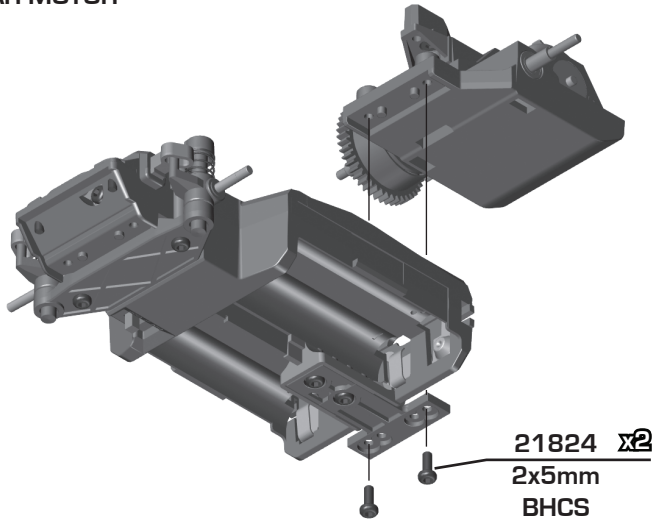

MID MOTOR

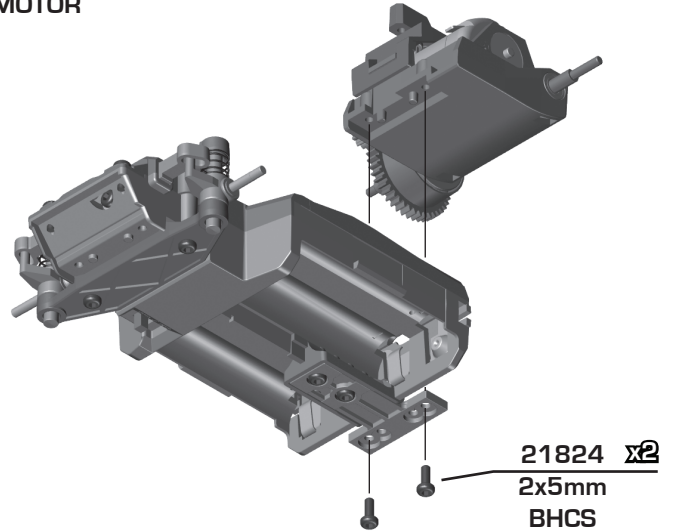

∴ Shock Install - Step 1

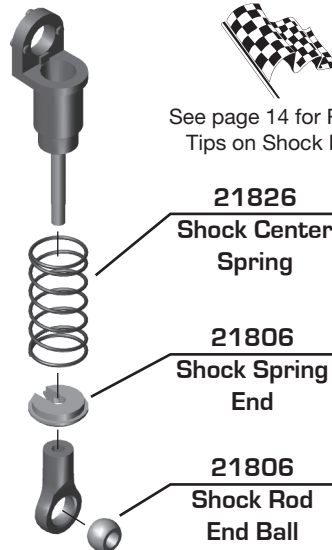
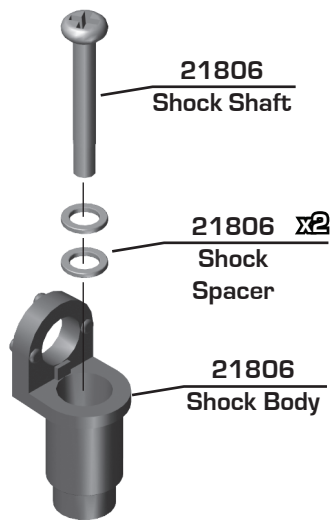

  
See page 14 for Racers  
Tips on Shock Lube

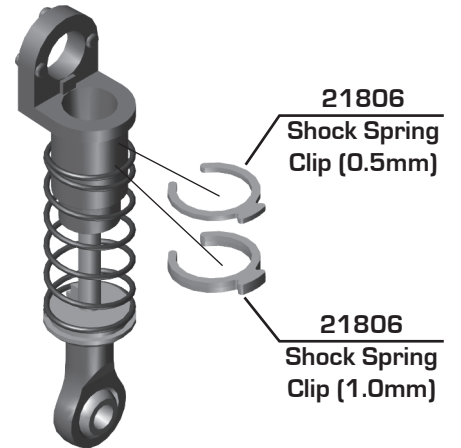

∴ Shock Install - Step 2

REAR MOTOR

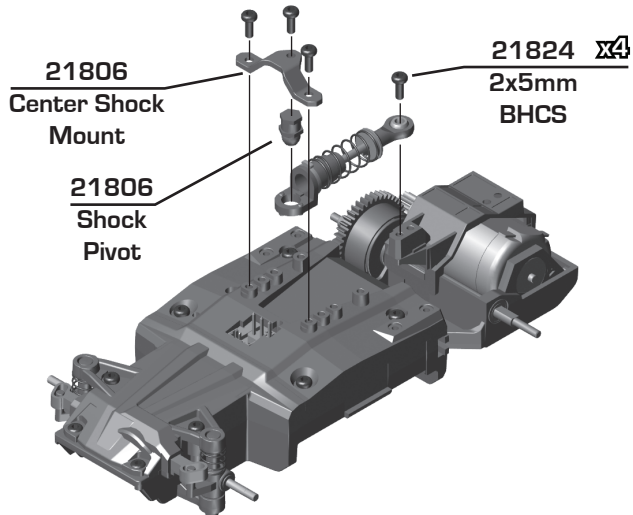

MID MOTOR

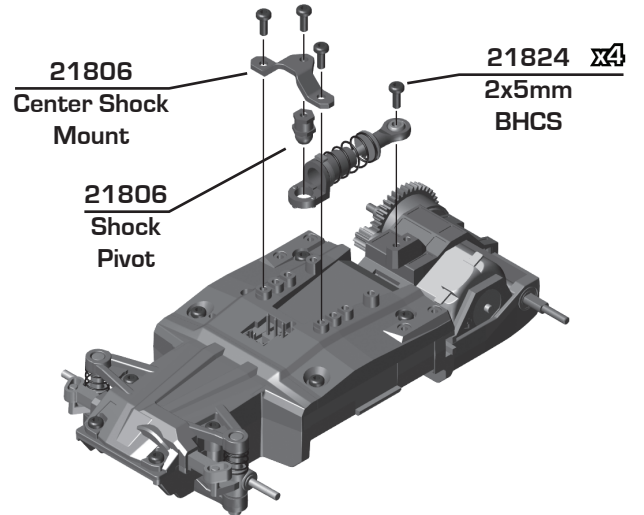

## :: Body Mounts Install - Step 1

REAR MOTOR

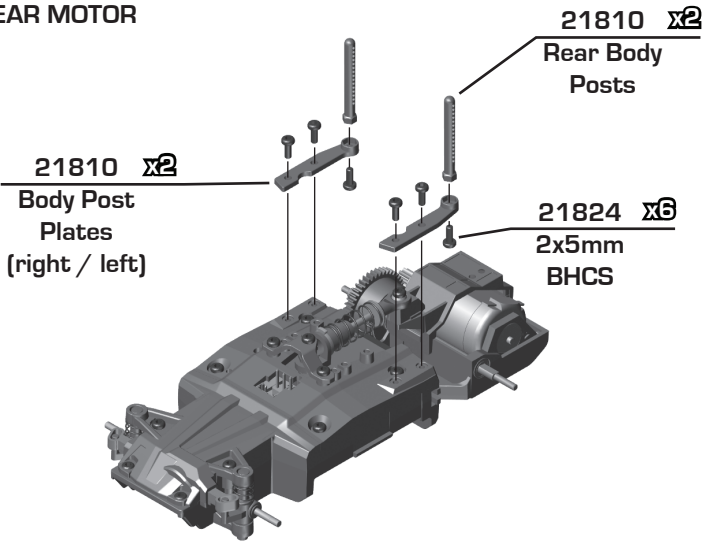

MID MOTOR

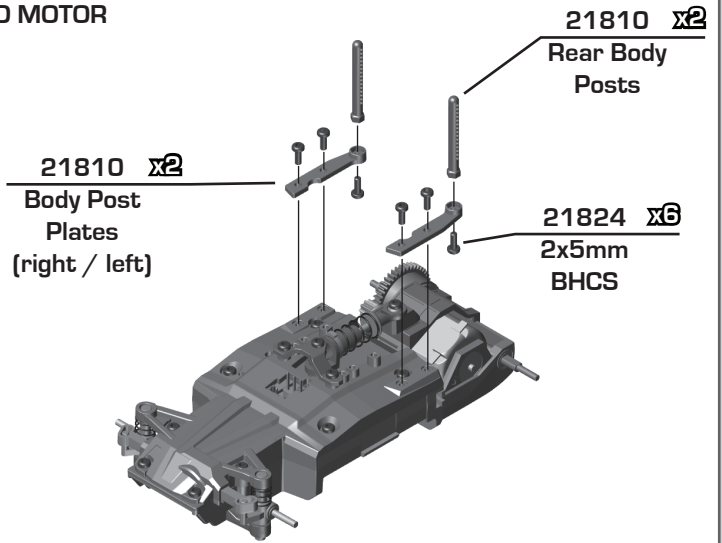

## :: Body Mounts Install - Step 2

REAR MOTOR

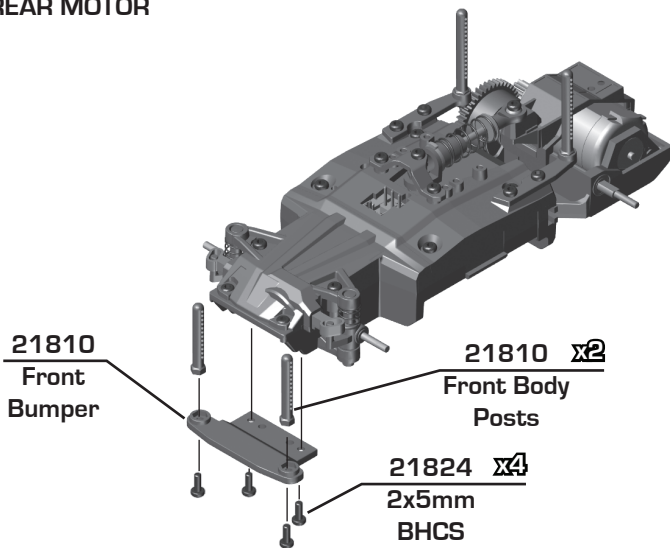

MID MOTOR

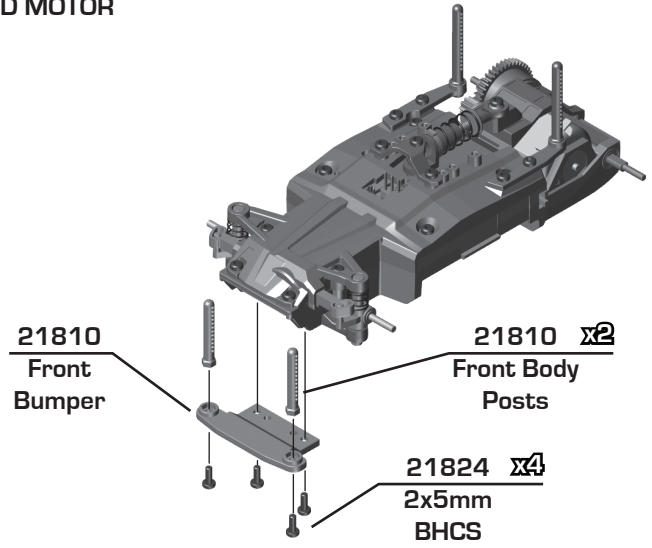

## :: Wheel and Tire Install - Step 1

REAR MOTOR

### Wheels / Tires

#21815	Turbine Wheel and Tire Set
#21820	12-Spoke Wheel and Tire Set
#21821	Tire Set, 8.5mm - 35 Shore
#21822	Tire Set, 11mm - 20 Shore
#21823	Tire Set, 8.5mm - 20 Shore

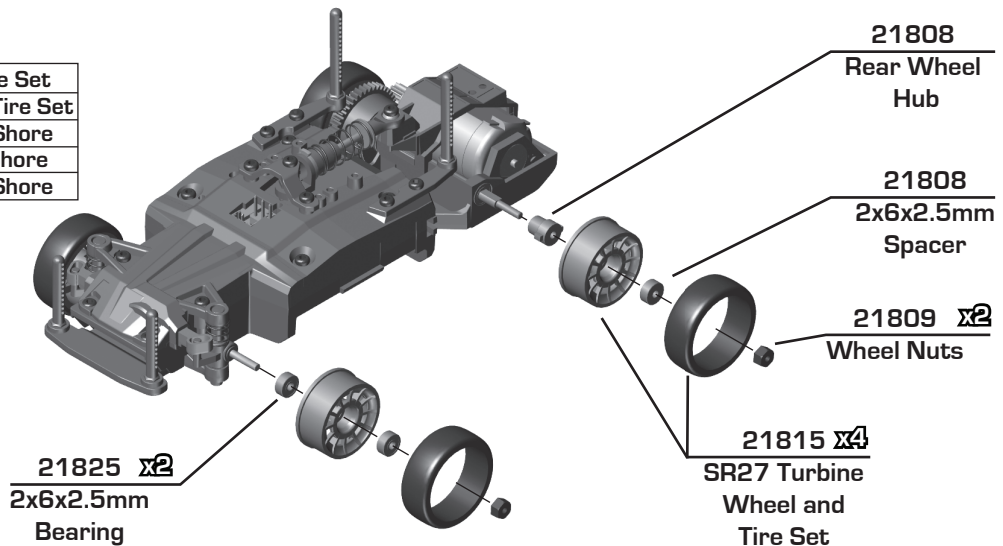

See page 14 for Racers  
Tips on Tires

Wheel and Tire Install - Step 2

MID MOTOR

Wheels / Tires

#21815	Turbine Wheel and Tire Set
#21820	12-Spoke Wheel and Tire Set
#21821	Tire Set, 8.5mm - 35 Shore
#21822	Tire Set, 11mm - 20 Shore
#21823	Tire Set, 8.5mm - 20 Shore



See page 14 for Racers  
Tips on Tires

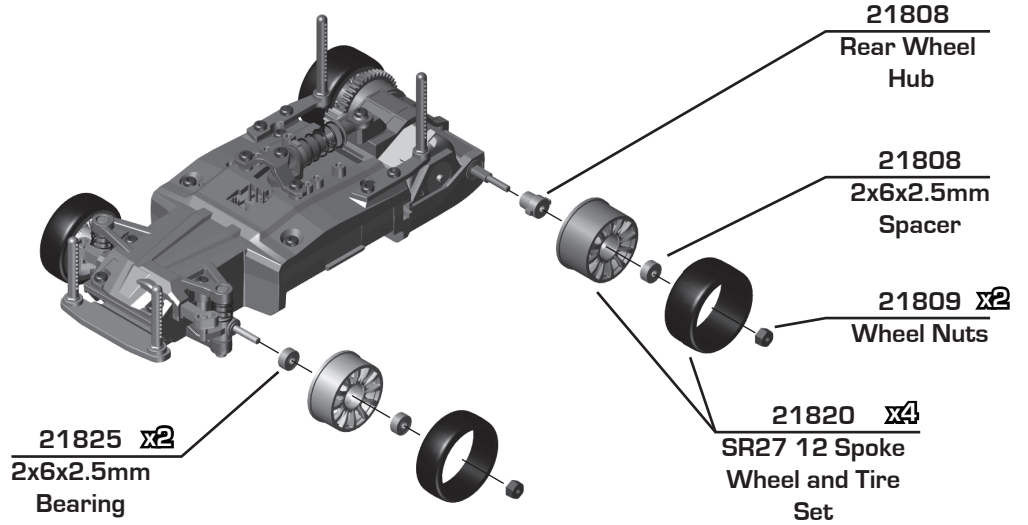

Batteries Install - Step 1

REAR MOTOR

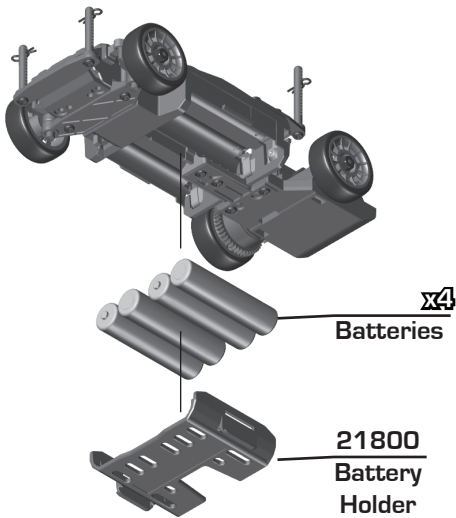

MID MOTOR

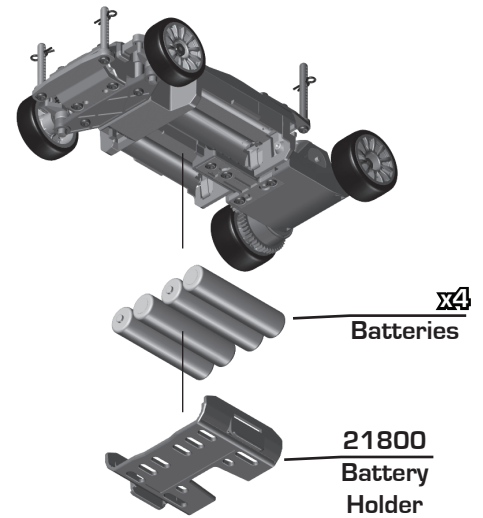

SR27 Side View

REAR MOTOR

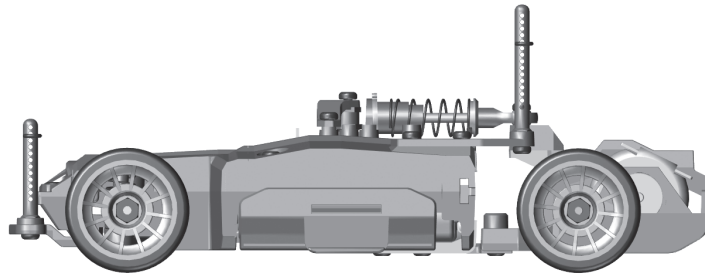

MID MOTOR

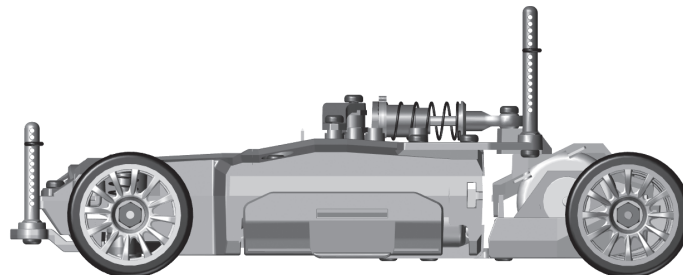

## :: 240z Body Install - Step 1

### REAR MOTOR

#### Bodies

#21811	Datsun 240z Body, Green
#21812	Datsun 240z Body, Clear
#21814	Datsun 240z Body, Red
#21833	Datsun 240z Body, White

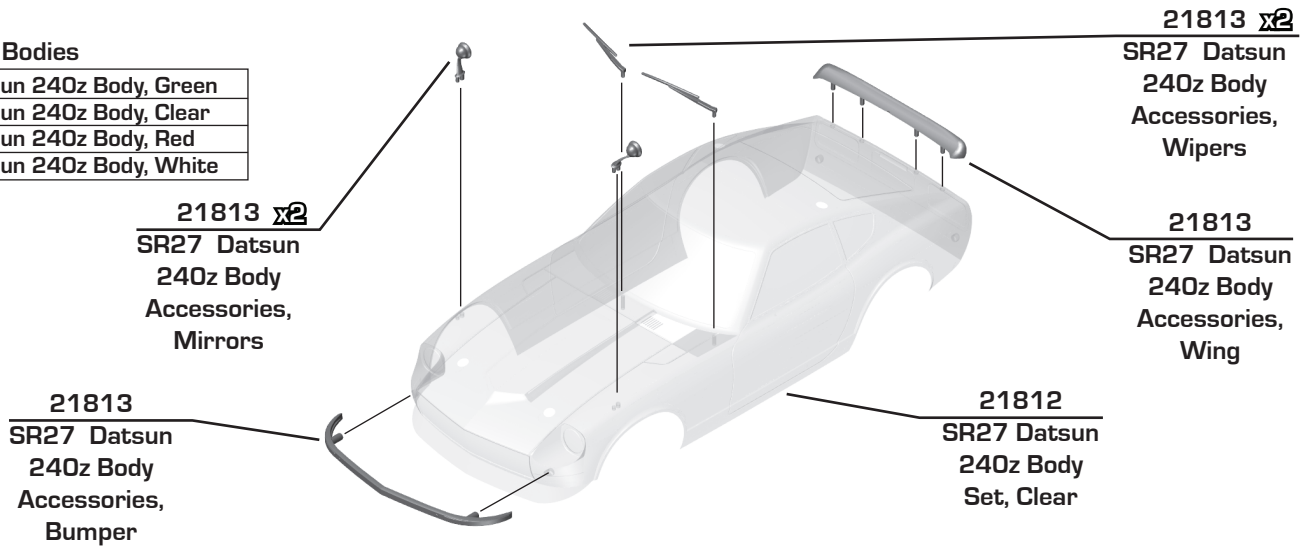

## :: 240z Body Install - Step 2

### REAR MOTOR

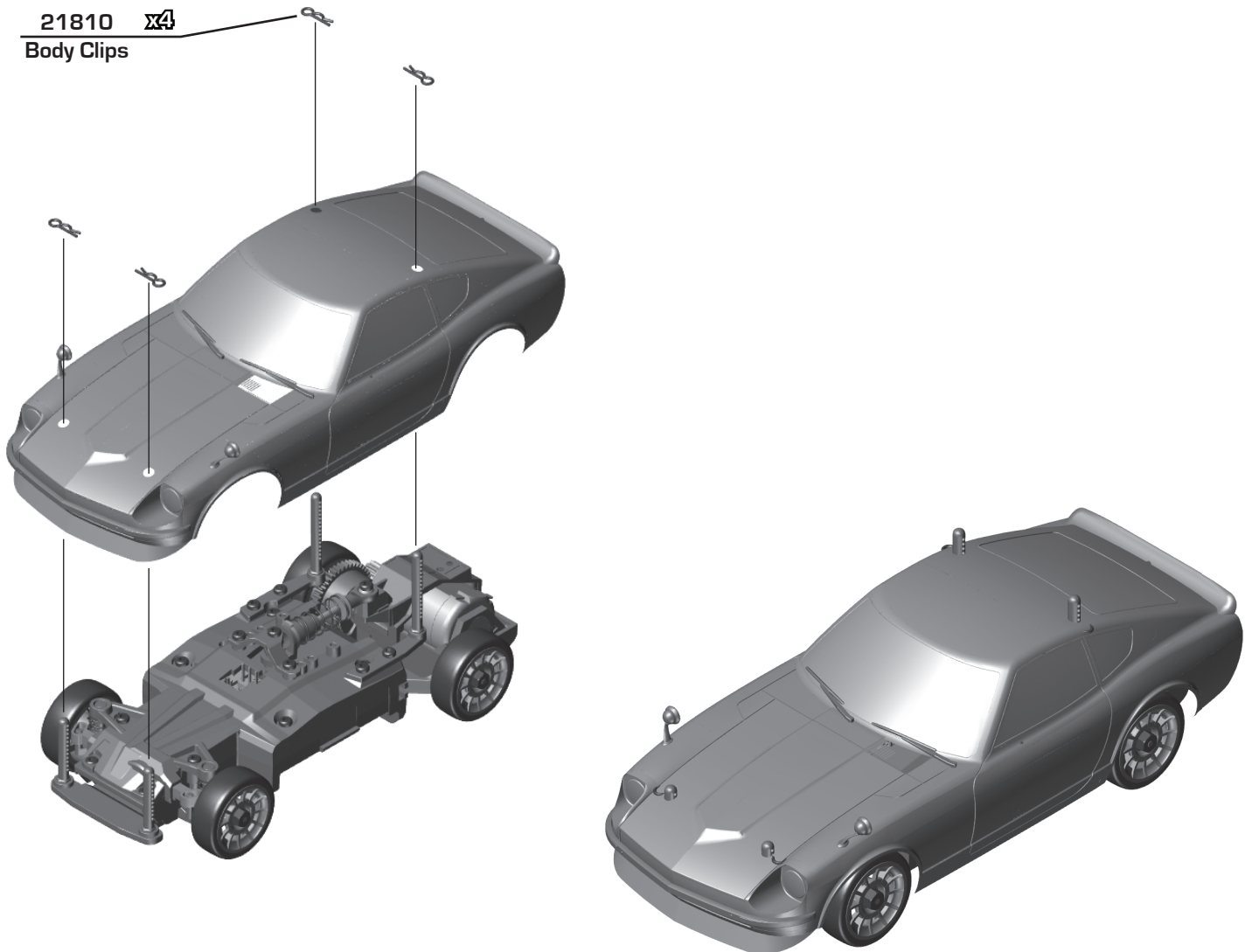

⚡ 400z Body Install - Step 1

MID MOTOR

Bodies

#21817	2023 Nissan Z Body, Clear
#21831	2023 Nissan Z Body, Yellow
#21832	2023 Nissan Z Body, Blue



⚡ 400z Body Install - Step 2

MID MOTOR

21810 x4  
Body Clips

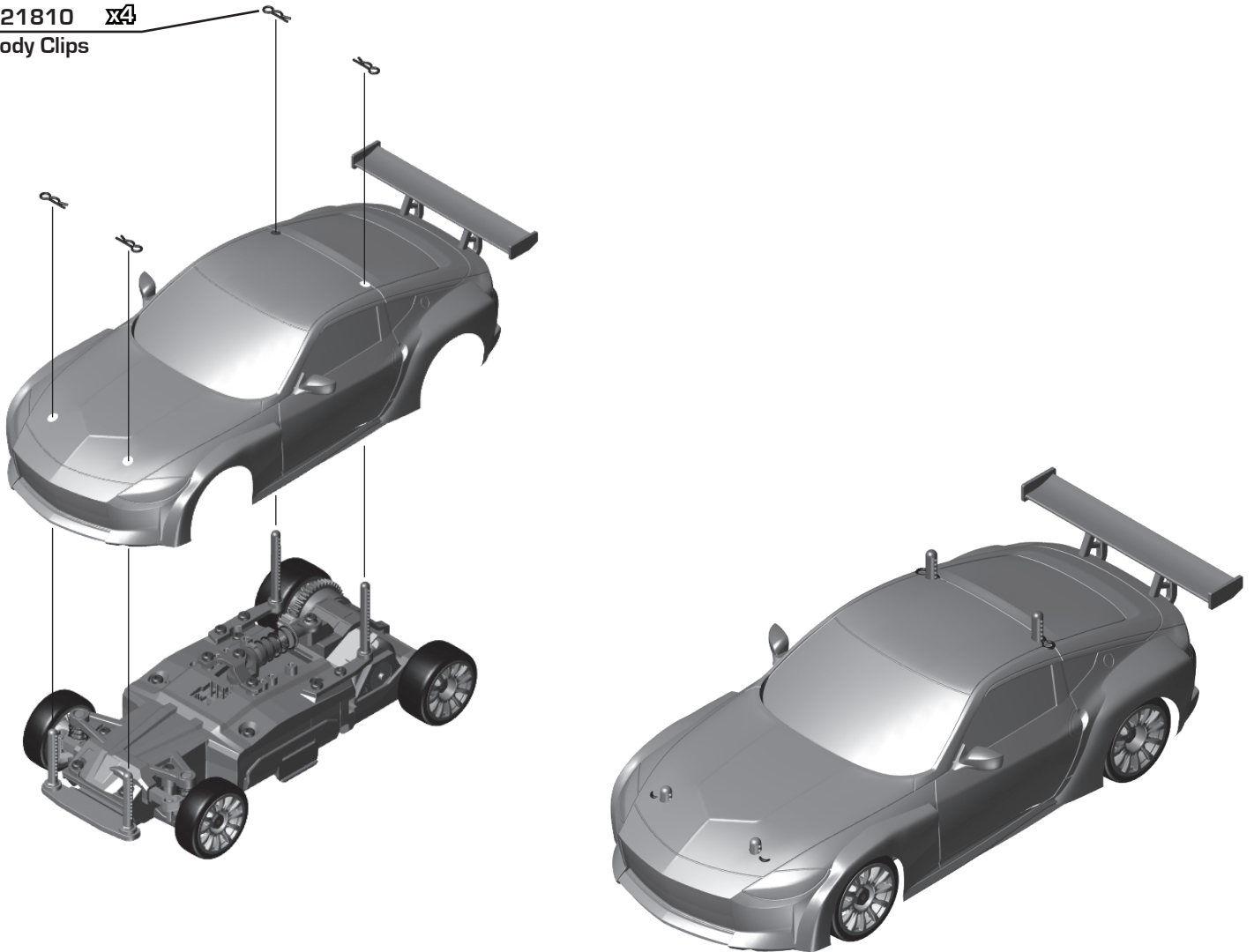



## :: SR27 Racer Tips

### Tires:

- Aftermarket tires recommended for track use
  - Check with your local track which tires are popular
- Tire tape or gluing the tires to the wheels is suggested for track use

### Steering Servo:

- Make sure the steering servo is secured to chassis and can't move. If the servo can move it will result in changing steering trim and the car will not go straight after hitting barriers.
  - The servo should be secured from factory but may need a drop of hot glue to secure it in place tightly

### Gearing:

- There are four pinion gear options for the SR27. Which gearing is used will depend on the size of track and the features it has. Lower tooth count pinions will provide faster acceleration with a lower top speed while higher count pinions have a higher top speed and smoother but slower acceleration.
  - Small Tracks w/ Short Straights: 6T Pinion
  - Medium Tracks w/ Short Straights: 7T Pinion
  - Medium Tracks w/ Long Straights: 8T Pinion
  - Large Tracks w/ Long Straights: 9T Pinion

### Shock Limiters:

- There are small plastic washers included with the SR27. These washers can be used to limit the down travel of the center shock resulting in less pod droop. The RTR should come with these already installed and this is the preferred setting for RCP tracks.
  - More Droop: More stability and better bump handling
  - Less Droop: Faster weight transfer resulting in more corner speed
  - Engineering at AE have found that setting the rear pod droop horizontal with the bottom of the main chassis or slightly below is the best for RCP tracks.

### Shock Lube:

- It is recommended to use a high viscosity (FT 30K Diff Fluid) for the center friction shock
  - Simply add oil to the shock shaft and work the shock up and down. Apply more if needed.
  - This will remove unwanted oscillation that can make the car unpredictable.
- It is also recommended to apply high viscosity silicone fluid (FT 30K Diff Fluid) to the front king pins where they slide through the upper arm.

### Diff Lube:

- Applying varying levels of black grease to the gear differential is recommended for improving performance and consistency (Note: aftermarket tires recommended for this step)
  - Small amount (just wetting the gears) will improve the consistency of the differential action
  - Larger amounts (packing grease into the diff case) will greatly improve on-power stability and consistency but too much can lead to loss of traction exiting tight corners and locking the rear tires up on full brakes.
  - Avoid overfilling the diff. Overfilling the diff will make a mess and can leak on to track surface.

### Wheel Nuts:

- Be sure not to overtighten the wheel nuts
- Front tires should spin freely with minimal side to side movement
- Rear wheels should spin freely allowing the differential to work properly

### Maintenance:

- Clean the car after use with a brush or light application of compressed air
- Look over the car and check that everything is in good working order
- Oil bearings and re-lube items listed above after 45 minutes of use for a consistent feeling car