

Front Suspension:

Ride Height:	27mm
Camber:	-1.5°
Toe:	-1.0°
Anti-Roll Bar	
Size:	2.3mm black
Gap:	2.3mm
Ackerman	
Notes:	1 2 3 4 5
Drive Shaft:	CVA: <input checked="" type="checkbox"/> Universal: <input type="checkbox"/>
Chassis Brace:	Short: <input type="checkbox"/> Long: <input checked="" type="checkbox"/>
Hex:	+1mm #81079
Notes:	

Caster Shim:	0.9mm
Upper Ball Type:	Steel
Upper Ball Shim:	0.7mm
Washers:	0
Lower Ball Shim:	0.7mm

Wheelbase Shim:	1mm
Lower Ball Type:	Steel
Upper Arm Mount:	
Arm Mount A:	
Arm Mount B:	

Rear Suspension:

Ride Height:	28mm
Camber:	-2.5°
Anti-Roll Bar	
Size:	2.7mm blue
Gap:	0
Drive Shaft:	CVA: <input checked="" type="checkbox"/> Universal: <input type="checkbox"/>
Chassis Brace:	Short: <input type="checkbox"/> Long: <input checked="" type="checkbox"/>
Hex:	+1mm #81079
Notes:	

Hub Shim:	2.5mm
Wheelbase Shim:	1mm

Arm Mount C:	
Arm Mount D:	

Electronics:

Radio:	
Servo:	
EPA: Throttle:	% Brake: %
EXPO: Throttle:	% Brake: %
ESC:	
Motor:	
Battery:	
Notes:	

Differential:

	Fluid	Gear Set	Planet O-Rings
Front:	7,000	HTC	0
Center:	7,000	HTC	0
Rear:	4,000	HTC	0

Gearing:

Spur Gear:	46	Pinion:	14
Notes:			

Shocks:

	Front	Rear
Piston:	8 x 1.2 T	8 x 1.2 T
Fluid:	40wt	35wt
Cap:	Bleeder	Bleeder
Rebound:	0	0
Spring:	5.5 (Blue)	4.3 (Blue)
Free Length:	104mm	120mm
Notes:		



Track Info:

Size:	Small <input type="checkbox"/> Medium <input type="checkbox"/> Large <input type="checkbox"/> Extra Large <input type="checkbox"/>
Surface:	Dirt <input type="checkbox"/> Carpet <input type="checkbox"/> Astroturf <input type="checkbox"/> Multi Surface <input type="checkbox"/>
Traction:	Low <input type="checkbox"/> Medium <input type="checkbox"/> High <input type="checkbox"/> Very High <input type="checkbox"/>
Moisture:	Dry <input type="checkbox"/> Damp <input type="checkbox"/> Wet <input type="checkbox"/>
Condition:	Indoor <input type="checkbox"/> Outdoor <input type="checkbox"/> Dusty <input type="checkbox"/> Hard Packed <input type="checkbox"/> Bumpy <input type="checkbox"/> Grooved <input type="checkbox"/> Smooth <input type="checkbox"/> Loamy <input type="checkbox"/>
Temperature:	Ambient: _____ Track: _____
Notes:	

Tires:

Front Tires:	
Front Compound:	
Front Insert:	
Rear Tires:	
Rear Compound:	
Rear Insert:	
Wheel (F/R):	
Notes:	

Body, Wings:

Body:	Kit (Pro Line)
Wing:	Kit
Wing Height:	High: <input type="checkbox"/> Low: <input checked="" type="checkbox"/>
Gap to Tower:	0mm
Weight:	
Total Vehicle Weight:	
Notes:	

Vehicle Comments:

Notes:	
--------	--

Front Suspension:

Ride Height: _____
Camber: _____
Toe: _____
Anti-Roll Bar
Size: _____
Gap: _____
Ackerman
Notes: _____
Drive Shaft: CVAs: Universals:
Chassis Brace: Short: Long:
Hex: _____
Notes: _____

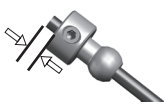

Caster Shim: _____
Upper Ball Type: _____
Upper Ball Shim: _____
Washers: _____
Lower Ball Shim: _____

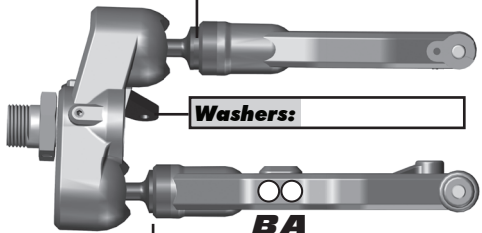
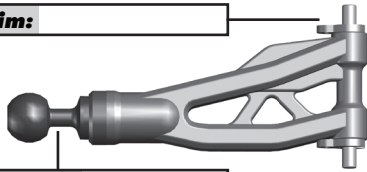

Wheelbase Shim: _____
Lower Ball Type: _____
Upper Arm Mount: _____
Arm Mount A: _____
Arm Mount B: _____

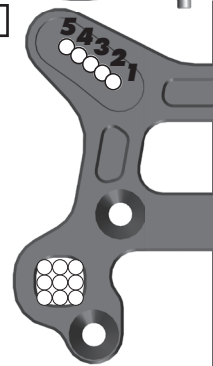
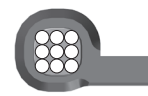
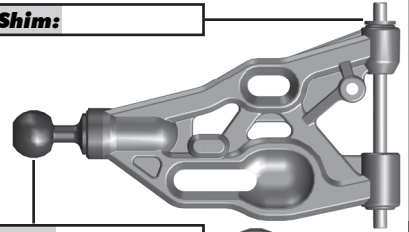

Rear Suspension:

Ride Height: _____
Camber: _____
Anti-Roll Bar
Size: _____
Gap: _____
Drive Shaft: CVAs: Universals:
Chassis Brace: Short: Long:
Hex: _____
Notes: _____

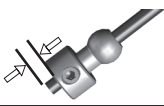

Hub Shim: _____
Wheelbase Shim: _____
Arm Mount C: _____
Arm Mount D: _____

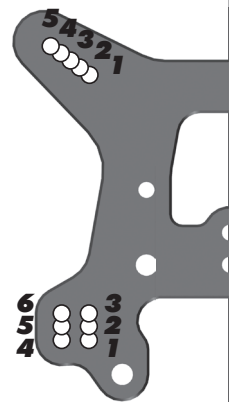
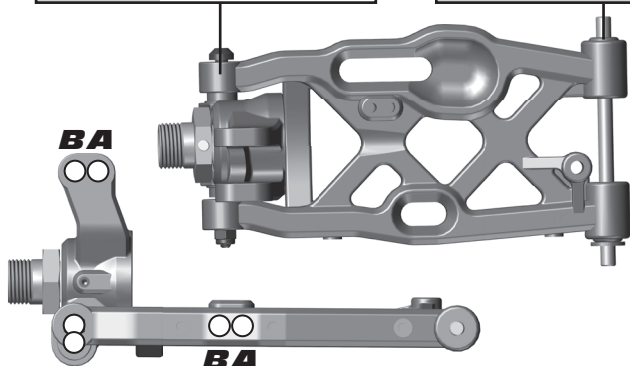

Electronics:

Radio: _____
Servo: _____
EPA: Throttle: _____ % Brake: _____ %
EXPO: Throttle: _____ % Brake: _____ %
ESC: _____
Motor: _____
Battery: _____
Notes: _____

Differential:

	Fluid	Gear Set	Planet O-Rings
Front:			
Center:			
Rear:			

Gearing:

Spur Gear: _____ **Pinion:** _____
Notes: _____

Shocks:

	Front	Rear
Piston:		
Fluid:		
Cap:		
Rebound:		
Spring:		
Free Length:		
Notes:		



Track Info:

Size: Small Medium Large Extra Large
Surface: Dirt Carpet Astroturf Multi Surface
Traction: Low Medium High Very High
Moisture: Dry Damp Wet
Condition: Indoor Outdoor Dusty Hard Packed
 Bumpy Grooved Smooth Loamy
Temperature: Ambient: _____ Track: _____
Notes: _____

Tires:

Front Tires: _____
Front Compound: _____
Front Insert: _____
Rear Tires: _____
Rear Compound: _____
Rear Insert: _____
Wheel (F/R): _____
Notes: _____

Body, Wings:

Body: _____
Wing: _____
Wing Height: High: Low:
Gap to Tower: _____
Weight: _____
Total Vehicle Weight: _____
Notes: _____

Vehicle Comments:

Notes: _____