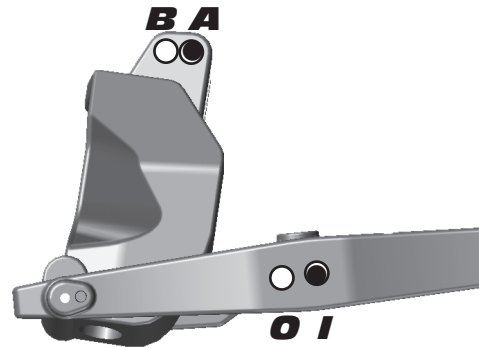
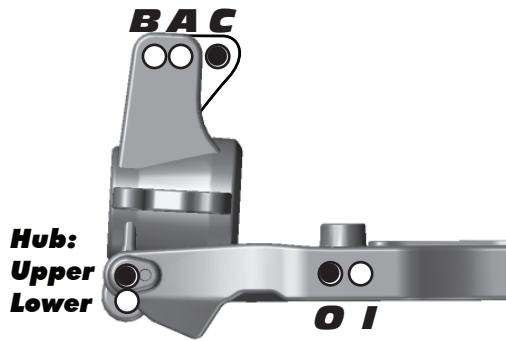

Front Suspension
Steering System:
Swing Rack **Anti Roll Bar:**
Bellcrank Rack
2.2mm Green
2.3mm White
2.4mm Blue
2.5mm Yellow
Bumpsteer
Washers: 1.5 mm

Camber: -1

Caster: 16

Toe: 0

Ride Height: 29 mm

Upper Hinge Pin Bushing
Front # 1
Up **Down**
Rear # 2
Up **Down**
B-Plate Type
Low **Original**
Kickup Bushing A-Plate
2
Up **Down**
Rear Suspension
RESET
Wheelbase:
Long
Medium
Short
Anti Roll Bar:
2.5mm Green
2.6mm White
2.7mm Blue
2.8mm Yellow
Camber: -3

Ride Height: 29 mm

Toe Bushing D-Plate
1
In **Out**
Squat Bushing C-Plate
2
Up **Down**
Front Shocks
Spring: K Light Blue (AE Silver) **Shock Cap:** Bladder
Shock Fluid: 45 wt Associated **Length:** 99 mm
Piston: 8 x 1.3mm Tapered **Rebound:** None

Rear Shocks
Spring: K Light Blue (AE Silver) **Shock Cap:** Bladder
Shock Fluid: 32.5 wt Associated **Length:** 119 mm
Piston: 8 x 1.3 Tapered **Rebound:** None

Chassis Braces / Wheel Hex
Chassis Braces: **Wheel Hex:**
Pivot **Standard**
Molded **Narrow**
Aluminum
Chassis Weight
Weight: 3267g

Rear Hubs
Rear Hubs:
Standard
CNC FT Alum.
Differentials
Front Diff Fluid: 5000
Center Diff Fluid: 5000
Rear Diff Fluid: 5000

Body / Wing
Body Type: Pro-Line Bulldog
Wing Type: UpGrade Vortex
Gap to Tower (MM): 28 mm

Gearing / Clutch
Spur Gear: 44
Clutch Bell: 15
Clutch Shoes: 3 x Hard Aluminum
Clutch Spring: 2 x 1.0 + 1 x 1.1

Engine
Engine: Reedy 121 VR ST
Restrictor: 8 mm **Temp:** 265
Muffler: OS 2089
Glow Plug: P3 **Fuel:** Strike Clear

Tires
Tire (F/R): Pro-Line Hoeshot 2.0 / Pro-Line Hoeshot 2.0
Compound (F/R): M3 / M3
Inserts (F/R): Moulded / Moulded
Wheel (F/R): Associated 83 mm / Associated 83 mm

Notes:
Radio / Servos
Radio: Futaba 4PKS **Brake Bias:** 50% / 50%
Throttle / Steering Servo: Futaba / Futaba
Throttle / Brake expo: 0% / 0%
Steering expo: 0%
Dual Rate: 100%

Race and Vehicle Comments
Qualify: 17 **Main:** A **Finish:** 14 **TQ:**
Comments: Swing rack in the middle hole; Rear camber link drilled below #1 hole; Tall wing mount;
 Test: 47.5 wt front shock oil

Track Info
Traction: **High** **Medium** **Low**
Surface: **Smooth** **Bumpy** **Blue Groove**
Soft Dirt **Grass** **Clay** **Wet**
Astroturf **Dusty** **Other:**