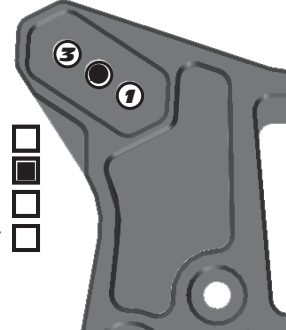
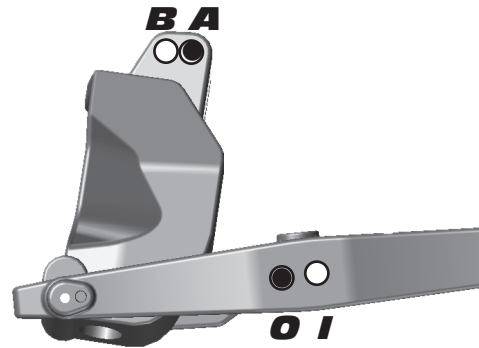
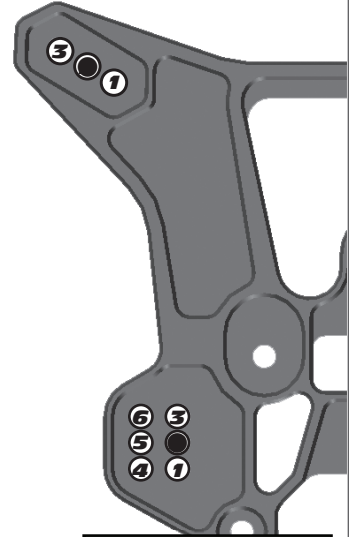
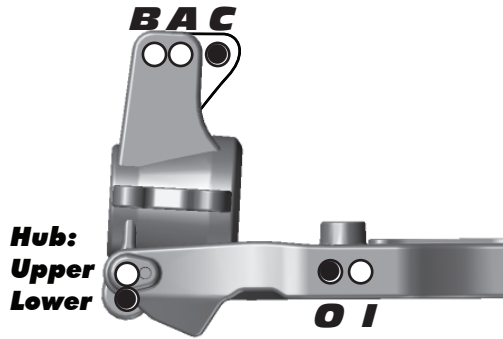

**Front Suspension**
**Steering System:**
**Swing Rack**  **Anti Roll Bar:**  
**Bellcrank Rack** 
**2.2mm Green**   
**2.3mm White**   
**2.4mm Blue**   
**2.5mm Yellow** 
**Bumpsteer**
**Washers:** Tall Ballstud \_\_\_\_\_

**Camber:** \_\_\_\_\_ -2

**Caster:** \_\_\_\_\_ 16

**Toe:** \_\_\_\_\_ -1

**Upper Hinge Pin Bushing**  
**Front #** \_\_\_\_\_ 1  
**Up**  **Down**   
**Rear #** \_\_\_\_\_ 2  
**Up**  **Down** 
**B-Plate Type**  
**Low**  **Original** 
**Kickup Bushing A-Plate**  
**#** \_\_\_\_\_ 2  
**Up**  **Down** 

**Ride Height:** \_\_\_\_\_ 29 mm

**Rear Suspension**
**RESET**
**Wheelbase:**
**Long**   
**Medium**   
**Short** 
**Anti Roll Bar:**
**2.5mm Green**   
**2.6mm White**   
**2.7mm Blue**   
**2.8mm Yellow** 
**Camber:** \_\_\_\_\_ -2

**Toe Bushing D-Plate**  
**#** \_\_\_\_\_ 1  
**In**  **Out** 

**Hub: Upper Lower**  
**Ride Height:** \_\_\_\_\_ 30 mm

**Squat Bushing C-Plate**  
**#** \_\_\_\_\_ 2  
**Up**  **Down** 
**Front Shocks**
**Spring:** Kyo Lt Blue (74 mm) **Shock Cap:** Bladder  
**Shock Fluid:** 32.5 Associated **Length:** 104 mm  
**Piston:** 5x1.1 + 5x1.2 **Rebound:** 10 mm

**Rear Shocks**
**Spring:** Kyo Lt Blue (95 mm) **Shock Cap:** Bladder  
**Shock Fluid:** 27.5 Associated **Length:** 124 mm  
**Piston:** 5x1.1 + 5x1.2 **Rebound:** 10 mm

**Chassis Braces / Wheel Hex**
**Chassis Braces:** **Wheel Hex:**  
**Pivot**  **Standard**   
**Molded**  **Narrow**   
**Aluminum** 
**Chassis Weight**
**Weight:** \_\_\_\_\_  
 \_\_\_\_\_  
 \_\_\_\_\_

**Rear Hubs**
**Rear Hubs:**  
**Standard**   
**CNC FT Alum.** 
**Differentials**
**Front Diff Fluid:** \_\_\_\_\_ 5000  
**Center Diff Fluid:** \_\_\_\_\_ 5000  
**Rear Diff Fluid:** \_\_\_\_\_ 5000

**Body / Wing**
**Body Type:** 2012 Pro-Line Bull Dog  
**Wing Type:** JConcepts Hi Flow  
 Low (RC8.2) wing mount  
**Gap to Tower (MM):** \_\_\_\_\_ 25 mm

**Gearing / Clutch**
**Spur Gear:** \_\_\_\_\_ 44  
**Clutch Bell:** \_\_\_\_\_ 17  
**Clutch Shoes:** 2 Standard Aluminum / 1 Fiber  
**Clutch Spring:** 2 x 1.0 / 1 x 0.9

**Engine**
**Engine:** Muman Mods Novarossi 4BTT  
**Restrictor:** 6.5 mm **Temp:** 280  
**Muffler:** Novarossi 9901 / 41021  
**Glow Plug:** C6TGC **Fuel:** Byron's 30%

**Tires**
**Tire (F/R):** AKA Grid Iron / AKA Grid Iron  
**Compound (F/R):** Soft / Soft  
**Inserts (F/R):** AKA Red / AKA Red  
**Wheel (F/R):** AKA Evo / AKA Evo  
**Notes:** No wheel stiffeners

**Radio / Servos**
**Radio:** Airtronics M11x **Brake Bias:** 50/50  
**Throttle / Steering Servo:** XP 1313 / Airtronics 94780  
**Throttle / Brake expo:** -65% / 0%  
**Steering expo:** \_\_\_\_\_ 0%  
**Dual Rate:** \_\_\_\_\_ 100%

**Race and Vehicle Comments**
**Qualify:** \_\_\_\_\_ **Main:** \_\_\_\_\_ **Finish:** \_\_\_\_\_ **TQ:** \_\_\_\_\_  
**Comments:** Short outdrives in the front; Truggy rear spring length; Center hole on the steering rack  
 \_\_\_\_\_  
 \_\_\_\_\_  
 \_\_\_\_\_

**Track Info**
**Traction:** **High**  **Medium**  **Low**   
**Surface:** **Smooth**  **Bumpy**  **Blue Groove**   
**Soft Dirt**  **Grass**  **Clay**  **Wet**   
**Astroturf**  **Dusty**  **Other:** Loose on top, swept groove and watered edges, but still dusty