

# RF10 4WD

1:10 SCALE COMPETITION FOUR-WHEEL DRIVE

## 1:10 SCALE ELECTRIC 4WD COMPETITION OFF-ROAD CAR KIT INSTRUCTION MANUAL



Due to ongoing research and development, photos may not match current kit components.  
RC10 photos shown equipped with items that may NOT be included with vehicle.

# RF10 TEAM ASSOCIATED



## :: Introduction

Thank you for purchasing this Team Associated product. This assembly manual contains instructions and tips for building and maintaining your new Kit. Please take a moment to read through this manual to help familiarize yourself with these steps.

We are continually changing and improving our designs; therefore, actual parts may appear slightly different than in the illustrations. New parts will be noted on supplementary sheets located in the appropriate parts bags. Check each bag for these sheets before you start to build.

## :: KIT Features

Features in the RC10 4WD Kit:

- Authentic Never Released RC10 4WD Concept Race Buggy
- 4WD Gold anodized 6061-T6 aluminum monocoque tub chassis
- Fully adjustable four-wheel independent suspension
- Long travel, fluid-filled, Hard-anodized aluminum coil-over shocks
- Race Proven front and Rear Stealth Transmissions
- Adjustable Ball Differentials front and rear
- Exceptional ground clearance with low center of gravity
- Vintage 4wd spike Tires included
- Clear ProTech body with wing
- New 4wd Specific shock towers front and rear
- Precision Bearings throughout
- Fits 6-cell NiMh and 2S LiPo battery packs
- Adjustable 3.5mm Turnbuckles all around
- Front and Rear CVA Driveshafts
- Durable Low Friction Center Belt and tension system
- Long front arm geometry
- All new front caster and spindle assembly designed for RC104wd
- Updated Rear Bulkhead and chassis stiffener
- Carbon Fiber Rear Transmission Brace
- Front 2.2" 12mm Hex Wheels included
- Rear 2.2" wheels included
- HD Metric Ball Studs throughout
- Race Proven V2 Slipper Clutch System
- All new 4wd Specific Bell Crank system
- 5.5" High Downforce Lexan Race Wing Included

## :: Additional

Your new RC10 4WD Kit comes as a kit. There are some items you will need to complete your kit (refer to website for suggestions):

- R/C two channel surface frequency radio system
- Electronic Speed Control (ESC)
- Steering Servo
- Peak detection battery charger
- 2S, 7.4V Lipo stick battery or 7.2V NiMH battery
- 2mm Hex Driver (AE #1501)
- Polycarbonate specific paint
- Pinion gear, size to be determined by type and wind of motor you use
- R/C Electric Motor
- Servo Horn (AE #89007)
- Thread Lock (AE #1596)
- 5.5mm Hex Driver (AE #1507)

Tools included:

- Allen wrenches (.035", .050", 1/16", 3/32")
- Shock building tool

## :: Other Helpful Items

- Silicone Shock Fluid (Refer to website for complete listings)
- Tire Adhesive (AE #1697)
- Shock Pliers (AE #1681)
- Wire Cutters / Hobby Knife
- Body Scissors (AE #1737)
- Green Slime shock lube (AE #1105)
- Needle Nose Pliers
- Reamer / Hole Punch (AE #1499)
- Calipers or a Precision Ruler
- Soldering Iron

**Associated Electrics, Inc.**  
21062 Bake Parkway  
Lake Forest, CA 92630



**Customer Service**  
Tel: 949.544.7500  
Fax: 949.544.7501

**:: Hardware - 1:1 Scale View**

**Cap Head (shcs)**

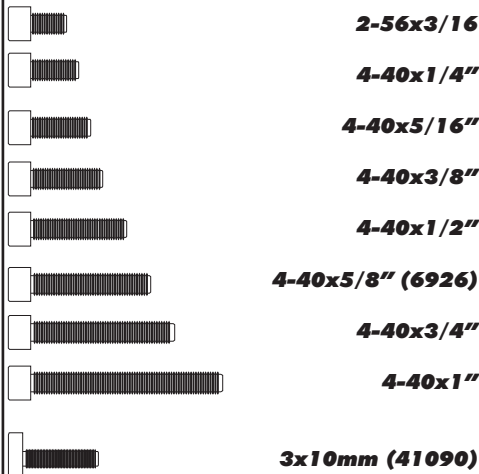

**Flat Head (fhcs)**

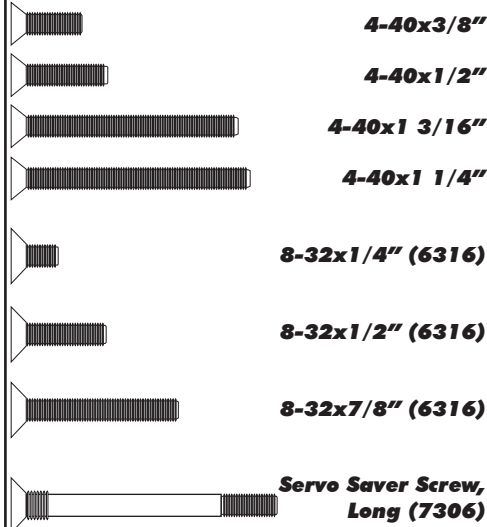

**Button Head (bhcs)**

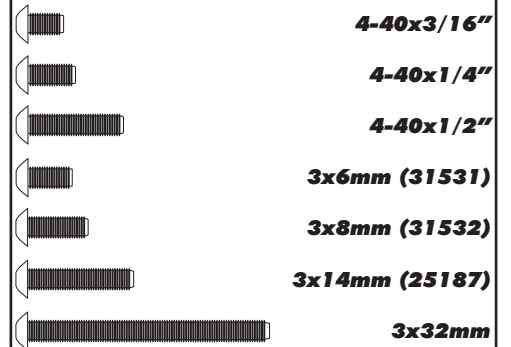

**Clips**



**Shims and Washers**



**Nuts (lock/plain)**

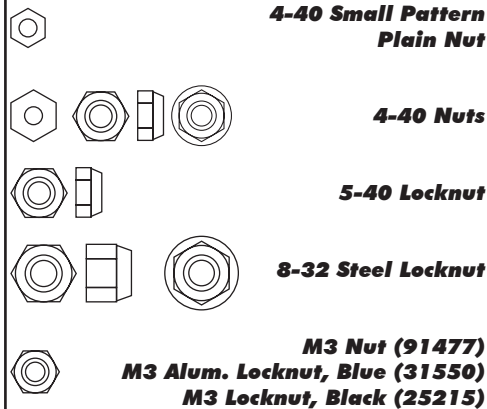

**Bearings**

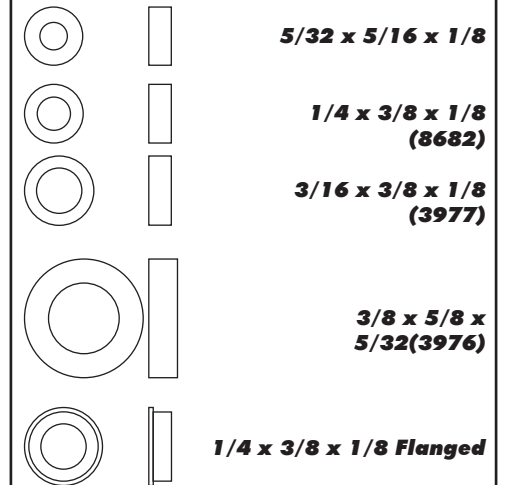

**Set Screws**



**Diff Balls**



**Ballstuds**



**Notes:**

## :: Table of Contents

1..... Cover	13.....Rear Suspension Build (Bag E)
2..... Introduction	14.....Turnbuckles Build (Bag F)
3.....1:1 Hardware "Fold Out"	15.....Shocks Build (Bag G)
4..... Table of Contents	18..... Chassis Build (Bag H)
5.....Nose Plate / Steering Build (Bag A) (Bag F)	19.....Electronics Build (Bag I)
6..... Differential Build (Bag B)	20.....Wheels, Tires and Body Install (Bag J)
7.....Front Transmission Build (Bag B)	24 - 25.....Setup Sheets
8.....Rear Transmission Build (Bag B)	26..... Back Cover
9.....Front Suspension Build (Bag C)	
11.....Rear Bulkhead Build (Bag D)	

## :: Notes



This symbol indicates a special note or instruction in the manual.



**There is a 1:1 hardware foldout page in the front of the manual. To check the size of a part, line up your hardware with the correct drawing until you find the exact size.**

**Associated Electrics, Inc.**  
21062 Bake Parkway  
Lake Forest, CA 92630



**Customer Service**  
Tel: 949.544.7500  
Fax: 949.544.7501

**:: Nose Plate / Steering Build - Bag A - Step 1**



Washers are used to adjust to your preferred body height.

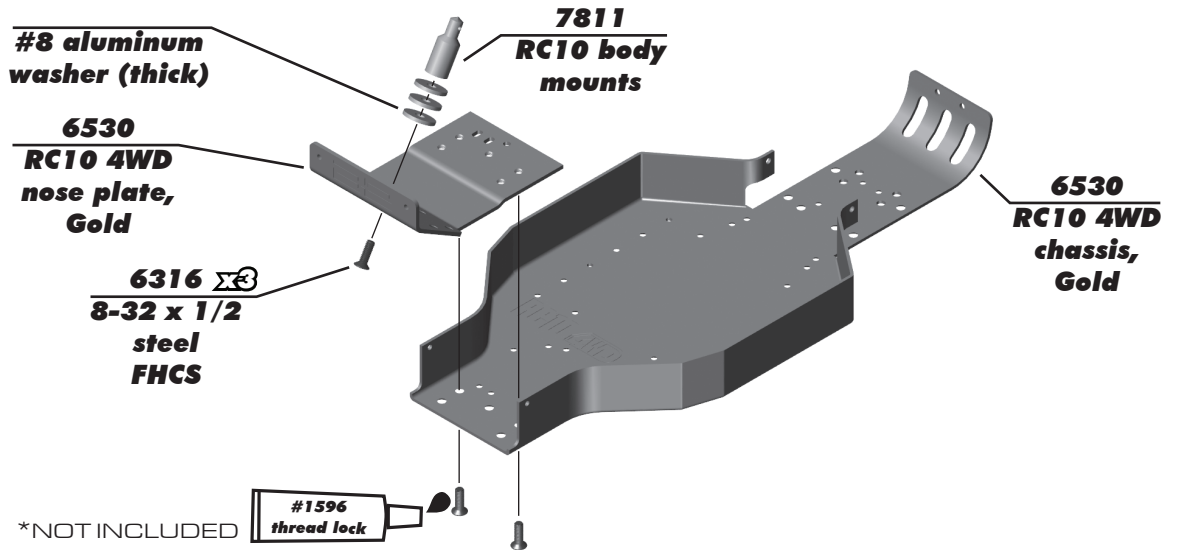

**:: Nose Plate / Steering Build - Bag A - Step 2**

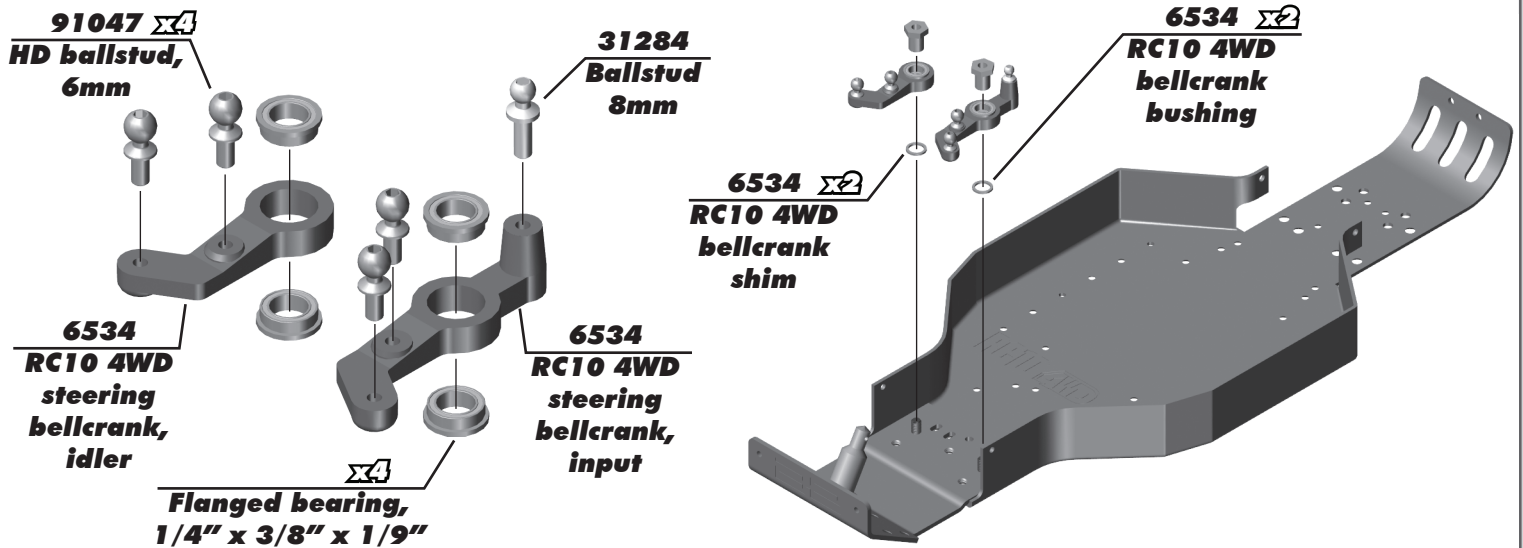

**:: Nose Plate / Steering Build - Bag F - Step 3**



The steering rack turnbuckle parts are in bag F.



Note the direction of the ball cups!

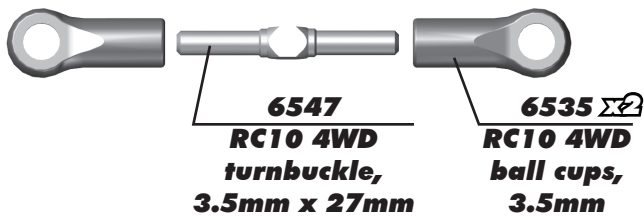

**Steering Rack Turnbuckle  
0.31" (8mm)**

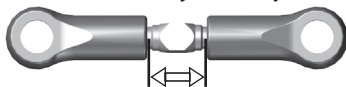

Orient the notch to the left throughout the car. It indicates which end has the left hand threads!

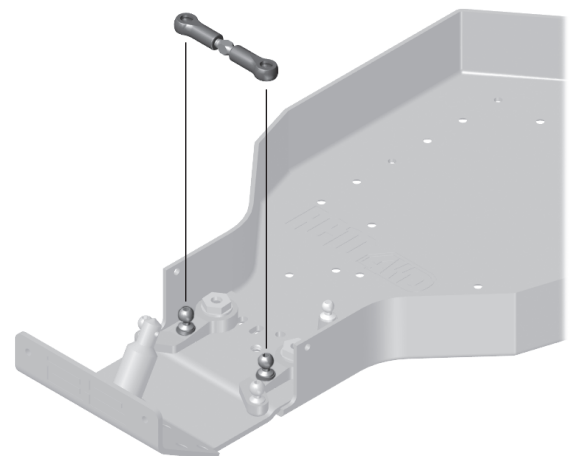

**:: Differential Build - Bag B - Step 1**

**Build x2 Diffs!**

**6579**  
Diff drive rings

**6578**  
Diff outdrives

**6579**  
Diff drive rings

**6578**  
Diff outdrives

**6573**  
Diff thrust bolt

**Diff thrust washer**

**Diff thrust balls, cage**

**BLACK GREASE #6588**

**BLACK GREASE #6588**

**Build Tip:**  
Install the first washer (grove up), add grease #6588. Install the caged thrust washer. Add grease on top of the balls, then install the 2nd washer (grooves down).

**:: Differential Build - Bag B - Step 2**

**6581** x12  
Carbide diff balls, 3/32"

**7812**  
Diff gear 45T

**6589** x2  
Bearing 5/32 x 5/16

**FT DIFF LUBE #6591**

**Build Tip:**  
Do this entire step with the diff screw on the end of your wrench for better control.

**:: Differential Build - Bag B - Step 3**

**6575**  
Diff thrust nut

**6582**  
Diff thrust spring

**6575**  
Diff bolt cover

**Compress spring first.**

\*It is important to tighten your RC 10 4WD Ball diffs x2 so they don't slip. As you tighten the diff bolt, you will notice the T-nut ears moving closer to the bottom of the outdrive slot. This compresses the spring behind the T-nut. The spring should be completely compressed at the same time the T-nut reaches the end of the slot. Caution! Pay close attention to the feeling when the spring is completely compressed. Do not overtighten the bolt. When you feel the spring completely compressed, loosen the diff bolt 1/4" of a turn. Your diff should now operate smoothly with resistance as the outdrives move in opposite directions. After you have driven the car once, recheck the diff settings as they may loosen up with a new differential system.

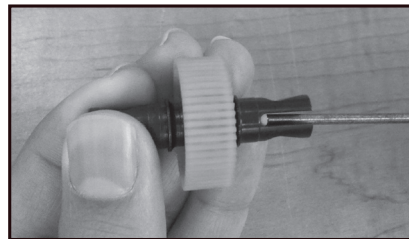

### :: Differential Build - Bag B - Step 4

Front diff settings and setup notes / tips:

When installing your Ball Differentials, make sure to install the Diff Bolt on the same side as the Top Shaft End.

- Front Diff: Diff Bolt should be on the Driver Side
- Rear Diff: Diff Bolt should be on the Passenger Side

Tighter Front Diff: Tighter front diff compared to the rear will give you more on power steering and off power stability.

Looser Front Diff: Looser front diff compared to the rear will provide more off power steering and on power stability.

Rear diff settings and setup notes / tips:

Tighter Rear Diff: Tighter rear diff compared to the front will provide more rear end stability.

Looser Rear Diff: Looser rear diff compared to the front will provide more off power corner speed and on power stability.

### :: Front Transmission Build - Bag B - Step 1

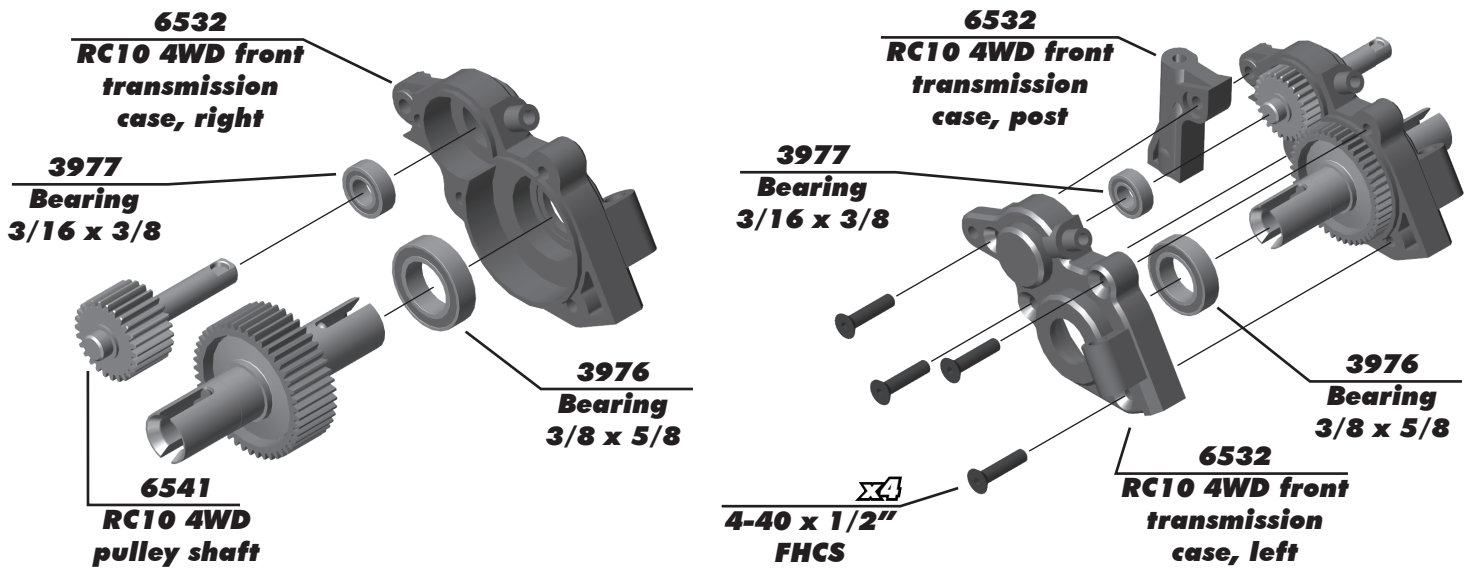

### :: Front Transmission Build - Bag B - Step 2

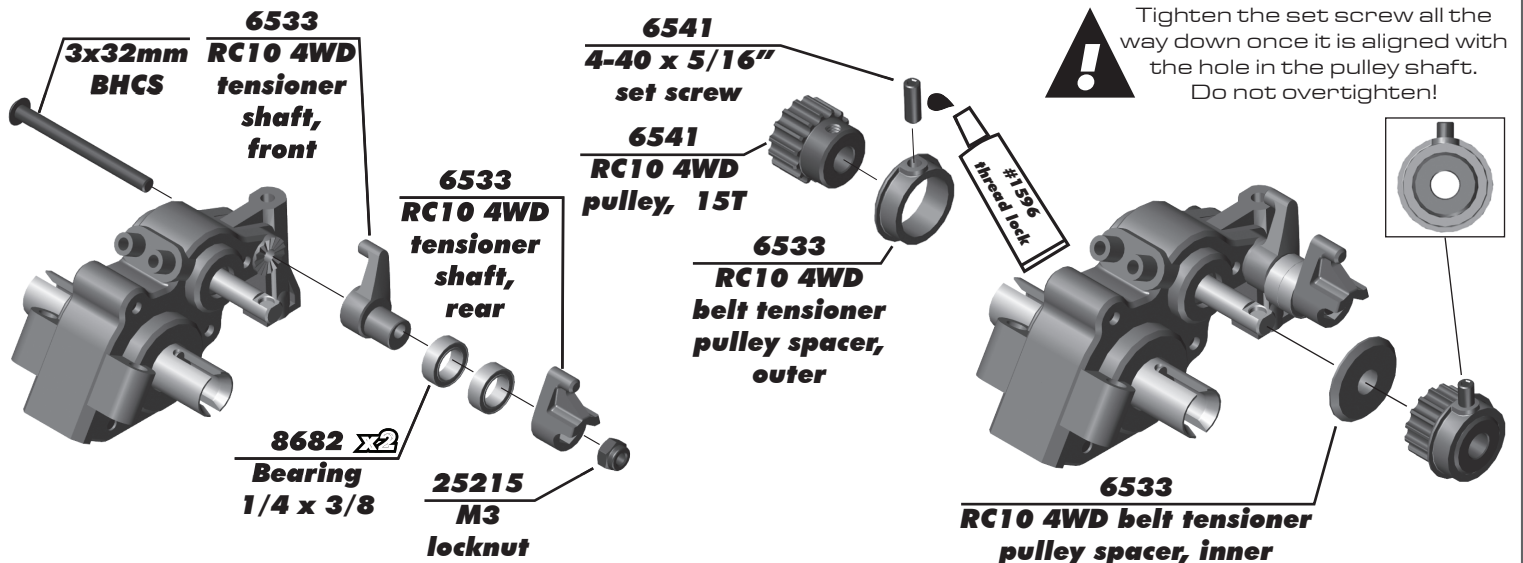

**:: Rear Transmission Build - Bag B - Step 1**

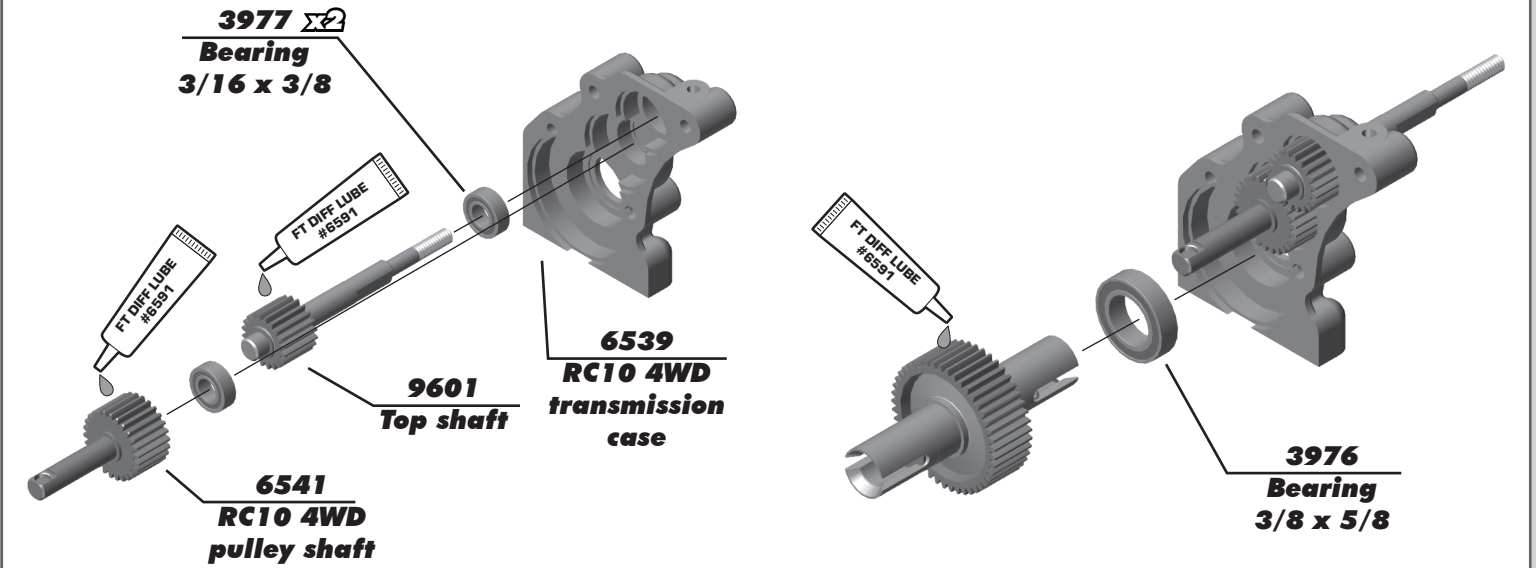

**:: Rear Transmission Build - Bag B - Step 2**

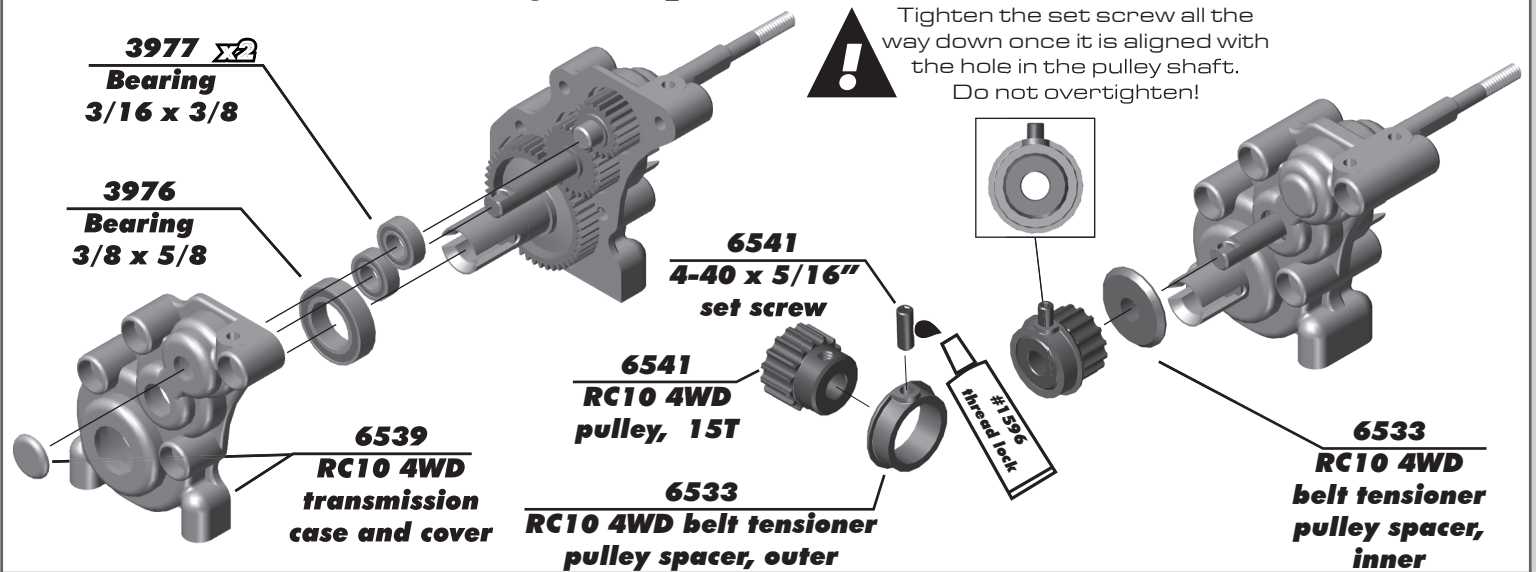

**:: Rear Transmission Build - Bag B - Step 3**

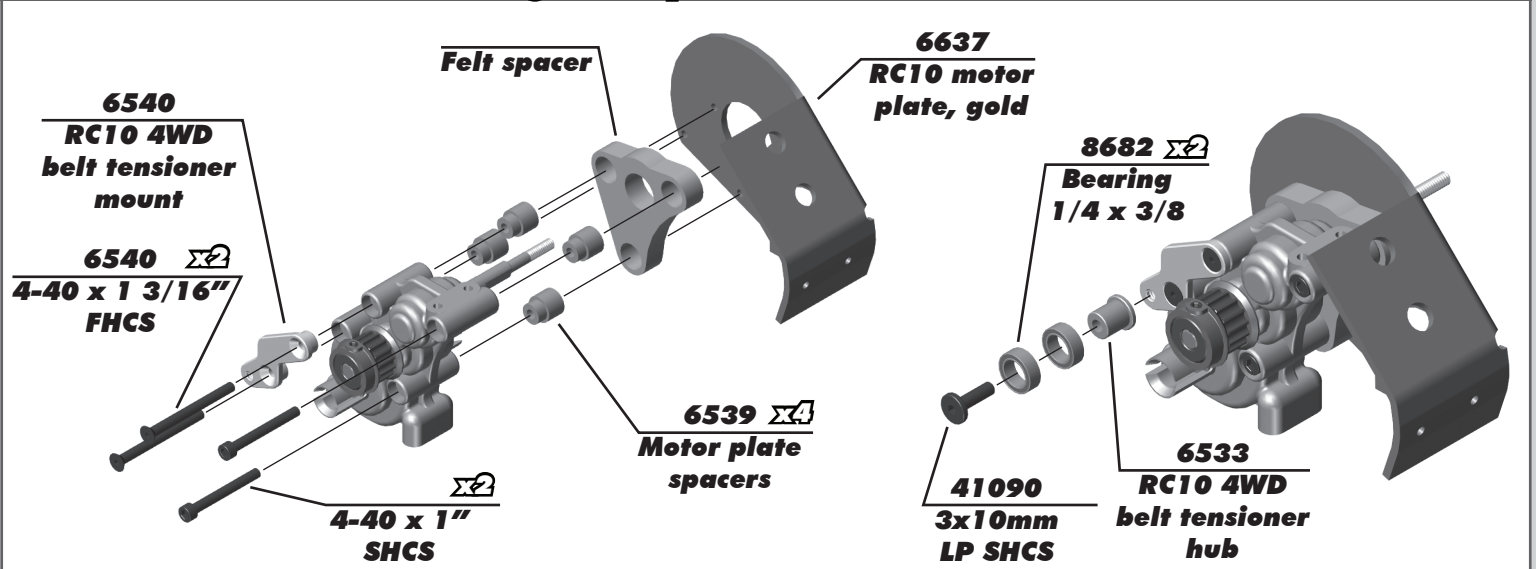



**:: Rear Transmission Build - Bag B - Step 4**

**92288**  $\Sigma 2$   
**Octalock slipper pad, 19mm**

**92296**  
**Octalock spur gear, 81T 48P**

**7485**  $\Sigma 2$   
**Slipper hub, v2**

**91423**  
**Slipper spring adapter**

**9739**  
**Slipper spring**

**5-40 locknut**

You can get the slipper spring and adapter together in #7486

Slipper starting point. Tighten the slipper nut until 2.5mm of the top shaft threads are exposed. Adjust as needed.

**:: Front Suspension Build - Bag C - Step 1**

**4-40 nut**  $\Sigma 2$

**4-40 x 3/4 SHCS**  $\Sigma 2$

**#4 aluminum washer**  $\Sigma 2$

**#1596 thread lock**

**31383**  $\Sigma 2$   
**Ballstud washers, blue aluminum, 2mm**

**6531**  
**RC10 4WD front shock tower**

**25215**  $\Sigma 2$   
**M3 Locknut**

**91048**  $\Sigma 2$   
**HD ballstud 8mm**

**:: Front Suspension Build - Bag C - Step 2**

**6532**  
**RC10 4WD front transmission case, gasket**

**4-40 x 1/4 BHCS**  $\Sigma 2$

**6207**  $\Sigma 2$   
**RC10 front arm mounts, (Left & Right)**

**4-40 x 1/2 FHCS**  $\Sigma 2$

**:: Front Suspension Build - Bag C - Step 3**

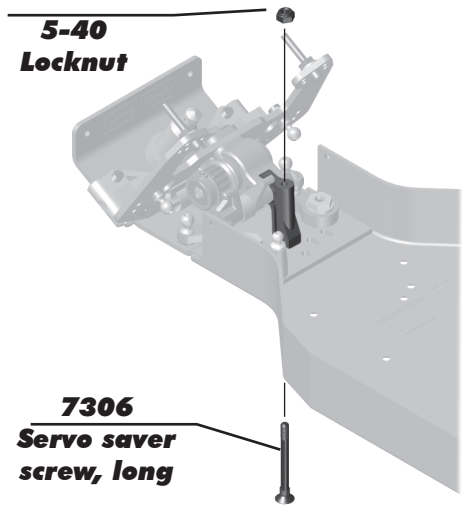
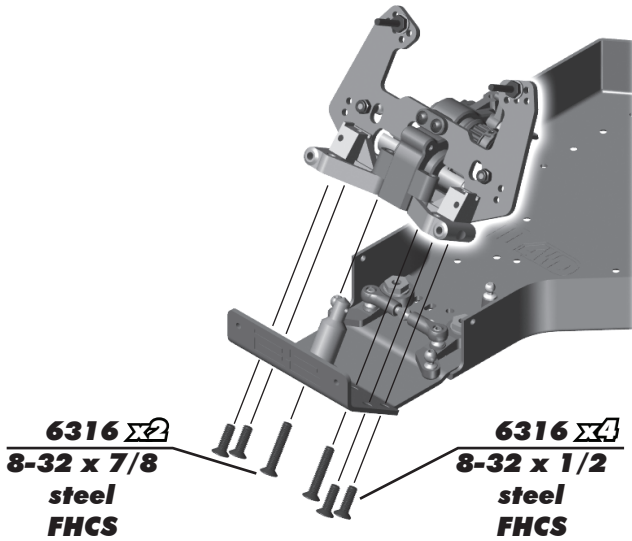

**:: Front Suspension Build - Bag C - Step 4**

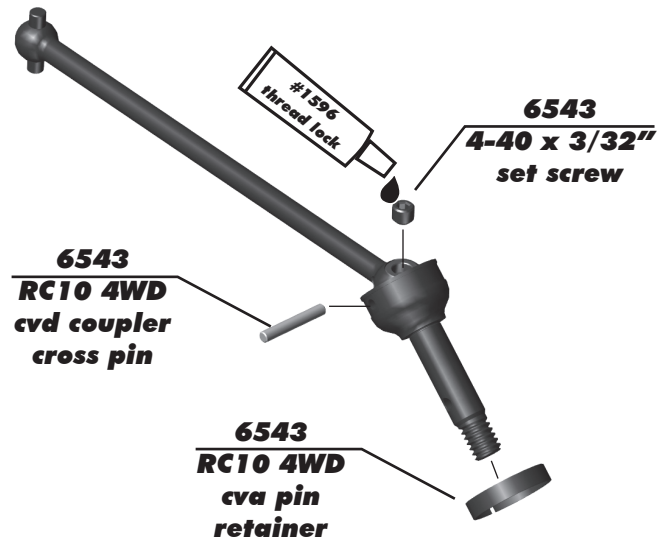
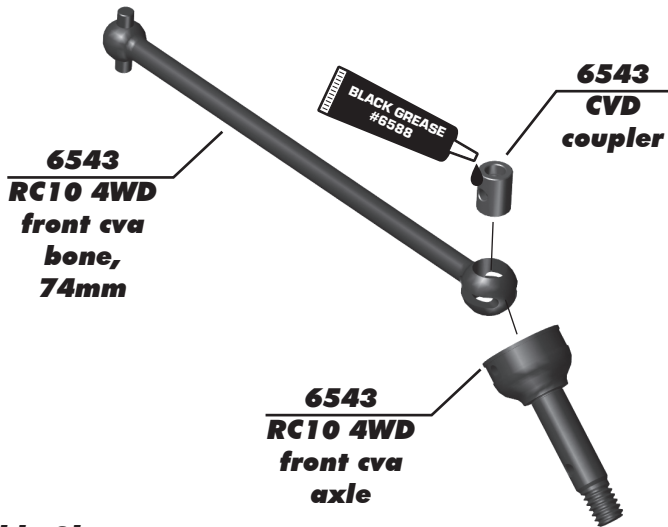

Build x2!

**:: Front Suspension Build - Bag C - Step 5**

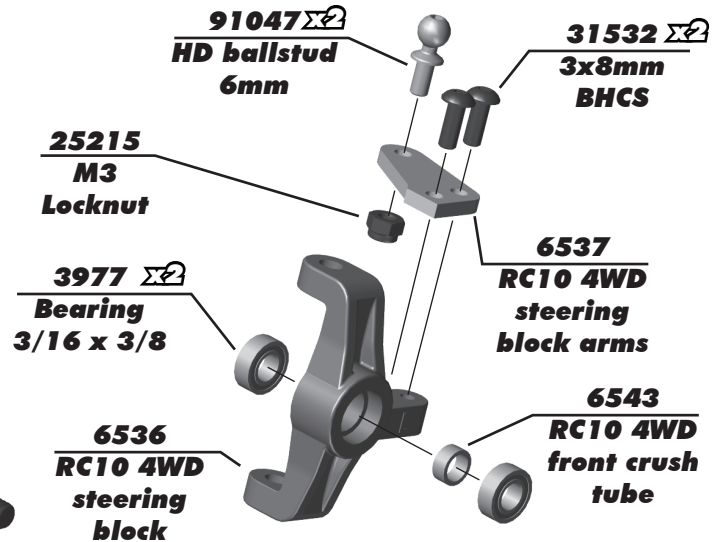
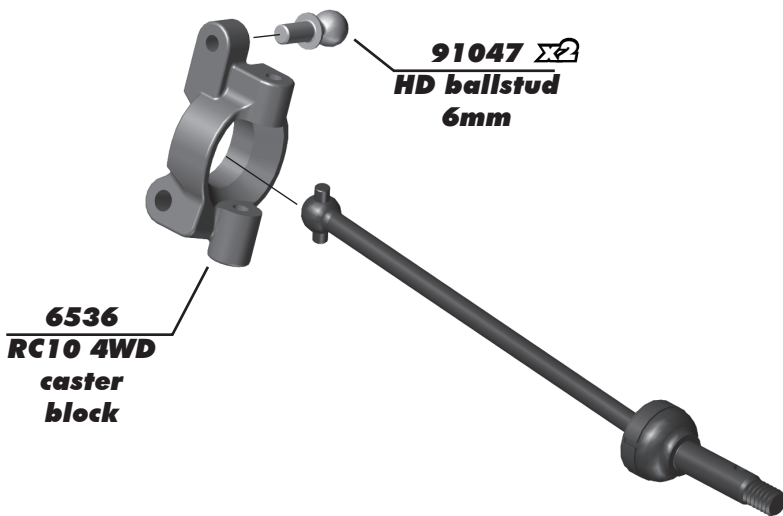

Build left and right sides!

**:: Front Suspension Build - Bag C - Step 6**

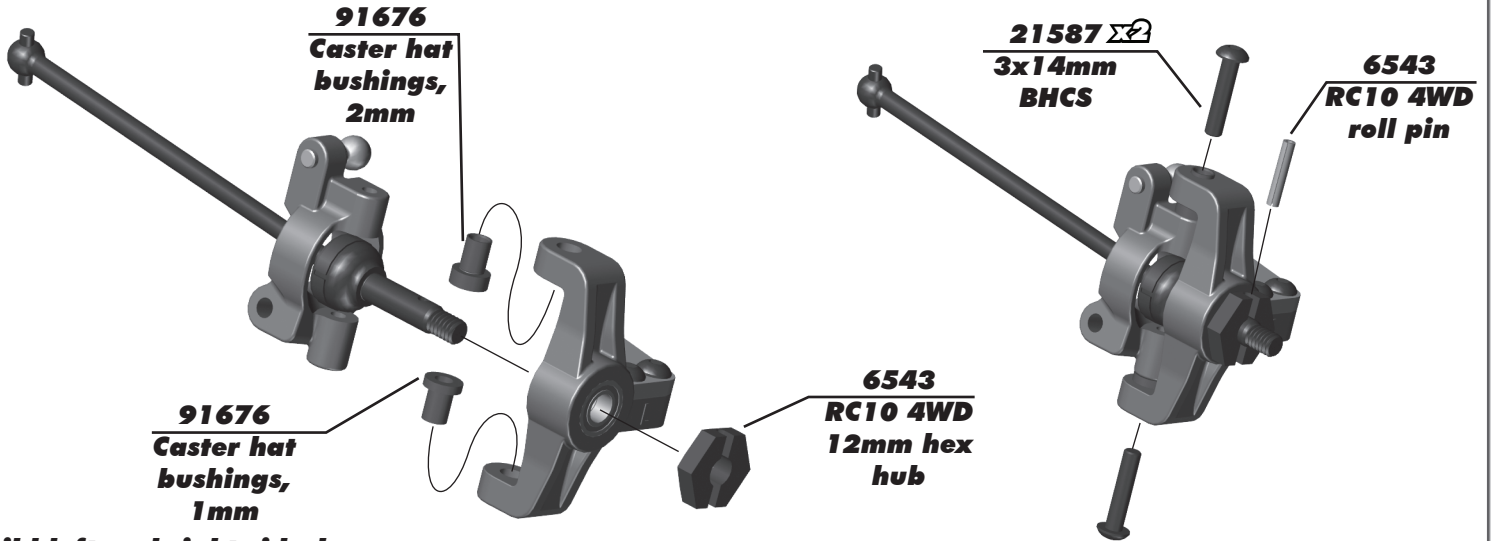

**Build left and right sides!**

**:: Front Suspension Build - Bag C - Step 7**

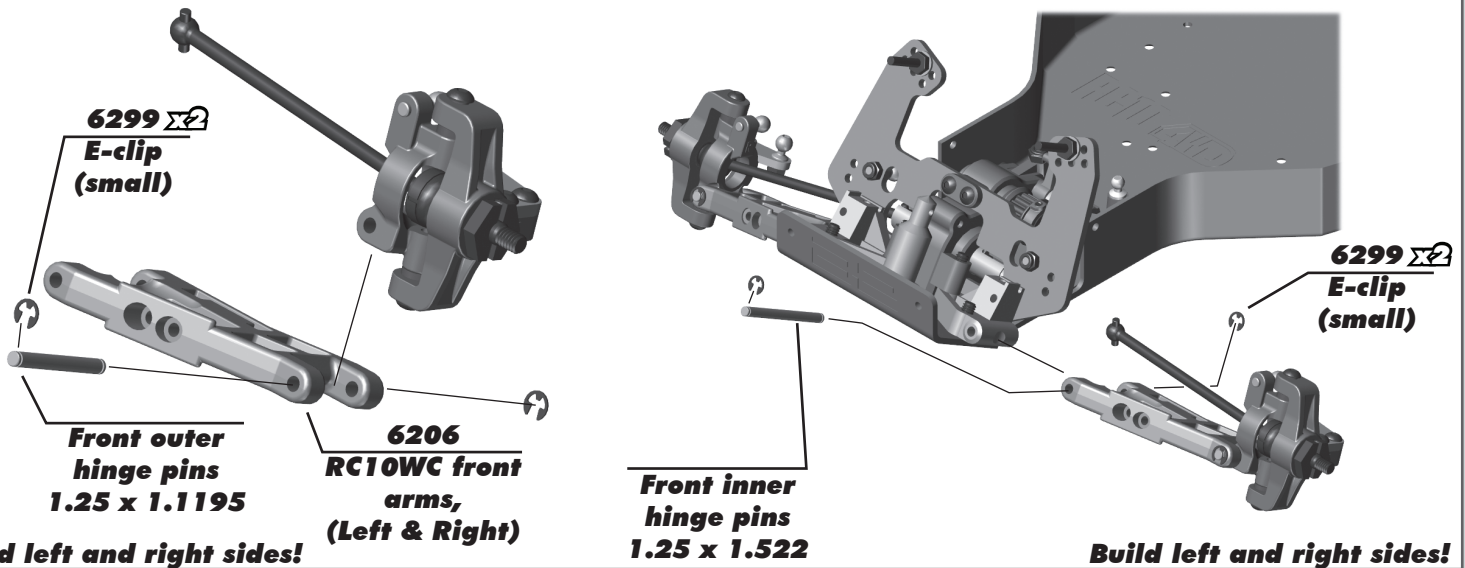

**Build left and right sides!**

**Build left and right sides!**

**:: Rear Bulkhead Build - Bag D - Step 1**

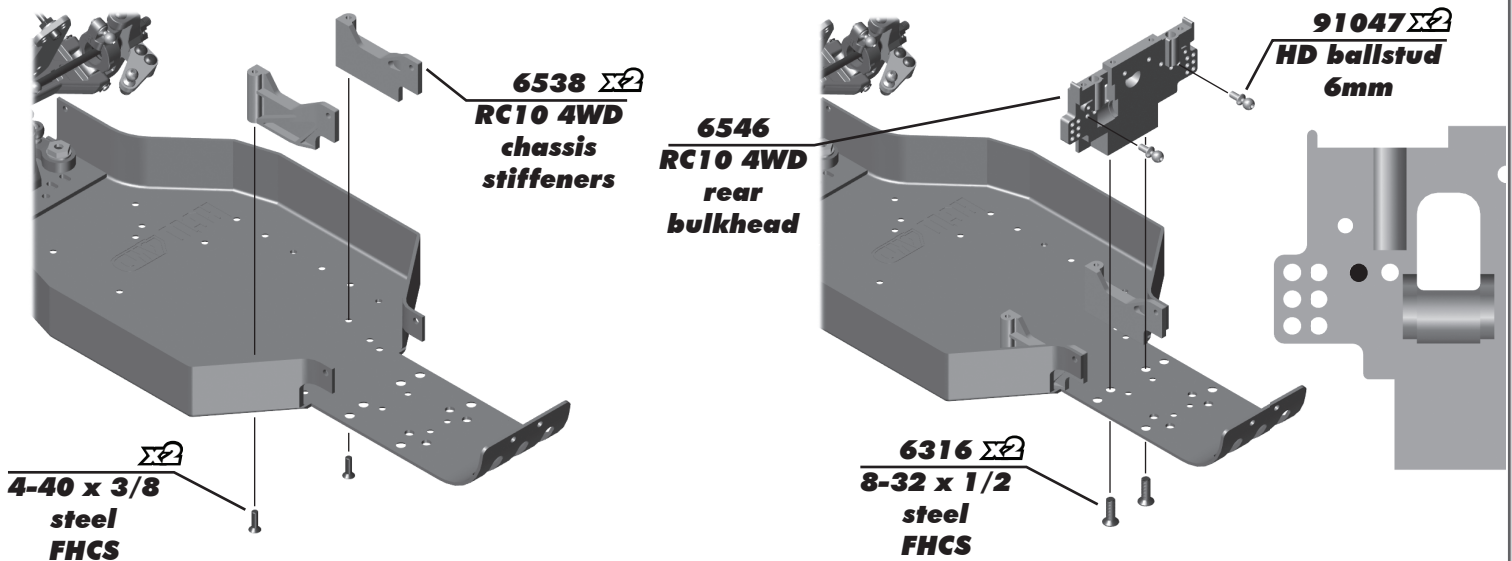

**4-40 x 3/8 steel FHCS**

**6316 8-32 x 1/2 steel FHCS**

**:: Rear Bulkhead Build - Bag D - Step 2**

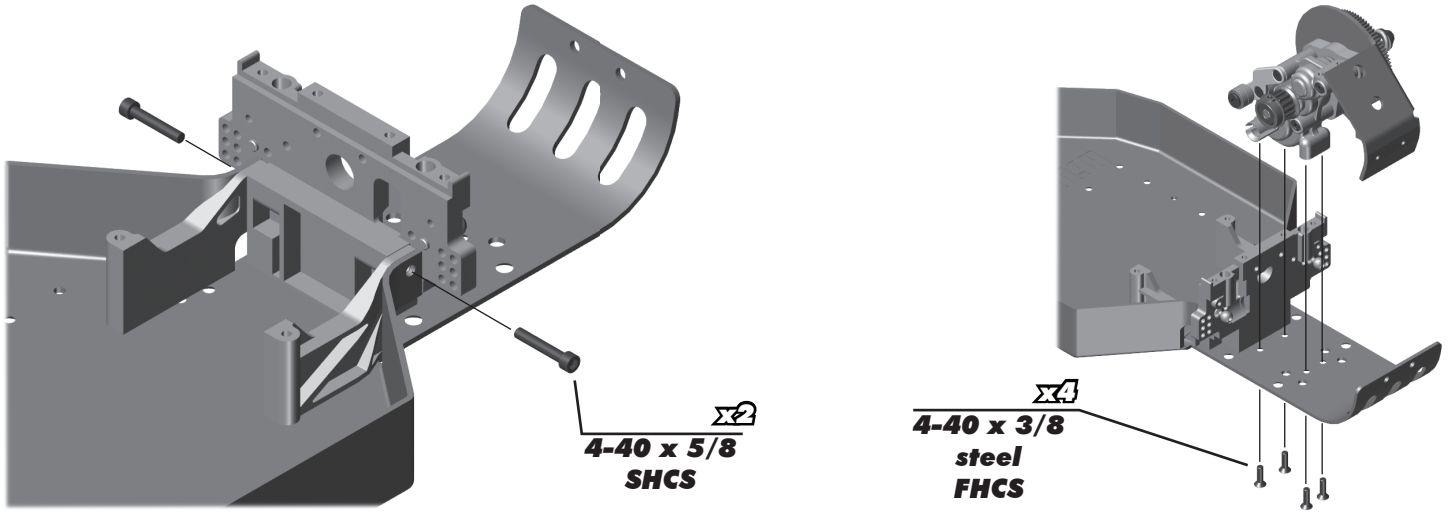

**:: Rear Bulkhead Build - Bag D - Step 3**

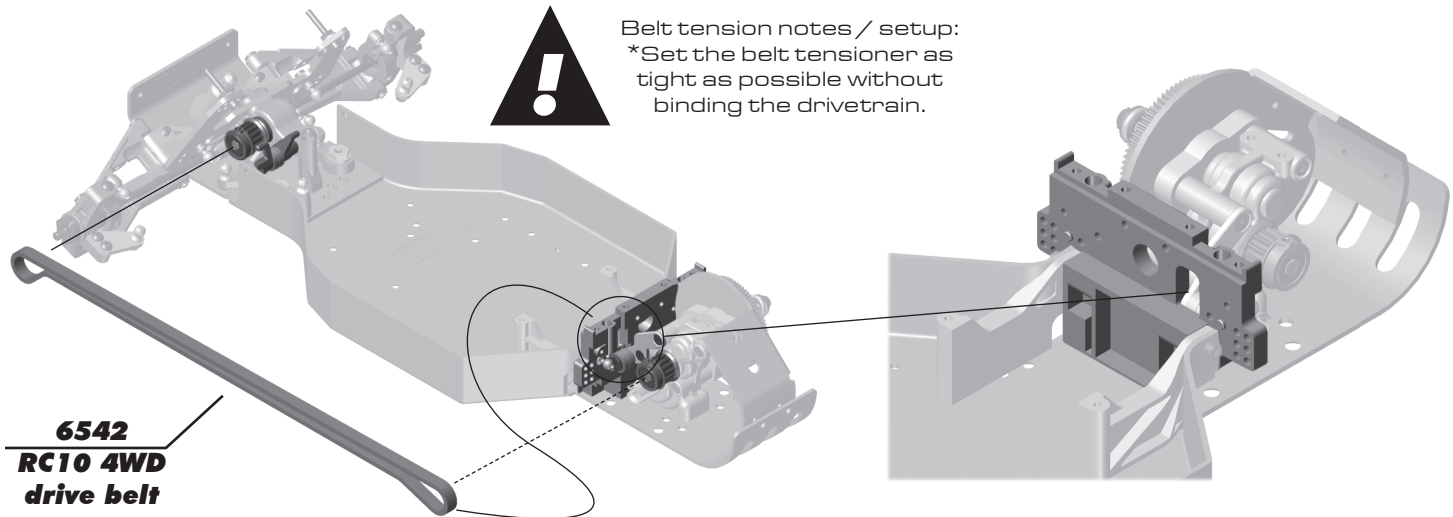

**:: Rear Bulkhead Build - Bag D - Step 4**

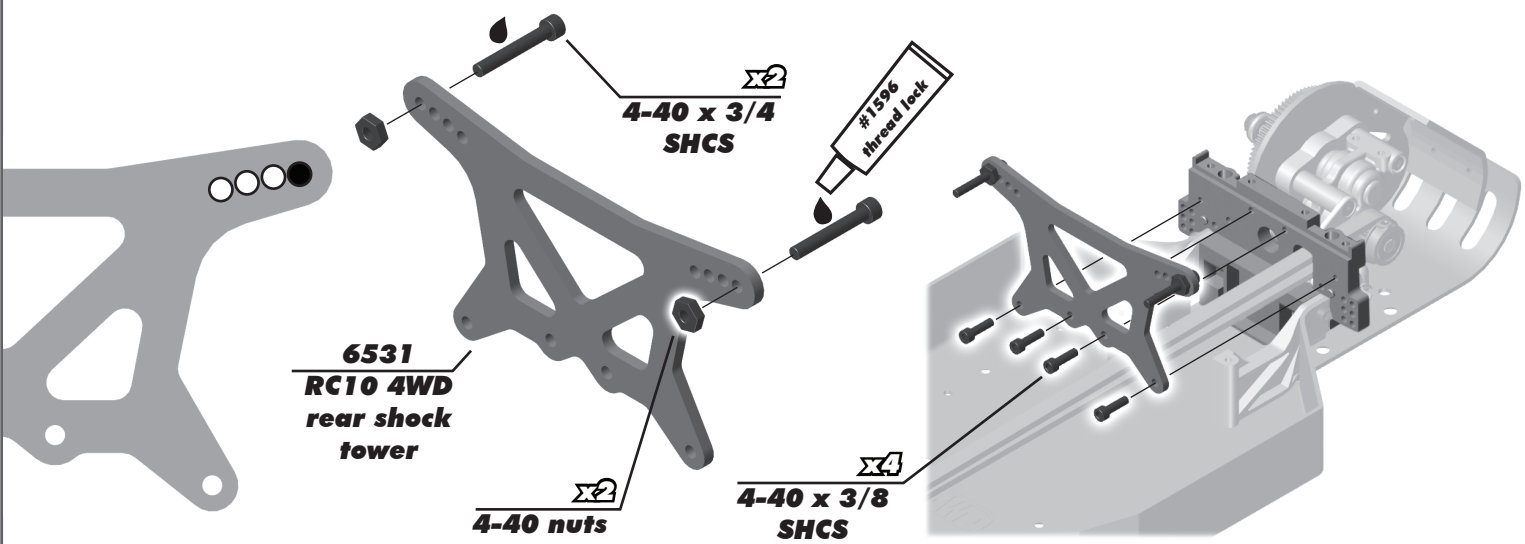

**:: Rear Bulkhead Build - Bag D - Step 5**

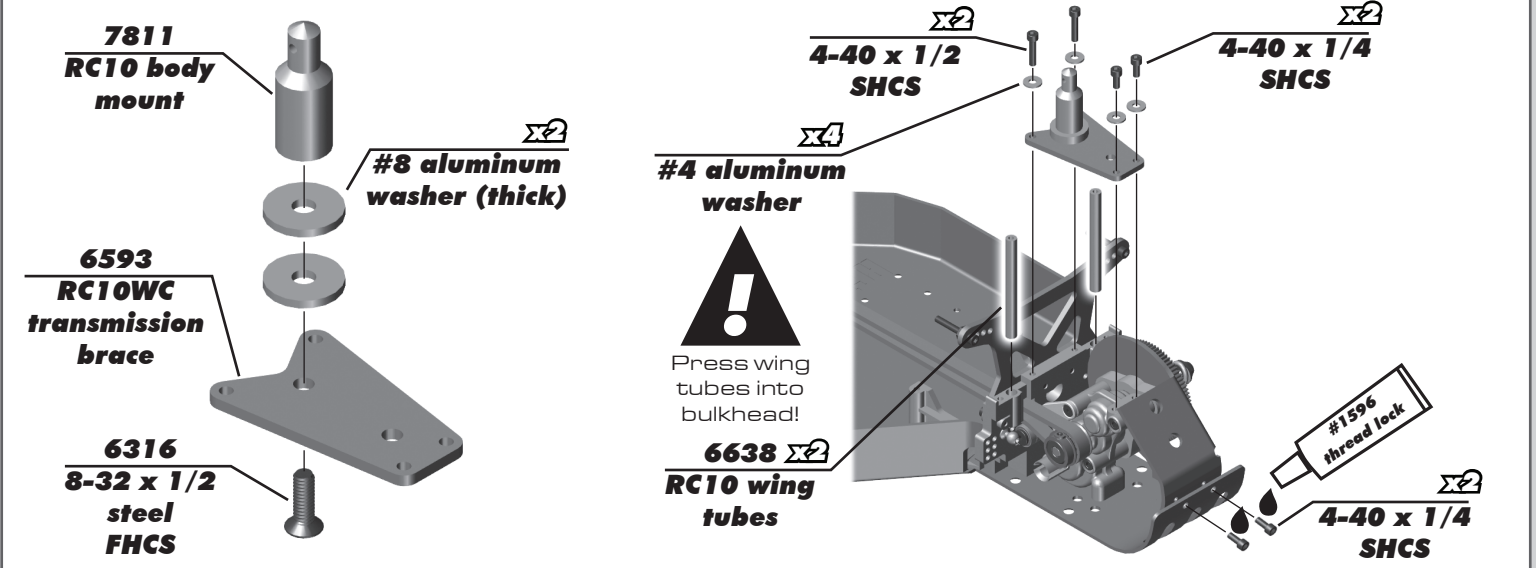

**:: Rear Suspension Build - Bag E - Step 1**

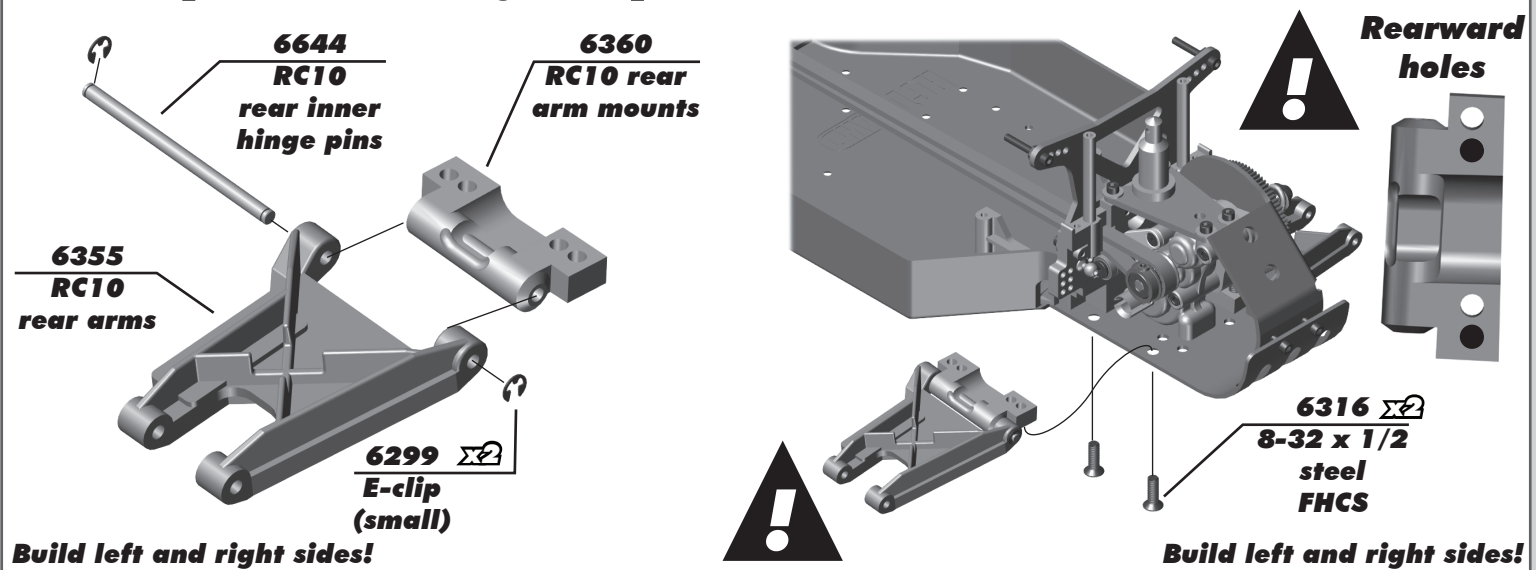

**:: Rear Suspension Build - Bag E - Step 2**

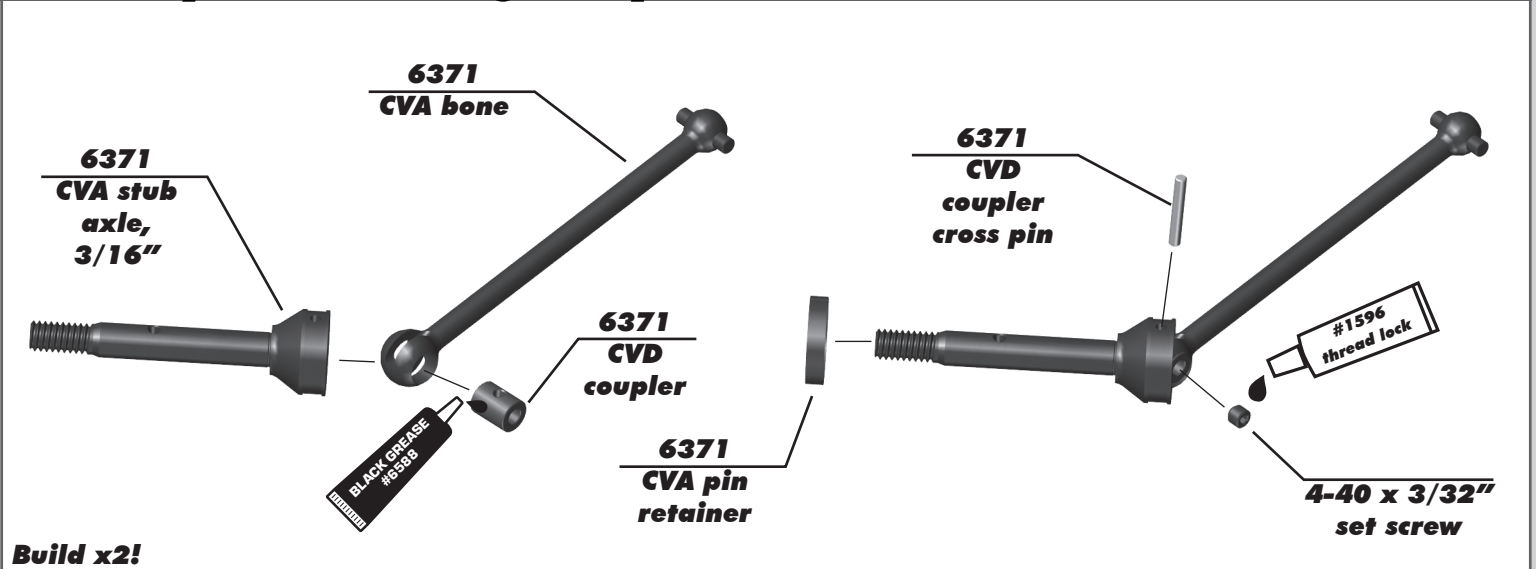

**:: Rear Suspension Build - Bag E - Step 3**

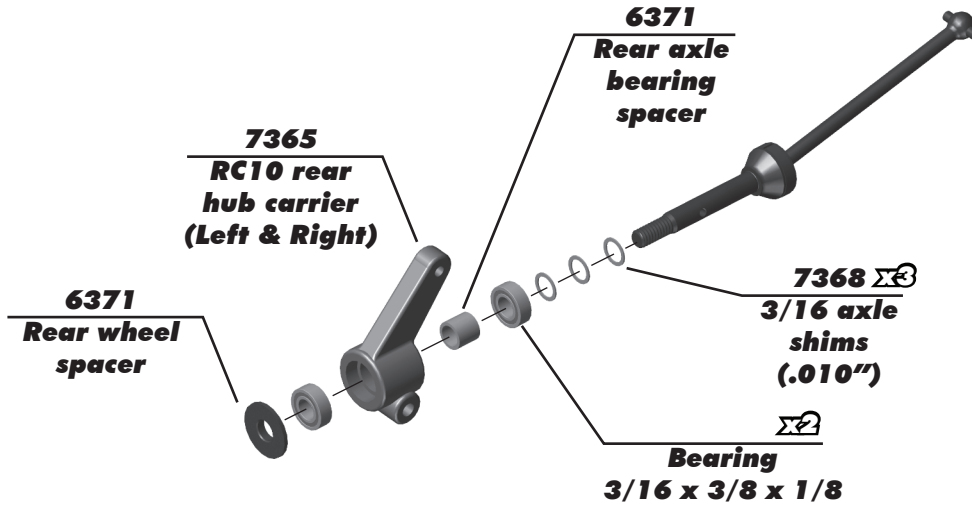

**Build left and right sides!**

**:: Rear Suspension Build - Bag E - Step 4**

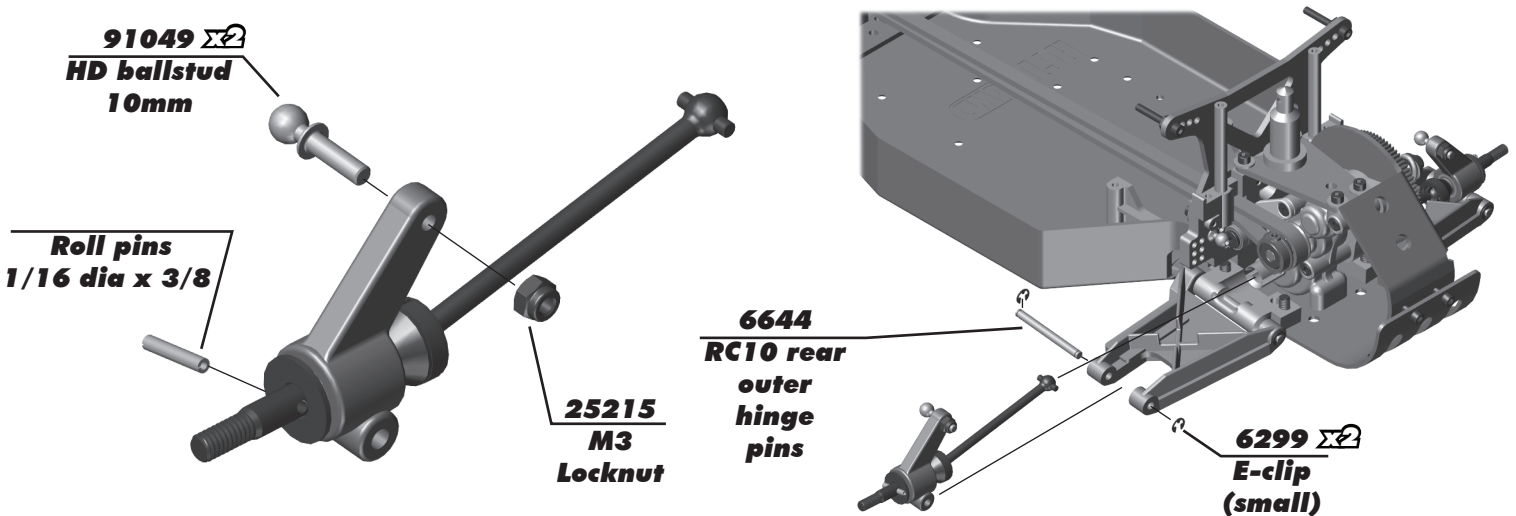

**Build left and right sides!**

**:: Turnbuckle Build - Bag F - Step 1**

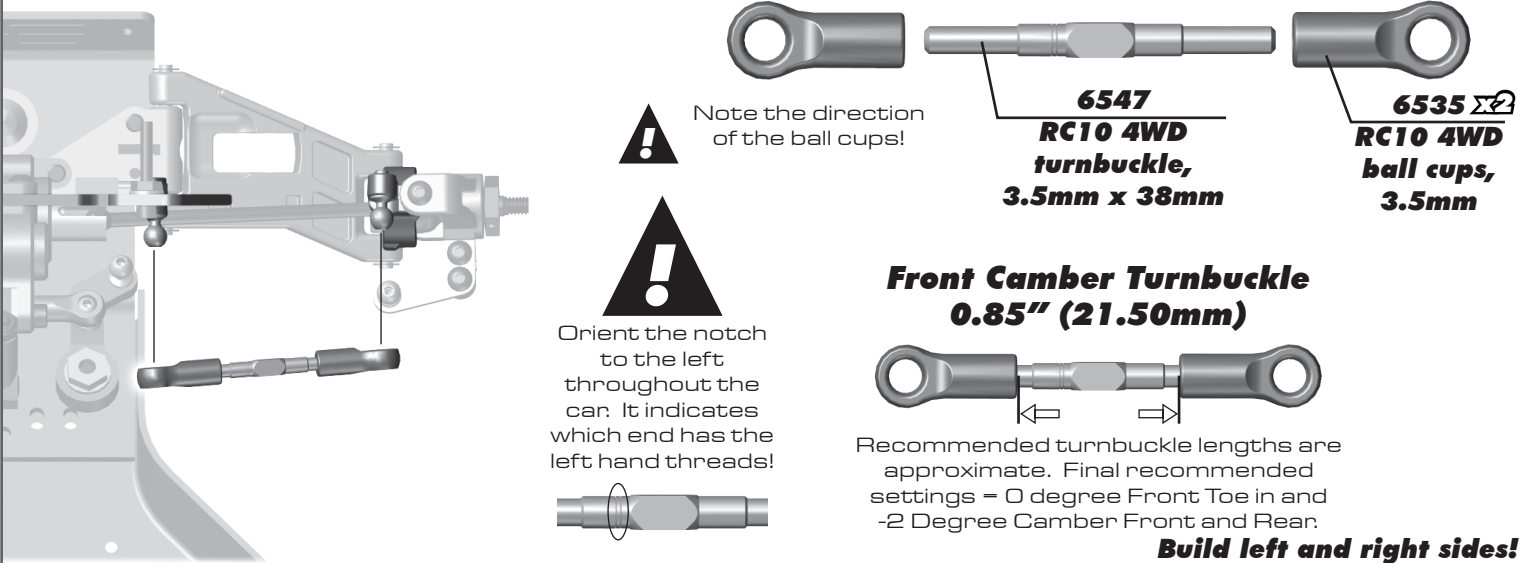

**:: Turnbuckle Build - Bag F - Step 2**

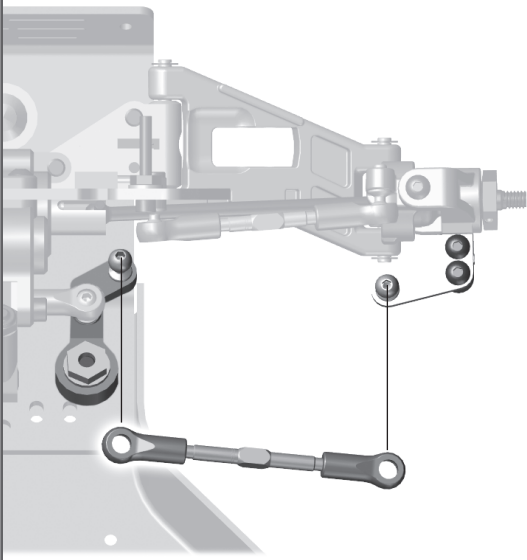

Note the direction of the ball cups!



Orient the notch to the left throughout the car. It indicates which end has the left hand threads!

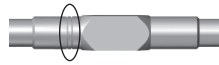

**Steering Turnbuckle  
1.18" (30.00mm)**

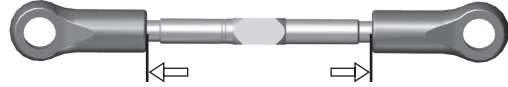

Recommended turnbuckle lengths are approximate. Final recommended settings = 0 degree Front Toe in and -2 Degree Camber Front and Rear.

**Build left and right sides!**

**:: Turnbuckle Build - Bag F - Step 3**

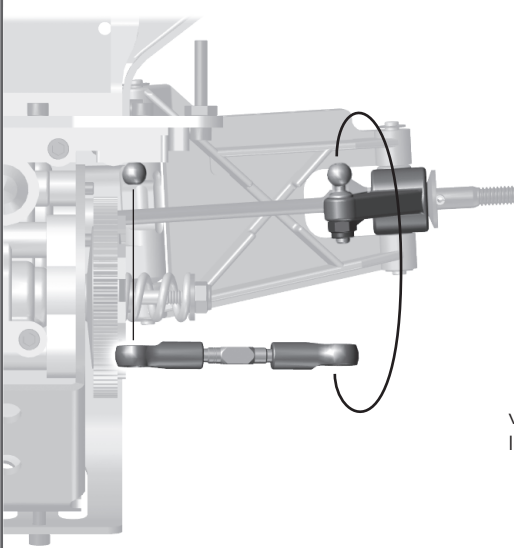

Note the direction of the ball cups!



Orient the notch to the left throughout the car. It indicates which end has the left hand threads!

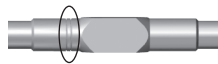

**Rear Camber Turnbuckle  
0.59" (15mm)**

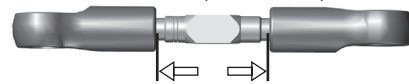

Recommended turnbuckle lengths are approximate. Final recommended settings = 0 degree Front Toe in and -2 Degree Camber Front and Rear.

**Build left and right sides!**

**:: Shocks Build - Bag G - Step 1**

**Remove spurs**

**Piston**

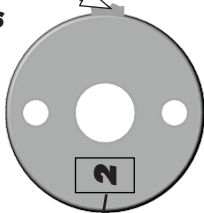

**Piston number here  
Use #1 = front shocks  
Use #1 = rear shocks**



**TIP:** Use marker to mark the piston numbers for easy identification!

**6299  
E-clip  
(small)**

**6418  
Shock shaft,  
front (0.71)**

**6417  
Shock shaft,  
rear (1.02)**

**Shock pistons  
(1, 2, 3)**

**6299  
E-clip  
(small)**



**Build two front and two rear!**

**:: Shocks Build - Bag G - Step 2**

**5407 X2 Red o-ring**

**Remove spurs**

**6440 RC10 shock rebuild kit**

**6440 Shock assembly tool**

**Front Shock**  
**6437 FT Hard Anodized shock body, front (0.71)**

**Rear Shock**  
**6435 FT Hard Anodized shock body, rear (1.32)**

**Shock fluid 50wt #5435**

**Shock fluid 35wt #5429**

**SNAP!**

**SNAP!**

**Place on table and push down hard until clamp snaps into place**

**Front shock fluid: 50wt**  
**Rear shock fluid: 30wt**

**:: Shocks Build - Bag G - Step 3**

**Front Shock**

**6440 X3 Shock downstops**

**Rear Shock**

**6440 X5 Shock downstops**

**6440 Shock cap o-ring**

**Shock pivot ball**

**Shock rod end**

**Build two front and two rear!**

**:: Shocks Build - Bag G - Step 4**

**Front shock fluid: 50wt**  
**Rear shock fluid: 30wt**

**Shock fluid**

**RC10 shock cap Gold**

**Step 1-3**      **Step 3-4**      **Step 5-6**      **Step 7**

**\* Shock Bleeding Steps:**

1. Pull shock shaft down.
2. Fill shock body 3/4 full with silicone fluid.
3. Slowly move the shock shaft up and down to remove air from under piston.
4. Wait for bubbles to come to surface.
5. Fill shock body to top with silicone fluid.
6. Place several drops of oil in the cap and on cap threads.
7. Install cap and tighten completely.
8. Slowly compress shaft all the way to the top. If there is pressure at the top of the stroke, there is too much oil. You must bleed it out.
9. Slowly pull shaft down.
10. Unscrew the cap 3/4 turn and tilt the shock at a slight angle.
11. Slowly compress the shaft to push out excess oil and air. You should see bubbles coming out from under the cap.
12. With the shaft compressed, tighten the cap and re-check for pressure at the top of the stroke. If there is still pressure, repeat steps 9 thru 11.



**:: Shocks Build - Bag G - Step 5**

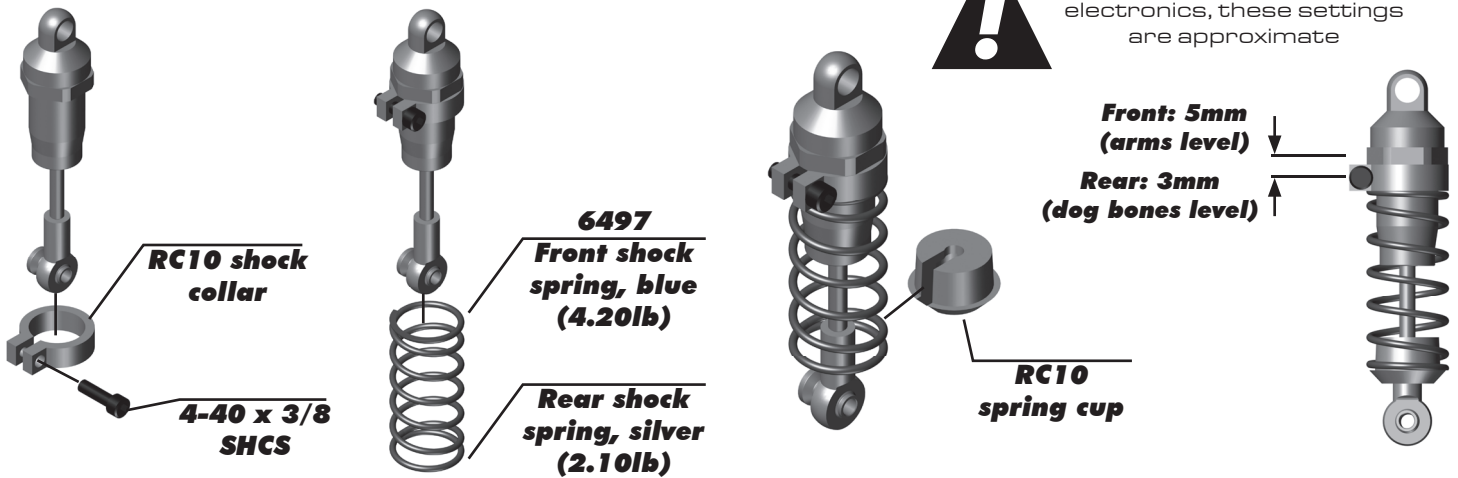

**Build two front and two rear!**

**:: Shocks Build - Bag G - Step 6**

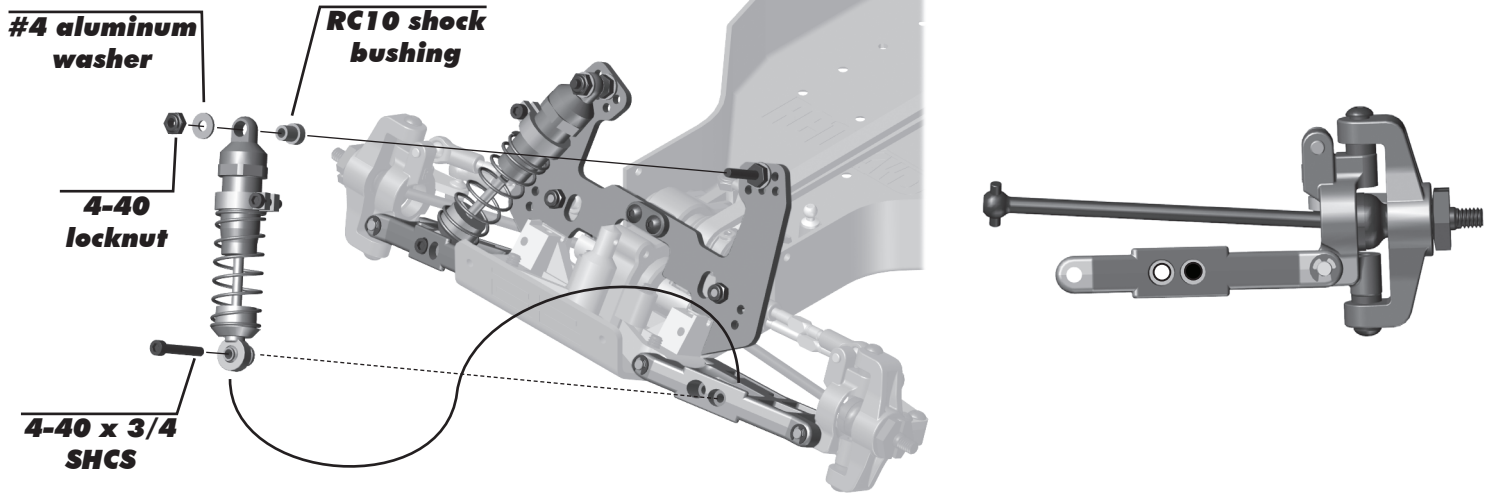

**Build left and right sides!**

**:: Shocks Build - Bag G - Step 7**

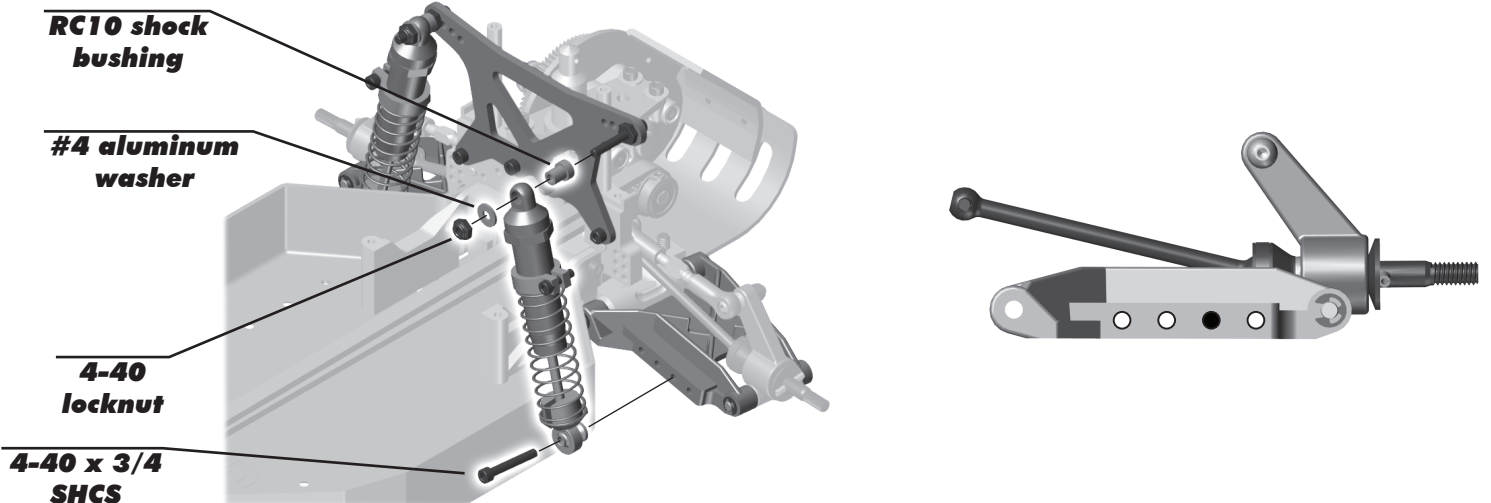

**Build left and right sides!**

**:: Chassis Build - Bag H - Step 1**

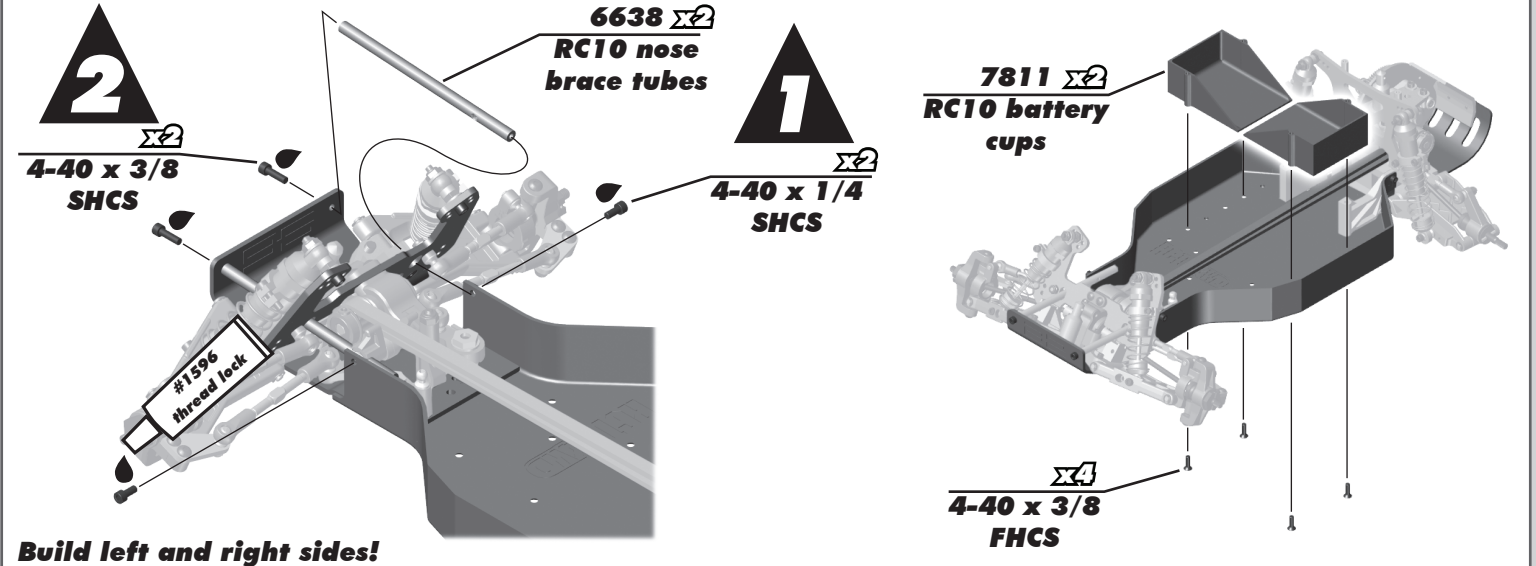

**:: Chassis Build - Bag H - Step 2**

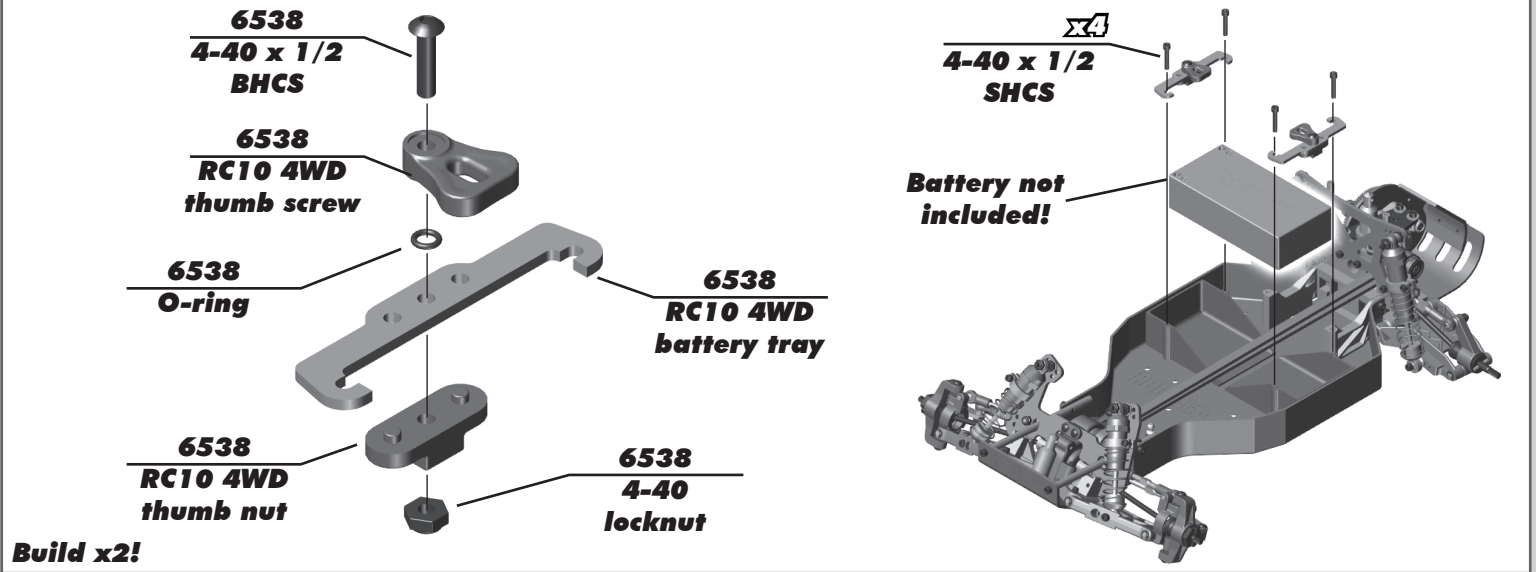

**:: Electronics Build - Bag I - Step 3**

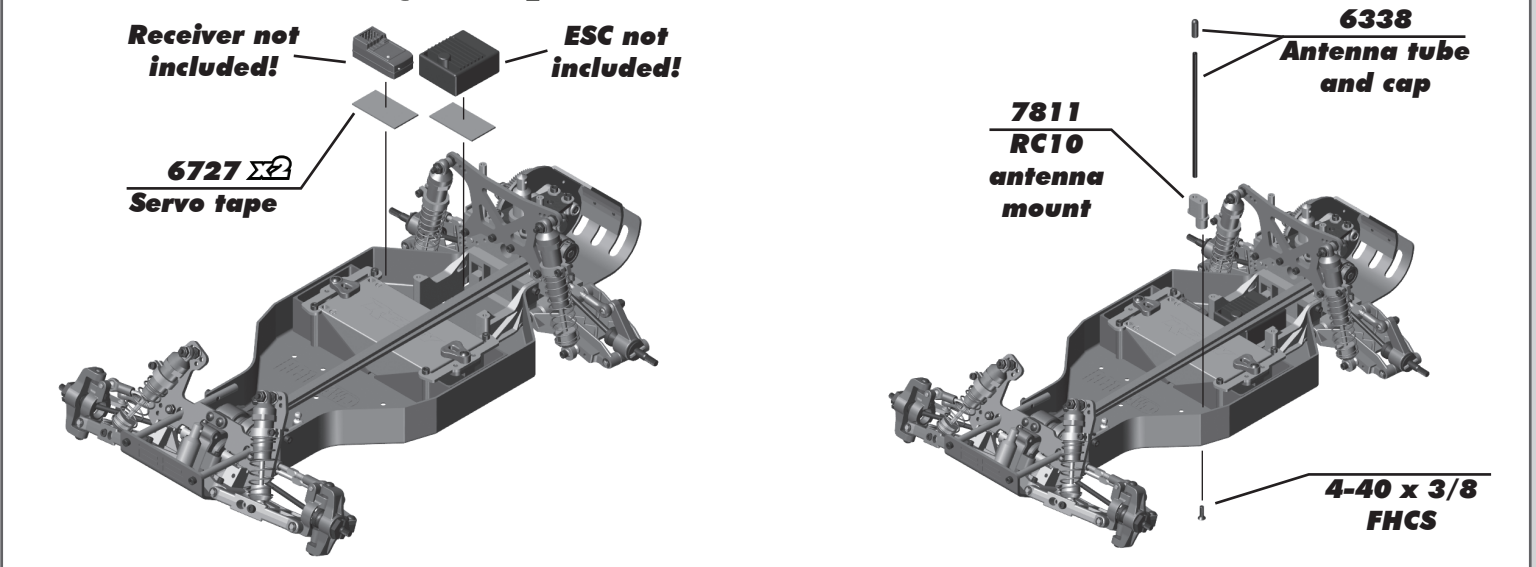

**:: Electronics Build - Bag I - Step 1**

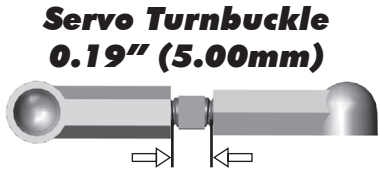
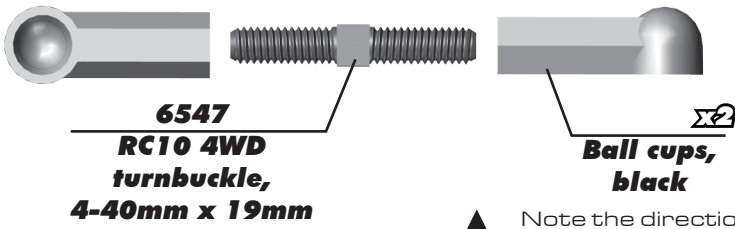

**!** Note the direction of the ball cups!

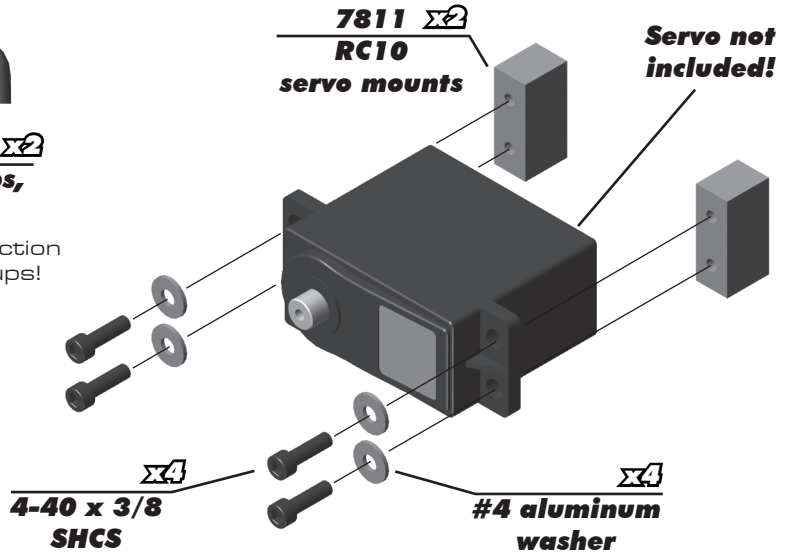

**:: Electronics Build - Bag I - Step 2**

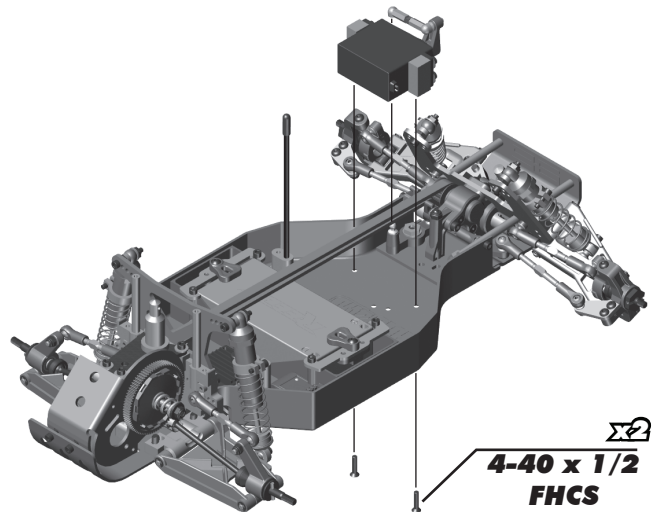
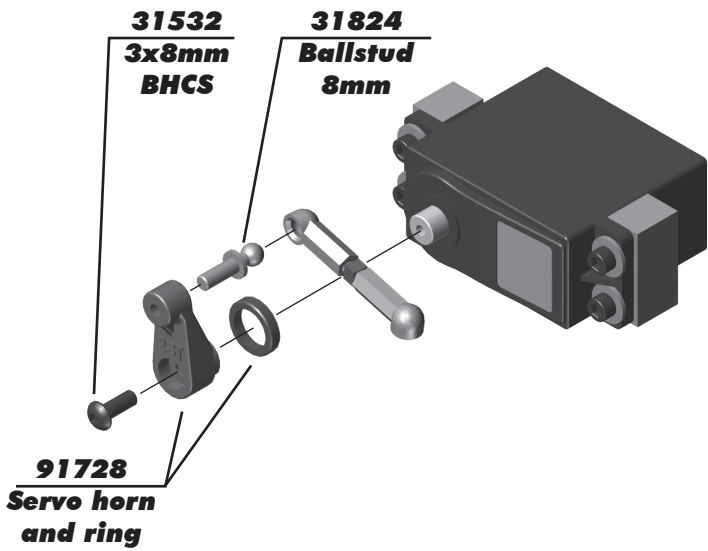

**:: Electronics Build - Bag I - Step 3**

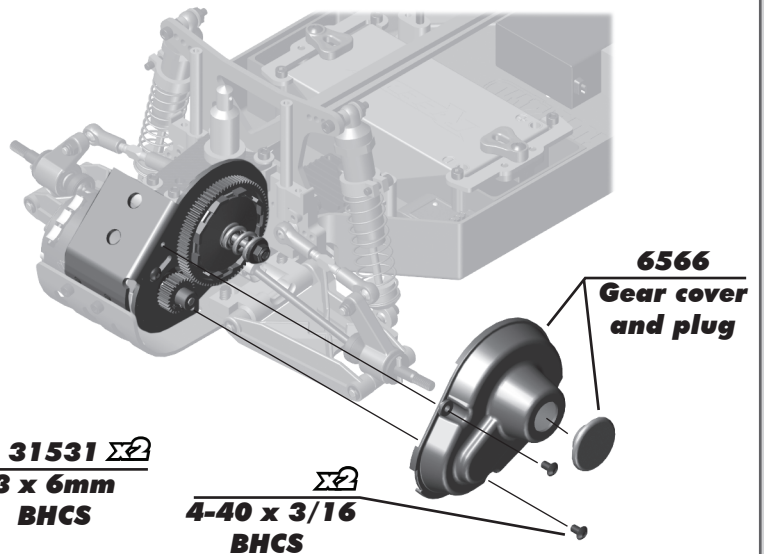
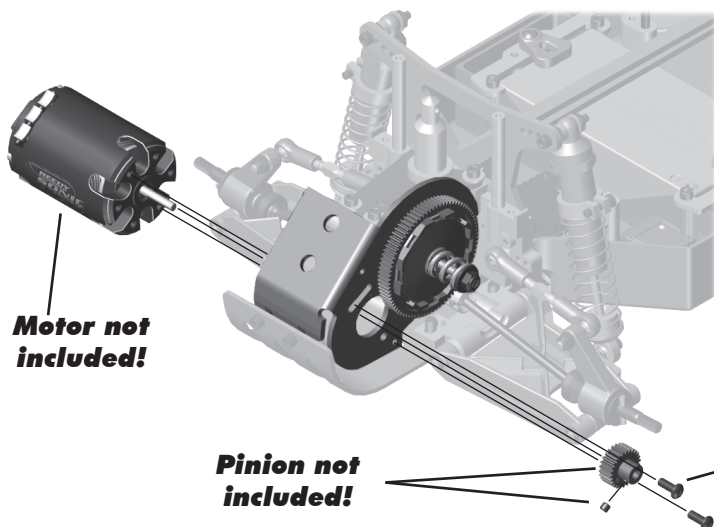

**:: Wheels / Tires and Body - Bag J - Step 1**



Clean the tire and wheel bead.  
Carefully apply CA glue (tire adhesive)  
to the tire bead on both sides.  
Do one side at a time, allow it to dry  
before gluing the other side!  
**CA glue not included!**

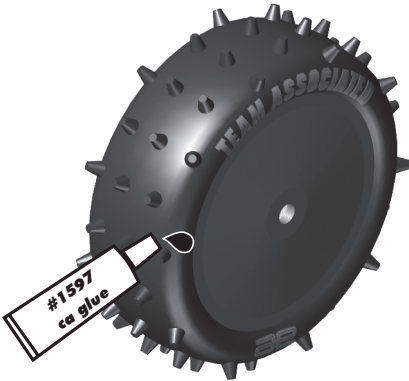

**Build 2**

**:: Wheels / Tires and Body - Bag J - Step 2**

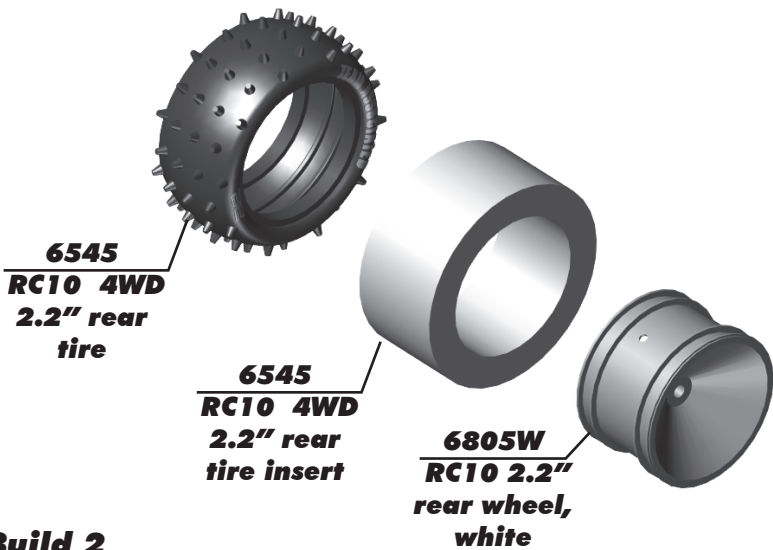

Clean the tire and wheel bead.  
Carefully apply CA glue (tire adhesive)  
to the tire bead on both sides.  
Do one side at a time, allow it to dry  
before gluing the other side!  
**CA glue not included!**

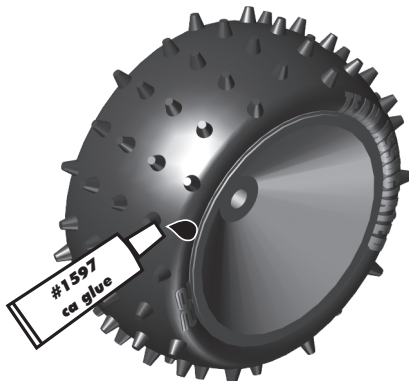

**Build 2**

**:: Wheels / Tires and Body - Bag J - Step 3**

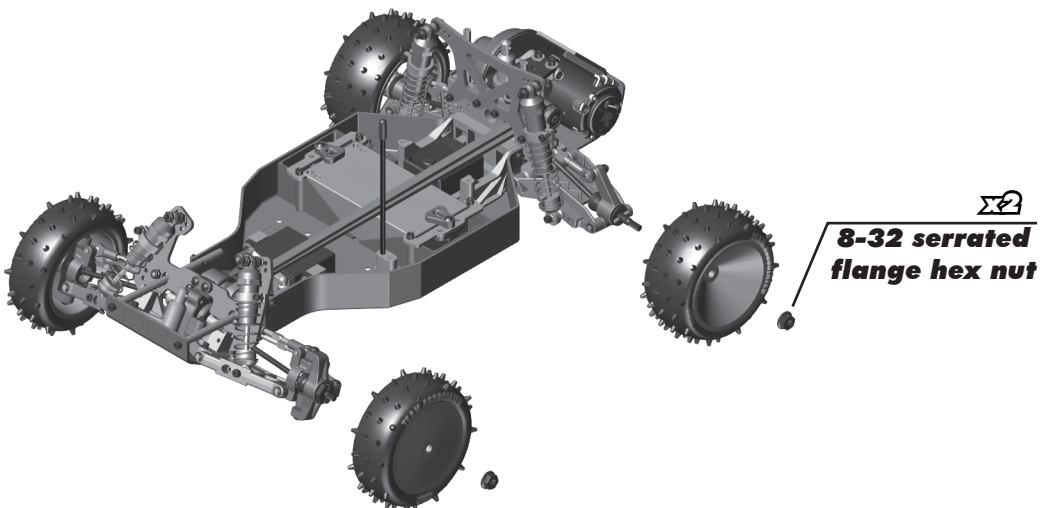

## :: Wheels / Tires and Body - Bag J - Step 4

### Painting Tips:

Your RC10 Kit comes with a clear polycarbonate body and wing. You will need to prep the body and wing before you can paint them. Wash the inside thoroughly with warm water and liquid detergent. Dry the body and wing using a clean, soft, lint-free cloth. Use high quality masking tape to make masks for the windows and install them on the inside of the body (RC cars get painted from the inside).

Using high quality masking tape, apply tape to the inside of the body to create a design. Spray (either rattle can or airbrush R/C specific paint) the paint to the inside of the body (preferably dark colors first, lighter colors last).

NOTE: use ONLY paint that is recommended for use with [polycarbonate] plastics. If you do not, you can destroy the plastic body and wing!!!!).

It is recommended to wear a mask while painting.

After the paint has dried, cut the body and wing along the trim lines. Make sure to drill or use a body reamer to make the holes for the body mounts, wing mounts, and antenna!

**6159**  
**RC10 Protec**  
**Buggy body,**  
**unpainted**

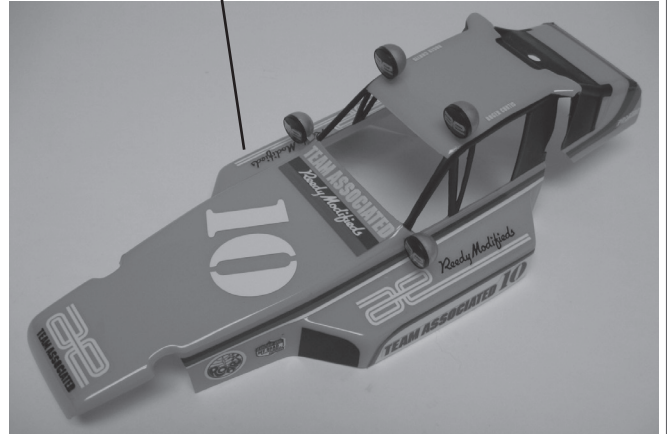

## :: Wheels / Tires and Body - Bag J - Step 5

### Light Buckets:

Press the light bucket halves together.  
Install light buckets with 2-56 x 3/16 SHCS in areas shown.

**6639**  
**Light**  
**buckets**

**x4**  
**2-56 x 3/16**  
**SHCS**

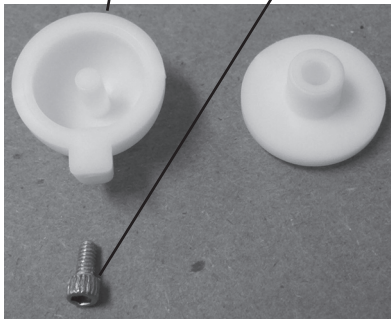

Mount the light buckets in any location of your choosing, or not at all.



**:: Wheels / Tires and Body - Bag J - Step 7**

**6332**  
Body clip

**6332**  
Body clip

**6159**  
RC10  
Protech body,  
clear

**6639**  $\Sigma 2$   
Wing  
mounts

**6182**  
High downforce  
wing, 5.5"

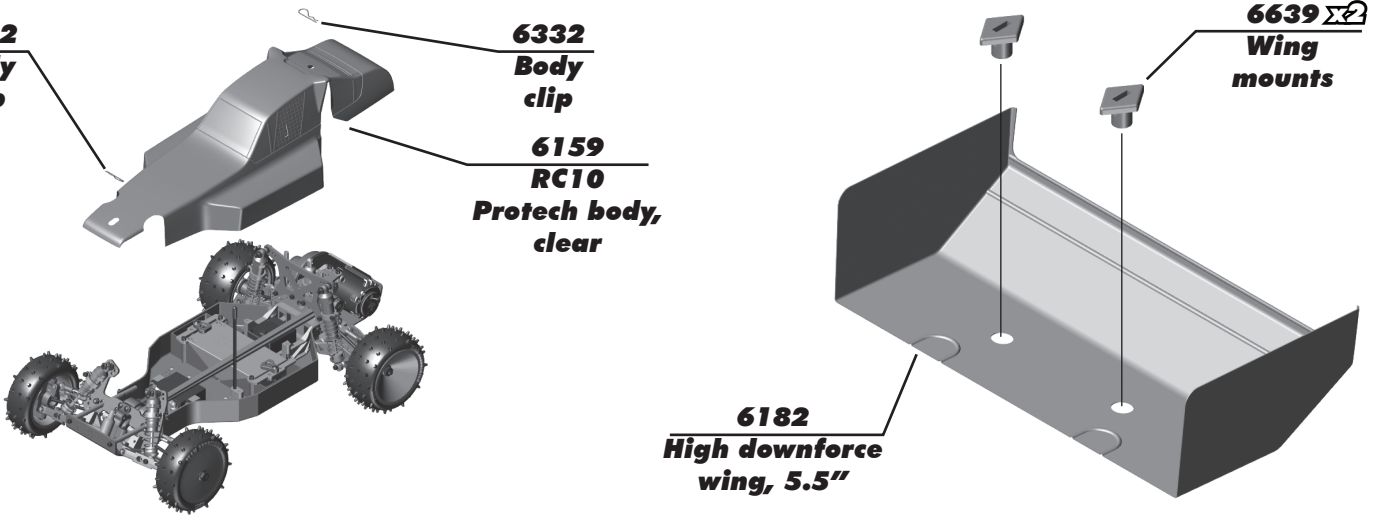

**:: Wheels / Tires and Body - Bag J - Step 8**

Wing mount  
wire

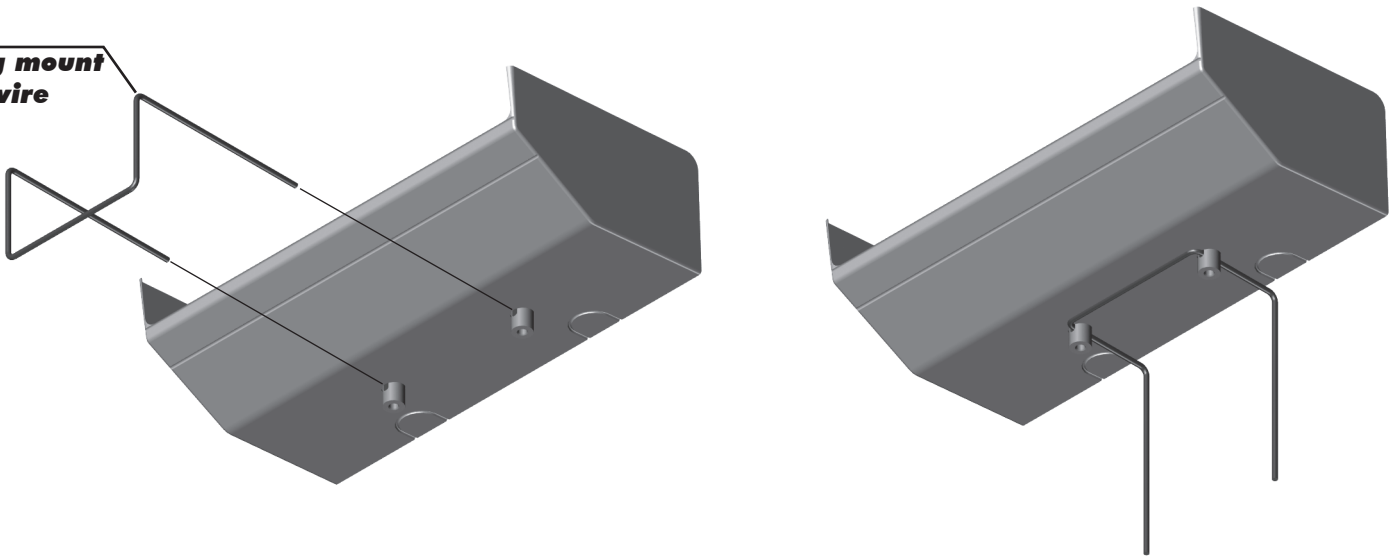

**:: Wheels / Tires and Body - Bag J - Step 9**

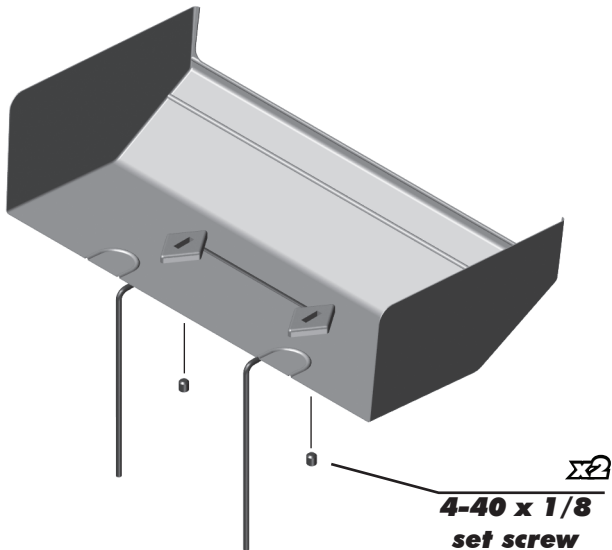

$\Sigma 2$   
**4-40 x 1/8**  
set screw

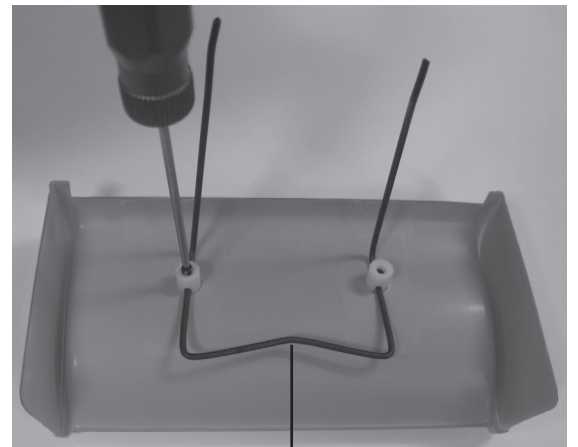

**TIP:** Bending the wire as shown can help ensure the wing buttons are parallel.

**:: Wheels / Tires and Body - Bag J - Step 10**

**TIP:** Bend wire to create tight fit inside wing tubes.

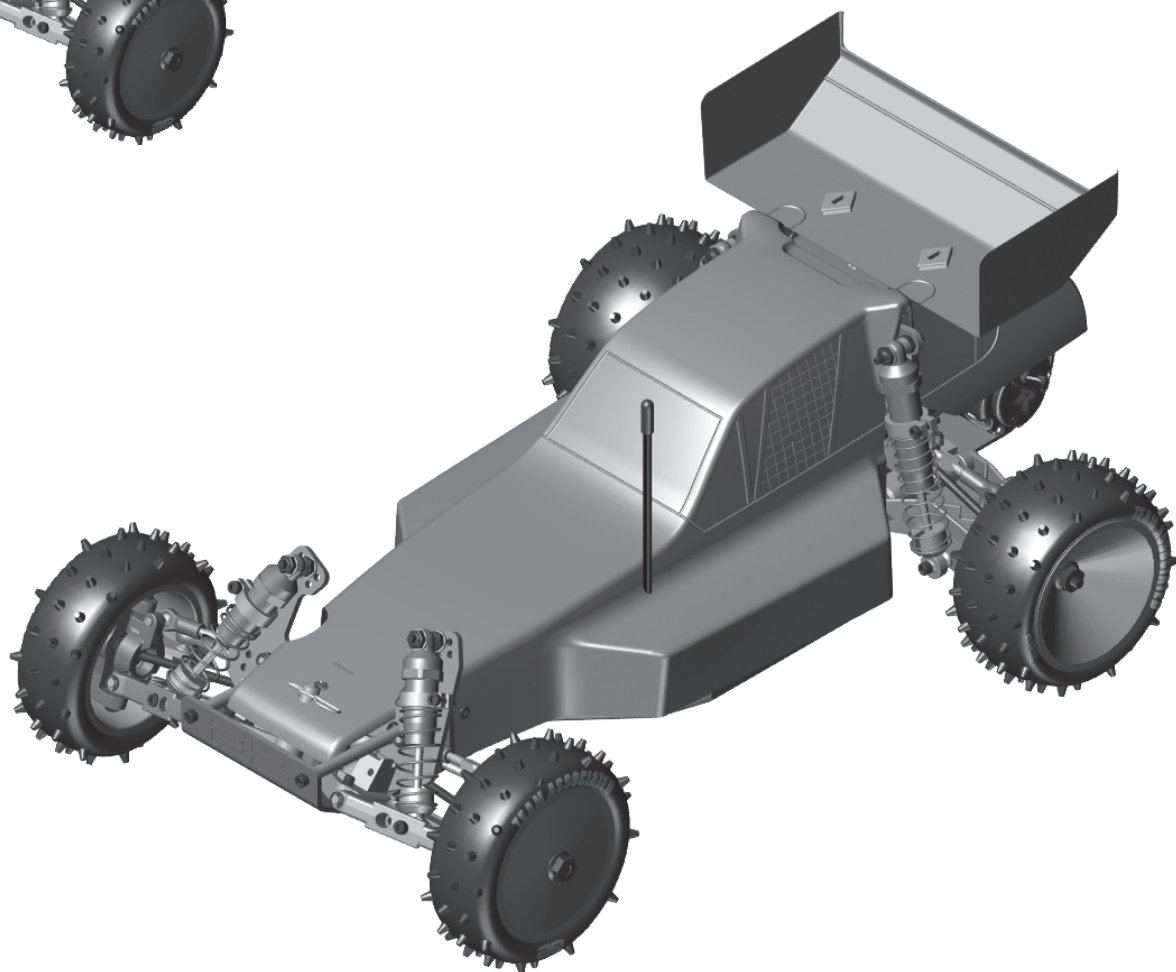
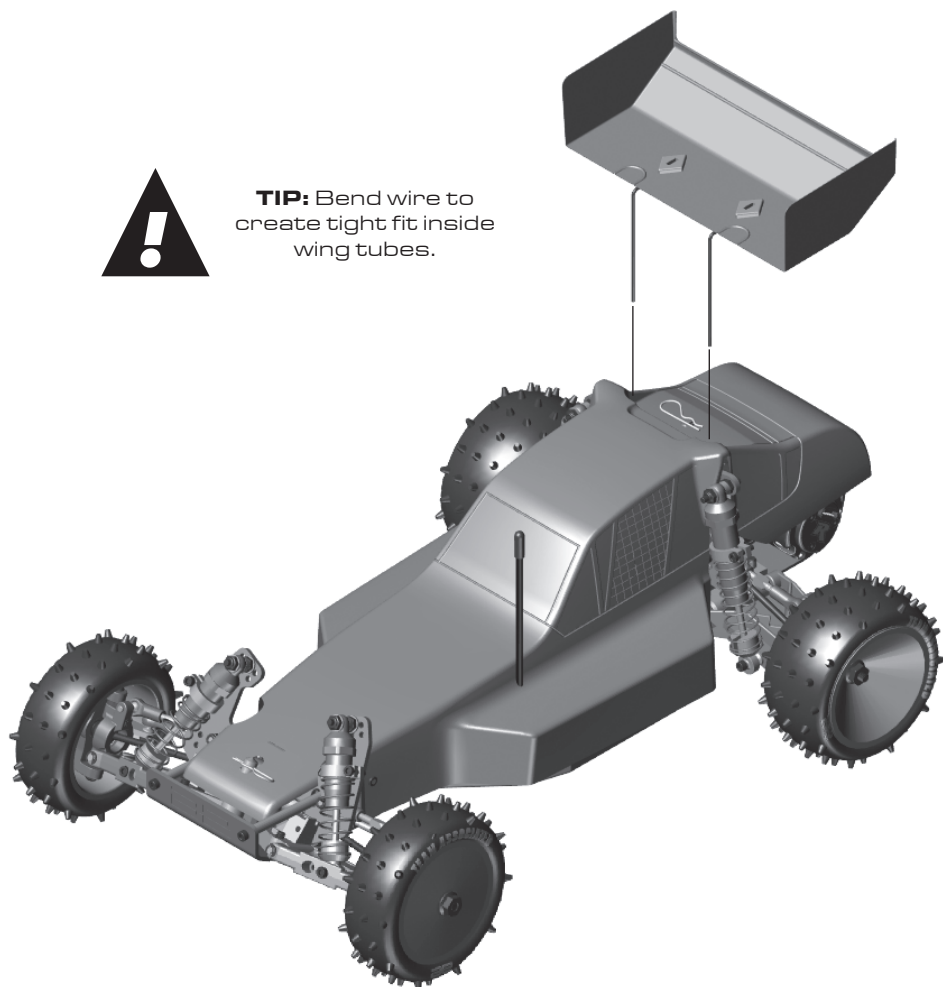

**TEAM ASSOCIATED**  
**RC10 4WD SETUP SHEET**

**Driver:** \_\_\_\_\_ **Date:** \_\_\_\_\_  
**Track:** \_\_\_\_\_ **Event:** \_\_\_\_\_  
**Conditions:** Indoor  Outdoor  **Temp.** \_\_\_\_\_ **Rev.1**

**Shock Towers**

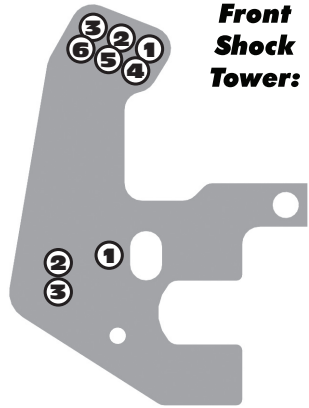

**Ride Height / Wheelbase**

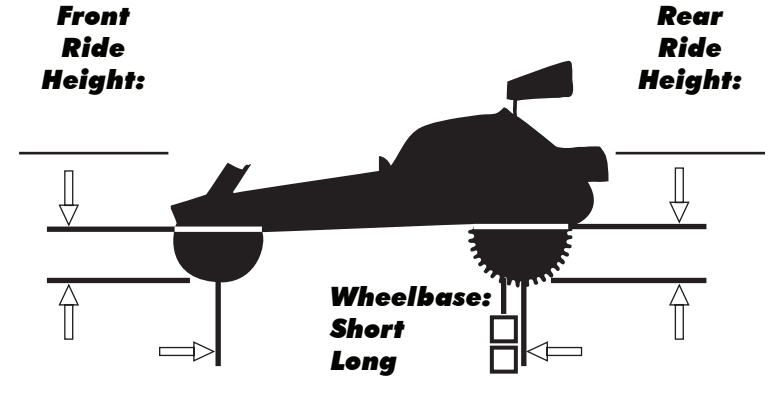

**Front Suspension**

**Camber:** \_\_\_\_\_  
**Toe:** \_\_\_\_\_

**Caster:**  
 15°   
 30°

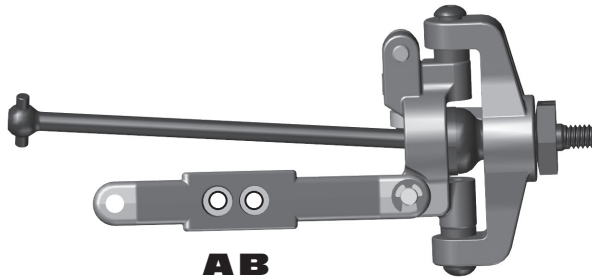

**Rear Suspension**

**Camber:** \_\_\_\_\_ **Rear Hub Carriers:** \_\_\_\_\_  
 0°   
 1.5°

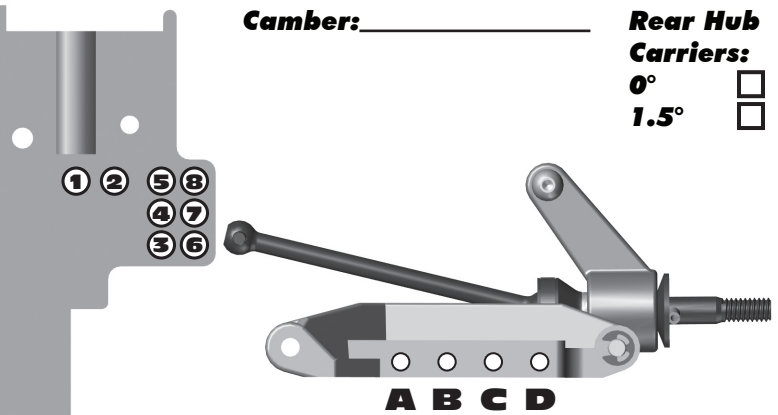

**Front Shocks**

**Spring:** \_\_\_\_\_ **Piston:** \_\_\_\_\_  
**Shock Oil:** \_\_\_\_\_ **Limiter:** \_\_\_\_\_

**Rear Shocks**

**Spring:** \_\_\_\_\_ **Piston:** \_\_\_\_\_  
**Shock Oil:** \_\_\_\_\_ **Limiter:** \_\_\_\_\_

**Motor / Battery**

**Motor & Wind:** \_\_\_\_\_  
**Pinion:** \_\_\_\_\_ **Spur Gear:** \_\_\_\_\_  
**Battery:** \_\_\_\_\_  
**Notes:** \_\_\_\_\_

**Radio / ESC Settings**

**Radio:** \_\_\_\_\_  
**Throttle / Brake e.p.a.:** \_\_\_\_\_  
**Throttle / Brake expo:** \_\_\_\_\_  
**Servo:** \_\_\_\_\_ **Steering Expo:** \_\_\_\_\_  
**ESC:** \_\_\_\_\_  
**ESC Settings:** \_\_\_\_\_

**Weight**

**Battery Placement:** \_\_\_\_\_  
**Ballast Weight:** \_\_\_\_\_  
**Notes:** \_\_\_\_\_

**Other**

**Body Type:** \_\_\_\_\_  
**Wing Type:** \_\_\_\_\_

**Front Tires**

**Tire:** \_\_\_\_\_  
**Compound:** \_\_\_\_\_  
**Insert:** \_\_\_\_\_ **Wheel:** \_\_\_\_\_

**Rear Tires**

**Tire:** \_\_\_\_\_  
**Compound:** \_\_\_\_\_  
**Insert:** \_\_\_\_\_ **Wheel:** \_\_\_\_\_

**Race and Vehicle Comments**

**Qualify:** \_\_\_\_\_ **Main:** \_\_\_\_\_ **Finish:** \_\_\_\_\_ **TQ:** \_\_\_\_\_  
**Comments:** \_\_\_\_\_  
 \_\_\_\_\_  
 \_\_\_\_\_  
 \_\_\_\_\_

**Track Info**

<b>Surface:</b>	<b>Traction:</b>	<b>Conditions:</b>	<b>Moisture:</b>
Dirt <input type="checkbox"/>	Low <input type="checkbox"/>	Grooved <input type="checkbox"/>	Wet <input type="checkbox"/>
Carpet <input type="checkbox"/>	Med <input type="checkbox"/>	Dusty <input type="checkbox"/>	Damp <input type="checkbox"/>
Astro <input type="checkbox"/>	High <input type="checkbox"/>	Smooth <input type="checkbox"/>	Dry <input type="checkbox"/>
Multi <input type="checkbox"/>		Bumpy <input type="checkbox"/>	
		Hard Pack <input type="checkbox"/>	
		Loamy <input type="checkbox"/>	



**TEAM ASSOCIATED**  
**RC10 4WD SETUP SHEET**

**Driver:** \_\_\_\_\_ **Date:** \_\_\_\_\_  
**Track:** \_\_\_\_\_ **Event:** \_\_\_\_\_  
**Conditions:** Indoor  Outdoor  **Temp.** \_\_\_\_\_ **Rev.1**

**Shock Towers**

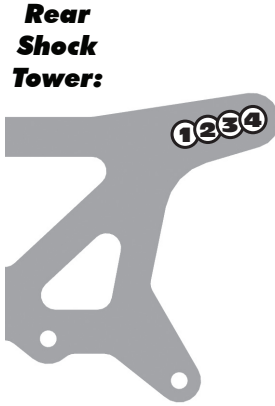
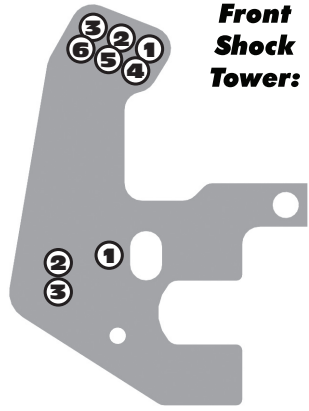

**Ride Height / Wheelbase**

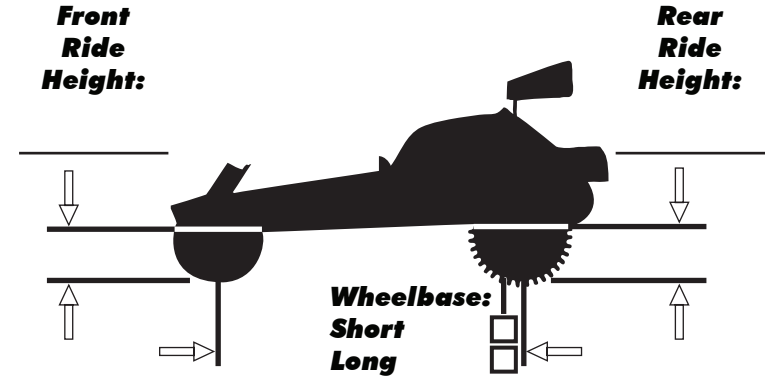

**Front Suspension**

**Camber:** \_\_\_\_\_  
**Toe:** \_\_\_\_\_

**Caster:**  
 15°   
 30°

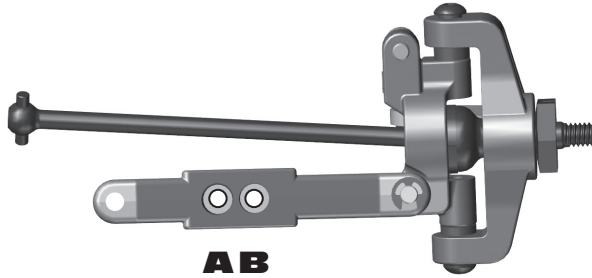

**Rear Suspension**

**Camber:** \_\_\_\_\_ **Rear Hub Carriers:**  
 0°   
 1.5°

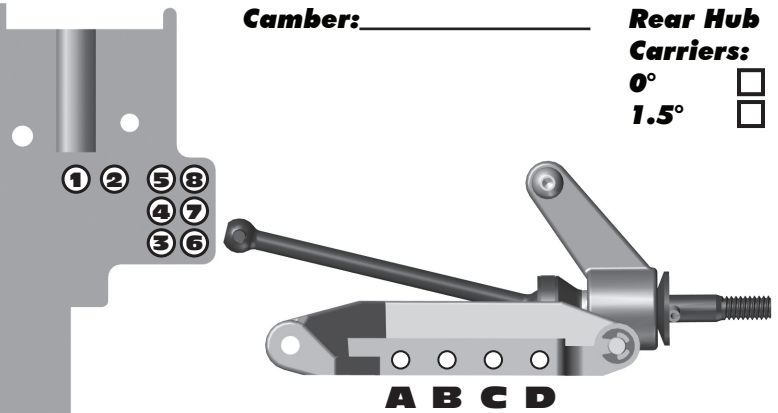

**Front Shocks**

**Spring:** \_\_\_\_\_ **Piston:** \_\_\_\_\_  
**Shock Oil:** \_\_\_\_\_ **Limiter:** \_\_\_\_\_

**Rear Shocks**

**Spring:** \_\_\_\_\_ **Piston:** \_\_\_\_\_  
**Shock Oil:** \_\_\_\_\_ **Limiter:** \_\_\_\_\_

**Motor / Battery**

**Motor & Wind:** \_\_\_\_\_  
**Pinion:** \_\_\_\_\_ **Spur Gear:** \_\_\_\_\_  
**Battery:** \_\_\_\_\_  
**Notes:** \_\_\_\_\_

**Radio / ESC Settings**

**Radio:** \_\_\_\_\_  
**Throttle / Brake e.p.a.:** \_\_\_\_\_  
**Throttle / Brake expo:** \_\_\_\_\_  
**Servo:** \_\_\_\_\_ **Steering Expo:** \_\_\_\_\_  
**ESC:** \_\_\_\_\_  
**ESC Settings:** \_\_\_\_\_

**Weight**

**Battery Placement:** \_\_\_\_\_  
**Ballast Weight:** \_\_\_\_\_  
**Notes:** \_\_\_\_\_

**Other**

**Body Type:** \_\_\_\_\_  
**Wing Type:** \_\_\_\_\_

**Front Tires**

**Tire:** \_\_\_\_\_  
**Compound:** \_\_\_\_\_  
**Insert:** \_\_\_\_\_ **Wheel:** \_\_\_\_\_

**Rear Tires**

**Tire:** \_\_\_\_\_  
**Compound:** \_\_\_\_\_  
**Insert:** \_\_\_\_\_ **Wheel:** \_\_\_\_\_

**Race and Vehicle Comments**

**Qualify:** \_\_\_\_\_ **Main:** \_\_\_\_\_ **Finish:** \_\_\_\_\_ **TQ:** \_\_\_\_\_  
**Comments:** \_\_\_\_\_  
 \_\_\_\_\_  
 \_\_\_\_\_  
 \_\_\_\_\_

**Track Info**

<b>Surface:</b>	<b>Traction:</b>	<b>Conditions:</b>	<b>Moisture:</b>
Dirt <input type="checkbox"/>	Low <input type="checkbox"/>	Grooved <input type="checkbox"/>	Wet <input type="checkbox"/>
Carpet <input type="checkbox"/>	Med <input type="checkbox"/>	Dusty <input type="checkbox"/>	Damp <input type="checkbox"/>
Astro <input type="checkbox"/>	High <input type="checkbox"/>	Smooth <input type="checkbox"/>	Dry <input type="checkbox"/>
Multi <input type="checkbox"/>		Bumpy <input type="checkbox"/>	
		Hard Pack <input type="checkbox"/>	
		Loamy <input type="checkbox"/>	

# FIND IT ON ASSOCIATEDELECTRICS.COM

## CARS & TRUCKS



### Vehicle Spare Parts

GO TO:

[AssociatedElectrics.com](#) →  
[Team Associated tab](#) →  
[Cars & Trucks](#) →  
[Scroll to your vehicle](#) →  
[Parts & Accessories link](#)

## SETUP SHEETS & MANUALS



### Setups and Manuals

GO TO:

[AssociatedElectrics.com](#) →  
[Team Associated tab](#) →  
[Manuals & Setups](#) →  
[Scroll to your vehicle](#)

## A-TEAM APPS



### Tuning Guides & Tips

GO TO:

[AssociatedElectrics.com](#) →  
[Support](#) →  
[A-Team Apps](#)



**Associated Electrics, Inc.**

**21062 Bake Parkway Lake Forest, CA 92630 USA**

**call: (949) 544-7500 - fax: (949) 544-7501**

**Check out the following web sites for all of our kits, current products,  
new releases, setup help, tips, and racing info!**

**[www.AssociatedElectrics.com](http://www.AssociatedElectrics.com)**

## FOLLOW US ON SOCIAL MEDIA



**TeamAssociated**  
**ReedyPower**  
**ElementRC**  
**Factory Team**



**@TeamAssociatedRC**  
**@ReedyPower**  
**@Element\_RC**  
**@FactoryTeam\_RC**



**@Team\_Associated**  
**@ReedyPower**



**@Associated\_Electrics**