

Front Suspension:

Reset Forms

Ride Height:	22 mm
Camber:	-1.5
Toe:	+1/2"
Arm Type:	#71103 Flat, Standard
Tower Type:	#71115 Flat
Caster Block Insert:	5°
Steering Block:	4
Bulkhead Type:	#91659 Brass
Kick-Up Angle:	25°
Wheel Hex:	#71111 8.5 mm Steel
Notes:	#1366 FT Aluminum Servo Horn, 25T #91667 Plastic Steering Rack #91668 Aluminum Steering Bellcranks

Anti Roll Bar:

White (1.2mm)

Gray (1.3mm)

Blue (1.4mm)

Other:

Bump Steer Spacing: 1 mm

Axle Height:

+3

+2

+1

0

Ball Stud Spacing: 1 mm

Steering Plate: #91680 +1

Steering Stop Spacing: 0 mm

Caster Block Spacing: 1 mm

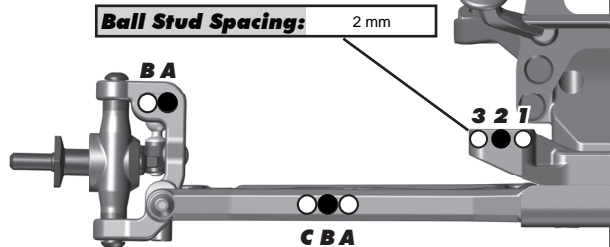
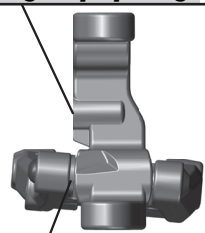
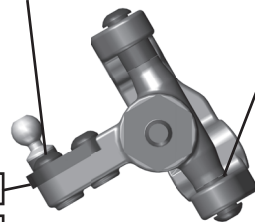

Rear Suspension:

Ride Height:	22 mm
Camber:	-1.5
Arm Type:	#71105 Standard
Tower Type:	#71116 Standard
Wheel Hex:	#91610 FT 7.0 mm
Hub Spacing:	Forward <input type="checkbox"/> Middle <input type="checkbox"/> Back <input checked="" type="checkbox"/>
Shock Mounting Position:	Front of Arm <input checked="" type="checkbox"/> Rear of Arm <input type="checkbox"/>
Notes:	

Anti Roll Bar:

White (1.1mm)

Gray (1.2mm)

Blue (1.3mm)

Other: _____

Rear Hub Link Setting:

Plastic Hub Aluminum Hub Ball Stud Spacing: 3 mm

Up Down

C Mount Inserts: 1° 0.5°

Aluminum Brass

D Mount Inserts: 1° 0.5°

Aluminum Brass

Hub Insert:

+3 +2 +1 0

Ball Stud Spacing: 4 mm

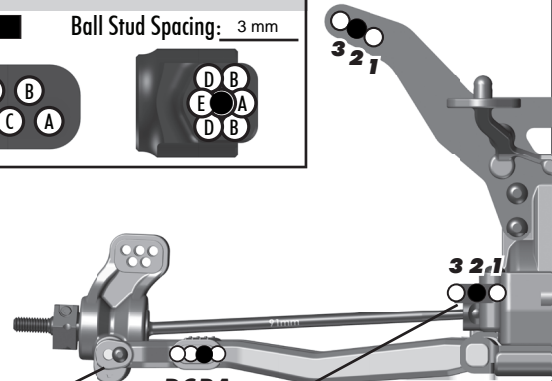

Electronics:

Radio:	Sanwa M12S	Servo:	#27101 Reedy RT1508
EPA: Throttle:	100 %	Brake:	95 %
ESC:	#27004 Reedy Blackbox 510R		
ESC Settings:	N/A		
Motor:	#626 Reedy M3		
Wind:	6.5	Timing:	20°
Pinion:	20	Spur:	81
Battery:	#27323 Reedy Zappers SG 5800 mAh 80C		
Battery Position:	4F		

Drivetrains:

Transmission:

3 Gear: **Laydown:**

4 Gear: **Layback:**

Differential: **Ball Diff:**

Height: 2 **Gear Diff:**

Notes: 5,000 - 4 Gear

Slipper Clutch:

Type: Team Associated

of Pads: 2 x #91197 LCF

Shocks:

	Front	Rear
Piston:	2 x 1.6	2 x 1.7
Fluid:	40 wt	35 wt
Spring:	#91835 V2 Red	#91639 Green
Limiters:	1	1
Stroke:	27 mm	35 mm
Eyelet Length:	Long	Short
Cup Offset:	5 mm	5 mm
Notes:	#91494 Machined Shock Spacers	

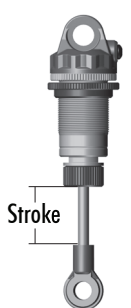

Track Info:

Size: Small Medium Large Extra Large

Surface: Dirt Carpet Astroturf Multi Surface

Traction: Low Medium High Very High

Moisture: Dry Damp Wet

Condition: Indoor Outdoor Dusty Hard Packed

Bumpy Grooved Smooth Loamy

Temperature: Ambient: 60F Track: 60F

Notes:

Tires:

Front Tires: Schumacher Handout

Front Compound: Yellow

Front Insert: JConcepts Open Cell

Rear Tires: Schumacher Handout

Rear Compound: Yellow

Rear Insert: JConcepts Open Cell

Wheel (F/R): #7852 Team Associated

Notes:

Body, Wing, Weight:

Body: Team Associated Kit

Team Associated Kit Spoiler

Servo Weights:

None Aluminum Steel Other

Electronic Weights:

None Aluminum Steel Other

Total Vehicle Weight:

Vehicle Comments:

Notes: #91620 & 91624 Chrome Shock Shafts; #91577 & 91579 Fox Shock Bodies