



PARTS LIST
in numerical order

First use the exploded drawings on the following pages to locate the part you need. Then look up it's part number in the left column in numerical order.

Can't find the part you're looking for? See later sections for parts not in the exploded drawing.

Prices subject to change without notice.

Typographic errors or other product pricing/description errors will not be honored.

Parts subject to availability.

Part #	Description	Qty	Price
3216	WASHER, #4	12	1.00
3438	ALUM. LOCKNUT, 8-32 (standard height)	3	1.50
3976	BALL BEARING, 3/8 x 5/8 unflanged	pr	7.00
3977	BALL BEARING, 3/16 x 3/8, unflanged, rubber sealed	pr	6.00
4187	NYLON SPACERS	8	1.00
5407	RED SILICONE "O" RINGS only, as used in rebuild kits #6440	8	2.00
6222	SELF-THREADING NYLON LOCKNUT, for #6220 axles	8	2.00
6270	SHORT BALL ENDS, steel, (4-40 threaded ball studs) w/plastic end caps	2	2.50
6272	FOAM BALL END DUST COVER	28	2.00
6273	LONG BALL END, .17 ball male 4-40 thread, .10" longer thread than #6270, with cups and nuts. Stainless steel.	2	2.50
6285	SOCKET HEAD screw, 4-40 x 1/4"	8	2.00
6292	FLAT HEAD Socket screw, 4-40 x 3/8"	6	2.00
6295	4-40 NUTS, 6 each, plain nut, nylon & steel locknuts	18	2.00
6299	1/8" E-CLIP	12	1.00
6332	HOOD PINS	6	.75
6338	ANTENNA KIT, tube & cap	1	2.00
6372	DOGBONE SPRING & SPACER	4	.75
6375	ROLL PIN for stub axle. Fits #6374 or 7362 rear axles	6	.75
6568	SPUR GEAR SCREW, 4-40 x 3/16" button head	4	1.50
6571	DRIVE GEAR/SHAFT ASSEMBLY, roll pin	1	9.00
6572	DRIVE SHAFT ROLL PIN	6	1.00
6573	DIFF THRUST WASHER	2	3.00
6574	PRECISION THRUST BALLS, 5/64"	6	2.00
6575	DIFF THRUST BOLT, Thrust Bearing Cover, Dogbone Spacers & Locking T-nut	set	2.00
6581	CARBIDE DIFF BALLS, large 3/32"	12	12.00
6582	DIFF THRUST SPRING	1	1.50
6587	TORQUE CONTROL SPRING & LOCKNUT	set	1.50
6589	BALL BEARING, 5/32" x 5/16" unflanged	pr	13.00
6594	THRUST BEARING WASHER, replaces #6586 thrust bearing	set	2.00
6597	BUSHING, 5/32" x 5/16" unflanged	2	1.00
6598	BUSHING, 3/8" x 5/8" unflanged	2	1.50
6599	BUSHING, 3/16" x 3/8" unflanged	4	2.00
6629	LOCKNUT 5-40	2	1.00
6727	SERVO TAPE STRIP, 1.5" x 6"	2	2.00
6903	BALL BEARING, 3/8" x 5/8" unflanged, PTFE sealed	pr	20.00
6906	BALL BEARING, 3/16" x 3/8" unflanged, PTFE sealed	pr	13.00
6915	FLAT HEAD screw, 4-40 x 5/8	6	2.00
6917	BUTTON HEAD screw, 4-40 x 3/8	6	2.00
6918	BUTTON HEAD Socket screw, 4-40 x 1/2"	6	2.00

6922	FLAT HEAD Socket screw, 4-40 x 1/2"	6	2.00
6923	FLAT HEAD Socket screw, 4-40 x 3/4"	6	2.00
6924	SOCKET HEAD screw, 4-40 x 3/8	6	2.00
6928	SOCKET HEAD Cap screw, 4-40 x 1"	6	2.00
6932	SOCKET HEAD screw, 4-40 x 5/16	6	2.00
6936	ALUMINUM WASHER, #4	10	1.00
6951	SET SCREWS & WRENCH, 4-40 x 1/8"	6	2.50
7205	FRONT SUSPENSION ARMS molded composite. Will not fit older trucks	pr	7.00
7210	T3/B3 FRONT BLOCK CARRIER, 30° caster	pr	3.00
7211	T3/B3 KINGPIN BALL END	2	4.00
7212	T3/B3 FRONT BLOCK CARRIER, 25° caster	pr	4.50
7213	MOLDED COMPOSITE FRONT SHOCK TOWER	1	4.00
7217	SHOCK ROD END, nylon with plastic pivot ball	2	3.00
7220	T3/B3 FRONT STEERING BLOCK	pr	2.00
7221	T3/B3 FRONT AXLE, aluminum, w/#6222 nuts	2	6.00
7223	T3 FRONT ARM SHOCK MOUNT, molded composite	2	2.00
7230	PLASTIC BALL END CUPS, molded	12	5.00
7253	TURNBUCKLE, 2.62". Upper control rod, tie rod	1	3.00
7260	THIN PLAIN NUT, 4-40	12	2.00
7302	T3/B3/B2 CHASSIS, LONG, molded composite. Max. length for B3/B2. Uses #9330 or #9331 battery strap.	12	2.00
7308	T3 CHASSIS, EXTRA LONG, molded composite. Uses #7333 or #7334 battery strap.	1	25.00
7321	T3 FRONT BODY MOUNT	1	4.00
7330	T3/B3/B2 BATTERY HOLD DOWN STRAP, LONG, molded composite for #9198 or #7302 chassis	1	3.00
7333	T3/B3/B2 BATTERY HOLD DOWN STRAP, EXTRA LONG, molded composite for #7308 or #7309 chassis	1	3.00
7336	SERVO MOUNT KIT, plastic parts, spacer and screws	set	2.50
7337	SMALL WASHER, steel (gold)	4	1.00
7340	T3 REAR SUSPENSION ARMS, molded composite	pr	7.00
7341	T3 ARM SHOCK MOUNT, molded composite	pr	2.00
7351	T3 REAR SHOCK TOWER, molded composite	1	5.00
7359	BALL BEARING, 1/4 x 3/8" unflanged, for #6374 or 7362 rear axles.	pr	15.00
7360	BUSHING, 1/4 x 3/8" unflanged, for #6374 or 7362 rear axles.	4	2.00
7361	DOGBONE. Use with #6374 or #7378 rear stub axles	1	7.00
7366	T3/B3/B2 REAR HUB CARRIER, 0° toe-in, molded composite	pr	3.50
7368	REAR AXLE SHIMS 3/16" I.D. x .010", fits MIP® CVD's and #7367 axles.	14	1.50
7369	1/16" REAR AXLE ROLL PINS, fits MIP® CVD's and #7367 axles.	4	1.00
7373	MOTOR PLATE GASKET, neoprene, for T3/B3/B2	1	1.50
7377	REAR AXLE BEARING SPACER, aluminum (fits only the #7367 rear axle and MIP® CVD's)	2	1.50
7378	REAR STUB AXLE, 3/16"	1	5.00
7379	MIP® CVD (Constant Velocity Drive) BONE, for T2/T3/GT	1	11.50
7380	MIP® CVD AXLE, for T2/T3/GT	1	8.00
7381	MIP® CVD REBUILD KIT	set	8.50
7383	MIP® CVD'S, rebuildable universal axles, for two axles, for T3/T2/GT	pr	35.50
7413	BUTTON HEAD SOCKET Screw, 4-40 x 3/4"	6	2.00
7669	DRIVE SHAFT SPACER	6	2.00
7673	FLAT HEAD Socket screw, 4-40 x 5/16"	6	2.00
7874	SOCKET HEAD Cap screw, 4-40 x 7/16"	6	2.00
8252	PRECISION MACHINED 48 pitch PINION GEAR, 15 tooth	1	6.00
8846	SHOCK PRELOAD SPACER, 4 each of 4 different sizes	1	3.00
9110	T3/B3/B2 FRONT INNER HINGE PIN, with E-clips	2	5.00
9115	T3/B3/B2 FRONT OUTER HINGE PIN, with E-clips	2	3.00
9120	T3/B3/B2 FRONT CROSS BRACE, steel	1	1.50
9125	T3/B3/B2 FRONT BULKHEAD, molded composite	1	4.00
9130	T3/B3/B2 FRONT TOP PLATE, molded composite	1	5.00
9145	BALL END, long thread (low profile black) with nuts	1	3.00

	and plastic ball end cups		
9155	SERVO SAVER & BELLCRANK	1	2.00
9158	SERVO SAVER TUBE & NUT	1	4.50
9160	SERVO SAVER & BELLCRANK MOUNTING PINS	2	3.00
9165	T3/B3/B2 STEERING DRAG LINK, molded	1	2.00
9170	T3/B3/B2 ADJUSTABLE SERVO LINK, 4-40 x 1/2" set screw with special plastic ball cups	1	2.00
9180	SERVO HORNS, molded (1 ea. fits Airtronics, Futaba, Hitec or JRpropo)	1	2.50
9210	T3/B3/B2 FRONT KICKUP, aluminum, black anodized	1	7.50
9215	FLAT HEAD Machine Screw, 6-32 x 3/16"	6	1.50
9220	T3/B3/B2 FRONT BUMPER	1	2.50
9235	T3/B3/B2 BATTERY PADS, adhesive foam pads for sides and bottom of battery slot	set	3.00
9238	T3/B3/B2 BATTERY PADS, foam pads for spacing battery to adjust weight bias	2	2.00
9241	T3/B3/B2 REAR CHASSIS PLATE, aluminum, black hard anodized	1	9.00
9245	T3/B3/B2 REAR MOTOR MOUNT, aluminum, black anodized	1	6.00
9247	T3/B3/B2 GEAR DUST COVER, with black insert button	1	1.50
9248	T3/B3/B2 GEAR DUST COVER, with black insert button. Fits Losi Hydra Drive and Schumacher Viscous Drive	1	1.50
9251	TORQUE CONTROL HUB, inner	1	7.50
9252	TORQUE CONTROL HUB, outer	1	7.50
9253	CLUTCH DISC for #9251 and #9252 torque control hubs	1	3.00
9260	T3/B3/B2 REAR INNER HINGE PIN, with E-clips	pr	3.00
9263	T3/B3/B2 REAR OUTER HINGE PIN, with E-clips	pr	2.50
9267	T3/B3/B2 REAR SUSPENSION MOUNTS, 3° toe-in per side and 3° of anti-squat	pr	2.00
9268	T3/B3/B2 REAR SUSPENSION MOUNTS, 3° toe-in per side and 0° of anti-squat	pr	2.00
9269	FLAT HEAD SOCKET Screw, 5-40 x 1/2"	6	2.00
9350	T3/B3/B2 2.40:1 TRANNY TRANSMISSION KIT, with ball bearings & Associated Torque Control	1	120.00
9352	T3/B3/B2 2.40:1 STRANNY TRANSMISSION CASE, right & left sides with motor plate spacers	set	9.00
9360	T3/B3/B2 IDLER GEAR, molded	1	2.00
9361	T3/B3/B2 IDLER GEAR SHAFT	1	2.00
9365	T3/B3/B2 DIFF GEAR, 2.40:1	1	2.50
9367	T3/B3/B2 DIFF DRIVE RING, 2.40:1	2	1.50
9370	T3/B3/B2 LEFT DIFF OUTDRIVE HUB, 2.40:1	1	7.50
9375	T3/B3/B2 RIGHT DIFF OUTDRIVE HUB, 2.40:1	1	7.50
9380	T3/B3/B2 TRANSMISSION BRACE, molded composite	1	4.00

Most items following are not found in the exploded drawings

FACTORY TEAM OPTIONS



SP-406	FACTORY TEAM CAP, BLUE	1	15.95
SP-407	FACTORY TEAM CAP, BLACK	1	15.95
1105	GREEN SLIME SHOCK LUBE	1	2.50
1110	FACTORY TEAM TURNBUCKLE WRENCH	1	1.50
1280	FACTORY BLUE TITANIUM TURNBUCKLE, 2.62"	set	30.00
1408	FACTORY BLUE TITANIUM TURNBUCKLE KIT, 2.62"	pr	10.00
1521	T3 FACTORY TEAM TITANIUM TURNBUCKLE/HINGE PIN COMBO, complete set	1	43.00
1595	CHASSIS LEAD WEIGHTS, 1/4 OZ	12	3.00
1596	FACTORY TEAM LOCKING ADHESIVE	10ml	3.95
1597	FACTORY TEAM TIRE ADHESIVE	1	6.95
1603	T3 TITANIUM HINGE PIN SET, complete	1	15.00
6312	CHASSIS PROTECTIVE SHEET	1	8.50

6416	UNOBTAINIUM SHOCK SHAFT 1.32 Stroke, rear	1	6.00
6417	UNOBTAINIUM SHOCK SHAFT 1.02 Stroke, front	1	6.00
6860	SOCKET HEAD Cap screw, 4-40 x 7/8"	2	1.00
6933	ALUM. FLAT HEAD Socket screw, 4/40 x 5/16"	6	2.00
6934	ALUM. FLAT HEAD Socket screw, 4/40 x 3/8"	6	2.00
6935	ALUM. SOCKET HEAD Cap screw, 4/40 x 1"	4	3.00
6937	FACTORY BLUE 4-40 LOCKNUTS	6	3.00
6938	ALUM. FLAT HEAD Socket screw, 4/40 x 1/2", blue	6	2.00
6943	FACTORY BLUE 8-32 LOCKNUTS	6	4.00
7194	COMPLETE TUNING GUIDE: T3	1	3.95
7204	FACTORY TEAM FRONT SUSPENSION ARMS, molded graphite composite, fits only T3 kits	1	10.00
7214	T3 FRONT SHOCK TOWER, GRAPHITE	1	6.00
7221B	FACTORY BLUE INLINE FRONT AXLES	pr	7.50
7299	T3 FACTORY BLUE ALUMINUM SCREW KIT	set	8.50
7309	FACTORY TEAM T3 CHASSIS, EXTRA LONG, graphite composite. Uses #7333 or #7334 battery strap.	1	35.00
7331	T3/B3/B2 FACTORY TEAM BATTERY HOLD DOWN STRAP, LONG, graphite composite, for #9198 or #7302 chassis	1	5.00
7334	T3/B3/B2 FACTORY TEAM BATTERY HOLD DOWN STRAP, EXTRA LONG, graphite composite, for #7308 or #7309 chassis	1	5.00
7339	T3 REAR SUSPENSION ARMS and REAR SHOCK MOUNT, molded graphite composite	pr	10.00
7349	FACTORY TEAM T3 REAR SHOCK TOWER, molded graphite composite	pr	8.00
7873	FLAT HEAD screw, 4-40 x 7/16, aluminum	6	2.50
9131	T3/B3/B2 FRONT TOP PLATE, molded graphite composite	1	8.00
9156B	BLUE SERVO SAVER TUBE & NUT	1	6.50
9162	T3/B3/B2 FACTORY TEAM STEERING BELLCRANK BEARINGS, 1/8" x 1/4" flanged ball bearings. (Replaces bushing in right side bellcrank)	2	15.00
9198	T3/B3/B2 FACTORY TEAM CHASSIS, LONG, graphite composite. Uses #7330 or #7331 battery strap	1	35.00
9210B	T3/B3/B2 FACTORY TEAM FRONT KICKUP, aluminum, blue anodized	1	10.00
9241B	T3/B3/B2 FACTORY TEAM REAR CHASSIS PLATE, aluminum, blue anodized	1	12.00
9245B	T3/B3/B2 FACTORY TEAM REAR MOTOR MOUNT, aluminum, blue anodized	1	8.00
9381	T3/B3/B2 TRANSMISSION BRACE, molded graphite composite	1	6.00

BODIES & SPOILER

6144B	RC10T3 TEAM-BUILT PREPAINTED BODY, blue (does not fit RTR T3)	1	34.99
6144R	RC10T3 TEAM-BUILT PREPAINTED BODY, red (does not fit RTR T3)	1	34.99
6222	NYLON LOCKNUT to mount #7185 spoiler	8	2.00
6919	4-40 x 5/16" BUTTON HEAD Screw to mount #7185 spoiler	6	2.00
6180	DRIVER, clear	1	2.00
7185	TRUCK REAR SPOILER, clear	1	2.00

RC10T3 TRUCKS

7003	RC10T3 BASIC Plus TRUCK KIT	1	230.00
7009	RC10T3 TEAM-BUILT, assembled without radio	1	265.95
7010	RC10T3 RTR, assembled with radio	1	359.95
7013	RC10T3 SPORT TRUCK KIT	1	275.00
7038	RC10T3 TEAM KIT	1	309.00
7048	RC10T3 FACTORY TEAM KIT	1	379.00

OILS, GREASE & LUBE

5420	SILICONE SHOCK OIL, 10 wt. 2 ounce bottle	1	3.50
5421	SILICONE SHOCK OIL, 20 wt. 2 ounce bottle	1	3.50

5422	SILICONE SHOCK OIL, 30 wt. 2 ounce bottle	1	3.50
5423	SILICONE SHOCK OIL, 40 wt. 2 ounce bottle	1	3.50
5425	SILICONE SHOCK OIL, 80 wt. 2 ounce bottle	1	3.50
5427	SILICONE SHOCK OIL, 15 wt. 2 ounce bottle	1	3.50
5428	SILICONE SHOCK OIL, 25 wt. 2 ounce bottle	1	3.50
5429	SILICONE SHOCK OIL, 35 wt. 2 ounce bottle	1	3.50
5435	SILICONE SHOCK OIL, 50 wt. 2 ounce bottle	1	3.50
5436	SILICONE SHOCK OIL, 60 wt. 2 ounce bottle	1	3.50
5437	SILICONE SHOCK OIL, 70 wt. 2 ounce bottle	1	3.50
6588	BLACK GREASE	1	2.50
6591	TRANNY DIFF LUBE	1	2.50

SHOCKS

1598	FACTORY TEAM BLUE ALUM. SHOCK CAP, see also #6439	4	11.95
6421	GOLD SHOCK KIT, front, 1.02" body & shaft. Gold anodized.	pr	25.00
6424B	SHOCK BODY, rear, 1.32". Blue aluminum.	1	6.75
6425	GOLD SHOCK BODY, front, 1.02". Gold anodized.	1	6.75
6425B	SHOCK BODY, front, 1.02". Blue aluminum.	1	6.75
6428	SHOCK END CAP, molded composite.	1	2.25
6429	SHOCK ASSEMBLY TOOL	1	1.00
6432	RACING SHOCK KIT, front, 1.02" body & shaft, hard anodized PTFE sealed	pr	30.00
6436	RACING SHOCK BODY, front, 1.02", hard anodized, PTFE sealed	1	8.50
6439	FACTORY TEAM BLUE ALUM. SHOCK CAP, see also #1598	1	3.00
6440	REBUILD KIT, for 4 Racing style shocks	set	4.00
6458	SHOCK SHAFT 1.32 Stroke, rear	1	3.00
6459	SHOCK SHAFT 1.02 Stroke, front	1	3.00
6465	SHOCK PISTON, 4 each of #1, #2 & #3 to adjust dampening	12	3.00
6466	SHOCK DOWNSTOP, (travel limiters), 4 ea. of 3 sizes 1/8" (.125"), 1/16" (.062") and 1/32" (.031"). Also used as hub carrier spacers	set	1.50
6469	O-RING, shock end cap-to-body seal	4	1.50
6472	SHOCK LOCKNUT, 4-40/5-40	4	1.00
6473	SHOCK BUSHING	4	1.00
6475	PRE-LOAD & CUP (replaces #6474)	set	5.00
7408	RACING SHOCK KIT, rear, 1.39" body with 1/32" shaft, hard anodized, PTFE sealed	pr	30.00
7409	GOLD SHOCK KIT, rear, 1.39" body with 1/32" shaft, gold anodized	pr	25.00
7410	RACING SHOCK BODY, rear, 1.39" body, hard anodized, PTFE sealed	pr	8.50
7411	GOLD SHOCK BODY, rear, 1.39", gold anodized	1	6.75

SPRINGS

1580	TRUCK FRONT SPRING SET	set	11.99
1582	TRUCK/BUGGY REAR SPRING SET	set	11.99
6478	TRUCK & BUGGY REAR RACING SPRING, silver	pr	2.50
6480	TRUCK & BUGGY REAR RACING SPRING, green	pr	2.50
6481	TRUCK & BUGGY REAR RACING SPRING, black	pr	2.50
7425	TRUCK FRONT RACING SPRING, gold	pr	2.50
7426	TRUCK FRONT RACING SPRING, black	pr	2.50
7427	TRUCK FRONT RACING SPRING, green	pr	2.50
7428	TRUCK FRONT RACING SPRING, silver	pr	2.50
7429	TRUCK FRONT RACING SPRING, blue	pr	2.50
7430	TRUCK FRONT RACING SPRING, red	pr	2.50
7434	TRUCK REAR RACING SPRING, blue	pr	2.50
7435	TRUCK REAR RACING SPRING, gold	pr	2.50
7436	TRUCK REAR RACING SPRING, red	pr	2.50

48 PITCH SPUR & PINION GEARS

6679	STOCK 48 PITCH PINION GEAR, 21 tooth	1	4.00
6681	STOCK 48 PITCH PINION GEAR, 23 tooth	1	4.00
6682	STOCK 48 PITCH PINION GEAR, 24 tooth	1	4.00
6683	STOCK 48 PITCH PINION GEAR, 25 tooth	1	4.00
6684	STOCK 48 PITCH PINION GEAR, 26 tooth	1	4.00
6693	PRECISION 48 PITCH SPUR GEAR, 81 tooth	1	4.00
6694	PRECISION 48 PITCH SPUR GEAR, 85 tooth	1	4.00
6695	PRECISION 48 PITCH SPUR GEAR, 87 tooth	1	4.00
6697	PRECISION 48 PITCH SPUR GEAR, 83 tooth	1	4.00

8253	PRECISION MACHINED PINION GEAR, 16 tooth	1	6.00
8254	PRECISION MACHINED PINION GEAR, 17 tooth	1	6.00
8255	PRECISION MACHINED PINION GEAR, 18 tooth	1	6.00
8256	PRECISION MACHINED PINION GEAR, 19 tooth	1	6.00
8257	PRECISION MACHINED PINION GEAR, 20 tooth	1	6.00
8258	PRECISION MACHINED PINION GEAR, 21 tooth	1	6.00
8259	PRECISION MACHINED PINION GEAR, 22 tooth	1	6.00
8260	PRECISION MACHINED PINION GEAR, 23 tooth	1	6.00
8261	PRECISION MACHINED PINION GEAR, 24 tooth	1	6.00
8262	PRECISION MACHINED PINION GEAR, 25 tooth	1	6.00
8263	PRECISION MACHINED PINION GEAR, 26 tooth	1	6.00

BEARINGS & BUSHINGS

6595	COMPLETE BUSHING SET FOR TRANNY TRANSMISSION	9	5.00
6903	BALL BEARING, 3/8" x 5/8" unflanged, PTFE sealed	pr	20.00
6906	BALL BEARING, 3/18" x 3/8" unflanged	pr	13.00
7359	BALL BEARING, 1/4" x 3/8" unflanged	pr	15.00
7700	FACTORY TEAM PTFE SEALED BEARING KIT 16 bearings for transmission, front wheels and rear hubs. For 3/16" rear axles only.	set	95.00
9390	T3/B3 RUBBER SEALED BEARING KIT	set	45.00

WHEELS & TIRES

Front

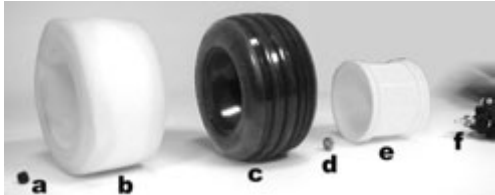

a=6222. b=7880. c=7877. d=3977 / 6599 / 6906. e=7842. f=3977 or 6906.

Rear

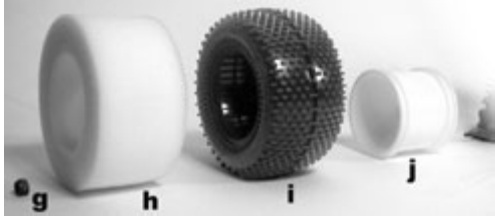

g=3438. h=7880. i=7824. j=7803.

3977	FRONT WHEEL BEARING, 3/16" x 3/8" unflanged, rubber sealed	2	6.00
6599	FRONT WHEEL BUSHING, 3/16" x 3/8" unflanged	4	2.00
6906	FRONT WHEEL BEARING 3/16" x 3/8" unflanged, PTFE sealed	pr	13.00
7802	REAR WHEEL, one piece, lightweight. White (Fits only #6374 or #7362 axles)	pr	7.00
7802B	TRUCK REAR WHEELS, 1 piece, 2.2", black. (Fits only #6374 or #7362 axles)	pr	7.00
7802Y	TRUCK REAR WHEELS, 1 piece, 2.2", fluorescent yellow. (Fits only #6374 or #7362 axles)	pr	7.00
7803	NEW TRUCK REAR WHEEL, 1 piece, 2.2" white (fits MIP® CVD's or #7367 rear axles only.)	pr	7.00
7803B	NEW TRUCK REAR WHEEL, 1 piece, 2.2" black (fits MIP® CVD's or #7367 rear axles only.)	pr	7.00
7803Y	NEW TRUCK REAR WHEEL, 1 piece, 2.2" fluorescent yellow (fits MIP® CVD's or #7367 rear axles only.)	pr	7.00
7824	REAR TIRE, PRO-LINE® M2 compound, "Bow Tie" design, with foam inserts. 2.2". New standard tire for Truck kits	pr	17.95
7842	WIDE FRONT WHEEL, one piece, lightweight	pr	7.00
7842B	TRUCK FRONT WHEELS, 1 piece, 2.2", black	pr	7.00
7842Y	TRUCK FRONT WHEELS, 1 piece, 2.2", fluorescent yellow	pr	7.00
7877	FRONT TIRE, PRO-LINE® M2 compound, "Edge" design, 2.2" w/foam inserts	pr	17.95
7880	TRUCK TIRE INSERT, white	pr	2.00

ANTI-ROLL BAR KITS

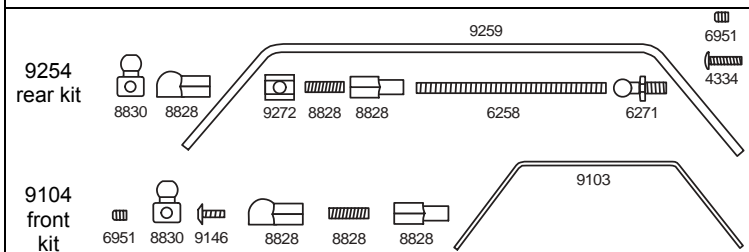

4334	BUTTON HEAD Socket Screw, 2-56 x 5/16"	8	1.50
6258	THREADED ROD	pr	2.00
6271	SHORT BALL END, stainless steel, short thread, with nuts and plastic ball cups	12	10.00
6951	SET SCREWS & WRENCH, 4-40 X 1/8"	6	2.50
8828	ROLL BAR CUP set. Closed and open cup with 5/16" set screw.	2pr	2.00
8830	ROLL BAR PIVOT, aluminum, with #6951 set screw	1	4.00
9103	B3/T3 FRONT ANTI-ROLL BAR WIRE, 2 sizes.	2	2.50
9104	B3/T3 FRONT ANTI-ROLL BAR KIT, light & heavy bars included in kit	1	8.00
9146	BUTTON HEAD CAP Screw, 2-56 x 3/16", for front anti-roll bar mounting on B3 and T3	6	2.00
9254	T3/B3 REAR ANTI-ROLL BAR KIT, light & heavy bars included	1	8.00
9259	REAR ANTI-ROLL BAR WIRE, pre-bent, 2 sizes, fits T3/B3	1	8.00
9272	REAR ANTI-ROLL BAR MOUNTS AND SCREWS, 2-56 x 5/16" button head socket screw	set	2.00

TOOLS

1110	FACTORY TEAM TURNBUCKLE WRENCH	1	1.50
1593	FACTORY TEAM BODY REAMER TIP	1	9.95
1594	FACTORY TEAM BODY MOUNTING HOLE REAMER	1	22.00
6592	ALLEN WRENCH SET	set	2.50
6950	ALLEN WRENCH SET, 3/32", 1/16", .050, .035	set	2.50
6956	ASSOCIATED MOLDED TOOL SET. Wrenches to install 11/32", 1/4", and 3/16" nuts, adjust 1/8" and 3/16" turnbuckles, and install and remove Associated shock caps.	set	4.50

TEAM ASSOCIATED ALLEN DRIVERS #6957-6962 include a color-coded anodized aluminum hex handle and precision ground replaceable tip

6957	.050" ALLEN DRIVER, clear anodized handle	1	10.50
6958	1/16" ALLEN DRIVER, black anodized handle	1	10.50
6959	5/64" ALLEN DRIVER, blue anodized handle	1	10.50
6960	3/32" ALLEN DRIVER, gold anodized handle	1	10.50
6961	2.5mm ALLEN DRIVER, green anodized handle	1	10.50
6962	1.5mm ALLEN DRIVER, purple anodized handle	1	10.50
6964	.050" REPLACEMENT TIP, precision ground	1	5.50
6965	1/16" REPLACEMENT TIP, precision ground	1	5.50
6966	5/64" REPLACEMENT TIP, precision ground	1	5.50
6967	3/32" REPLACEMENT TIP, precision ground	1	5.50
6968	2.5mm REPLACEMENT TIP, precision ground	1	5.50
6969	1.5mm REPLACEMENT TIP, precision ground	1	5.50
6980	NEW! FACTORY TEAM HEX DRIVER SET. Allen drivers above in one package, with tips.	set	49.95

DECALS & APPAREL

SP-42	T3/GT T-SHIRT. T3 printed on front & GT on back in full color on 100% cotton. Specify M, L, XL.	1	13.00
SP-42 XXL	T3/GT T-SHIRT. T3 printed on front & GT on back in full color on 100% cotton.	1	15.00
SP-406	FACTORY TEAM CAP. Low crown style. Heavy brushed twill cap has contrasting stitch. Buckle back adjustable. One size fits all. Blue color.	1	15.95
SP-407	FACTORY TEAM CAP. Black color.	1	15.95
SP-411	NEW TEAM JACKET. Specify Med., L, XL, XXL, XXXL	1	79.99
3814	RC10T3 DECAL, 3 sizes of "RC10T3," fluorescent red & yellow	1	2.00

3817	ASSOCIATED BUMPER STICKERS, 1 large, 1 small. Red, white & blue.	2	4.00
3820	"AE" logo decal sheet	1	2.00
3824	FACTORY TEAM "DRIVER" DECAL, 10" x 4.25"	1	2.00
3825	FACTORY TEAM LOGO DECAL SHEET	1	2.00
6196	ASSOCIATED LOGO DECAL SHEET	1	2.00
7199	RC10T3 BODY DECALS, for the #6139 F-150 body.	1	4.00

CAR CARRIER

See our Pictorial Catalog for full-color picture of Car Carrier

SP-415	ASSOCIATED CAR CARRIER BAG. Heavy duty reinforced nylon with brass zipper. (Boxes not included.)	1	39.95
SP-100	ASSOCIATED CAR CARRIER BOXES. Fits inside #SP-415 bag. Three 24 x 12 x 6" inner boxes fit into one double thickness box with locking end flap. (Bag not included.) Due to its large size, add \$15.00 to shipping charges.	set	15.00
SP-101	INNER BOXES. Three 24 x 12 x 6" inner boxes.	set	5.25

OTHER PARTS

LRP 8305	LRP RUNNER PLUS digital speed control. With forward and reverse. For 18 turn motors and up.	1	79.95
652	BATTERY POWER CONNECTOR PIN. Eliminates hassle of soldering battery packs to radio leads. Quick connect/disconnect.	5pr	10.00
SP 412	REEDY PIT TOWEL. Protect your workbench with this tough, washable towel	1	15.00
3504	CONNECTOR, 2-pin, JST mating pair, with pins	pr	1.00
3505	CONNECTOR, 2-pin, AMP mating pair	pr	2.00
3721	SCREWS, self-tapping	2	6.00
3736	FAST-CHARGE CORD, for 6-cell packs	1	5.50
3737	SILICONE WIRE, 16 gauge, 2 ft orange, 2 ft black	1	5.00
3740	CONNECTOR, 3-pin, AMP mating pair	pr	2.50
6242	LOCKNUT, 4-40	6	1.00
6295	4-40 NUTS, 6 steel hex, 6 small steel hex, 6 Nylon	set	2.00
6296	8-32 NUTS, 6 Nylock, 6 Nylon	set	3.00
6500	POWER 20 STOCK MOTOR 20 turns	1	19.95
6515	MOTOR MOUNTING SCREWS	4	1.00
6520	MOTOR CAPACITORS	3	2.00
6588	BLACK GREASE	1	2.50
6591	TRANNNY DIFF LUB E	1	2.50
6711	RESISTOR, throttle control, Yokomo	1	15.00
6712	WIPER, throttle control	1	2.50
6714	BYPASS KIT, for throttle resistor	1	3.50
6742	CONNECTOR, 2 male pin AMP connector with 7" silicone coated wire leads	1	2.50
6743	CONNECTOR, 2 female pin AMP connector with 7" silicone coated wire leads	1	2.50
6744	WIRE HARNESS, input, 3 male pin AMP connector with radio diodes for non BEC receivers	1	4.50
6745	WIRE HARNESS, motor output, with .1ufd capacitor	1	3.00
6746	ADAPTER, Tamiya 2 pin JST battery connector to old RC10 3 pin AMP connector	1	4.00
6747	WIRE HARNESS, input, 2 pin JST Tamiya plug with JST BEC connector	1	3.00
6912	4-40 SCREW SET, Button heads, countersunk, socket heads and washers, four 8-32 aluminum screws also incl.	set	8.00
6925	SOCKET HEAD Cap screw, 4-40 x 1/2"	6	2.00
6981	ASSOC. REFERENCE LIBRARY CD-ROM	1	11.95
7320	BODY MOUNT WASHER, large nylon	pr	1.50
7527	SERVO MOUNTS, for throttle & steering servos	2	2.50
8353	COMPLETE DIFF ASSEMBLY	1	39.95
8850	RESISTOR BRACKET, aluminum, black anodized	set	7.00
9351	DIFFERENTIAL REBUILD KIT	1	8.95
9353	B3/T3 DIFF ASSEMBLY	1	39.95

For motor and battery choices, please see our current Reedy catalog

See web site for new additions: <http://www.TeamAssociated.com/>

RC10 T3



TEAM ASSOCIATED
3585 Cadillac Ave
Costa Mesa, CA 92626-1401
<http://www.teamassociated.com>

©2000-2002 Associated Electrics, Inc.

See Gear section for spur & pinion gears

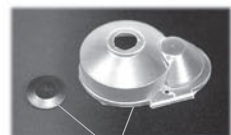

9247, 9248

Pinion

6681, 6679, 6682, 6683, 6684, 8252, 8253, 8254, 8255, 8256, 8257, 8258, 8259, 8260, 8261, 8262, 8263



RTR LRP8305
See our LRP catalog for more speed controls



6139 body
Sport, Basic, RTR

See Bodies section for more bodies



6156 body
Factory Team, Team

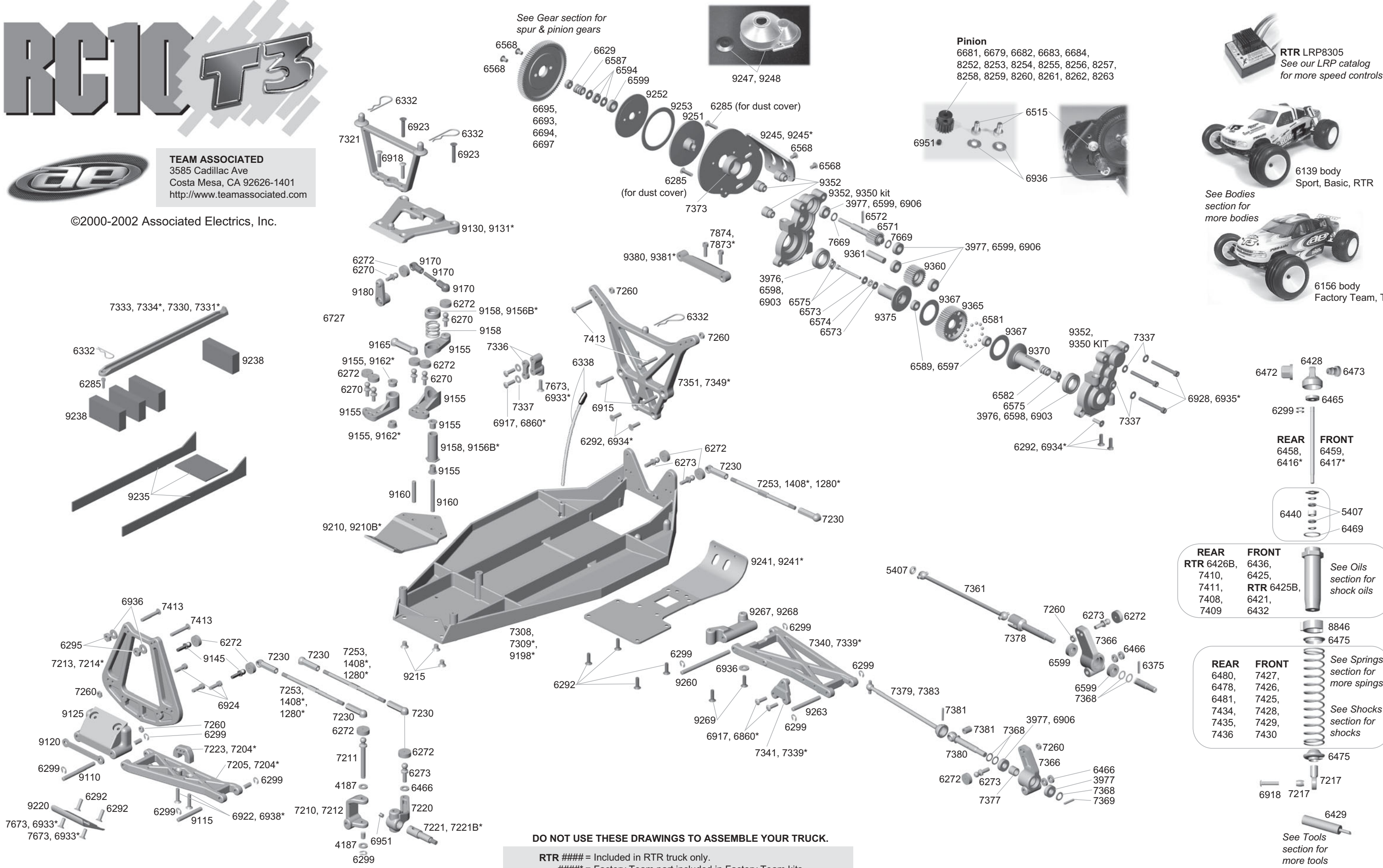

6472 6428 6473

6299 6465

REAR 6458, 6416*
FRONT 6459, 6417*

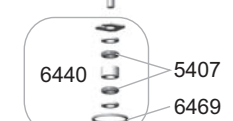

REAR RTR 6426B, 7410, 7411, 7408, 7409
FRONT 6436, 6425, RTR 6425B, 6421, 6432



See Oils section for shock oils

REAR 6480, 6478, 6481, 7434, 7435, 7436
FRONT 7427, 7426, 7425, 7428, 7429, 7430

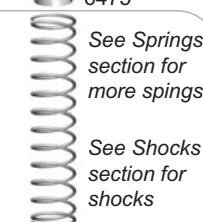

See Springs section for more springs
See Shocks section for shocks

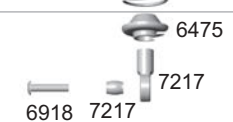

6429

See Tools section for more tools

DO NOT USE THESE DRAWINGS TO ASSEMBLE YOUR TRUCK.

RTR #### = Included in RTR truck only.
####* = Factory Team part included in Factory Team kits.
= Included in all trucks except Factory Team kits.