

10R5 FACTORY Team

1:10 Scale Electric 2WD Competition Car Kit
#8021

--- O V A L ---



1:10 Scale Electric 2WD Competition Car Kit Manual

TEAM ASSOCIATED



Thank you!

...for selecting this Team Associated model.

Associated's Factory Team RC10R5-OVAL is Area-51's newest oval racing platform. The RC12R5 active strut front end and thru-shaft shock design are both integrated into the chassis, allowing more adjustability than ever. The RC10R5-OVAL has a new rigid chassis layout that is built for LiPo, but retains NiMh compatibility, so it can suit any current racing class. A new rear pod design is ultra-rigid and also allows for simple brushless motor installation and wiring. The resulting chassis has the performance and durability to stand up to the highest demands of racing...Associated's Factory Team RC10R5-OVAL!

Team Associated wants you to enjoy the process of building, driving and maintaining your new model. If you discover any problems or need help with the assembly of your model, please give us a call and we will do our very best to help you!

Manual

Examine each step carefully before building. Special notes will be listed for each step.

Bags

Open the bags in order according to each step. Some bags contain a large amount of small parts. We recommend using a small container to keep the parts together.

Supplied

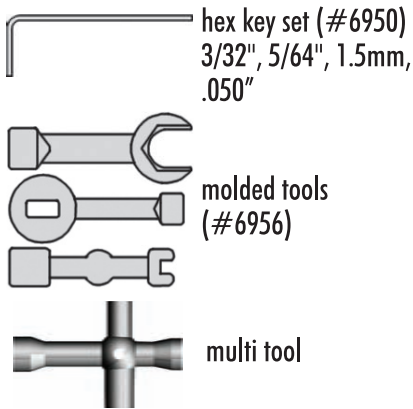

Items Needed

You will need the following to complete you vehicle:

1. R/C two channel surface frequency radio system.
2. Electronic Speed Control.
3. R/C Electric Motor.
4. Battery pack (4-cell/6-cell or LiPo).
5. Peak detection battery charger
6. Pinion gear (64P).
7. 1/10 scale Lexan oval body.
8. Wheels and tires.

Recommended

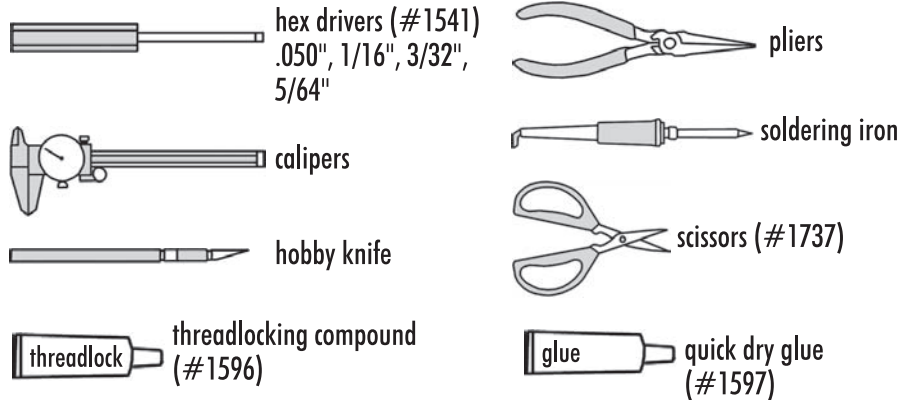

Customer Support

Tel: 949.544.7500
Fax: 949.544.7501

Hours: Monday-Friday
8:00am - 4:00pm, pst

Visit the following web sites for tips, setup help and racing information:

www.RC10.com
www.TeamAssociated.com



Suppl.

We are constantly developing new parts to improve our kits. These changes, if any, will be noted on supplementary sheets located in the appropriate parts bags. Check each bag for these sheets before you start to build.

Notes

There is an included 1:1 fold out in the back of the manual. Fold it out while building your kit for easy parts sizing!

:: Side Shocks

BAG A-AA

STEP 1

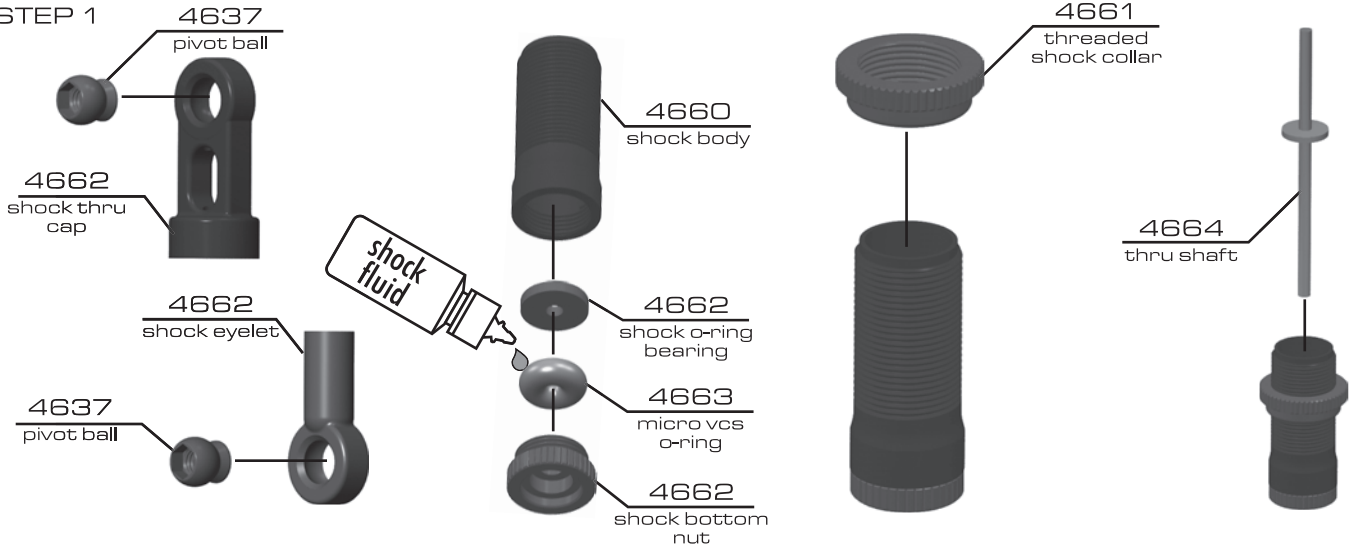

:: Side Shocks (cont.)

STEP 2

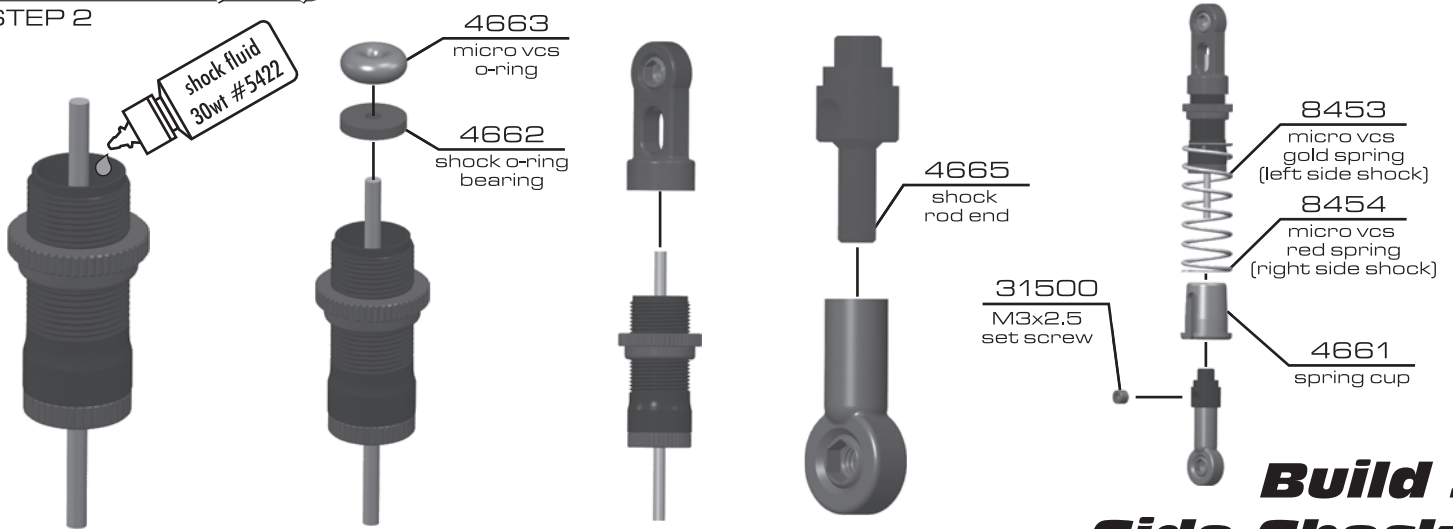

Build 2 Side Shocks

:: Center Shock

STEP 3

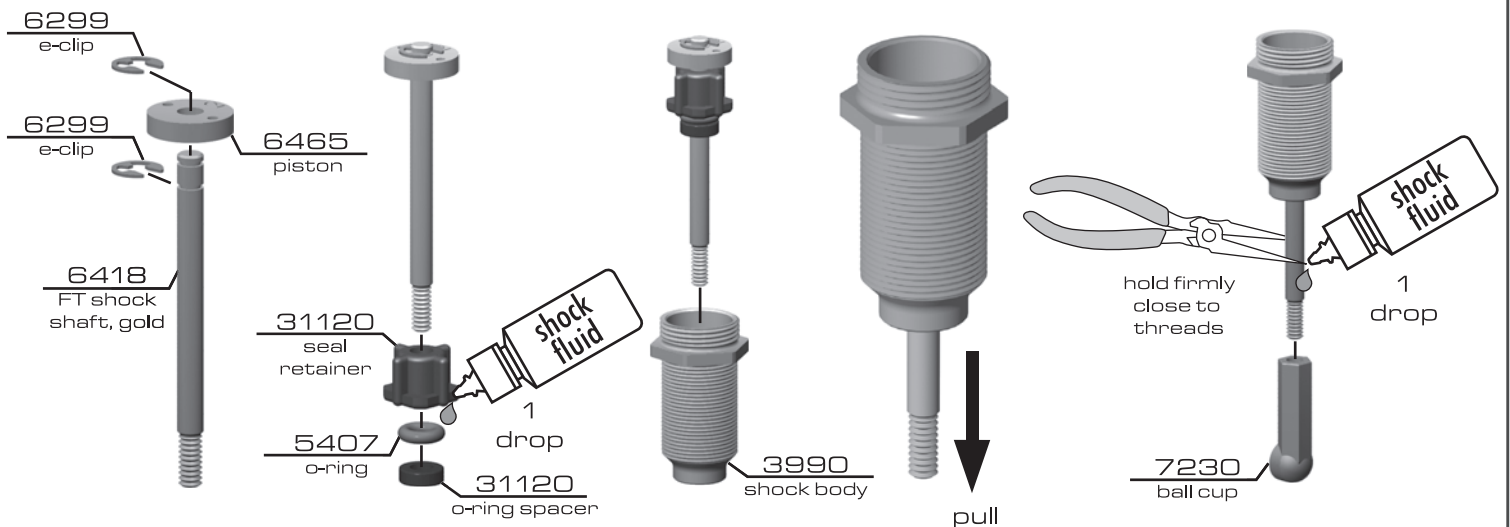

:: Center Shock (cont.)

STEP 4

Bladder installation

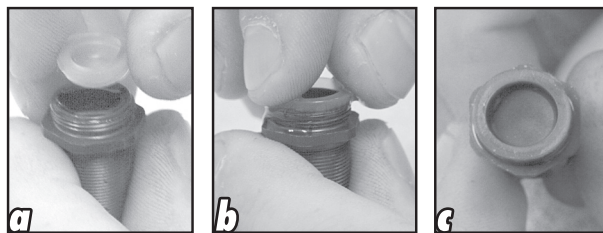
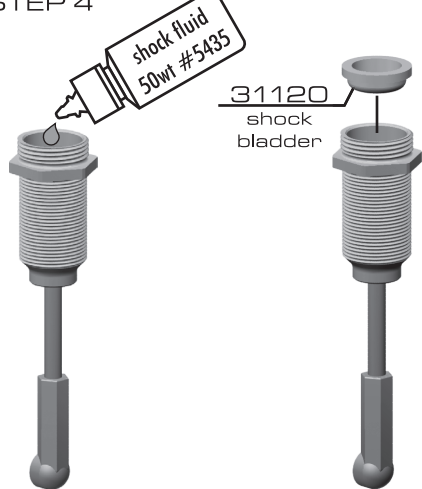

▶ With the shaft fully extended, place bladder onto the top of the shock body (a), displacing the extra oil (b). Make sure there are no air bubbles under the clear bladder (c). If there are, gently lift one side of the bladder to allow air bubbles to escape.

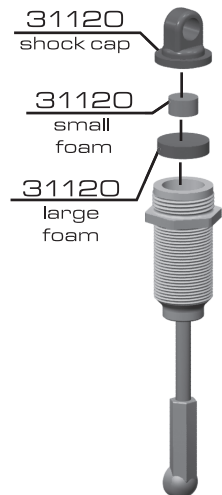

:: Center Shock (cont.)

STEP 5

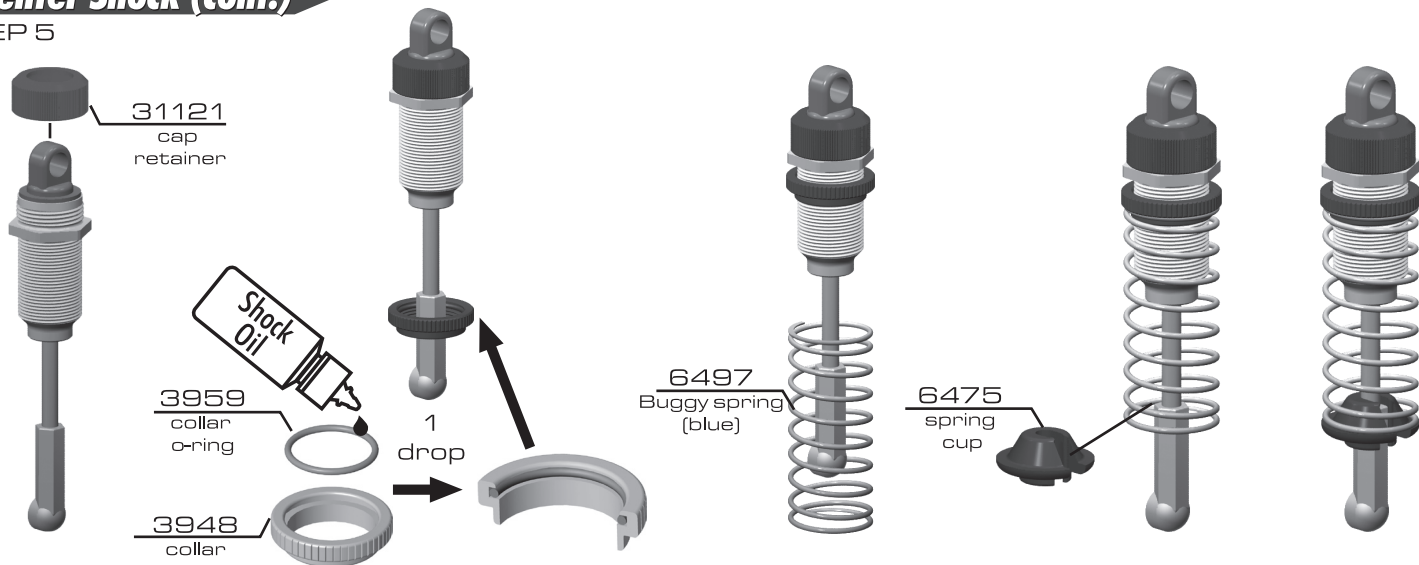

:: Turnbuckles

STEP 6

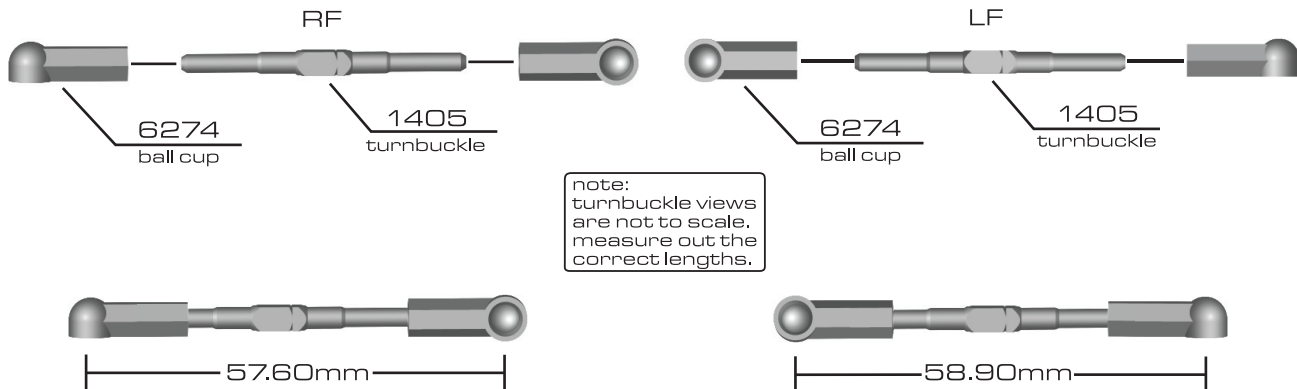

note:
turnbuckle views
are not to scale.
measure out the
correct lengths.

:: Chassis Prep

BAG B-BB

STEP 1

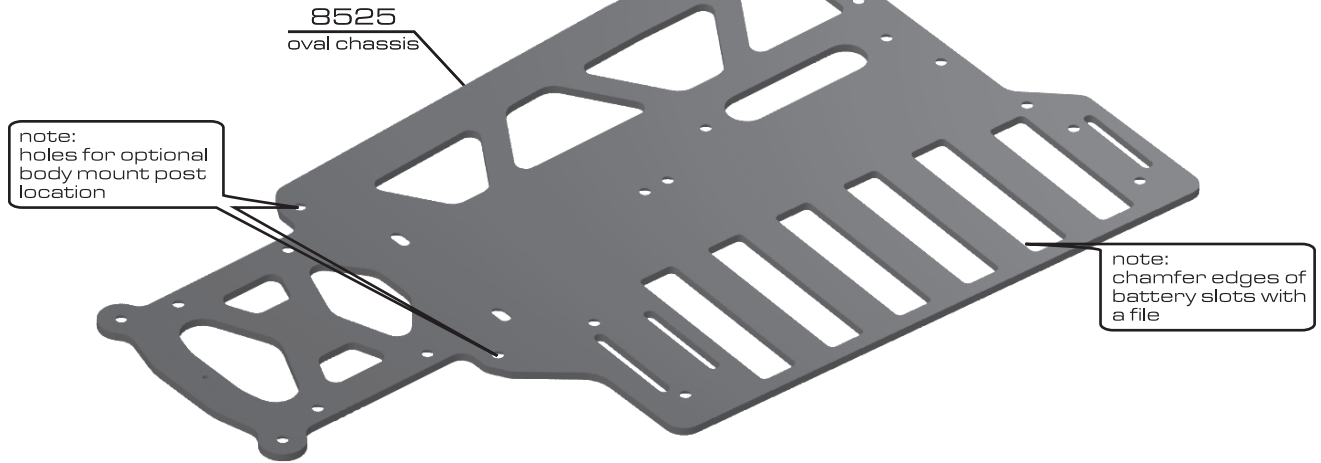

:: Rear Bulkhead

STEP 2

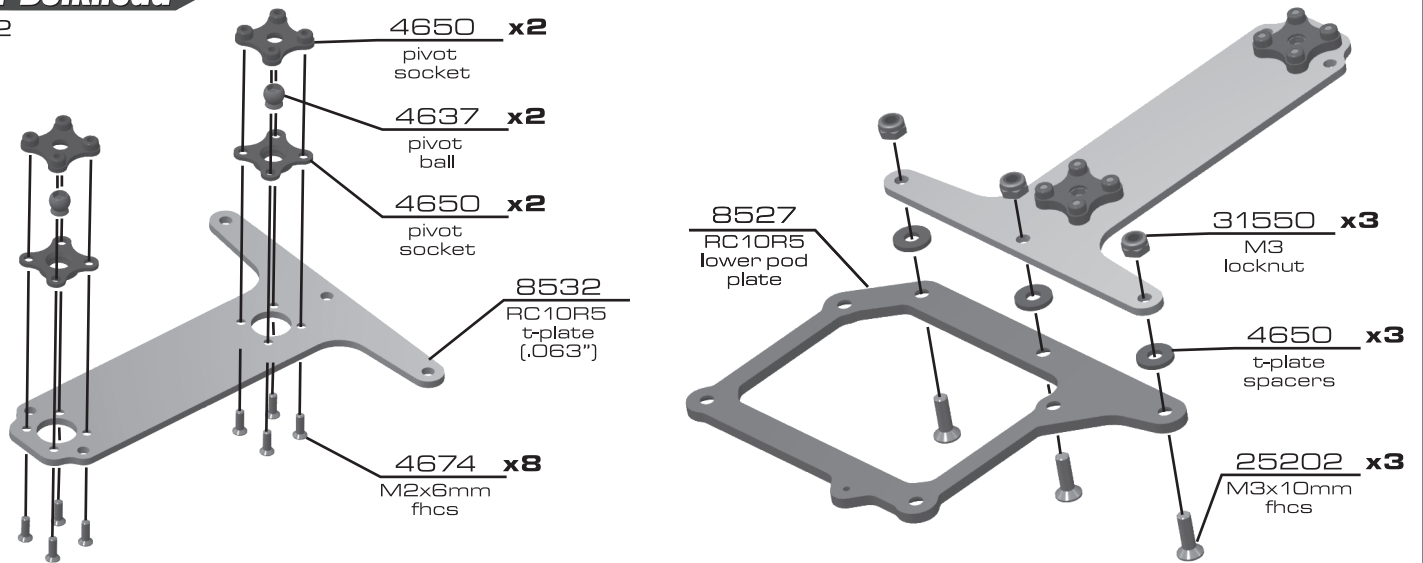

:: Rear Bulkhead (cont.)

STEP 3

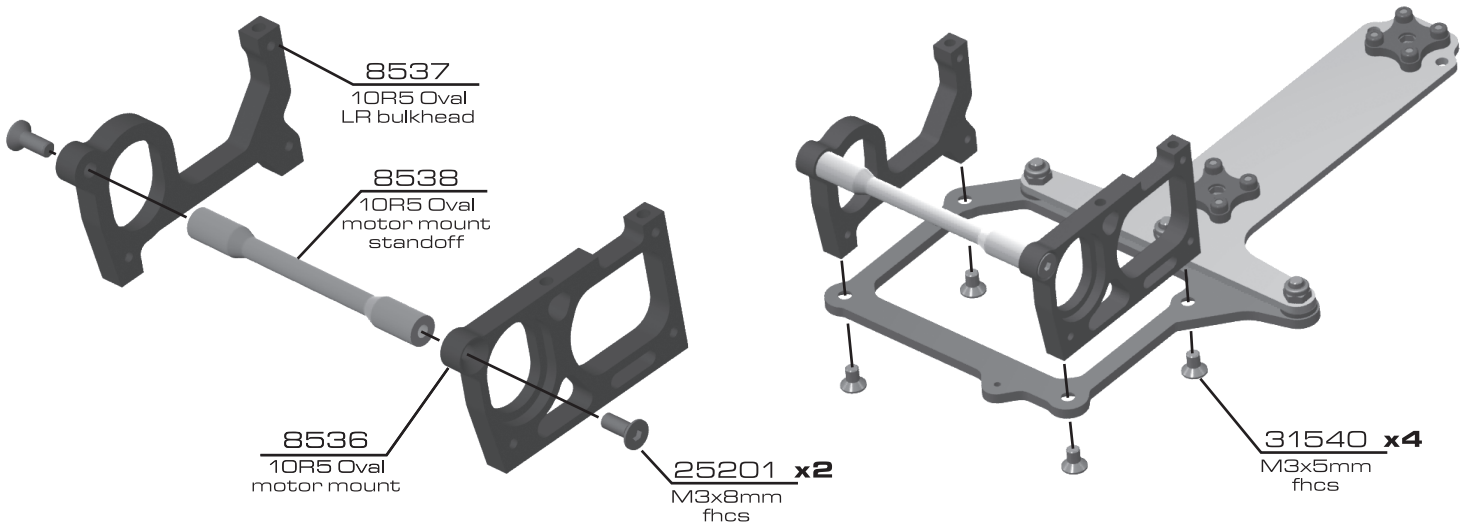

:: Rear Bulkhead (cont.)

STEP 4

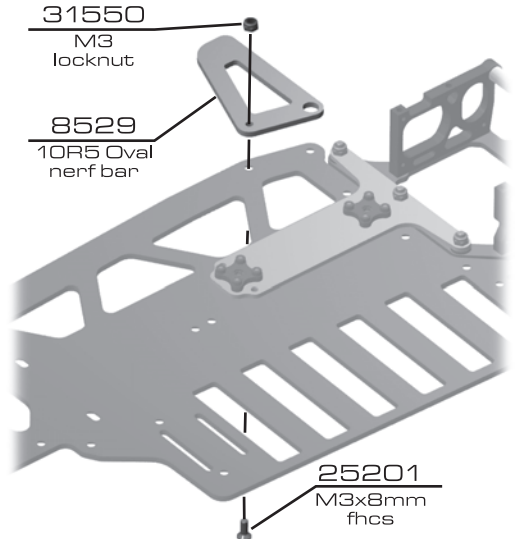
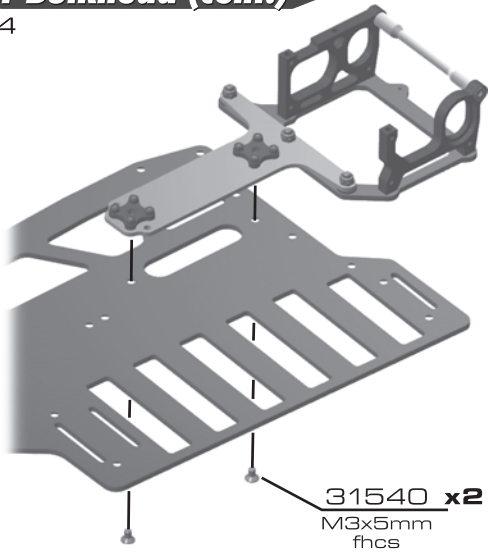

:: Rear Bulkhead (cont.)

STEP 5

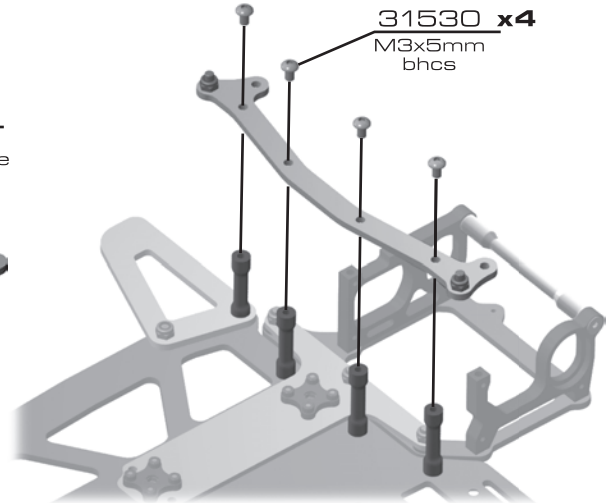
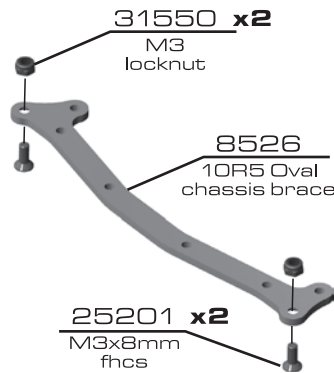
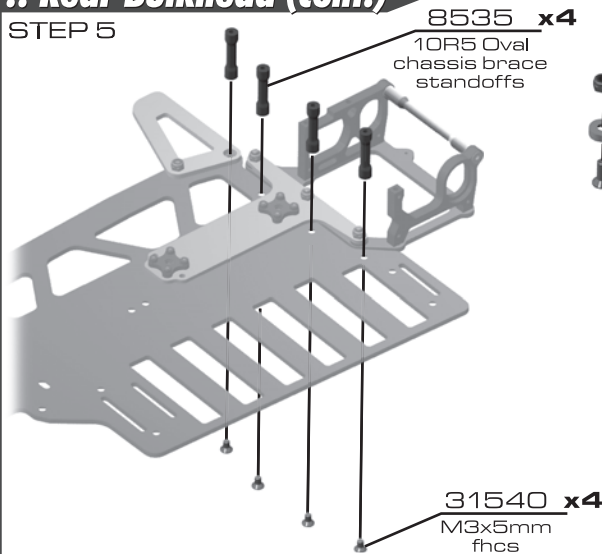

:: Pivot Brace Link Assemblies

STEP 6

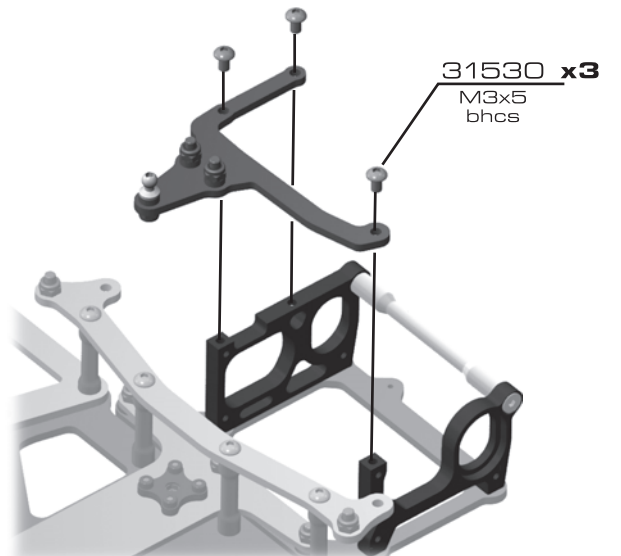
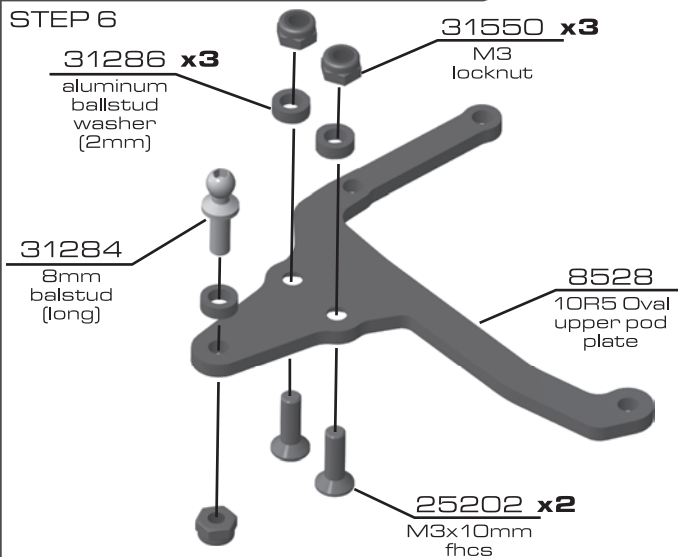

:: Front Bulkheads

BAG C-CC

STEP 1

8441 x2 center steering blocks

31280 x2 5mm ballstud (short)

8417 x2 pivot ball

note: shoulders on pivot balls should point upward

shock fluid

shock fluid

8443B x2 front inline axle (blue)

4620 x2 lower arm

RF LF

note: the lower suspension arms sweep towards the back of the chassis.

FRONT OF CAR

:: Front Bulkheads (cont.)

STEP 2

8417 x2 pivot ball

shock fluid

shock fluid

4622 x2 upper arm eyelet

4621 x2 upper arms

1410 x2 turnbuckle

note: eyelet offset position relative to the upper suspension arm

note: eyelet offset position to pivot ball

:: Front Bulkheads (cont.)

STEP 3

31197 arm mount nut

25211 M3x10 bhcs

4614 front bulkhead

4614 front bulkhead

25211 M3x10 bhcs

31197 arm mount nut

:: Front Bulkheads (cont.)

**Upper Suspension
Mount Active
Caster Settings**

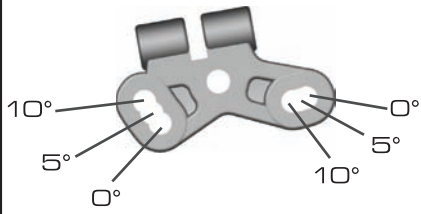

STEP 4

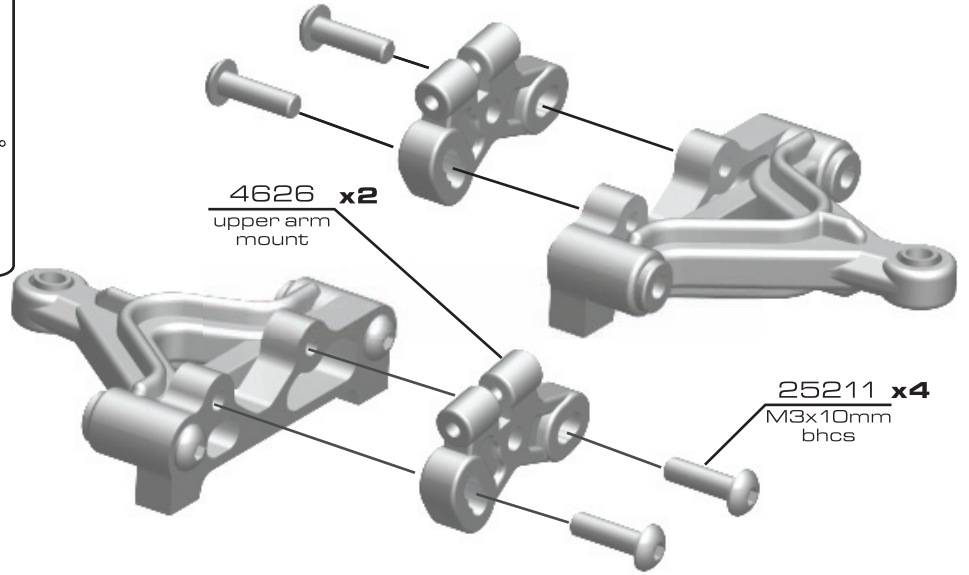

:: Front Bulkheads (cont.)

STEP 5

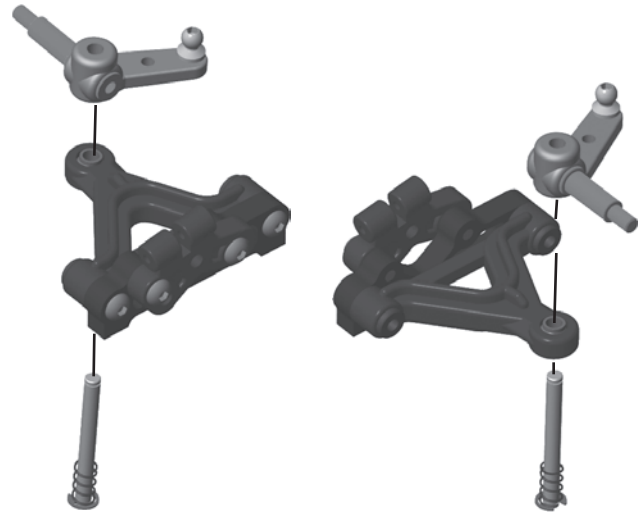
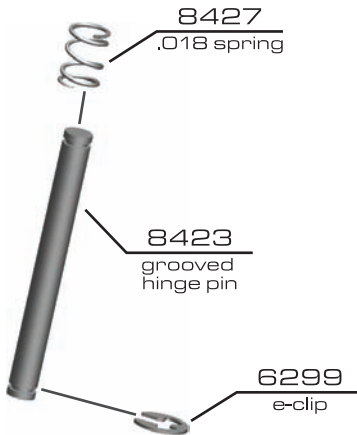

**Build 2
Hinge Pins**

:: Front Bulkheads (cont.)

STEP 6

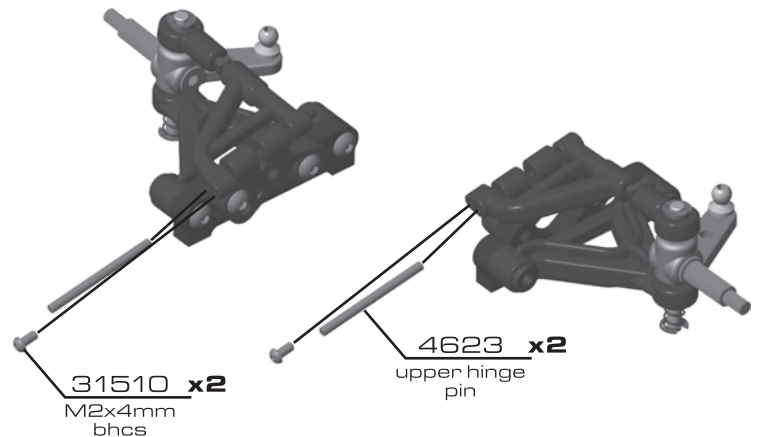
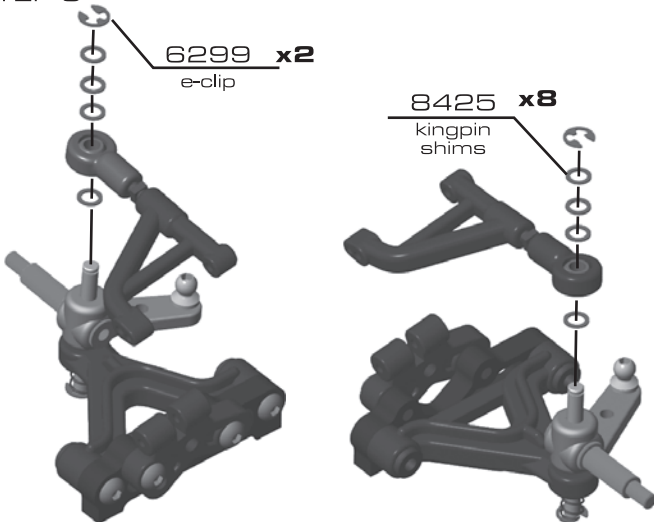

:: Front Bulkheads (cont.)

STEP 7

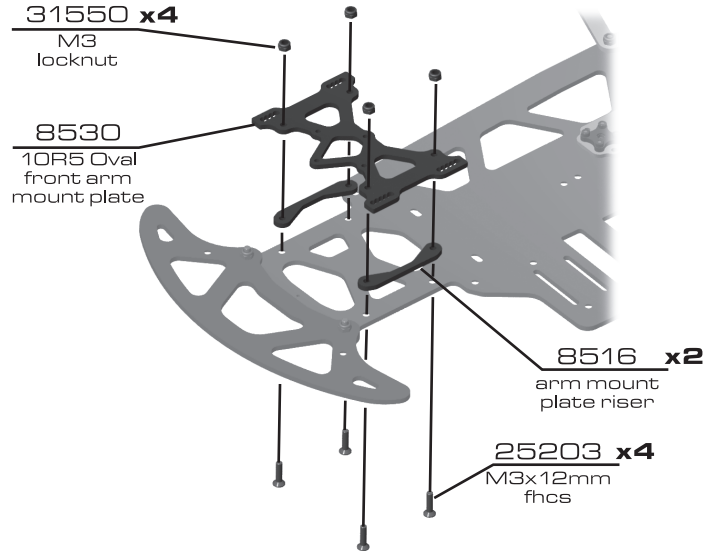
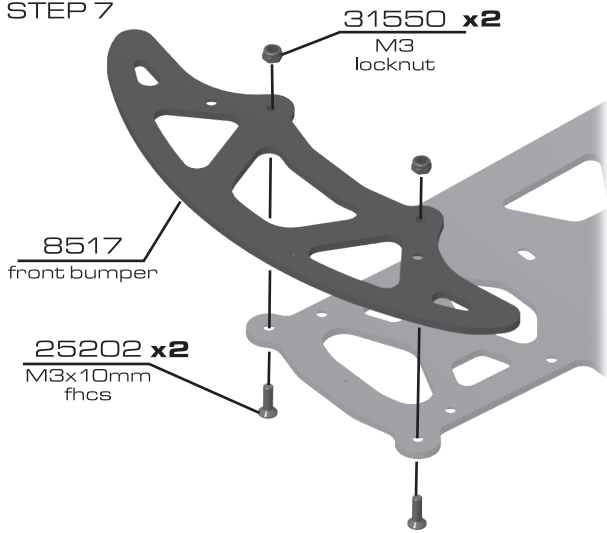

:: Front Bulkheads (cont.)

STEP 8

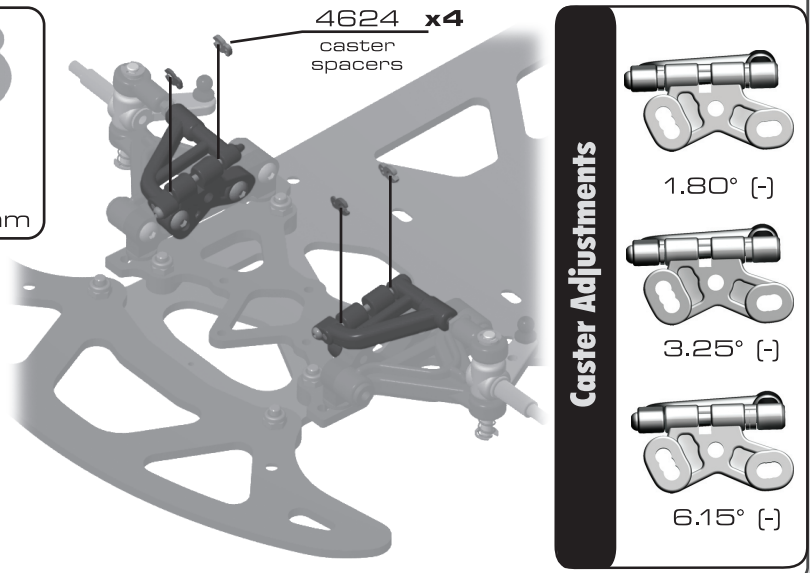
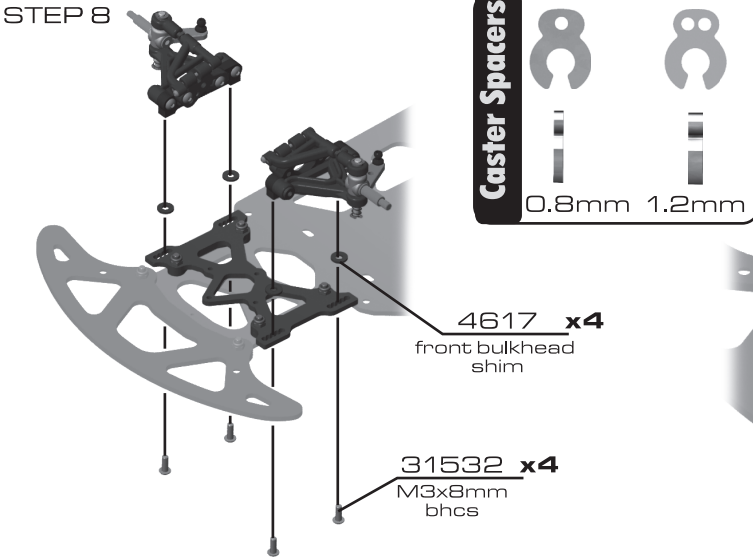

:: Rear Axle

STEP 1

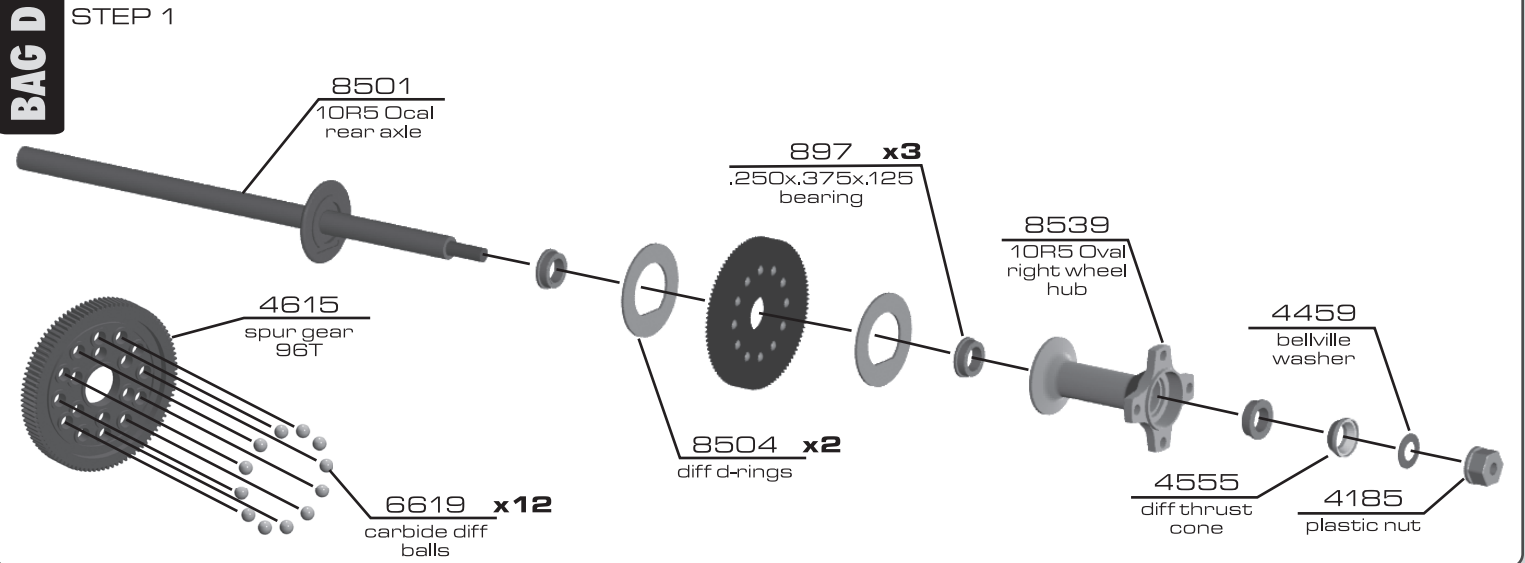

:: Rear Axle (cont.)

STEP 2

897 **x2**
.250x.375x.125

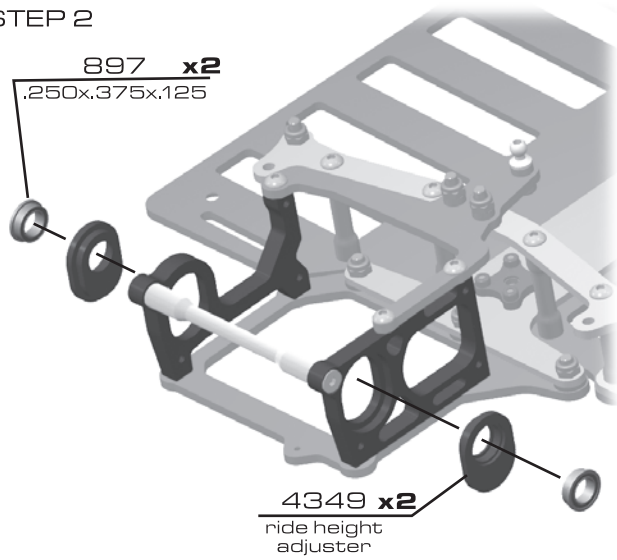

4349 **x2**
ride height
adjuster



8520
left wheel
hub
4568
2-56x3.13"
shcs

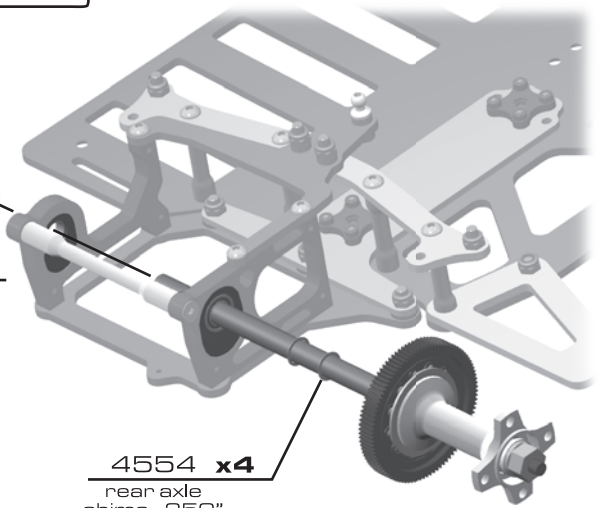

4554 **x4**
rear axle
shims, .250"

:: Battery Index / Shocks

STEP 1

BAG E-EE

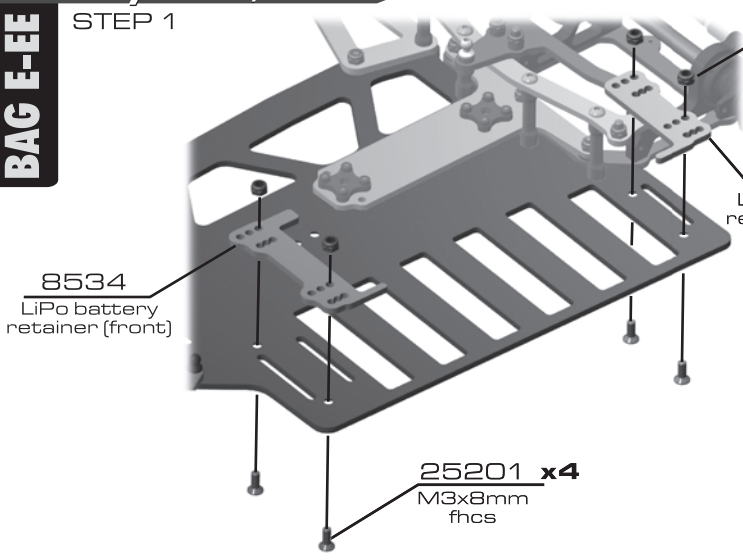

8534
LiPo battery
retainer (front)

31550 **x4**
M3
locknut

8533
LiPo battery
retainer (rear)

25201 **x4**
M3x8mm
fncs

31530 **x4**
M3x5mm
bhcs

31250
shock
bushing

4607
shock mount
upright

4655
shock mount
brace

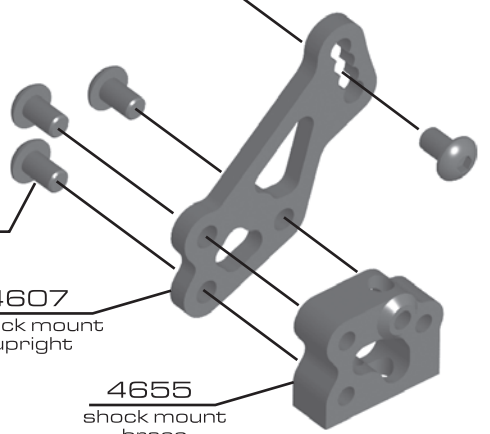

:: Center Shock (cont.)

STEP 2

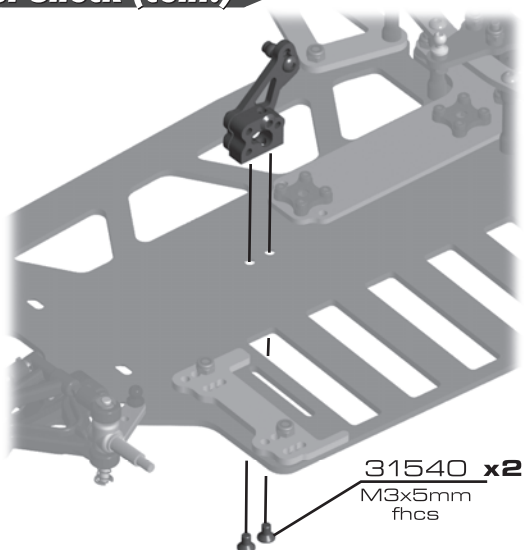

31540 **x2**
M3x5mm
fncs

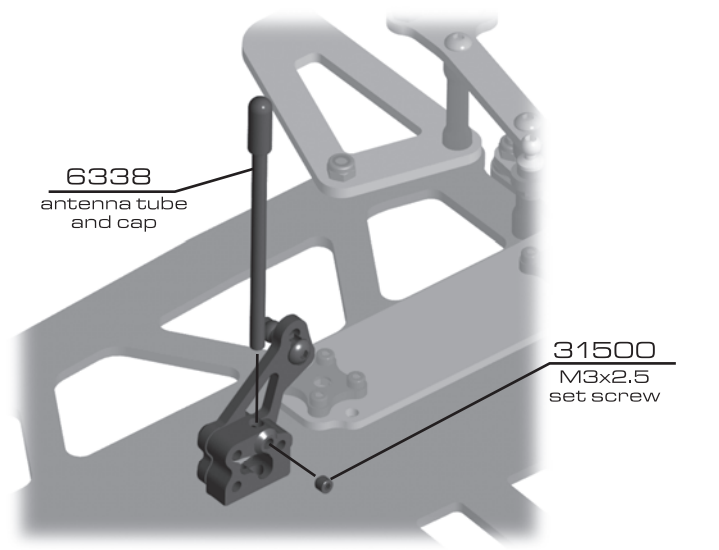

6338
antenna tube
and cap

31500
M3x2.5
set screw

:: Shocks (cont.)

STEP 3

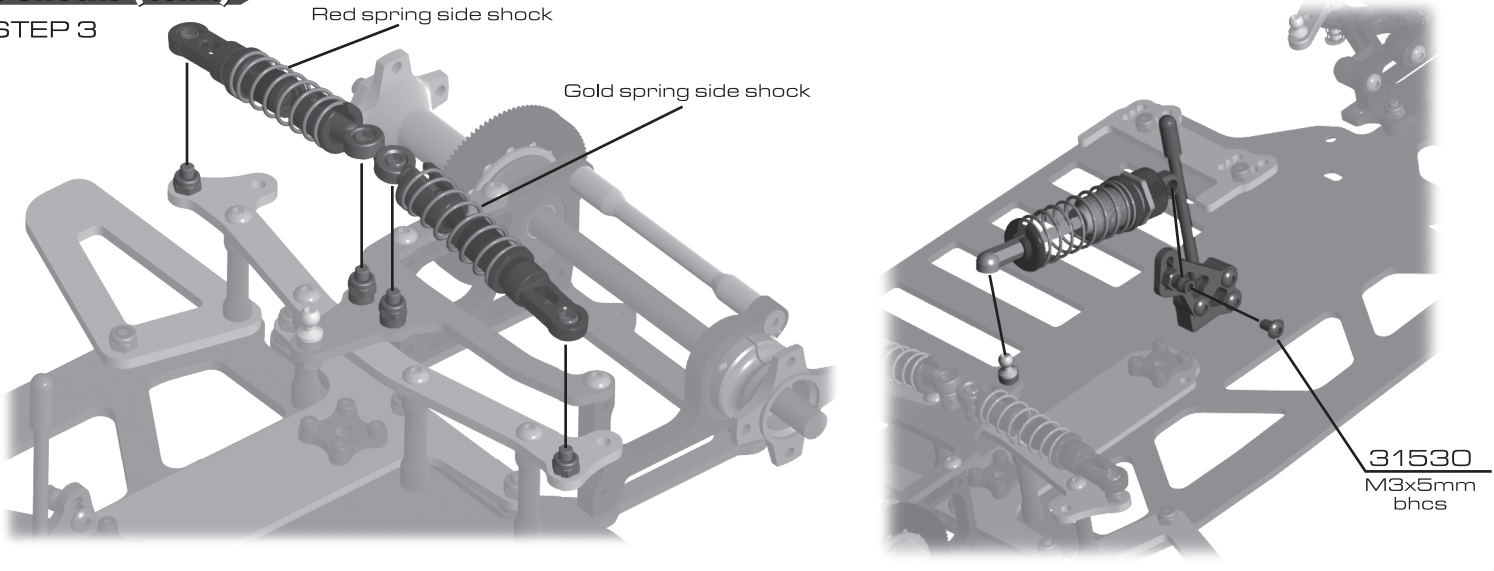

:: Servo Assembly

STEP 4

Ackerman Adjustment Spacers

note:
use spacers to
adjust ackerman
settings

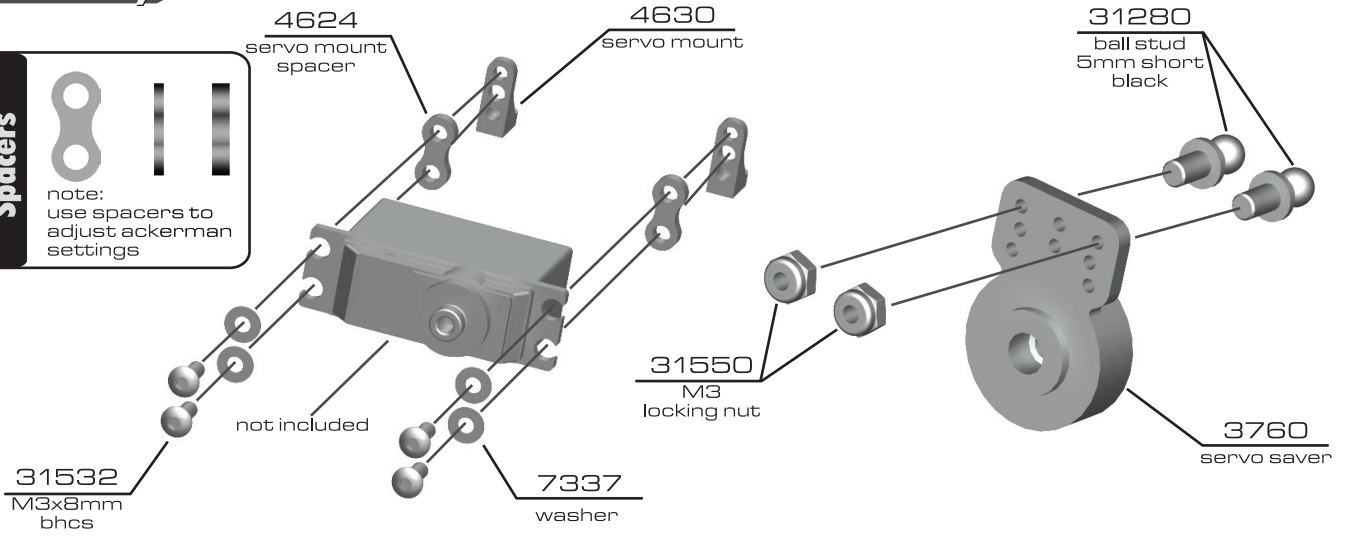

:: Servo Assembly (cont.)

STEP 5

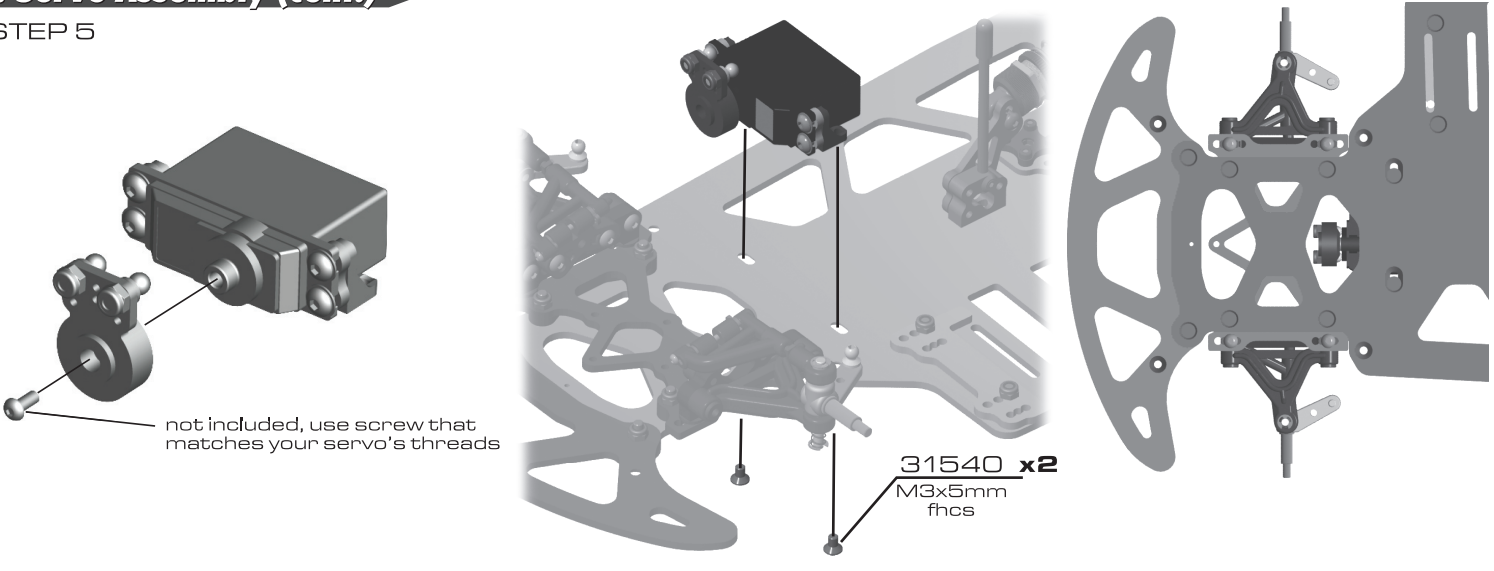

:: Turnbuckles / Body Posts

STEP 6

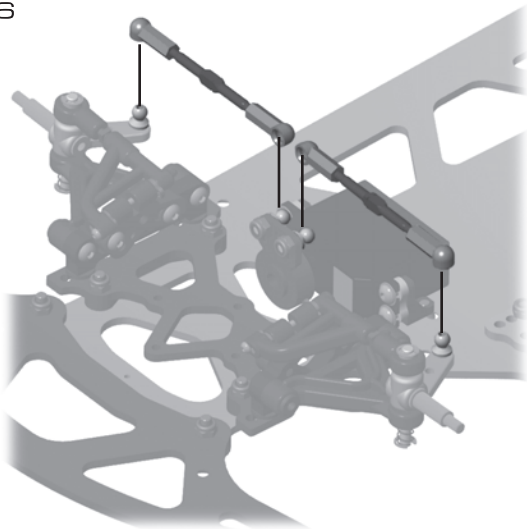

8522 x2
body posts

25201 x2
M3x8mm
fhcs

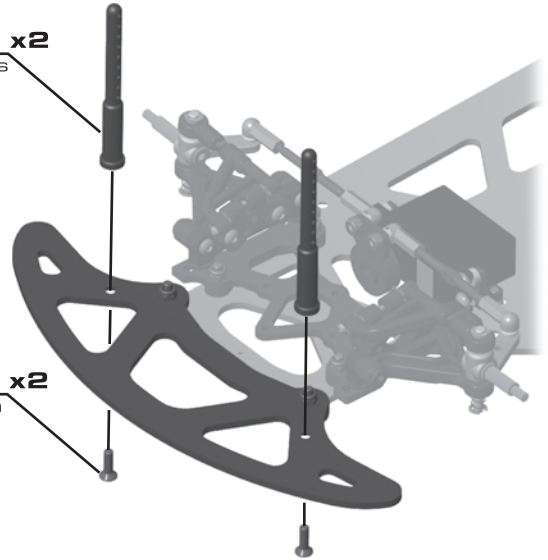

:: Bumper / Body Mounts

STEP 7

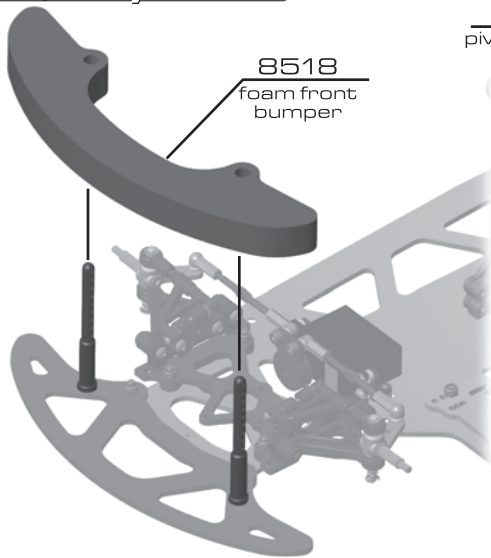

8518
foam front
bumper

3897 x2
pivoting body
mounts

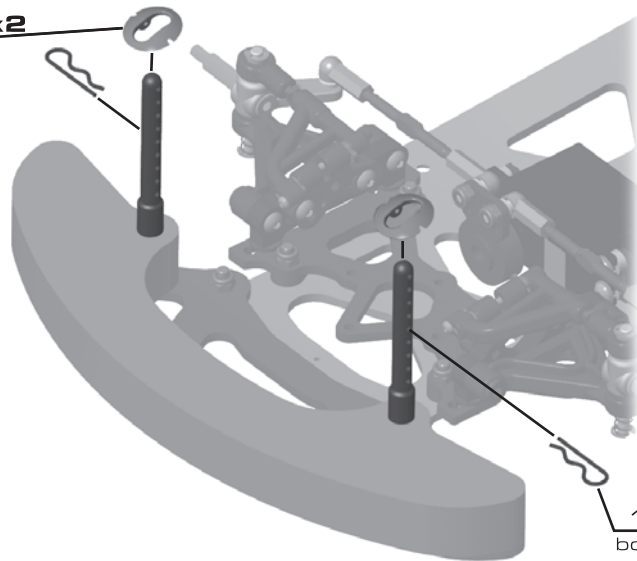

1736 x2
body clips

:: Body Mounts (cont.)

STEP 8

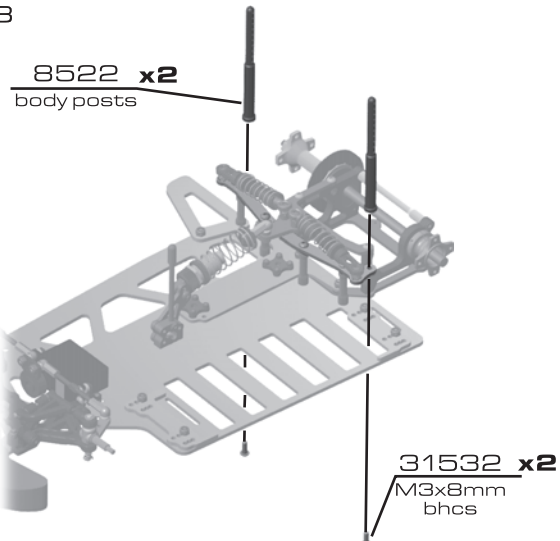

8522 x2
body posts

31532 x2
M3x8mm
bhcs

3897 x2
pivoting body
mounts

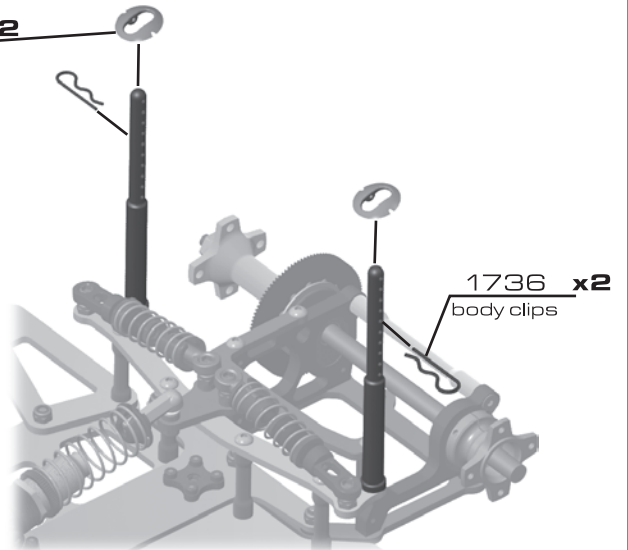

1736 x2
body clips

:: Wheels / Tires Install

STEP 9

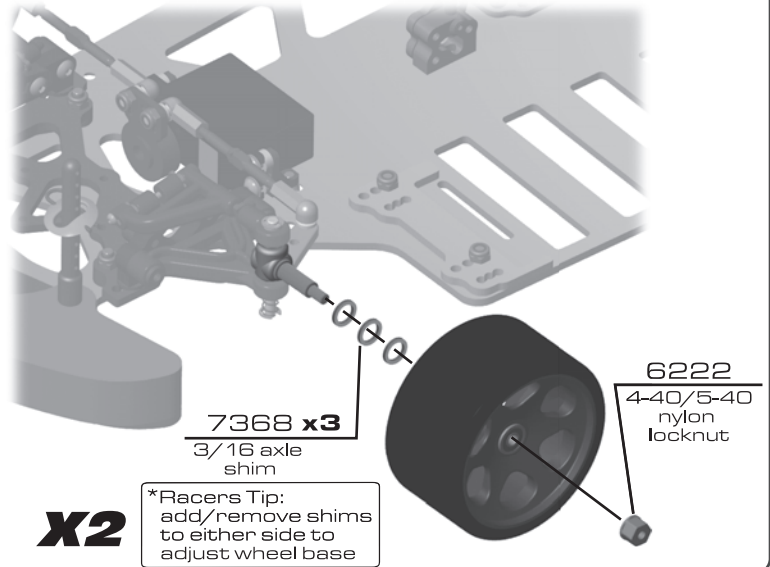
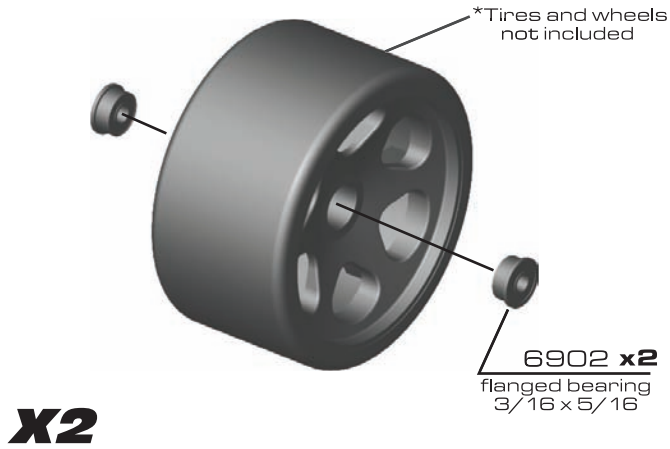

:: Wheels / Tires Install (cont.)

STEP 10

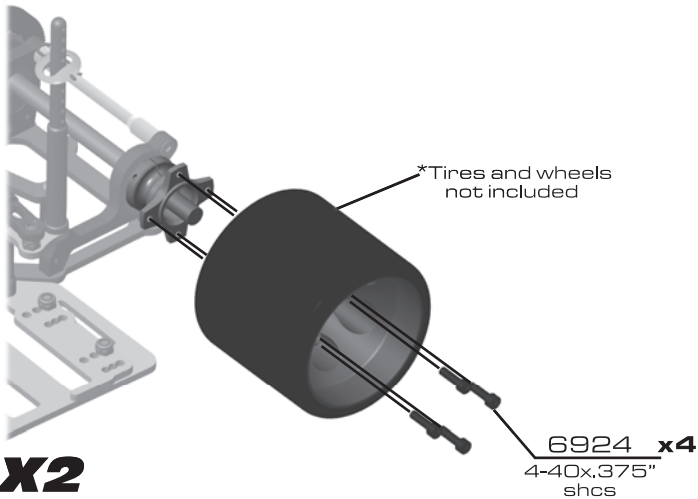

:: Electronics

STEP 11

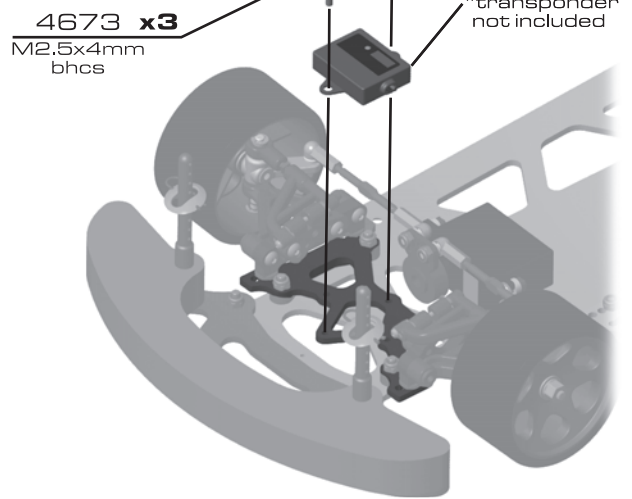

:: Body Mounts (cont.)

STEP 12

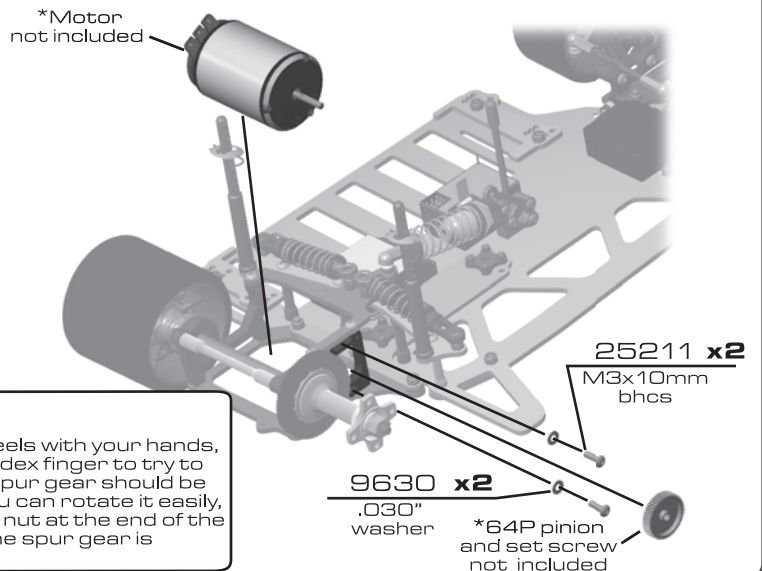
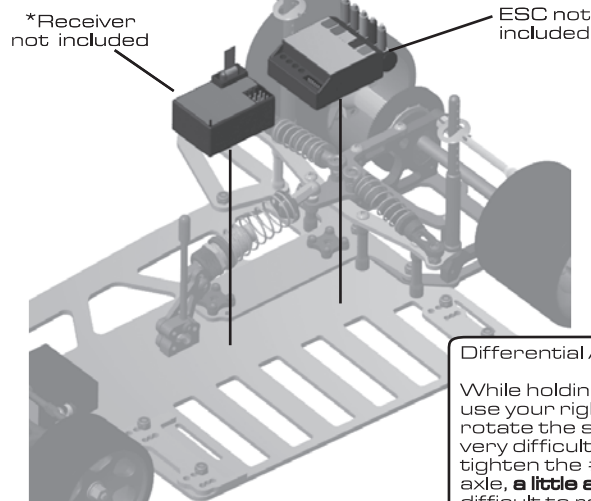

Differential Adjustment:
While holding both rear wheels with your hands, use your right thumb and index finger to try to rotate the spur gear. The spur gear should be very difficult to rotate. If you can rotate it easily, tighten the #4185 11/32" nut at the end of the axle, **a little at a time**, until the spur gear is difficult to rotate.

:: Electronics (cont.)

STEP 9

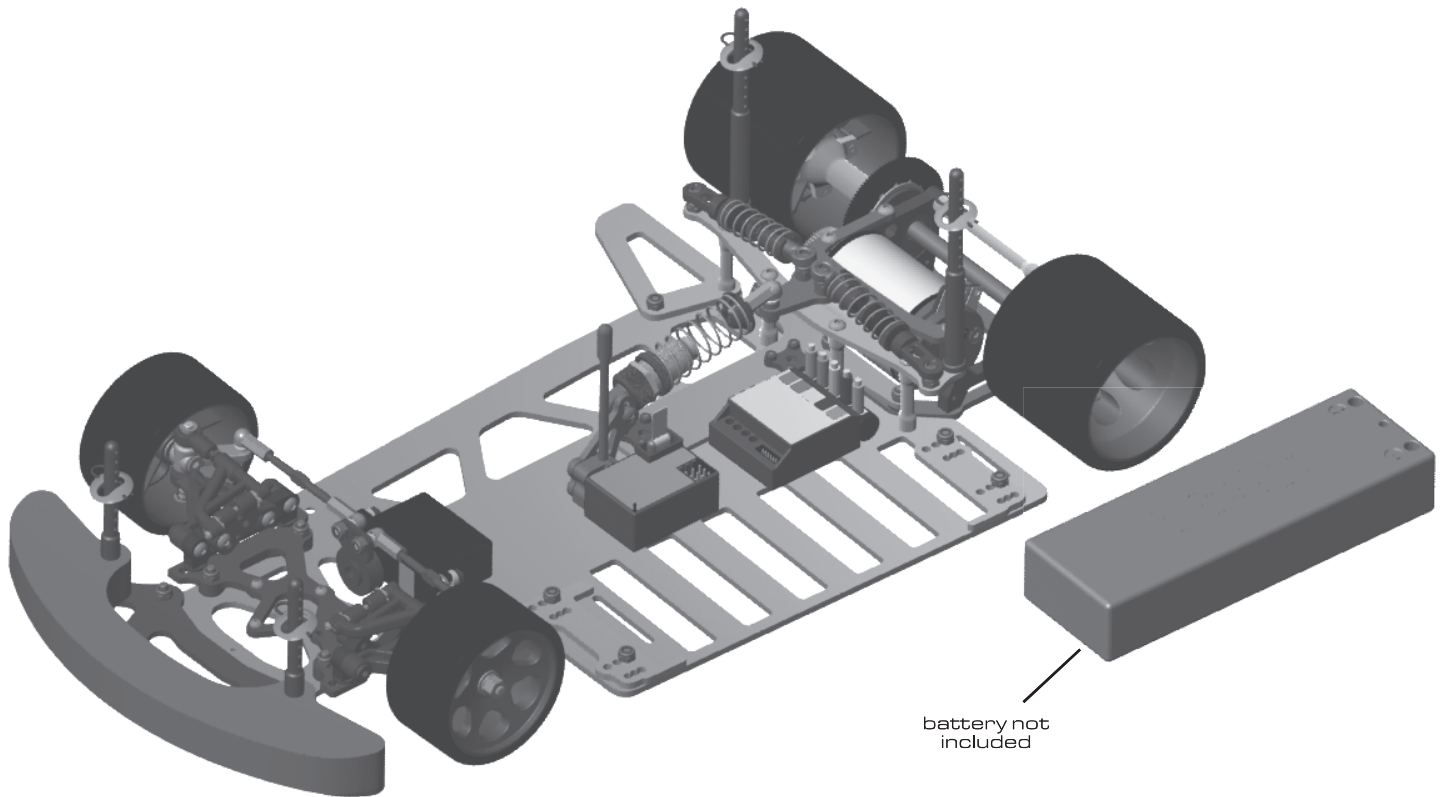
battery not
included**:: Finished Model****Battery Mounting:**

To mount your battery to the chassis, whether it be a Ni-MH 6-cell battery or a LiPo battery, you should use strapping tape to hold it in place.

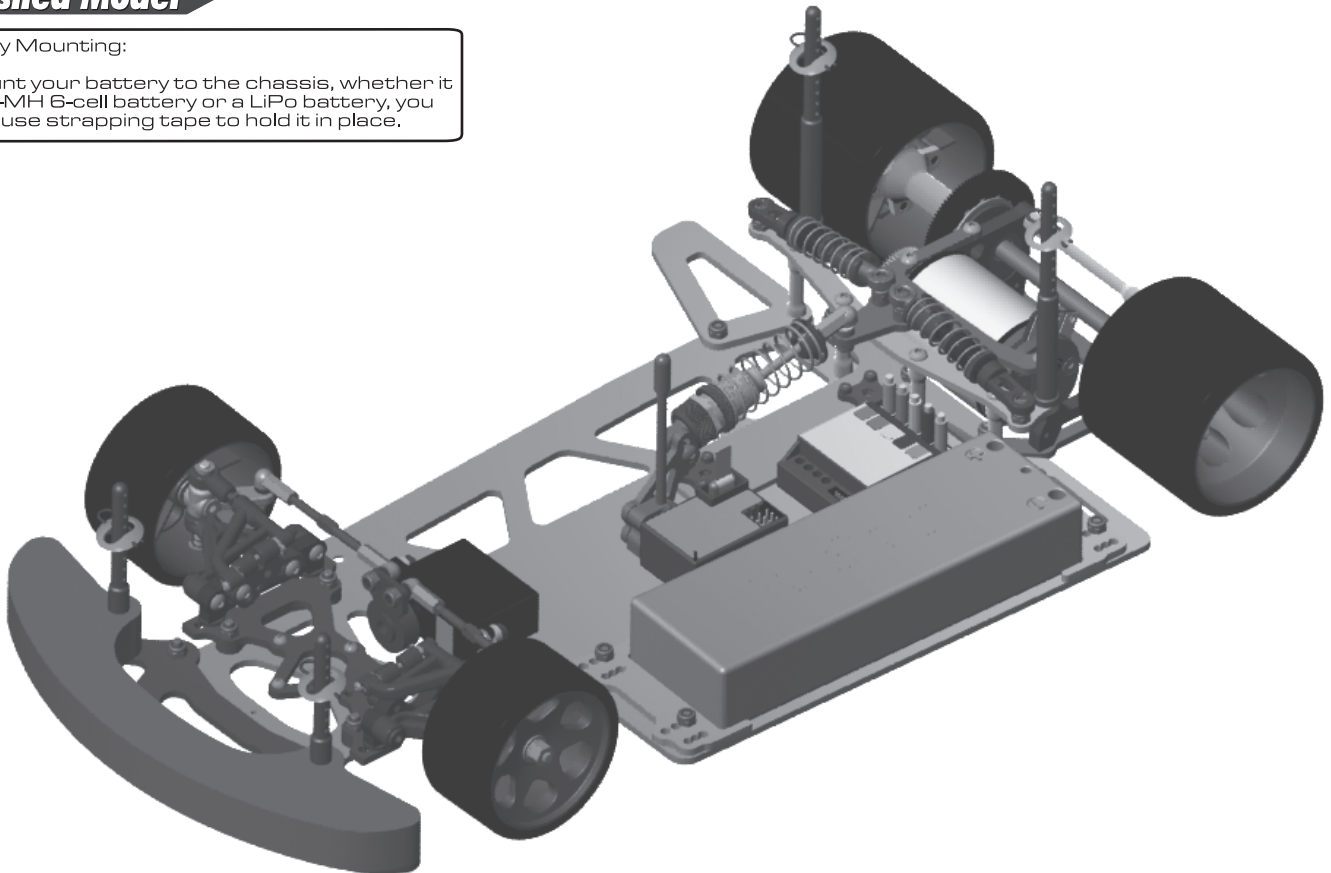



:: Driver: Team Associated **:: Date:** _____
:: Track: Standard RC10R5-OVAL Setup
:: Event: _____

Setup Sheet for Team Associated's 10R5 OVAL

Rev. 1

:: Front Suspension

Kingpin Lube: 60k Springs: LF: .018 RF: .018

Upper Arm Mounts: LF: 0° 5° 10°
 RF: 0° 5° 10°

Camber: LF: +2.5 RF: -2.5

Ride Height: 4.5mm

Mounting Plate Riser:

Yes No

Kingpin:
 shim qty/thickness,
 LF: 0.030 RF: 0.045

shim qty/thickness,
 LF: 0 RF: 0.015

Wheel axle shims:
 LF: 0 RF: 0

Lower arm
 spacing: LF: _____ RF: _____

Caster:

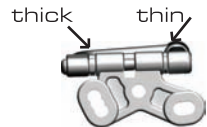

LF: 1.80°
 RF: 1.80°

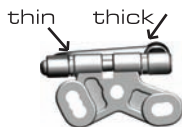

3.25°
 3.25°



6.15°
 6.15°

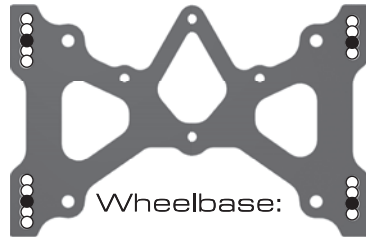

Wheelbase:

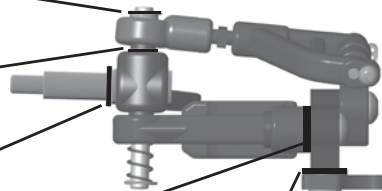

Front ride height
 spacers:
 LF: _____ RF: _____

:: Rear Suspension

T-Plate: .063 2 screws 3 screws

Ride Height Adjuster: 1mm up

Ride Height: 4.8mm

Side Shocks

Oil: LR: 30 RR: 30

Spring: LR: Red RR: Gold

Center Shock

Piston: 2

Oil: 60

Spring: 10 lb

Position:

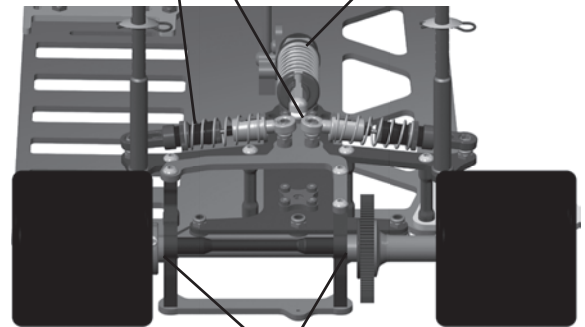

Hub spacers: LR: 0 / RR: 0

Notes: _____

:: Tires

Tires	LEFT	RIGHT
Tire Compounds	F	
	R	
Tire Diameter	F	
	R	
Tire Width	F	
	R	

Tire Treatment Type: _____

Total Car Weight: _____ oz.

Tweak Settings

_____ oz. _____ oz.

(front)

(rear)

_____ oz. _____ oz.

Shade in amount
 of tire treatment

:: Battery Placement

Front

Rear



Shade in battery placement for
 Sub C-cells.

Battery: _____

:: Track Info / Body

smooth: bumpy:
 traction: high med. low

Body Type and Make: _____

Body Height: _____

Wing: _____

Notes: _____

:: Motor/Speed Control

Motor: _____

Timing: _____ Gear: _____ / _____

S.C. : _____

S.C. Settings: _____

:: Transmitter

Turning Circle: _____

Steering Expo: _____



Brake E.P. : _____

Throttle Expo: _____

Notes: _____

:: Hardware - 1:1

cap head (shcs)

-  2-56x.313 (4568)
-  4-40x.375 (6924)







nuts (lock/plain)

-  m3 locknut (31550)

flat head (fhcs)

-  2x6mm (4674)
-  3x5mm (31540)
-  3x8mm (25201)
-  3x10mm (25202)
-  3x12mm (25203)
-  2-56X3/8 (31125)

button head (bhcs)

-  2x4mm (31510)
-  2,5x4mm (4673)
-  3x5mm (31530)
-  3x6mm (31531)
-  3x8mm (31532)
-  3x10mm (25211)







ball bearings

-  rear axle bearing (897)
.250x.375x.125
-  flanged bearing (6902)
.1875 x .3125



setscrews

-  3x2.5mm (31500)

shims & washers

-  washer (9630)
-  kingpin shim (8425)
-  blue aluminum shims
1 mm, 2mm (31286)
-  washer (7337)
-  bulkhead shim (4617)
0.5mm, 1 mm, 2mm
-  t-plate spacers (4650)
-  rear axle shim .005" (4554)

pivot balls

-  hard anodized pivot ball (4637)
-  plastic pivot ball (8417)

Notes:

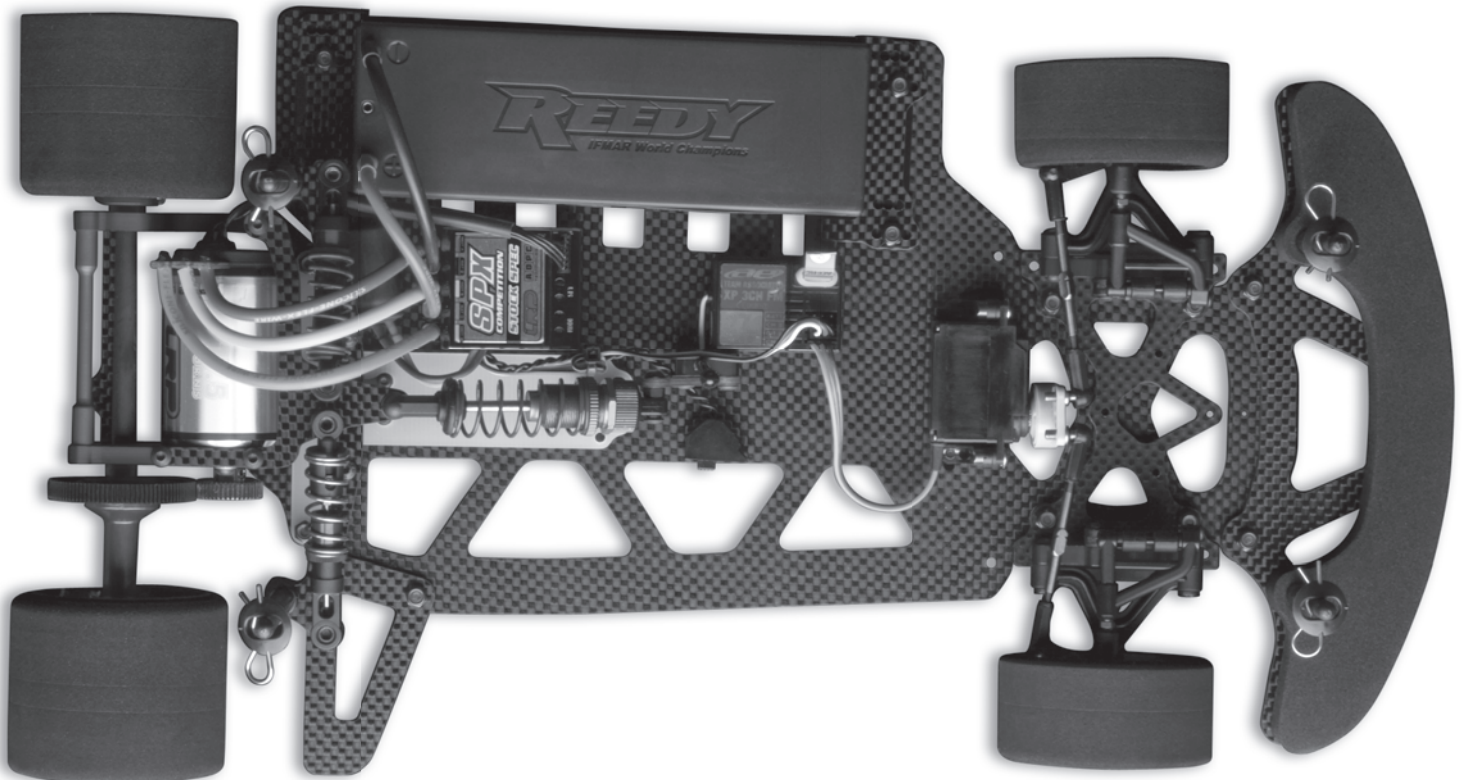



:: Driver: _____ **:: Date:** _____
:: Track: _____
:: Event: _____

Setup Sheet for Team Associated's 10R5 OVAL

Rev. 1

:: Front Suspension

Kingpin Lube: _____ Springs: LF: _____ RF: _____
 Upper Arm Mounts: LF: 0° 5° 10°
 RF: 0° 5° 10°
 Camber: LF: _____ RF: _____
 Ride Height: _____
 Mounting Plate Riser:
 Yes No
 Kingpin:
 shim qty/thickness, LF: _____ RF: _____
 shim qty/thickness, LF: _____ RF: _____
 Wheel axle shims: LF: _____ RF: _____
 Lower arm spacing: LF: _____ RF: _____
 Caster:
 thick thin thin thick thick and thin
 LF: 1.80° 3.25° 6.15°
 RF: 1.80° 3.25° 6.15°

Wheelbase: _____
 Front ride height spacers: LF: _____ RF: _____

:: Rear Suspension

T-Plate: _____ 2 screws 3 screws
 Ride Height Adjuster: _____
 Ride Height: _____
 Side Shocks
 Oil: LR: _____ RR: _____
 Spring: LR: _____ RR: _____

Center Shock
 Piston: _____
 Oil: _____
 Spring: _____
 Position: _____

Hub spacers: LR: _____ / RR: _____
 Notes: _____

:: Tires

Tires	LEFT	RIGHT
Tire Compounds	F	
	R	
Tire Diameter	F	
	R	
Tire Width	F	
	R	

Total Car Weight: _____ oz.
 Tweak Settings
 _____ oz. _____ oz.
 (front)
 _____ oz. _____ oz.
 (rear)
 Shade in amount of tire treatment

:: Battery Placement

Front Rear

 Shade in battery placement for Sub C-cells.
 Battery: _____

:: Track Info / Body

smooth: bumpy:
 traction: high med. low
 Body Type and Make: _____
 Body Height: _____
 Wing: _____
 Notes: _____

:: Motor/Speed Control

Motor: _____
 Timing: _____ Gear: _____ / _____
 S.C. : _____
 S.C. Settings: _____

:: Transmitter

Turning Circle: _____
 Steering Expo: _____
 Brake E.P. : _____
 Throttle Expo: _____
 Notes: _____

:: Factory Team



PERFORMANCE GEAR FOR THE 10R5 OVAL

(Available separately from your local hobby store. Not included in this kit.)

FACTORY TEAM ACCESSORIES

- 1105 GREEN SLIME SHOCK OIL
- 1111 FT TURNBUCKLE WRENCH
- 1450 FT RIDE HEIGHT GAUGE
- 1583 FT ON ROAD/OVAL COMPLETE SPRING KIT
- 1595 LEAD WEIGHTS
- 1596 THREAD LOCKING ADHESIVE
- 1597 FT TIRE ADHESIVE
- 1736 BODY CLIPS - BLUE
- 1737 BODY SCISSORS
- 6588 BLACK GREASE
- 6591 DIFF LUBE
- 6636 SILICONE LUBE
- 6727 SERVO TAPE STRIPS
- 29166 XP DS1313 DIGITAL SERVO
- 29177 XP DS1015 DIGITAL SERVO



- SP58** AE 07 T-SHIRT BLACK (M,L,XL,XXL)
- SP59** AE 07 T-SHIRT BLUE (M,L,XL,XXL)



REEDY PERFORMANCE

- 300 REEDY STOCKSTAR 27T STOCK
- 517 REEDY CHALLENGER 19T SPEC
- 605 REEDY MOTOR COOLING FAN
- 651 REEDY BATTERY BARS
- 654 4.0mm PLUGS (2m, 2f)
- 665 SINGLE CELL SHRINK WRAP (12)
- 679 VMX R-46 IB4600 MATCHED 4-CELL 4.8V
- 680 VMX R-46 IB4600-EU MATCHED 4-CELL 4.8V
- 703 LiPo 5000mAh PRO 7.4V
- 704 LiPo 5000mAh 7.4V w/TAM CONNECTOR
- 705 LiPo 3200mAh 7.4V w/TAM CONNECTOR
- 709 LiPo 35C 5000mAh 7.4V ROAR SPEC
- 711 LiPo 35C 4900mAh 7.4V EFRA SPEC
- SP35** REEDY LOGO T-SHIRT - WHITE (M, L, XL, XXL, XXXL)
- SP36** REEDY LOGO T-SHIRT - BLACK (M, L, XL, XXL, XXXL)
- SP417 FACTORY TEAM 1/10 MOTOR STORAGE BAG
- SP418 FACTORY TEAM 1/10 CAR CARRIER BAG

FACTORY TEAM TOOLS

- ### FACTORY TEAM NUT DRIVERS
- #1561 FULL SET OF 6
 - #1562 3/16" BLACK
 - #1563 1/4" RED
 - #1564 5.5MM PURPLE
 - #1565 11/32" GREEN
 - #1566 7MM SILVER
 - #1567 8MM GOLD

- ### FACTORY TEAM HEX DRIVERS
- #1541 FULL SET OF 7
 - #1542 .050" SILVER
 - #1543 1/16" BLACK
 - #1545 5/64" BLUE
 - #1546 3/32" GOLD
 - #1544 1.5MM PURPLE
 - #1547 2.5MM GREEN
 - #1548 3MM RED

- ### FACTORY TEAM BALL HEX DRIVERS
- #1592 BALL HEX DRIVER SET (3)
 - #1589 5/64" BALL HEX BLUE
 - #1590 3/32" BALL HEX GOLD
 - #1591 2.5MM BALL HEX GREEN

- ### FACTORY TEAM SCREWDRIVERS
- #1551 FT SCREWDRIVERS (2)
 - #1554 FT SPRING HOOK



SILICONE SHOCK FLUIDS

- #5420 10wt. SHOCK FLUID, 2oz
- #5421 20wt. SHOCK FLUID, 2oz
- #5422 30wt. SHOCK FLUID, 2oz
- #5423 40wt. SHOCK FLUID, 2oz
- #5425 80wt. SHOCK FLUID, 2oz
- #5427 15wt. SHOCK FLUID, 2oz
- #5428 25wt. SHOCK FLUID, 2oz
- #5429 35wt. SHOCK FLUID, 2oz
- #5430 45wt. SHOCK FLUID, 2oz
- #5431 55wt. SHOCK FLUID, 2oz
- #5435 50wt. SHOCK FLUID, 2oz
- #5436 60wt. SHOCK FLUID, 2oz
- #5437 70wt. SHOCK FLUID, 2oz

