

## Front Suspension:

Reset Forms

<b>Ride Height:</b>	23.5 mm
<b>Camber:</b>	0
<b>Toe:</b>	0
<b>Arm Type:</b>	#91672 Flat Arm, Hard
<b>Tower Type:</b>	#91661 Flat
<b>Caster Block Insert:</b>	5°
<b>Bulkhead Type:</b>	#91658 Aluminum
<b>Kick-Up Angle:</b>	25°
<b>Wheel Hex:</b>	#91683 Titanium 5 mm
<b>Notes:</b>	#1366 FT Aluminum Servo Horn, 25T 15.5 mm

**Anti Roll Bar:**

None

White (0.8mm)

Gray (0.9mm)

Blue (1.0mm)

Other:

**Bump Steer Spacing:** 2 mm

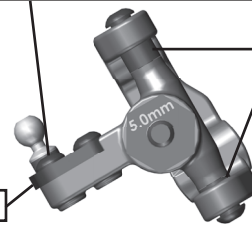

**Axle Height:**

+3

+2

+1

0

**Ball Stud Spacing:** 1 mm

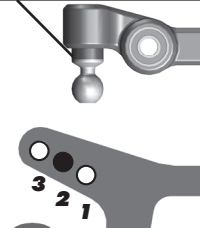

**Steering Plate:** #91679 Kit Aluminum

**Steering Stop Spacing:** 0 mm

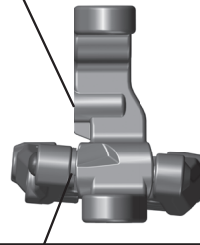

**Caster Block Spacing:** 1 mm

**Ball Stud Spacing:** 1 mm

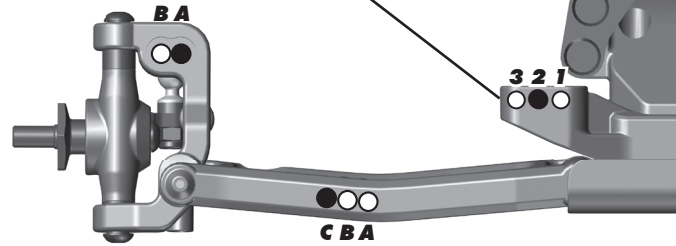

## Rear Suspension:

<b>Ride Height:</b>	23 mm
<b>Camber:</b>	-1°
<b>Wheel Hex:</b>	#91610 Clamping 7 mm
<b>Hub Spacing:</b>	Forward <input type="checkbox"/> Middle <input checked="" type="checkbox"/> Back <input type="checkbox"/>
<b>Shock Mounting Position:</b>	Front of Arm <input type="checkbox"/> Rear of Arm <input checked="" type="checkbox"/>
<b>Notes:</b>	#91686 Aluminum Arm Mount, C
	#91688 Aluminum Arm Mount, D
	#91696 Rear Arm, Hard

**Anti Roll Bar:**

None

White (1.2mm)

Gray (1.3mm)

Blue (1.4mm)

Other:

**Rear Hub Link Setting:**

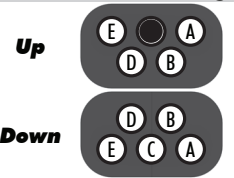

**C Mount Inserts:** 1°  0.5°



**D Mount Inserts:** 1°  0.5°



**Hub Insert:**

+3  +2  +1  0

**Ball Stud Spacing:** 2 mm

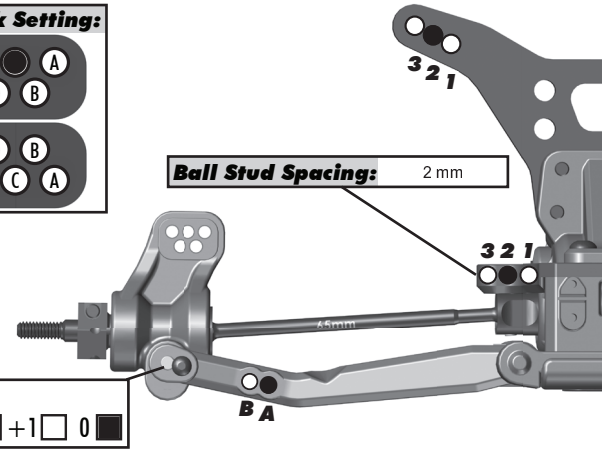

## Electronics:

<b>Radio:</b>	Futaba 4PX	<b>Servo:</b>	Futaba Full Size
<b>EPA: Throttle:</b>	100 %	<b>Brake:</b>	74 %
<b>ESC:</b>	LRP Flow Works Team		
<b>ESC Settings:</b>	N/A		
<b>Motor:</b>	LRP X20		
<b>Wind:</b>	8.5	<b>Timing:</b>	4 Dot
<b>Pinion:</b>	22	<b>Spur:</b>	81
<b>Battery:</b>	LRP Standard Shorty		
<b>Battery Position:</b>	3R		

## Drivetrain:

**Transmission:**

**3 Gear:**       **4 Gear:**

**Stand Up:**       **Lay Down:**

**Differential:**

**Ball Diff:**       **Gear Diff:**

**Notes:**

**Slipper Clutch:**

**Type:** #7495 FT Vented

**# of Pads:** 2

## Shocks:

	Front	Rear
<b>Piston:</b>	2 x 1.6 Flat	2 x 1.7 Flat
<b>Fluid:</b>	30 wt	27.5 wt
<b>Spring:</b>	X-Gear White	Yokomo Green
<b>Limiters:</b>	0	0
<b>Stroke:</b>	22.25 mm	28 mm
<b>Eyelet Length:</b>	Short	Long
<b>Cup Offset:</b>	5 mm	5 mm
<b>Notes:</b>	#91493 X-Rings; #91494 Machined Internals	

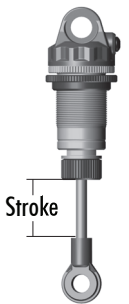

## Track Info:

**Size:** Small  Medium  Large  Extra Large

**Surface:** Dirt  Carpet  Astroturf  Multi Surface

**Traction:** Low  Medium  High  Very High

**Moisture:** Dry  Damp  Wet

**Condition:** Indoor  Outdoor  Dusty  Hard Packed

Bumpy  Grooved  Smooth  Loamy

**Temperature:** Ambient: 75°      Track: 75°

**Notes:**

## Tires:

**Front Tires:** JConcepts Dirt Webs

**Front Compound:** Gold

**Front Insert:** JConcepts Dirt Tech

**Rear Tires:** JConcepts Dirt Webs

**Rear Compound:** Gold

**Rear Insert:** JConcepts Dirt Tech

**Wheel (F/R):** JConcepts Mono

**Notes:**

## Body, Wing, Weight:

**Body:** Team Associated Kit

**Wing:** Team Associated Kit

**Wing Angle:** 0°  3°  6°

**Servo Weights:**

None  Aluminum  Steel  Other

**Electronic Weights:**

None  Aluminum  Steel  Other

**Total Vehicle Weight:** 1510g

## Vehicle Comments:

**Notes:** #91755 Titanium Screw Kit