

Front Suspension:

Reset Forms

| | |
|-----------------------------|--|
| Ride Height: | 21 mm |
| Camber: | -1° |
| Toe: | 0 |
| Arm Type: | #91673 Gullwing, Standard |
| Tower Type: | #91663 Gullwing |
| Caster Block Insert: | 5° |
| Bulkhead Type: | #91656 Plastic |
| Kick-Up Angle: | 25° |
| Wheel Hex: | #91682 Aluminum |
| Notes: | #1366 FT Aluminum Servo Horn, 25T #91667 Plastic Steering Rack #91668 Aluminum Steering Bellcranks |

| | |
|-----------------------|--|
| Anti Roll Bar: | None <input checked="" type="checkbox"/> |
| | White (0.8mm) <input type="checkbox"/> |
| | Gray (0.9mm) <input type="checkbox"/> |
| | Blue (1.0mm) <input type="checkbox"/> |
| | Other: _____ <input type="checkbox"/> |

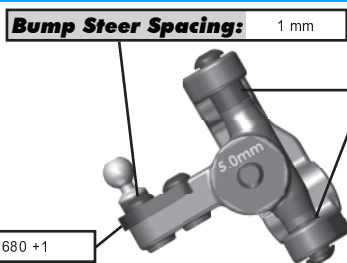

| | |
|---------------------|--|
| Axle Height: | +3 <input type="checkbox"/> |
| | +2 <input type="checkbox"/> |
| | +1 <input checked="" type="checkbox"/> |
| | 0 <input type="checkbox"/> |

| | |
|---------------------------|------|
| Ball Stud Spacing: | 1 mm |
|---------------------------|------|

| | |
|------------------------|-----------|
| Steering Plate: | #91680 +1 |
|------------------------|-----------|

| | |
|-------------------------------|---|
| Steering Stop Spacing: | 0 |
|-------------------------------|---|

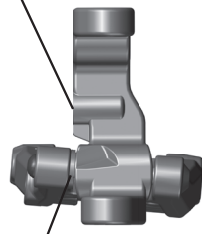

| | |
|------------------------------|------|
| Caster Block Spacing: | 1 mm |
|------------------------------|------|

| | |
|---------------------------|------|
| Ball Stud Spacing: | 1 mm |
|---------------------------|------|

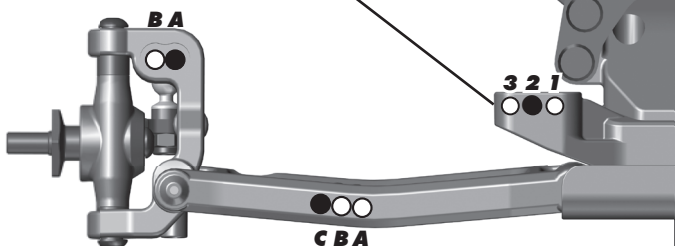

Rear Suspension:

| | |
|---------------------------------|---|
| Ride Height: | 21 mm |
| Camber: | -1° |
| Wheel Hex: | #91610 7.0 mm |
| Hub Spacing: | Forward <input type="checkbox"/> Middle <input checked="" type="checkbox"/> Back <input type="checkbox"/> |
| Shock Mounting Position: | Front of Arm <input checked="" type="checkbox"/> Rear of Arm <input type="checkbox"/> |
| Notes: | #91690 Brass "C" Arm Mount, 25G #91688 Aluminum "D" Arm Mount #91760 FT Aluminum Hubs (Front Row Inside +3mm) #91763 B6 CVA Kit, 67mm Prototype Rear Suspension Arm |

| | |
|-----------------------|--|
| Anti Roll Bar: | None <input checked="" type="checkbox"/> |
| | White (1.2mm) <input type="checkbox"/> |
| | Gray (1.3mm) <input type="checkbox"/> |
| | Blue (1.4mm) <input type="checkbox"/> |
| | Other: _____ <input type="checkbox"/> |

| | |
|-------------------------|--|
| C Mount Inserts: | 1° <input type="checkbox"/> 0.5° <input checked="" type="checkbox"/> |
|-------------------------|--|

| | |
|-------------------------|---|
| D Mount Inserts: | 1° <input type="checkbox"/> 0.5° <input type="checkbox"/> |
|-------------------------|---|

| | |
|-------------------------------|-----------------------------------|
| Rear Hub Link Setting: | Up <input type="checkbox"/> E C A |
| | Down <input type="checkbox"/> D B |

| | |
|--------------------|---|
| Hub Insert: | +3 <input type="checkbox"/> +2 <input type="checkbox"/> +1 <input type="checkbox"/> 0 <input checked="" type="checkbox"/> |
|--------------------|---|

| | |
|---------------------------|------|
| Ball Stud Spacing: | 0 mm |
|---------------------------|------|

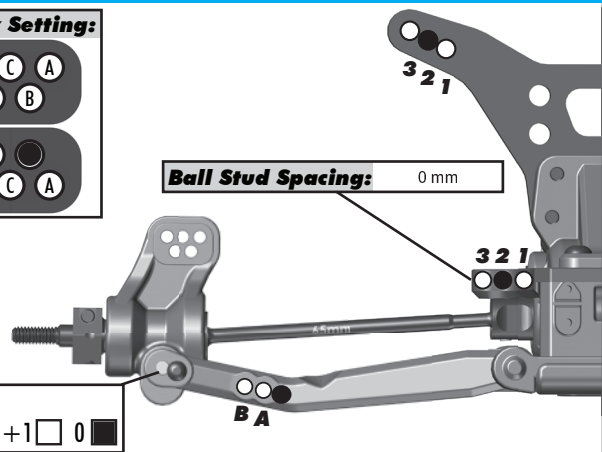

Electronics:

| | | | |
|--------------------------|---|----------------|---------------------|
| Radio: | Sanwa M12S | Servo: | #27109 Reedy RT1408 |
| EPA: Throttle: | 100 % | Brake: | 88% % |
| ESC: | Reedy Blackbox 510R | | |
| ESC Settings: | See Baseline Setup Sheet | | |
| Motor: | Reedy M3 (#273 12.5 Spec Rotor) | | |
| Wind: | 7.5 | Timing: | 10° |
| Pinion: | #1340 Factory Team 22T | Spur: | 78 |
| Battery: | #27308 Reedy Zapper 5400 mAh 70C | | |
| Battery Position: | Battery Strap Slotted To Move Battery Against Waterfall | | |

Drivetrain:

| | |
|------------------------|--|
| Transmission: | 3 Gear: <input checked="" type="checkbox"/> 4 Gear: <input type="checkbox"/> |
| | Stand Up: <input type="checkbox"/> Lay Down: <input checked="" type="checkbox"/> |
| Differential: | Ball Diff: <input checked="" type="checkbox"/> Gear Diff: <input type="checkbox"/> |
| Notes: | |
| Slipper Clutch: | Type: #7495 Vented Team Associated |
| # of Pads: | #9603 Slipper Pad (2) |

Shocks:

| | Front | Rear |
|-----------------------|---|--------------|
| Piston: | 1 x 1.6 + 1 x 1.7 Flat | 2 x 1.7 Flat |
| Fluid: | 32.5 wt | 27.5 wt |
| Spring: | AE Gray | AE Green |
| Limiters: | 2 | 0 |
| Stroke: | 20.5 mm | 28.5 mm |
| Eyelet Length: | Long | Short |
| Cup Offset: | 5 mm | 5 mm |
| Notes: | #91494 Machined Internals, #91493 X-Rings | |

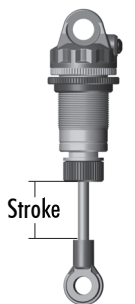

Track Info:

| | |
|---------------------|---|
| Size: | Small <input checked="" type="checkbox"/> Medium <input checked="" type="checkbox"/> Large <input type="checkbox"/> Extra Large <input type="checkbox"/> |
| Surface: | Dirt <input checked="" type="checkbox"/> Carpet <input type="checkbox"/> Astroturf <input type="checkbox"/> Multi Surface <input type="checkbox"/> |
| Traction: | Low <input type="checkbox"/> Medium <input checked="" type="checkbox"/> High <input checked="" type="checkbox"/> Very High <input type="checkbox"/> |
| Moisture: | Dry <input checked="" type="checkbox"/> Damp <input type="checkbox"/> Wet <input type="checkbox"/> |
| Condition: | Indoor <input checked="" type="checkbox"/> Outdoor <input type="checkbox"/> Dusty <input checked="" type="checkbox"/> Hard Packed <input checked="" type="checkbox"/> Bumpy <input checked="" type="checkbox"/> Grooved <input checked="" type="checkbox"/> Smooth <input type="checkbox"/> Loamy <input type="checkbox"/> |
| Temperature: | Ambient: 55F Track: 55F |
| Notes: | |

Tires:

| | |
|------------------------|----------------------|
| Front Tires: | Pro-Line Electron |
| Front Compound: | MC |
| Front Insert: | Pro-Line Closed Cell |
| Rear Tires: | Pro-Line Positron |
| Rear Compound: | MC |
| Rear Insert: | Pro-Line Closed Cell |
| Wheel (F/R): | Pro-Line |
| Notes: | |

Body, Wing, Weight:

| | |
|------------------------------|--|
| Body: | Pro-Line Elite |
| Wing: | Pro-Line Airforce |
| Wing Angle: | 0° <input type="checkbox"/> 3° <input type="checkbox"/> 6° <input checked="" type="checkbox"/> |
| Servo Weights: | None <input checked="" type="checkbox"/> Aluminum <input type="checkbox"/> Steel <input type="checkbox"/> Other <input type="checkbox"/> |
| Electronic Weights: | #91754 FT Graphite ESC Plate |
| Electronic Weights: | None <input type="checkbox"/> Aluminum <input type="checkbox"/> Steel <input type="checkbox"/> Other <input checked="" type="checkbox"/> |
| Total Vehicle Weight: | 1610g |

Vehicle Comments:

Notes: #91652 Side Rails, Standard; #91696 & 91620 Chrome Shock Shafts; #91576 & 91577 Kashima Shock Bodies; #91744 FT Brass Under Battery Weight (26g);