

## Front Suspension:

Reset Forms

<b>Ride Height:</b>	21 mm
<b>Camber:</b>	-1°
<b>Toe:</b>	0°
<b>Arm Type:</b>	#91674 Gullwing, Standard
<b>Tower Type:</b>	#91663 Gullwing
<b>Caster Block Insert:</b>	5°
<b>Bulkhead Type:</b>	#91658 FT Aluminum
<b>Kick-Up Angle:</b>	25°
<b>Wheel Hex:</b>	#91683 FT Titanium
<b>Notes:</b>	#91669 FT Aluminum Steering Rack #91668 FT Aluminum Steering Bellcranks Proline Front Wing & Mount #91702 0.5 mm Bulkhead Shim

**Anti Roll Bar:**

None

White (0.8mm)

Gray (0.9mm)

Blue (1.0mm)

Other:

**Bump Steer Spacing:** 2mm

**Axle Height:**

+3

+2

+1

0

**Ball Stud Spacing:** 2mm

**Steering Plate:** #91680 +1

**Steering Stop Spacing:**

**Ball Stud Spacing:** 1mm

**Caster Block Spacing:** 1mm

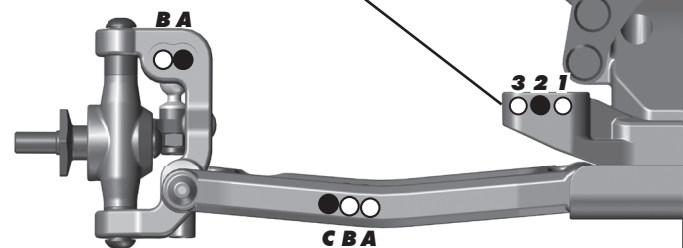
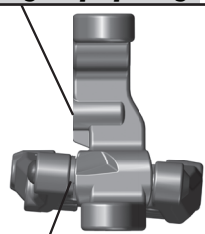
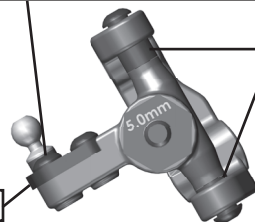

## Rear Suspension:

<b>Ride Height:</b>	21 mm
<b>Camber:</b>	-1°
<b>Wheel Hex:</b>	6mm
<b>Hub Spacing:</b>	Forward <input checked="" type="checkbox"/> Middle <input type="checkbox"/> Back <input type="checkbox"/>
<b>Shock Mounting Position:</b>	Front of Arm <input checked="" type="checkbox"/> Rear of Arm <input type="checkbox"/>
<b>Notes:</b>	#91690 Brass "C" Arm Mount, 25G #91688 Aluminum "D" Arm Mount #91434 Rear CVA Bones, 67mm Schelle Rear Hub (Inside Hole +1mm) / Schelle 67mm Offset Axles

**Anti Roll Bar:**

None

White (1.2mm)

Gray (1.3mm)

Blue (1.4mm)

Other:

**Rear Hub Link Setting:**

**Up**

E  A

D  B

**Down**

D  B

E  C  A

**C Mount Inserts:** 1°  0.5°

**D Mount Inserts:** 1°  0.5°

**Hub Insert:**

+3  +2  +1  0

**Ball Stud Spacing:** 2mm

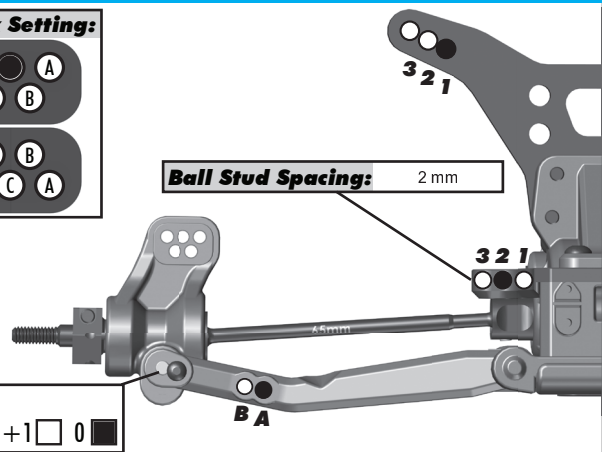
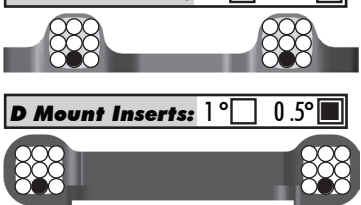

## Electronics:

<b>Radio:</b>	Sanwa M12	<b>Servo:</b>	#27109 Reedy RT1408
<b>EPA: Throttle:</b>	100 %	<b>Brake:</b>	67 %
<b>ESC:</b>	#27004 Reedy Blackbox 510R		
<b>ESC Settings:</b>	N/A		
<b>Motor:</b>	Reedy Mach 3 (#271 12.0 Rotor)		
<b>Wind:</b>	#260 7.5	<b>Timing:</b>	20
<b>Pinion:</b>	#1339 Factory Team 21T	<b>Spur:</b>	78
<b>Battery:</b>	#27307 Reedy Zapper 5800		
<b>Battery Position:</b>	4F		

## Drivetrains:

**Transmission:**

**3 Gear:**  **4 Gear:**

**Stand Up:**  **Lay Down:**

**Differential:**

**Ball Diff:**  **Gear Diff:**

**Notes:**

**Slipper Clutch:**

**Type:** #7495 Vented Team Associated

**# of Pads:** #91197 LCF (2)

## Shocks:

	Front	Rear
<b>Piston:</b>	3 x 1.4 Flat Machined	3 x 1.4 Flat Machined
<b>Fluid:</b>	32.5 wt	27.5 wt
<b>Spring:</b>	AE Gray	X-Gear Pink
<b>Limiters:</b>	1	0
<b>Stroke:</b>	20.5 mm	28.25 mm
<b>Eyelet Length:</b>	Long	Short
<b>Cup Offset:</b>	5mm	0mm
<b>Notes:</b>	#91494 Machined Internals, #91493 X-Rings	

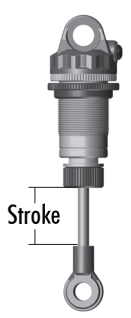

## Track Info:

**Size:** Small  Medium  Large  Extra Large

**Surface:** Dirt  Carpet  Astroturf  Multi Surface

**Traction:** Low  Medium  High  Very High

**Moisture:** Dry  Damp  Wet

**Condition:** Indoor  Outdoor  Dusty  Hard Packed   
Bumpy  Grooved  Smooth  Loamy

**Temperature:** Ambient: \_\_\_\_\_ Track: \_\_\_\_\_

**Notes:**

## Tires:

**Front Tires:** Proline Positrons

**Front Compound:** MC

**Front Insert:** Proline

**Rear Tires:** Proline Positrons

**Rear Compound:** MC

**Rear Insert:** Proline

**Wheel (F/R):** Proline

**Notes:**

## Body, Wing, Weight:

**Body:** Proline Elite

**Wing:** Proline Airforce (Moved back 5mm)

**Wing Angle:** 0°  3°  6°

**Servo Weights:**

None  Aluminum  Steel  Other

**Electronic Weights:**

None  Aluminum  Steel  Other

**Total Vehicle Weight:** 1575

## Vehicle Comments:

**Notes:** #91755 Ti Screw Kit (only used above chassis); #91696 & 91620 Chrome Shock Shafts; #91576 & 91577 Kashima Shock Bodies;